

EAST APPROACH
AT OLD IL ROUTE 3 INTERSECTION
WITH McCLURE GALE RD.

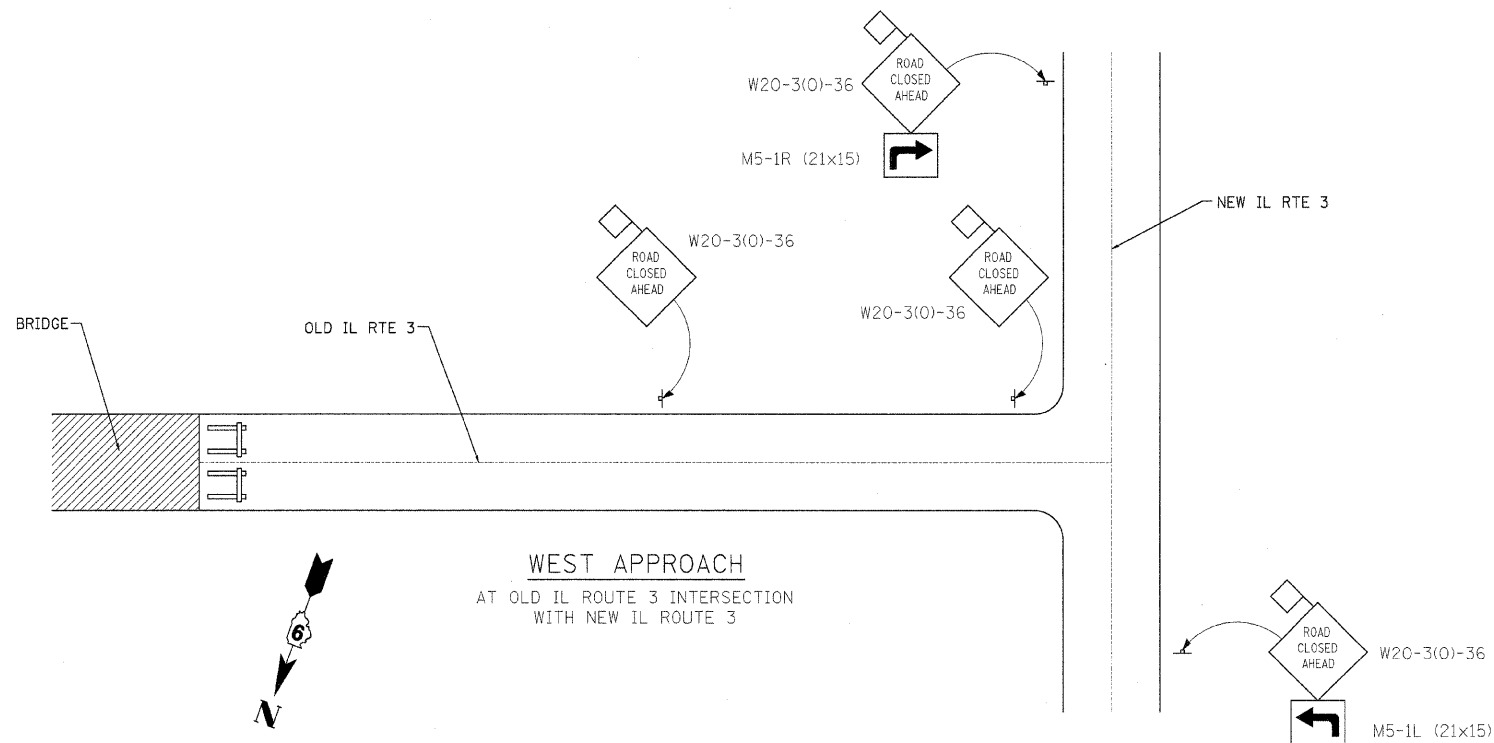

WEST APPROACH
AT OLD IL ROUTE 3 INTERSECTION
WITH NEW IL ROUTE 3



NOTES:

1. TRAFFIC CONTROL TO BE PROVIDED IN ACCORDANCE WITH HIGHWAY STANDARD B.L.R. 21-7 AND AS SPECIFIED HEREIN, AND SHALL BE PAID AT THE CONTRACT PRICE PER "LUMP SUM" FOR TRAFFIC CONTROL AND PROTECTION, STANDARD BLR 21 (SPECIAL).
2. SIGN LOCATIONS, INCLUDING PORTABLE CHANGEABLE MESSAGE SIGN, SHALL BE DETERMINED BY THE ENGINEER.
3. SEE HIGHWAY STANDARD B.L.R. 21-7 FOR DETAILS NOT SHOWN.

SYMBOLS



WORK AREA



TYPE III BARRICADE



SIGN WITH 18" BY 18" (MINIMUM)
ORANGE FLAG ATTACHED

FILE NAME =
...\\W01\Roadway\Sheets\MOT.dgn

USER NAME = Plotted by Administrator
PLOT SCALE = 10,0000' / 1IN.
PLOT DATE = 4/15/2009

DESIGNED - KHH
DRAWN - KHH
CHECKED - FML
DATE - 11/2008

REVISED - ----
REVISED - ----
REVISED - ----
REVISED - ----

**STATE OF ILLINOIS
DEPARTMENT OF TRANSPORTATION**

**MAINTENANCE OF TRAFFIC DETAIL
OLD IL ROUTE 3 OVER SEXTON CREEK**
SCALE: N.T.S. SHEET NO. ___ OF ___ SHEETS STA. TO STA.

S.B.I. RTE.	SECTION	COUNTY	TOTAL SHEETS	SHEET NO.
150	(133A)D, I	ALEXANDER	32	7
CONTRACT NO. 98910				
FED. ROAD DIST. NO. ILLINOIS FED. AID PROJECT				