

ROUTE NO.	SECTION	COUNTY	TOTAL SHEETS	SHEET NO.	SHEET NO. 9 23 SHEETS
S.B.I. 150	(133A) D.1	Alexander	32	16	
FED. ROAD DIST. NO. 7	ILLINOIS	FED. AID PROJECT-			

Contract #98910

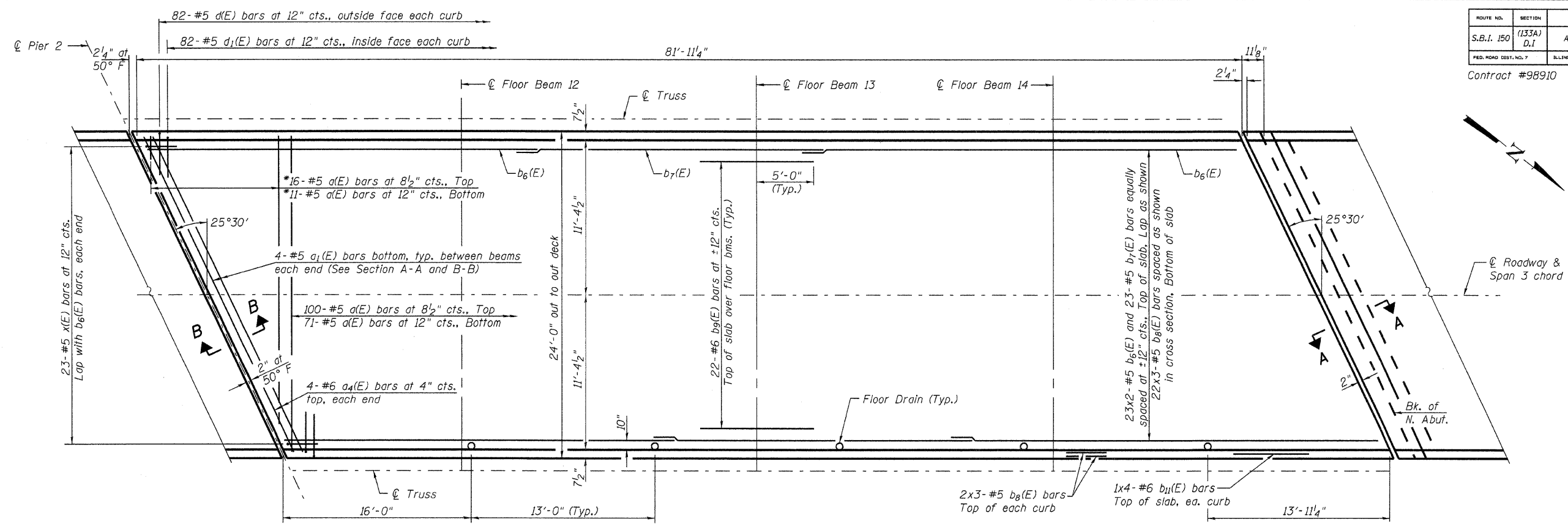

*Order a(E) bars full length. Cut to fit skew and use remainder in opposite end.

PLAN-SPAN 3

MIN. BAR LAP

- #5 bar = 1'-8"
- #6 bar = 2'-0"

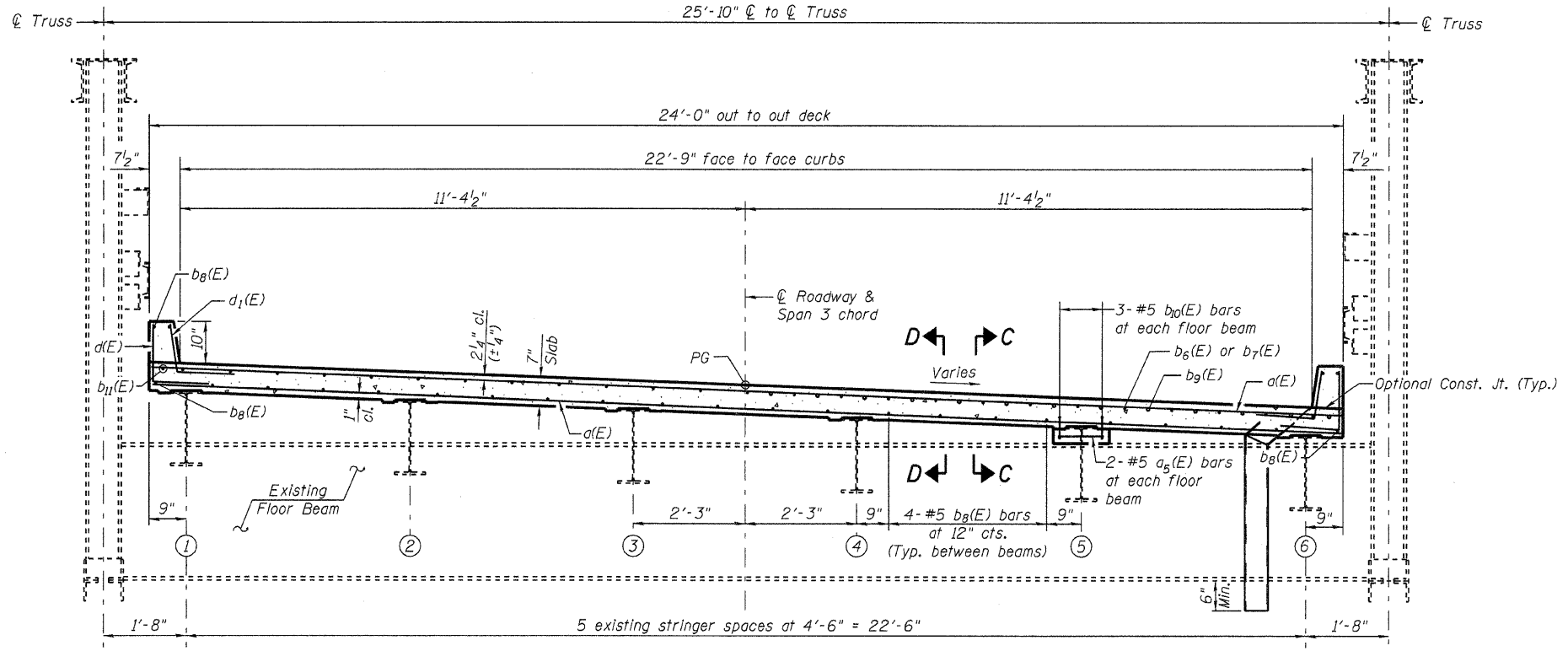

Notes:
 All longitudinal dimensions are measured along inside face of curb.
 See Sheets 10 of 23 for superstructure details and Bill of Material.
 See Sheet 10 of 23 for Sections A-A, B-B, C-C and D-D.
 Bars indicated thus 2x3-#5 etc. indicates 2 lines of bars with 3 lengths per line.

NEAR MIDSPAN

CROSS SECTION
(Looking North)

NEAR FLOORBEAM

LE LIN ENGINEERING, LTD.
 Consulting Engineers
 Chatham, Illinois

Designed By: DLS Checked By: STD Drawn By: A.J.F.
 Date: Feb. 2009 File: 002-0009.dgn

ILLINOIS DEPARTMENT OF TRANSPORTATION
SUPERSTRUCTURE - SPAN 3
 OLD ILLINOIS ROUTE 3
 OVER SEXTON CREEK
 S.B.I. ROUTE 150 - SECTION (133A)D.1
 ALEXANDER COUNTY
 STATION 1212+84.95
 STRUCTURE NO. 002-0009

...:\2009 revisions\002-0009.dgn

11:47:59 AM

3/1/2009