

F.A.I. RTE.	SECTION	COUNTY	TOTAL SHEETS	SHEET NO.
55		WILL	608	279
STA.		TO STA.		
FED. ROAD DIST. NO. 1		ILLINOIS	FED. AID PROJECT	
(26, 26HB-1&114) R-2		CONTRACT NO. 60363		

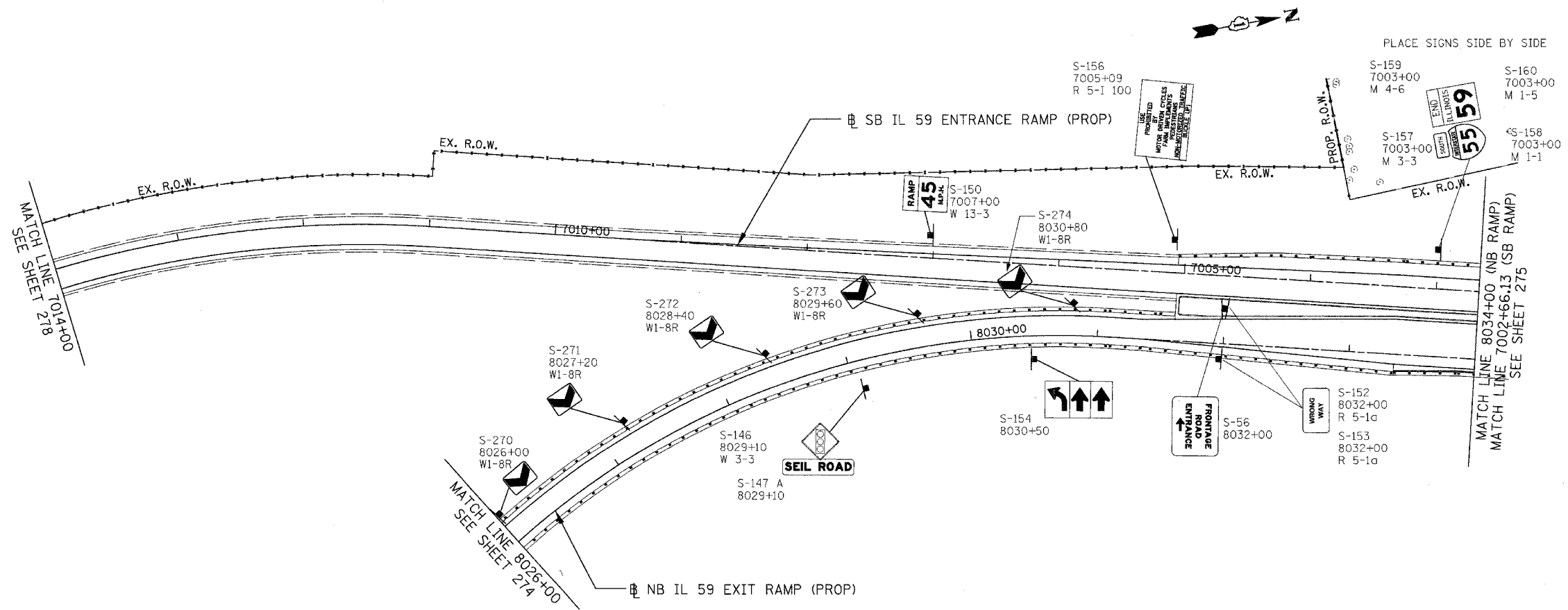

LEGEND

- | | | | |
|--|--------------------------------------|--|---|
| | EXISTING SIGN TRUSS | | EXISTING SIGN TO BE RELOCATED. (AT SAME STATION UNLESS SPECIFIED OTHERWISE) |
| | PROPOSED SIGN TRUSS | | EXISTING SIGN TO BE REMOVED |
| | EXISTING CANTILEVER SIGN FOUNDATION | | EXISTING SIGN TO REMAIN IN PLACE |
| | PROPOSED CANTILEVER SIGN FOUNDATION | | |
| | EXISTING GROUND/ BRIDGE MOUNTED SIGN | | |
| | PROPOSED GROUND/ BRIDGE MOUNTED SIGN | | |

REVISIONS	
NAME	DATE

ILLINOIS DEPARTMENT OF TRANSPORTATION
 FAI 55 AT FAP 338 ILLINOIS ROUTE 59
 SECTION: (26, 26HB-1&114) R-2
**EXISTING AND PROPOSED
 NB/SB RAMP RAMP SIGNING PLAN
 STA. 7002+66 TO STA. 7014+00**
 SCALE: 1" = 50'
 DATE: 03/14/08
 DRAWN BY: JB
 CHECKED BY: ACL
TENG
TENG & ASSOCIATES, INC.
 ENGINEERS/ARCHITECTS/PLANNERS
 315 N. DEARBORN AVE. CHICAGO, IL 60610
 TELEPHONE: 312.666.9999

\\ALTOORH6.DGN, \\SHPORR9.DGN, \\SURPOR9.DGN, \\TPOROR9.DGN, \\RWOOR9.DGN, \\TTBOROR9.DGN, \\RWOOR9.DGN, \\UTLOROP.DGN, \\DROROR9.DGN, \\DROROR9.DGN, \\LNDORPL.DGN, \\MOTORP.DGN, \\3-14-2008, 8:57:48
 T:\DOCUMENT\6279\N\VE\LOG\SIGN\0525.DGN
 1 2 3 4 5 6 7 8 9 10 11 12 13 14 15 16 17 18 19 20 21 22 23 24 25 26 27 28 29 30 31 32 33 34 35 36 37 38 39 40 41 42 43 44 45 46 47 48 49 50 51 52 53 54 55 56 57 58 59 60 61 62