

STATE OF ILLINOIS
DEPARTMENT OF TRANSPORTATION
DIVISION OF HIGHWAYS

**PROPOSED
HIGHWAY PLANS**

F.A.U. ROUTE 2746 CUMBERLAND AVE.
SECTION: 3215 A-RS
BELLE PLAINE AVE. TO HIGGINS RD. (IL-72)
RESURFACING (MAINTENANCE)
PROJECT NO.: M-2746(015)
COOK COUNTY
C-91-094-98

F.A. RTE. 2746	SECTION 3215 A-RS	COUNTY COOK	TOTAL SHEETS 27	SHEET NO. 1
FED. ROAD DIST. NO.		ILLINOIS	CONTRACT NO. 60559	

FOR INDEX OF SHEETS, SEE SHEET NO. 2

PROJECT LOCATED IN
THE CITY OF PARK RIDGE

D-91-094-98



PROJECT BEGINS
STATION 28+20

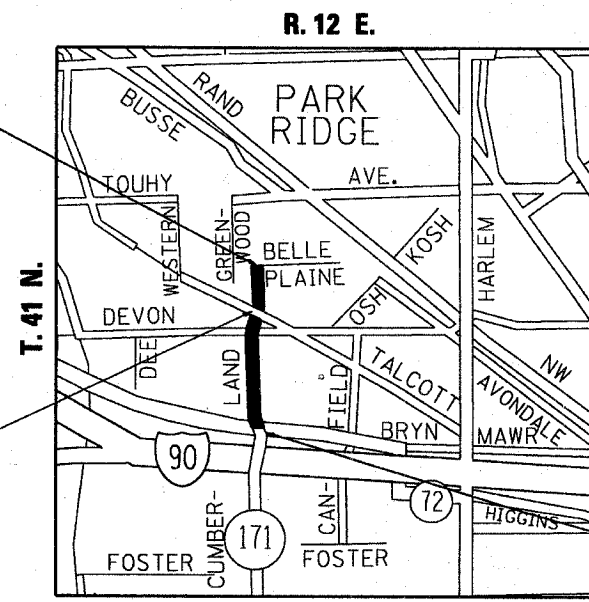

TRAFFIC DATA

2008 ADT = 13500
POSTED SPEED LIMIT = 30 MPH

MAP SCALE



OMISSION
STA 47+41.5 TO 49+13.5

PROJECT ENDS
STATION 92+03

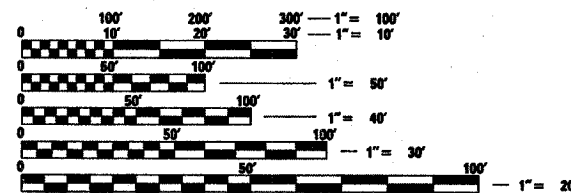

FULL SIZE PLANS HAVE BEEN PREPARED USING STANDARD ENGINEERING SCALES. REDUCED SIZED PLANS WILL NOT CONFORM TO STANDARD SCALES. IN MAKING MEASUREMENTS ON REDUCED PLANS, THE ABOVE SCALES MAY BE USED.

J.U.L.I.E.
JOINT UTILITY LOCATION INFORMATION FOR EXCAVATION
1-800-892-0123
OR 811

PROJECT ENGINEER JENPAI CHANG (847) 705-4432
PROJECT MANAGER KEN ENG

CONTRACT NO. 60559

NET LENGTH OF IMPROVEMENT = 6211 LINEAL FEET = 1.18 MILES
GROSS LENGTH OF IMPROVEMENT = 6383 LINEAL FEET = 1.20 MILES

STATE OF ILLINOIS
DEPARTMENT OF TRANSPORTATION
DIVISION OF HIGHWAYS

SUBMITTED MAY 14, 2008
Diana M. O'Keefe
DEPUTY DIRECTOR OF HIGHWAYS, REGION ENGINEER

JUNE 27, 2008
Eric E. Hurrell
ENGINEER OF DESIGN AND ENVIRONMENT

JUNE 27, 2008
Christina M. Reed
DIRECTOR OF HIGHWAYS, CHIEF ENGINEER

**PRINTED BY THE AUTHORITY
OF THE STATE OF ILLINOIS**

SUMMARY OF QUANTITIES			CONSTRUCTION TYPE CODE				
CODE NO	ITEM	UNIT	TOTAL QUANTITIES	URBAN 80% FED. 20% STATE 1000			
40600200	BITUMINOUS MATERIALS (PRIME COAT)	TON	12.2	12.2			
40600300	AGGREGATE (PRIME COAT)	TON	61.1	61.1			
40600400	MIXTURE FOR CRACKS, JOINTS, AND FLANGEWAYS	TON	9.2	9.2			
40600635	LEVELING BINDER (MACHINE METHOD), N70	TON	1757	1757			
40600895	CONSTRUCTING TEST STRIP	EACH	1	1			
40600982	HOT-MIX ASPHALT SURFACE REMOVAL - BUTT JOINT	SO YD	488.5	488.5			
40601005	HOT-MIX ASPHALT REPLACEMENT OVER PATCHES	TON	560	560			
40603340	HOT-MIX ASPHALT SURFACE COURSE, MIX "D", N70	TON	2636	2636			
42001300	PROTECTIVE COAT	SO YD	256	256			
44000159	HOT-MIX ASPHALT SURFACE REMOVAL, 2 1/2"	SO YD	30562	30562			
44001700	COMBINATION CONCRETE CURB AND GUTTER REMOVAL AND REPLACEMENT	FOOT	1150	1150			
44002210	HOT-MIX ASPHALT REMOVAL OVER PATCHES, 2 1/2"	SO YD	2611	2611			
44002224	HOT-MIX ASPHALT REMOVAL OVER PATCHES, 6"	SO YD	570	570			
44201737	CLASS D PATCHES, TYPE I, 8 INCH	SO YD	5	5			
44201741	CLASS D PATCHES, TYPE II, 8 INCH	SO YD	387	387			
44201745	CLASS D PATCHES, TYPE III, 8 INCH	SO YD	19	19			
44201747	CLASS D PATCHES, TYPE IV, 8 INCH	SO YD	153	153			
44201765	CLASS D PATCHES, TYPE II, 10 INCH	SO YD	1230	1230			
44201769	CLASS D PATCHES, TYPE III, 10 INCH	SO YD	466	466			
44201771	CLASS D PATCHES, TYPE IV, 10 INCH	SO YD	599	599			
** 55039700	STORM SEWERS TO BE CLEANED	FOOT	1300	1300			
60251730	CATCH BASINS TO BE ADJUSTED WITH NEW TYPE 23 FRAME AND GRATE	EACH	13	13			
60255800	MANHOLES TO BE ADJUSTED WITH NEW TYPE 1 FRAME, CLOSED LID	EACH	2	2			
60258200	MANHOLES TO BE RECONSTRUCTED WITH NEW TYPE 1 FRAME, CLOSED LID	EACH	1	1			
60261530	INLETS TO BE ADJUSTED WITH NEW TYPE 23 FRAME AND GRATE	EACH	12	12			

* SPECIALTY ITEMS
** NON PARTICIPATING ITEMS

SUMMARY OF QUANTITIES			CONSTRUCTION TYPE CODE				
CODE NO	ITEM	UNIT	TOTAL QUANTITIES	URBAN 80% FED. 20% STATE 1000			
60300305	FRAMES AND LIDS TO BE ADJUSTED	EACH	1	1			
60300310	FRAMES AND LIDS TO BE ADJUSTED (SPECIAL)	EACH	57	57			
67000400	ENGINEER'S FIELD OFFICE, TYPE A	CAL MO	6	6			
67100100	MOBILIZATION	L SUM	1	1			
70102620	TRAFFIC CONTROL AND PROTECTION, STANDARD 701501	L SUM	1	1			
70102625	TRAFFIC CONTROL AND PROTECTION, STANDARD 701606	L SUM	1	1			
70102635	TRAFFIC CONTROL AND PROTECTION, STANDARD 701701	L SUM	1	1			
70300100	SHORT-TERM PAVEMENT MARKING	FOOT	4103	4103			
70300210	TEMPORARY PAVEMENT MARKING - LETTERS AND SYMBOLS	SO FT	193	193			
70300220	TEMPORARY PAVEMENT MARKING - LINE 4"	FOOT	11281	11281			
70300240	TEMPORARY PAVEMENT MARKING - LINE 6"	FOOT	563	563			
70300260	TEMPORARY PAVEMENT MARKING - LINE 12"	FOOT	273	273			
70300280	TEMPORARY PAVEMENT MARKING - LINE 24"	FOOT	136	136			
70301000	WORK ZONE PAVEMENT MARKING REMOVAL	SO FT	1227	1227			
* 78000100	THERMOPLASTIC PAVEMENT MARKING - LETTERS AND SYMBOLS	SO FT	193	193			
* 78000200	THERMOPLASTIC PAVEMENT MARKING - LINE 4"	FOOT	11281	11281			
* 78000400	THERMOPLASTIC PAVEMENT MARKING - LINE 6"	FOOT	563	563			
* 78000600	THERMOPLASTIC PAVEMENT MARKING - LINE 12"	FOOT	273	273			
* 78000650	THERMOPLASTIC PAVEMENT MARKING - LINE 24"	FOOT	193	193			
* 78100100	RAISED REFLECTIVE PAVEMENT MARKER	EACH	388	388			
78300200	RAISED REFLECTIVE PAVEMENT MARKER REMOVAL	EACH	173	173			
* 88600600	DETECTOR LOOP REPLACEMENT	FOOT	393	393			
X0322256	TEMPORARY INFORMATION SIGNING	SO FT	51.4	51.4			
** Z0018500	DRAINAGE STRUCTURES TO BE CLEANED	EACH	130	130			

X4067107 POLYMERIZED LEVELING BINDER (MACHINE METHOD), IL-4.75, N 50 TON 1757 1757

FILE NAME =	USER NAME = auky	DESIGNED -	REVISED -	STATE OF ILLINOIS DEPARTMENT OF TRANSPORTATION	SUMMARY OF QUANTITIES			F.A.J. RTE.	SECTION	COUNTY	TOTAL SHEETS	SHEET NO.
ca\projects\dl09498\design.ee.dgn		DRAWN -	REVISED -					2746	3215A-RS	COOK	27	3
PLOT SCALE = 1/8" = 1' / IN.		CHECKED -	REVISED -		SCALE: SHEET NO. OF SHEETS STA. TO STA.			CONTRACT NO. 60559				
PLOT DATE = 5/15/2008		DATE -	REVISED -		FED. ROAD DIST. NO. 1 ILLINOIS FED. AID PROJECT							

Rev.

CUMBERLAND AVE.

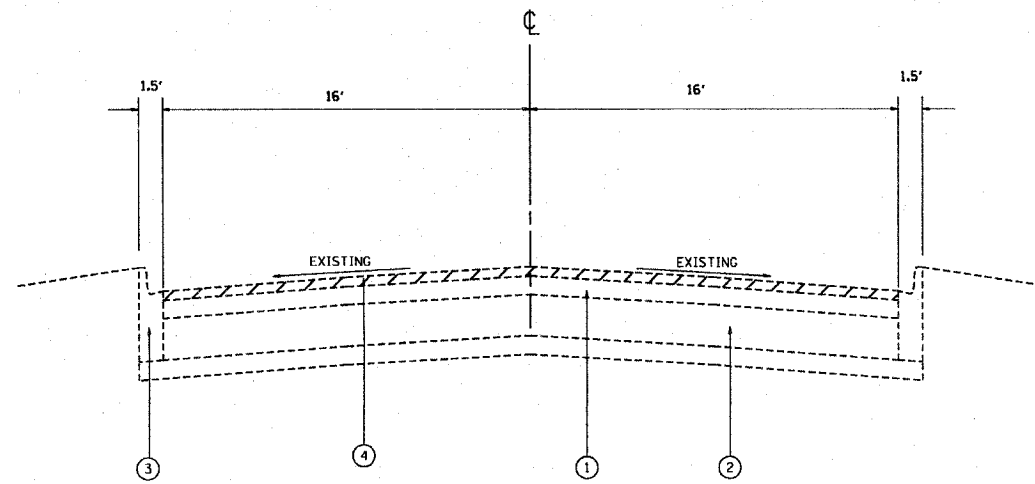

EXISTING
STA 28+20 TO STA 28+36

CUMBERLAND AVE.

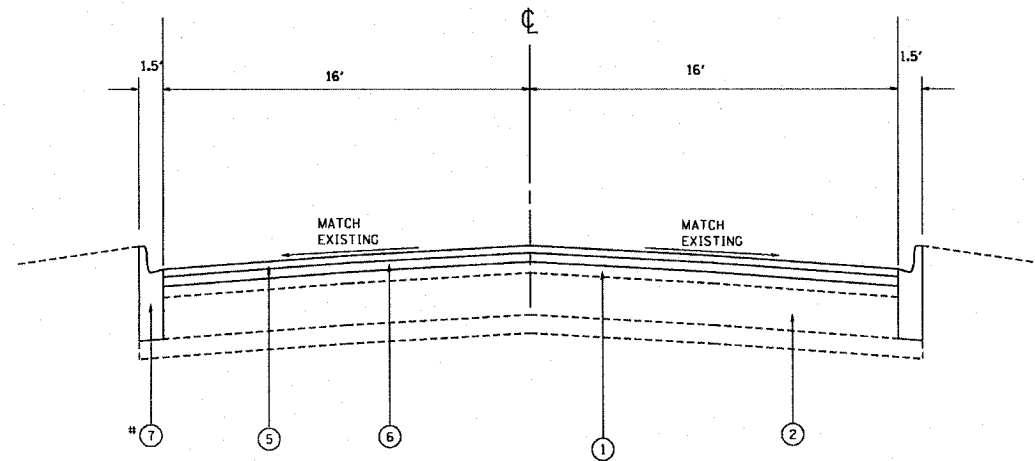

PROPOSED
STA 28+20 TO STA 28+36

LEGEND

- ① EXISTING HMA OVERLAY AFTER MILLING (3 1/2")
 - ② EXISTING PCC PAVEMENT (7 1/2")
 - ③ EXISTING CONCRETE CURB AND GUTTER, TYPE B-6.12
 - ④ PROPOSED HMA SURFACE REMOVAL, 2 1/2"
 - ⑤ PROPOSED HMA SURFACE COURSE, MIX "D", N70 (1 1/2")
 - ⑥ PROPOSED POLYMERIZED LEVELING BINDER (MACHINE METHOD), IL-4.75, N50 (1")
 - ⑦ PROPOSED CONCRETE CURB AND GUTTER, TYPE B-6.12
- * LOCATIONS TO BE DETERMINED BY THE ENGINEER

MIX SCHEDULE

MIX TYPE	AC TYPE	VOIDS
HMA SURF. CSE., MIX "D", N70 (IL-9.5mm)	PG 64-22	4% @ 70 CYR
POLYMERIZED LEVELING BINDER (MACHINE METHOD), IL 4.75, N50-	SBS/SBR PG 76-28/-22*	4% @ 50 CYR
HMA REPLACEMENT OVER PATCHES (HMA BINDER IL-19mm)	PG 64-22*	4% @ 70 CYR
CLASS D PATCH (HMA BINDER IL-19mm)	PG 64-22*	4% @ 70 CYR

NOTE: THE UNIT WEIGHT USED TO CALCULATE ALL HMA SURFACE MIXTURES IS 112 LBS/SQ. YD./ IN.
*WHEN RAP EXCEEDS 20% THE NEW ASPHALT BINDER IN THE MIX SHALL BE PG 58-22

CUMBERLAND AVE.

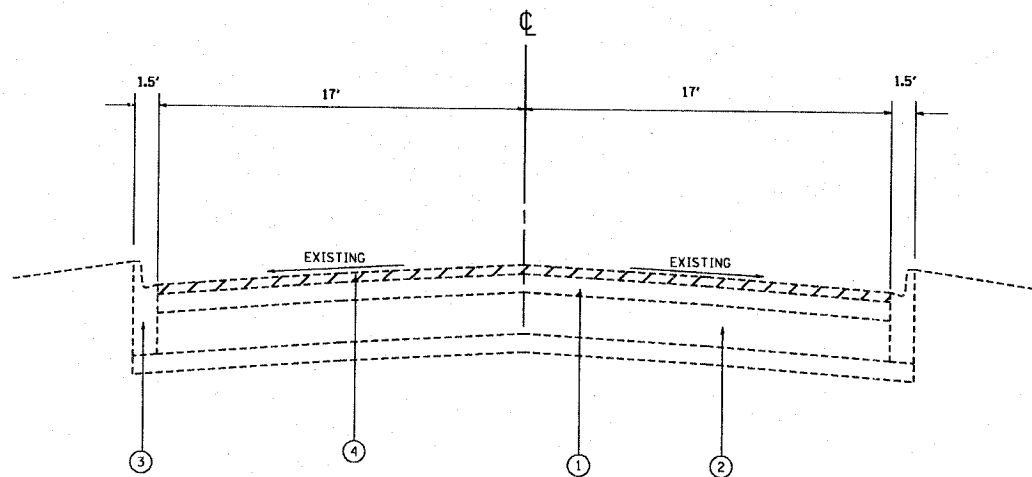

EXISTING
STA 29+71 TO STA 47+41.5

LEGEND

- ① EXISTING HMA OVERLAY AFTER MILLING (3 1/2")
 - ② EXISTING PCC PAVEMENT (7 1/2")
 - ③ EXISTING CONCRETE CURB AND GUTTER, TYPE B-6.12
 - ④ PROPOSED HMA SURFACE REMOVAL, 2 1/2"
 - ⑤ PROPOSED HMA SURFACE COURSE, MIX "D", N70 (1 1/2")
 - ⑥ PROPOSED POLYMERIZED LEVELING BINDER (MACHINE METHOD), IL-4.75, N50 (1")
 - ⑦ PROPOSED CONCRETE CURB AND GUTTER, TYPE B-6.12
- * LOCATIONS TO BE DETERMINED BY THE ENGINEER

CUMBERLAND AVE.

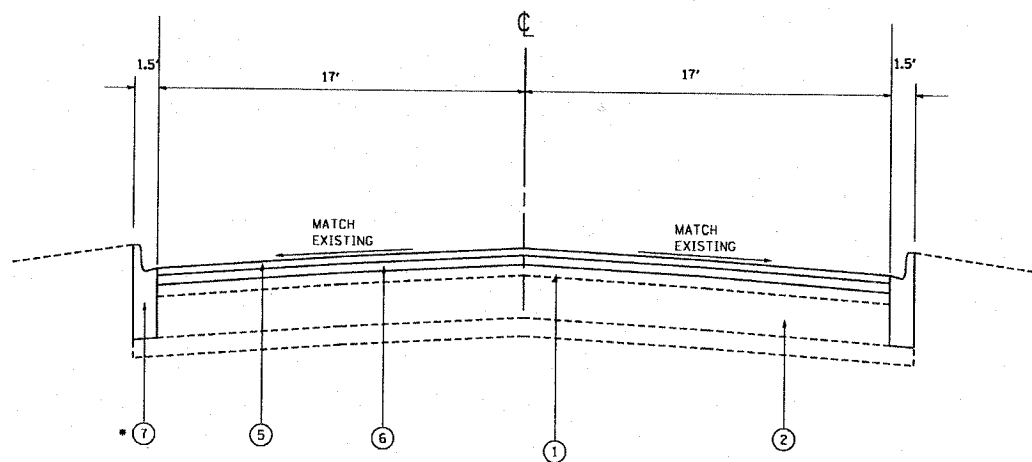

PROPOSED
STA 29+71 TO STA 47+41.5

FILE NAME = c:\projects\1018198\design.dgn	USER NAME = auky	DESIGNED -	REVISED -	STATE OF ILLINOIS DEPARTMENT OF TRANSPORTATION	CUMBERLAND AVE. EXISTING AND PROPOSED TYPICAL SECTIONS	F.A.U. RTE. 2746	SECTION 3215A-RS	COUNTY COOK	TOTAL SHEETS 27	SHEET NO. 6	
PLOT SCALE = 1/8" = 1' / IN.	DRAWN -	REVISED -	SCALE:			SHEET NO. OF SHEETS	STA. TO STA.	CONTRACT NO. 60559			
PLOT DATE = 6/13/2008	CHECKED -	REVISED -	FED. ROAD DIST. NO. 1 ILLINOIS FED. AID PROJECT								
	DATE -	REVISED -									

CUMBERLAND AVE.

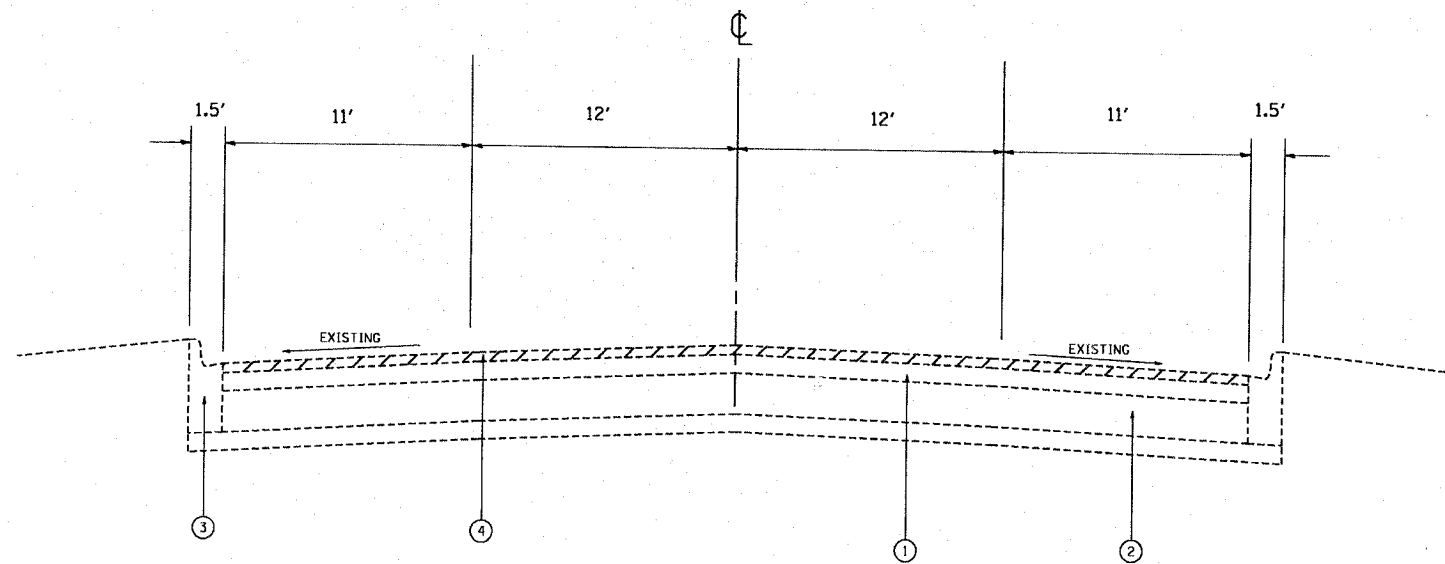

EXISTING
STA 49+13.5 TO STA 56+60

CUMBERLAND AVE.

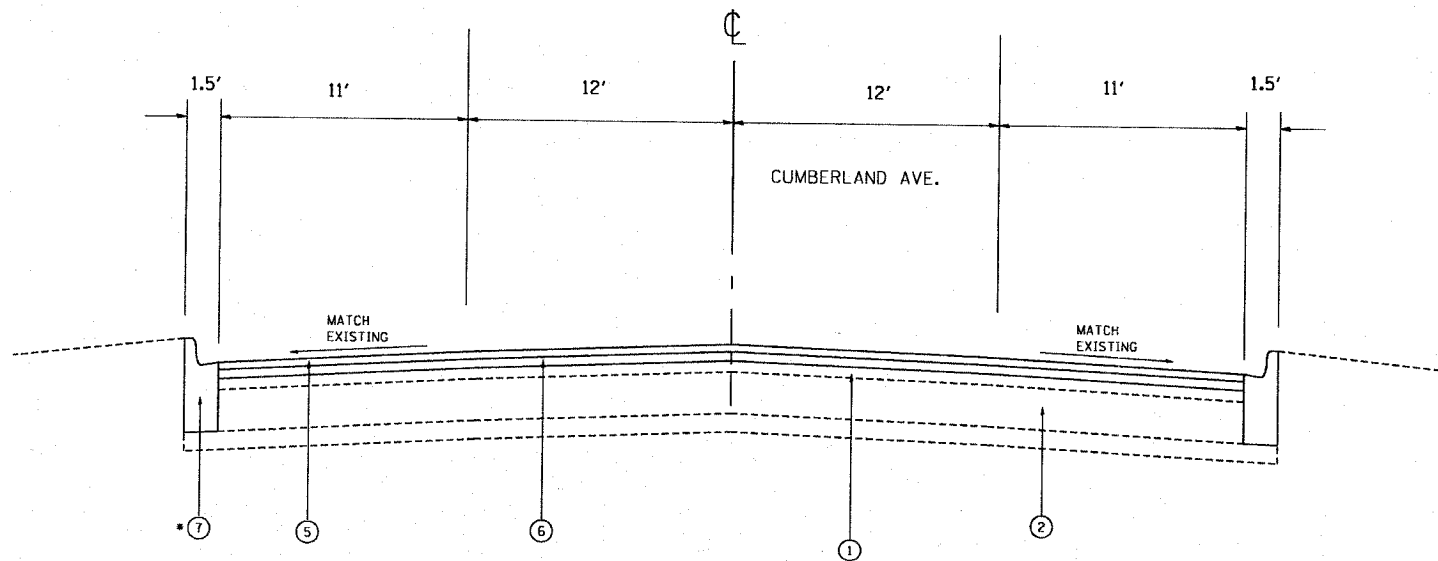

PROPOSED
STA 49+13.5 TO STA 56+60

LEGEND

- ① EXISTING HMA OVERLAY AFTER MILLING (3 1/2")
 - ② EXISTING PCC PAVEMENT (7 1/2")
 - ③ EXISTING CONCRETE CURB AND GUTTER, TYPE B-6.12
 - ④ PROPOSED HMA SURFACE REMOVAL, 2 1/2"
 - ⑤ PROPOSED HMA SURFACE COURSE, MIX "D", N70 (1 1/2")
 - ⑥ PROPOSED POLYMERIZED LEVELING BINDER (MACHINE METHOD), IL-4.75, N50 (1")
 - ⑦ PROPOSED CONCRETE CURB AND GUTTER, TYPE B-6.12
- LOCATIONS TO BE DETERMINED BY THE ENGINEER

FILE NAME =
c:\projects\109498\design_00.dgn

USER NAME = euky
PLOT SCALE = 1/8" = 1' / IN.
PLOT DATE = 6/13/2008

DESIGNED -
DRAWN -
CHECKED -
DATE -

REVISED -
REVISED -
REVISED -
REVISED -

STATE OF ILLINOIS
DEPARTMENT OF TRANSPORTATION

CUMBERLAND AVE.
EXISTING AND PROPOSED TYPICAL SECTIONS

SCALE: SHEET NO. OF SHEETS STA. TO STA.

F.A.D. RTE.	SECTION	COUNTY	TOTAL SHEETS	SHEET NO.
2746	3215A-RS	COOK	27	7
FED. ROAD DIST. NO. 1 ILLINOIS FED. AID PROJECT				

CONTRACT NO. 60559

CUMBERLAND AVE.

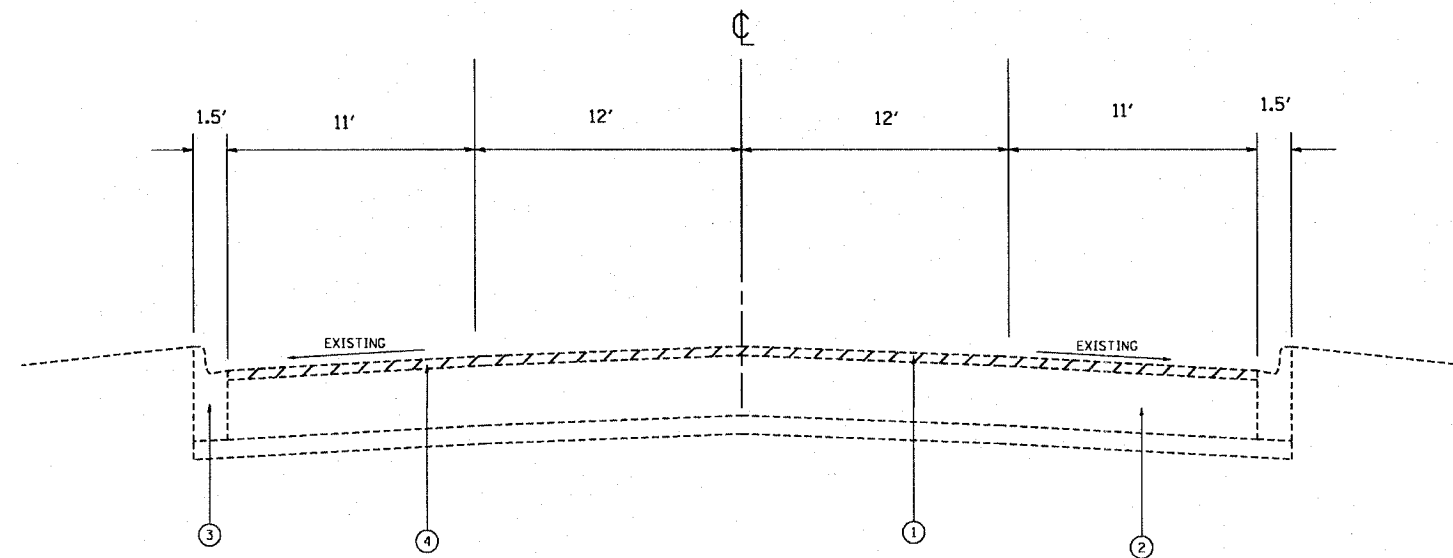

EXISTING
STA 56+60 TO STA 85+46

LEGEND

- ① EXISTING HMA OVERLAY (VARIES FROM 1½" - 3")
 - ② EXISTING PCC PAVEMENT (10")
 - ③ EXISTING CONCRETE CURB AND GUTTER, TYPE B-6.12
 - ④ PROPOSED HMA SURFACE REMOVAL, 2½"
 - ⑤ PROPOSED HMA SURFACE COURSE, MIX "D", N70 (1½")
 - ⑥ PROPOSED POLYMERIZED LEVELING BINDER (MACHINE METHOD), IL-4.75, N50 (1")
 - ⑦ PROPOSED CONCRETE CURB AND GUTTER, TYPE B-6.12
- LOCATIONS TO BE DETERMINED BY THE ENGINEER

CUMBERLAND AVE.

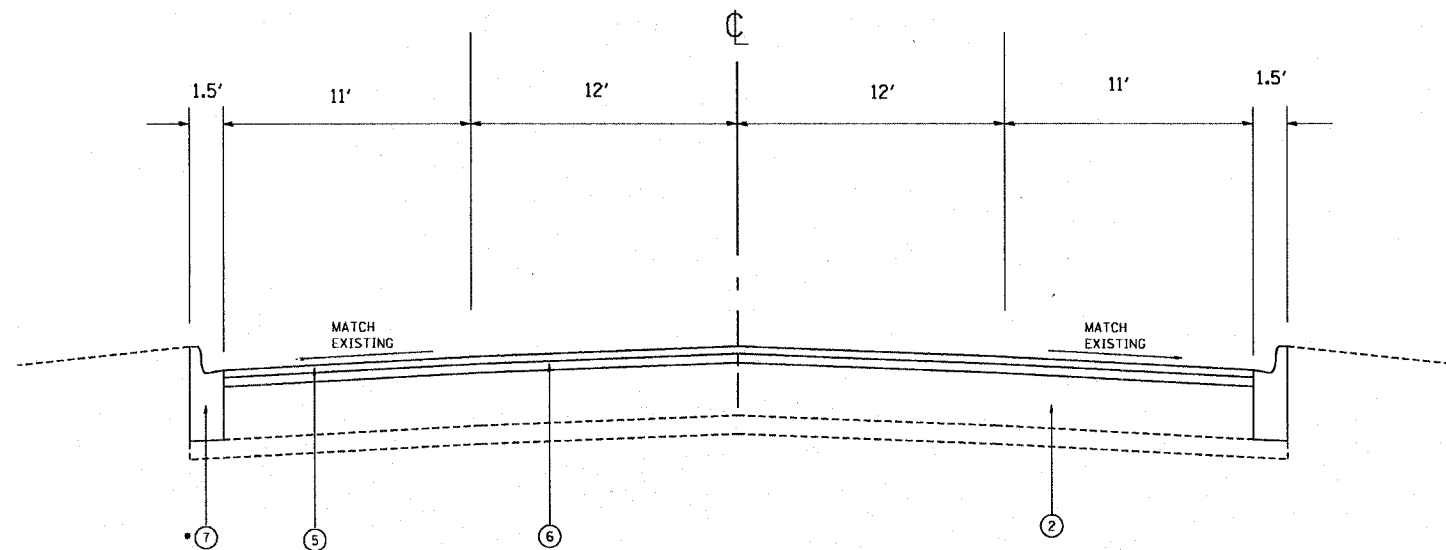

PROPOSED
STA 56+60 TO STA 85+46

FILE NAME = c:\projects\103\103\design\ee.dgn	USER NAME = euky	DESIGNED -	REVISED -	STATE OF ILLINOIS DEPARTMENT OF TRANSPORTATION	CUMBERLAND AVE. EXISTING AND PROPOSED TYPICAL SECTIONS		F.A.U. RTE. 2746	SECTION 3215A-RS	COUNTY COOK	TOTAL SHEETS 27	SHEET NO. 8
	PLOT SCALE = 103:8.461' / IN.	DRAWN -	REVISED -				CONTRACT NO. 60559				
PLOT DATE = 6/13/2008	CHECKED -	REVISED -	SCALE:		SHEET NO. OF SHEETS	STA. TO STA.	FED. ROAD DIST. NO. 1 ILLINOIS FED. AID PROJECT				
	DATE -	REVISED -									

CUMBERLAND AVE.

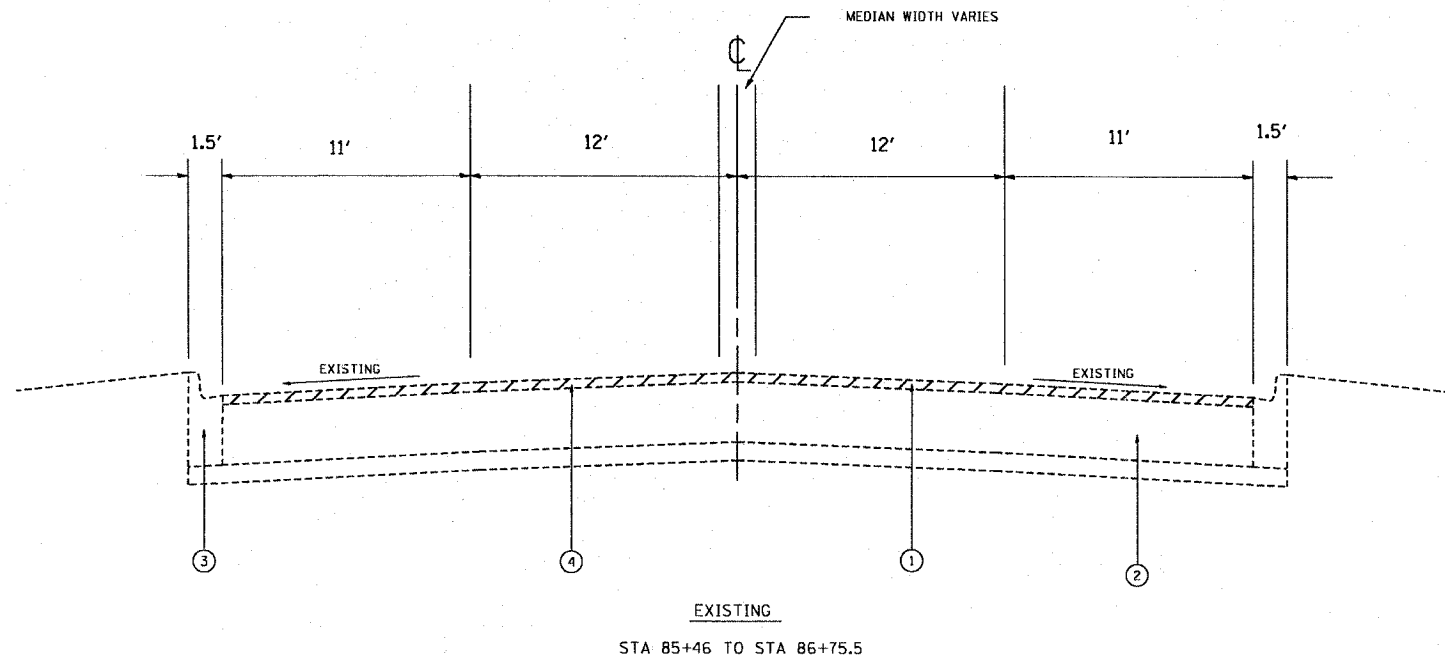

LEGEND

- ① EXISTING HMA OVERLAY (VARIES FROM 1½" - 3")
 - ② EXISTING PCC PAVEMENT (10 ")
 - ③ EXISTING CONCRETE CURB AND GUTTER, TYPE B-6.12
 - ④ PROPOSED HMA SURFACE REMOVAL, 2½"
 - ⑤ PROPOSED HMA SURFACE COURSE, MIX "D", N70 (1½")
 - ⑥ PROPOSED POLYMERIZED LEVELING BINDER (MACHINE METHOD), IL-4.75, N50 (1")
 - ⑦ PROPOSED CONCRETE CURB AND GUTTER, TYPE B-6.12
- LOCATIONS TO BE DETERMINED BY THE ENGINEER

CUMBERLAND AVE.

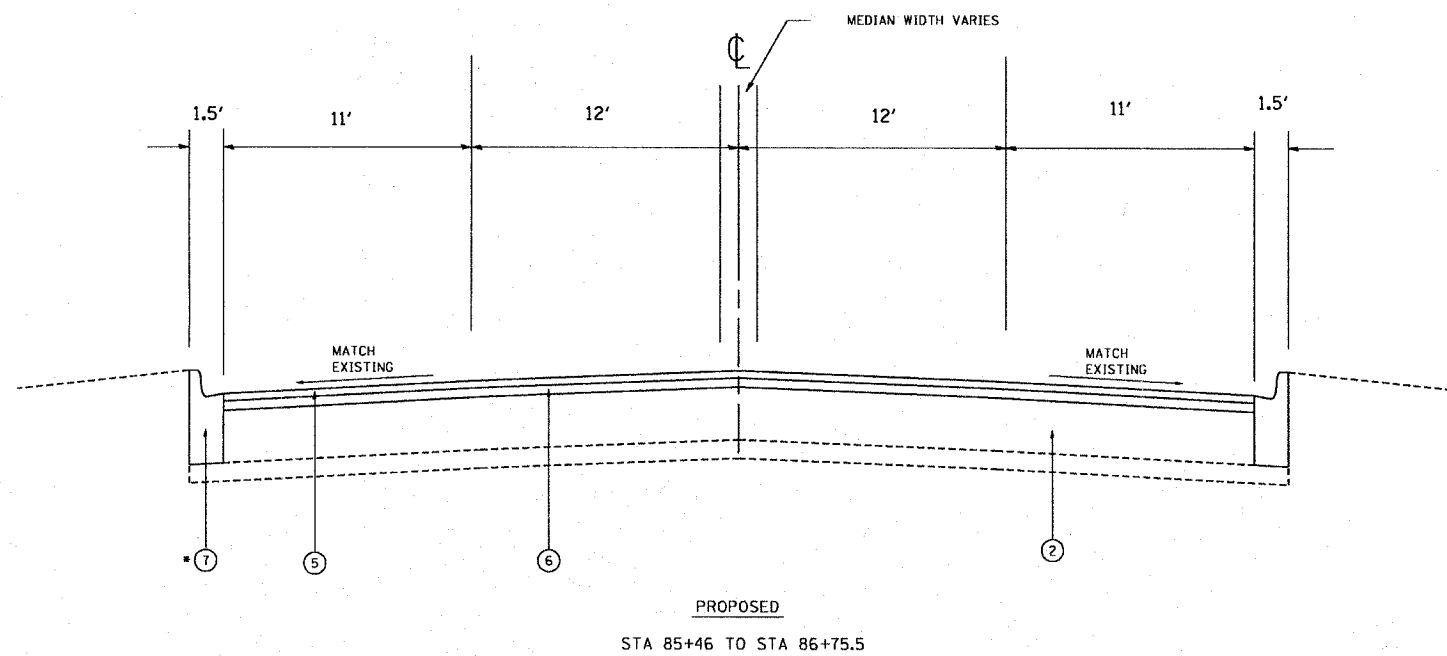

FILE NAME = c:\projects\dl09498\design_ee.dgn	USER NAME = euky	DESIGNED -	REVISED -	STATE OF ILLINOIS DEPARTMENT OF TRANSPORTATION	CUMBERLAND AVE. EXISTING AND PROPOSED TYPICAL SECTIONS	F.A.U. RTE. 2746	SECTION 3215A-RS	COUNTY COOK	TOTAL SHEETS 27	SHEET NO. 9
	PLOT SCALE = 1/8" = 1' / IN.	CHECKED -	REVISED -			CONTRACT NO.				
	PLOT DATE = 6/13/2008	DATE -	REVISED -			FED. ROAD DIST. NO. 1 ILLINOIS FED. AID PROJECT				
					SCALE:	SHEET NO. OF SHEETS		STA. TO STA.		

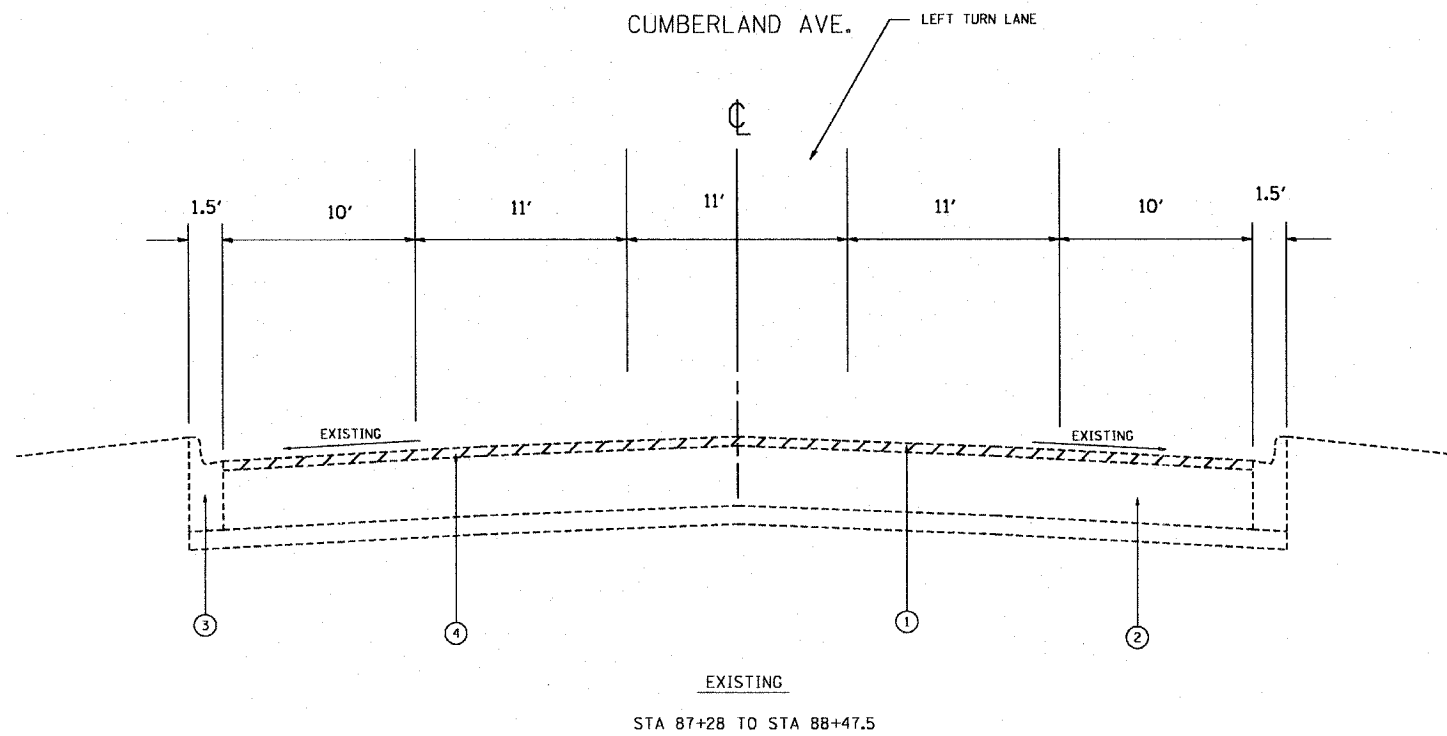

- LEGEND**
- ① EXISTING HMA OVERLAY (VARIES FROM 1½" - 3")
 - ② EXISTING PCC PAVEMENT (10")
 - ③ EXISTING CONCRETE CURB AND GUTTER, TYPE B-6.12
 - ④ PROPOSED HMA SURFACE REMOVAL, 2½"
 - ⑤ PROPOSED HMA SURFACE COURSE, MIX "D", N70 (1½")
 - ⑥ PROPOSED POLYMERIZED LEVELING BINDER (MACHINE METHOD), IL-4.75, N50 (1")
 - ⑦ PROPOSED CONCRETE CURB AND GUTTER, TYPE B-6.12
- LOCATIONS TO BE DETERMINED BY THE ENGINEER

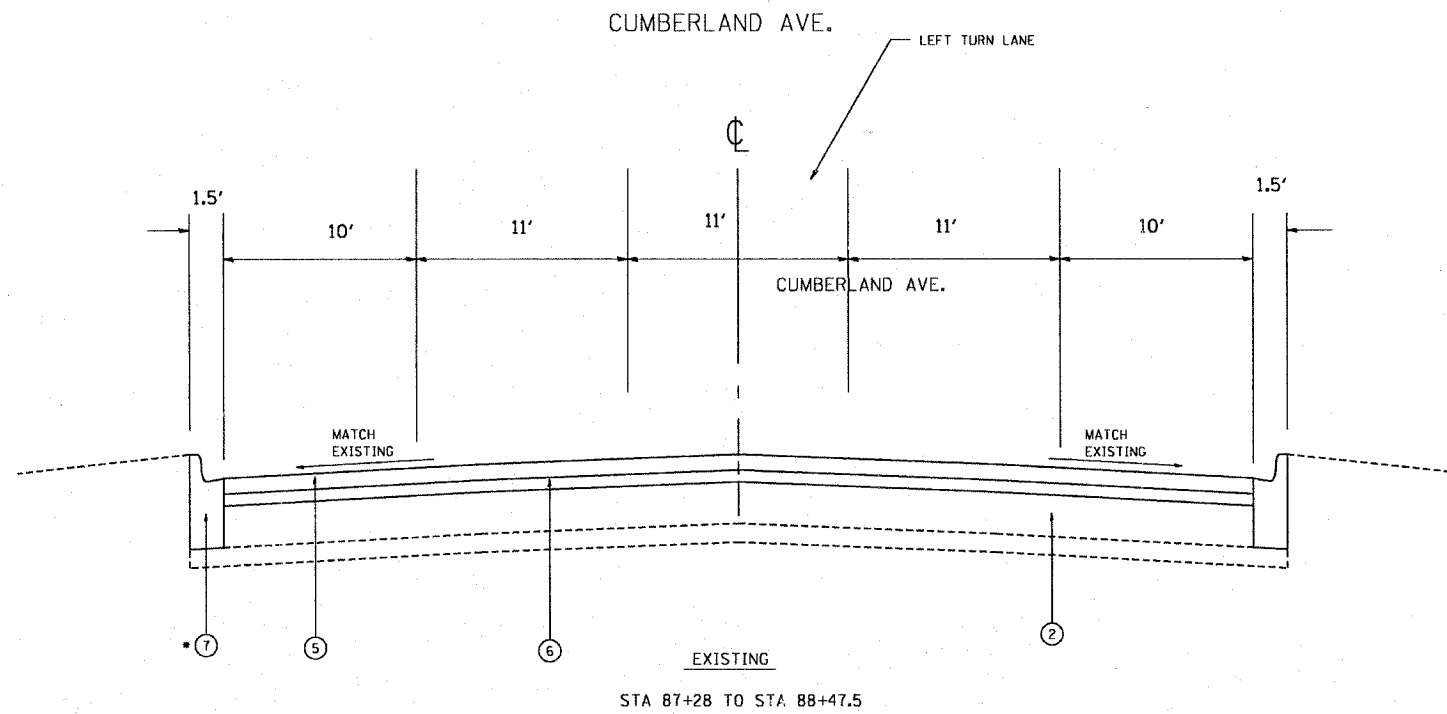

FILE NAME = c:\projects\109498\design\...dgn	USER NAME = aukj	DESIGNED -	REVISED -	STATE OF ILLINOIS DEPARTMENT OF TRANSPORTATION	CUMBERLAND AVE. EXISTING AND PROPOSED TYPICAL SECTIONS	F.A.U. RTE.	SECTION	COUNTY	TOTAL SHEETS	SHEET NO.
	PLOT SCALE = 1038.461' / IN.	DRAWN -	REVISED -			2746	3215A-RS	COOK	27	10
PLOT DATE = 6/13/2008	CHECKED -	REVISOR -	DATE -	SCALE:	SHEET NO. OF SHEETS	STA. TO STA.	FED. ROAD DIST. NO. 1 ILLINOIS FED. AID PROJECT			
							CONTRACT NO. 60559			

CUMBERLAND AVE.

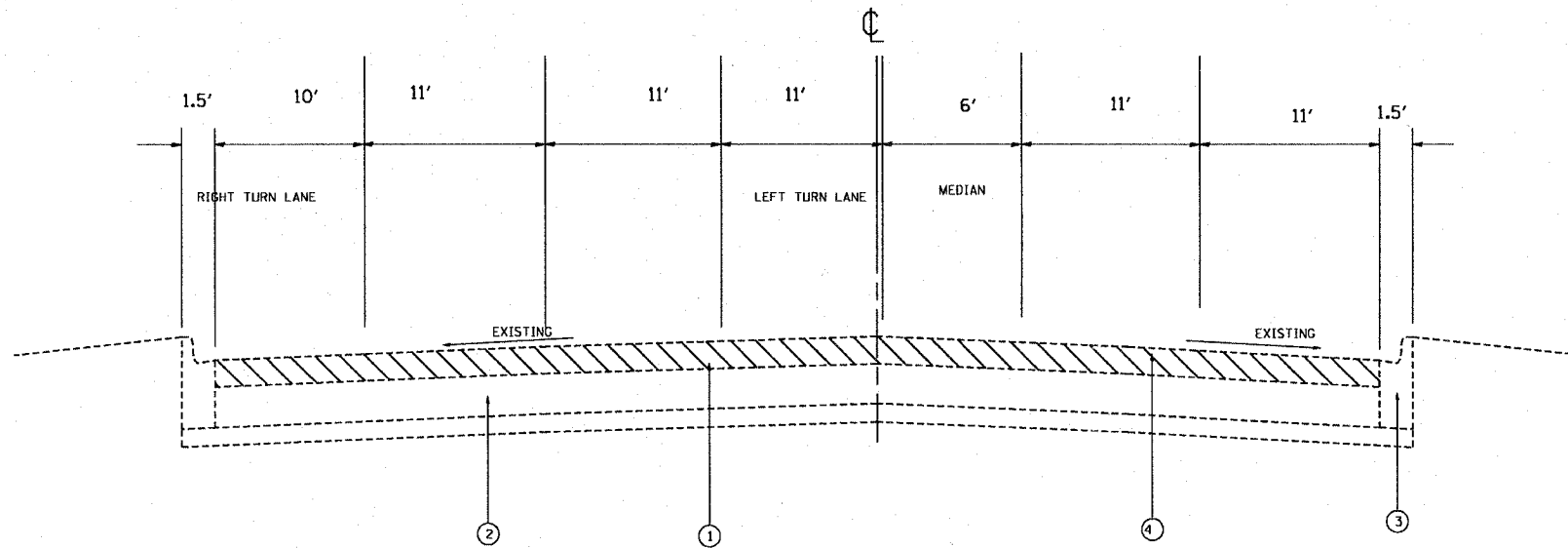

EXISTING
STA 88+47.5 TO STA 90+04

LEGEND

- ① EXISTING HMA OVERLAY (VARIES FROM 1/2" - 3")
 - ② EXISTING PCC PAVEMENT (10")
 - ③ EXISTING CONCRETE CURB AND GUTTER, TYPE B-6.12
 - ④ PROPOSED HMA SURFACE REMOVAL, 2 1/2"
 - ⑤ PROPOSED HMA SURFACE COURSE, MIX "D", N70 (1 1/2")
 - ⑥ PROPOSED POLYMERIZED LEVELING BINDER (MACHINE METHOD), IL-4.75, N50 (1")
 - ⑦ PROPOSED CONCRETE CURB AND GUTTER, TYPE B-6.12
- LOCATIONS TO BE DETERMINED BY THE ENGINEER

CUMBERLAND AVE.

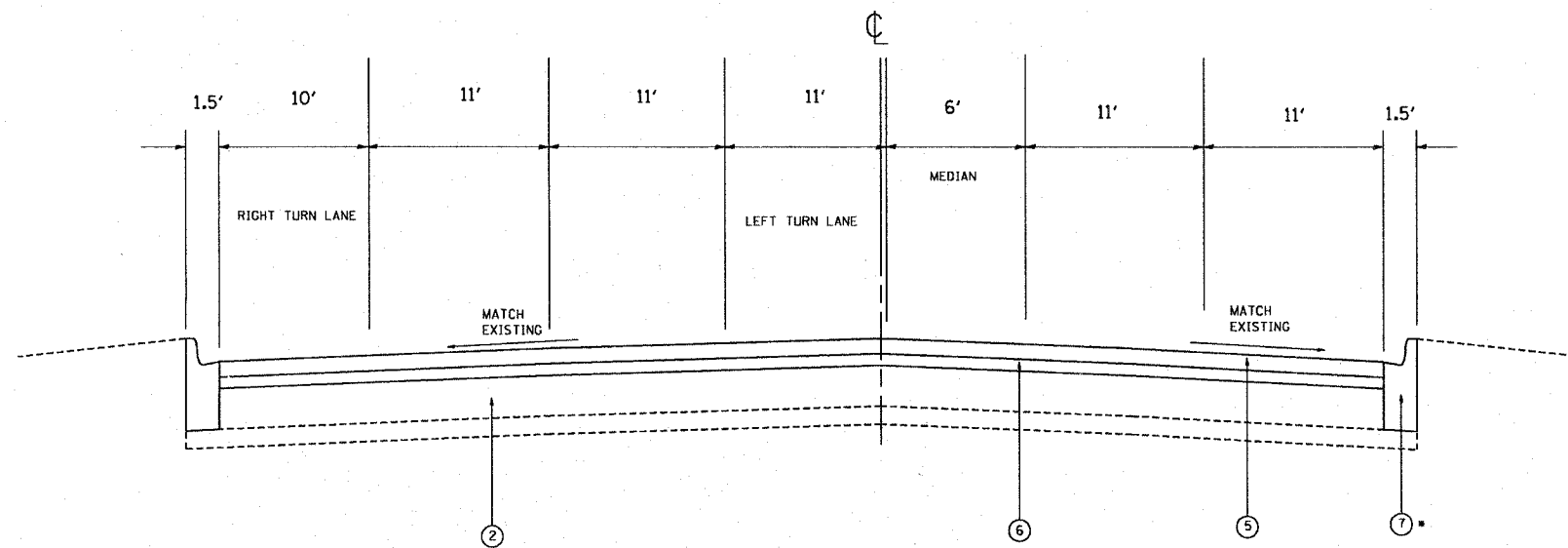

PROPOSED
STA 88+47.5 TO STA 90+04

FILE NAME =	USER NAME = aury	DESIGNED -	REVISED -	STATE OF ILLINOIS DEPARTMENT OF TRANSPORTATION	F.A.U. RTE.	SECTION	COUNTY	TOTAL SHEETS	SHEET NO.	
c:\projects\dl03498\design.oe.dgn		DRAWN -	REVISED -		2746	3215A-RS	COOK	27	11	
PLOT SCALE = 1/8" = 1' / IN.		CHECKED -	REVISED -		CONTRACT NO. 60559					
PLOT DATE = 6/13/2008		DATE -	REVISED -		FED. ROAD DIST. NO. 1 ILLINOIS FED. AID PROJECT					
					SCALE:	SHEET NO.	OF	SHEETS	STA.	TO STA.

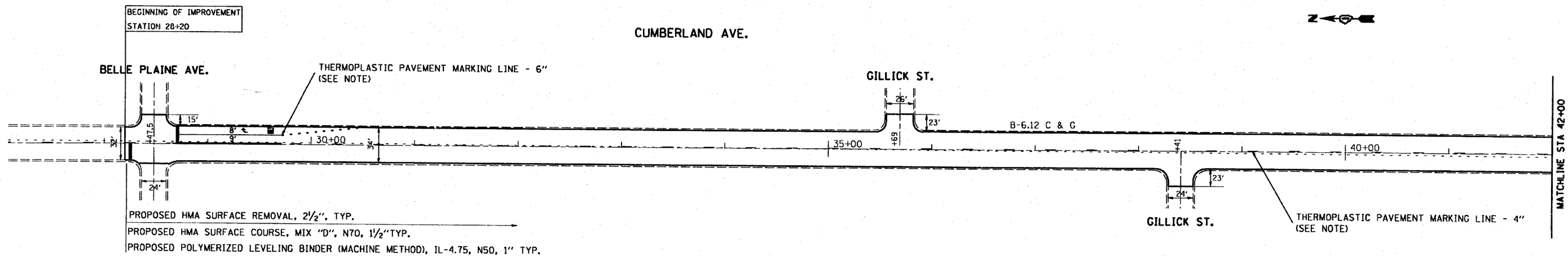

NOTE:
 PERMANENT PAVEMENT MARKING SHALL BE THERMOPLASTIC (OF THE EXTRUDED TYPE) AND SHOULD BE PLACED IN ACCORDANCE WITH "DISTRICT ONE TYPICAL PAVEMENT MARKING DETAILS"
 RAISED REFLECTIVE PAVEMENT MARKERS SHALL BE IN ACCORDANCE WITH THE DISTRICT ONE "TYPICAL APPLICATION RAISED REFLECTIVE PAVEMENT MARKERS DETAILS"

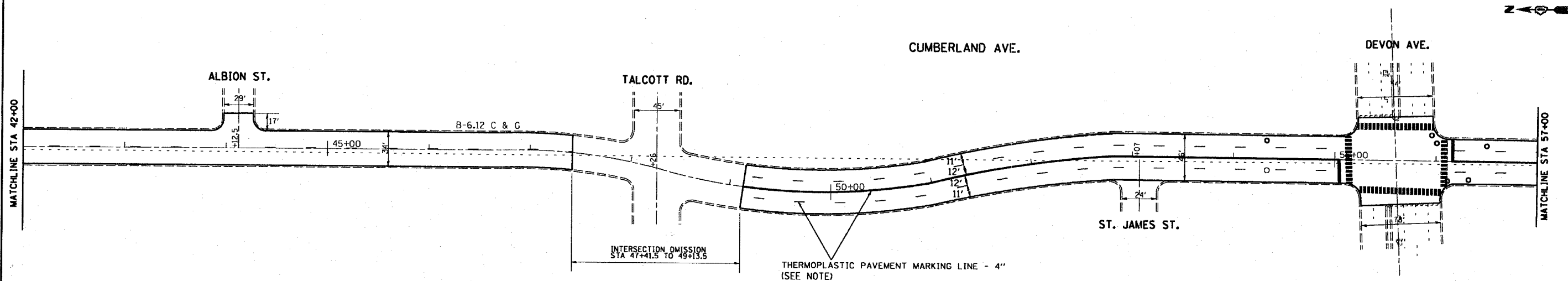

FILE NAME =
 c:\proj\joc\ta\dl\03498\design_ee.dgn

USER NAME = ouky

DESIGNED -
 DRAWN -

REVISED -
 REVISED -
 REVISED -
 REVISED -

PLOT SCALE = 10380.461 1/2" / IN.
 PLOT DATE = 6/13/2008

CHECKED -
 DATE -

STATE OF ILLINOIS
 DEPARTMENT OF TRANSPORTATION

CUMBERLAND AVE.
 EXISTING AND PROPOSED ROADWAY PLANS

F.A.U. RTE. 2746	SECTION 3215 A-RS	COUNTY COOK	TOTAL SHEETS 27	SHEET NO. 12
---------------------	----------------------	----------------	--------------------	-----------------

SCALE: 1"=50' SHEET NO. OF SHEETS STA. TO STA.

CONTRACT NO. 60559
 FED. ROAD DIST. NO. 1 ILLINOIS FED. AID PROJECT

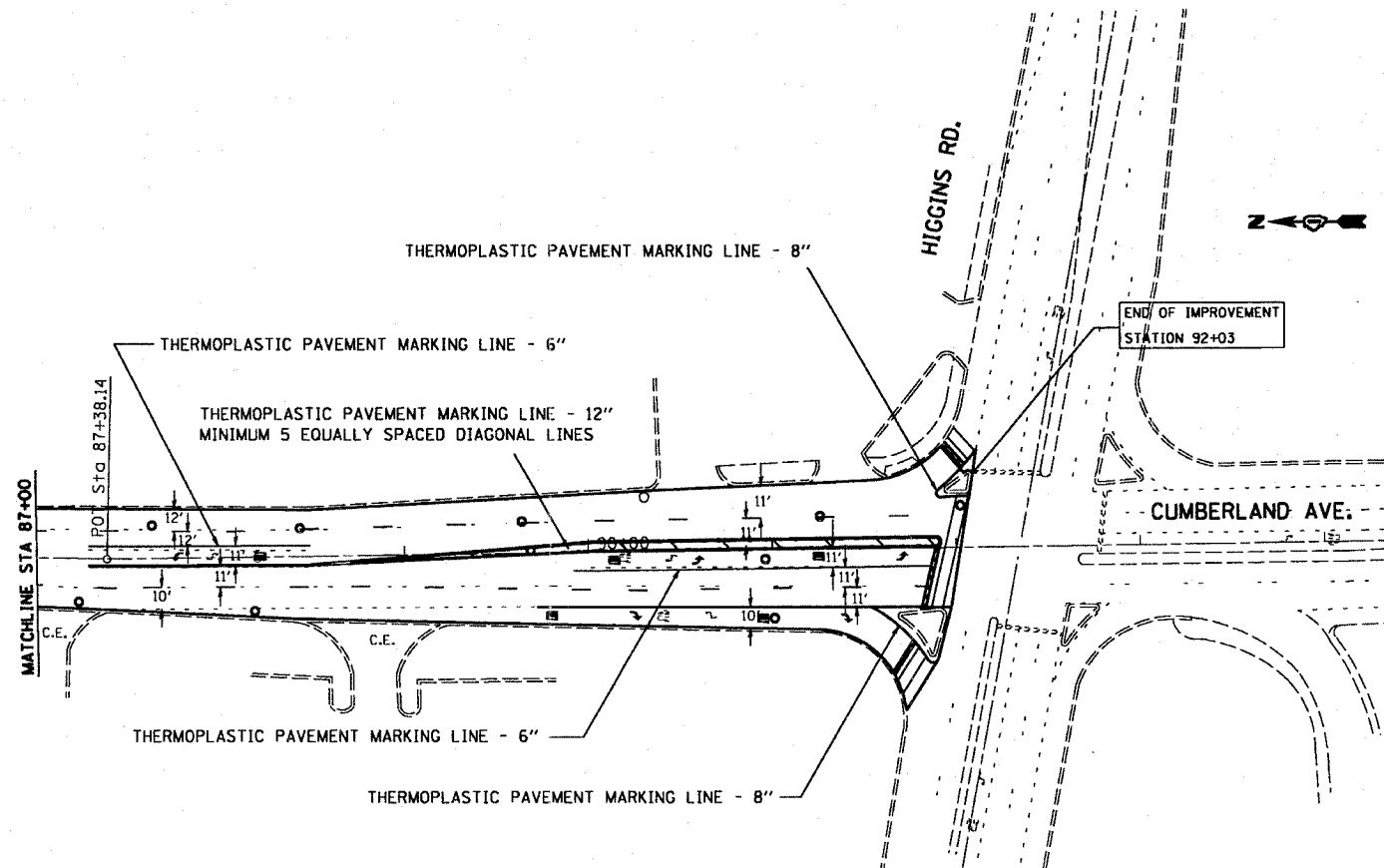

NOTE:

PERMANENT PAVEMENT MARKING SHALL BE THERMOPLASTIC (OF THE EXTRUDED TYPE) AND SHOULD BE PLACED IN ACCORDANCE WITH "DISTRICT ONE TYPICAL PAVEMENT MARKING DETAILS"

RAISED REFLECTIVE PAVEMENT MARKERS SHALL BE IN ACCORDANCE WITH THE DISTRICT ONE "TYPICAL APPLICATION RAISED REFLECTIVE PAVEMENT MARKERS DETAILS"

FILE NAME = c:\projects\dl09498\design_00.dgn	USER NAME = auky	DESIGNED -	REVISED -	STATE OF ILLINOIS DEPARTMENT OF TRANSPORTATION	CUMBERLAND AVE. EXISTING AND PROPOSED ROADWAY PLANS			F.A.U. RTE.	SECTION	COUNTY	TOTAL SHEETS	SHEET NO.
	PLOT SCALE = 1038.461' / IN.	CHECKED -	REVISED -		2746	3215A-RS	COOK	27	14			
PLOT DATE = 5/12/2008	DATE -	REVISED -	REVISED -		SCALE: 1"=50'	SHEET NO. OF SHEETS	STA. TO STA.	FED. ROAD DIST. NO. 1 ILLINOIS FED. AID PROJECT				
							CONTRACT NO. 60559					

STATE	SECTION	COUNTY	TOTAL SHEETS	SHEET NO.
		COOK		15
STA.		TO STA.		
FED. ROAD DIST. NO. 7		ILLINOIS		FED. AID PROJECT

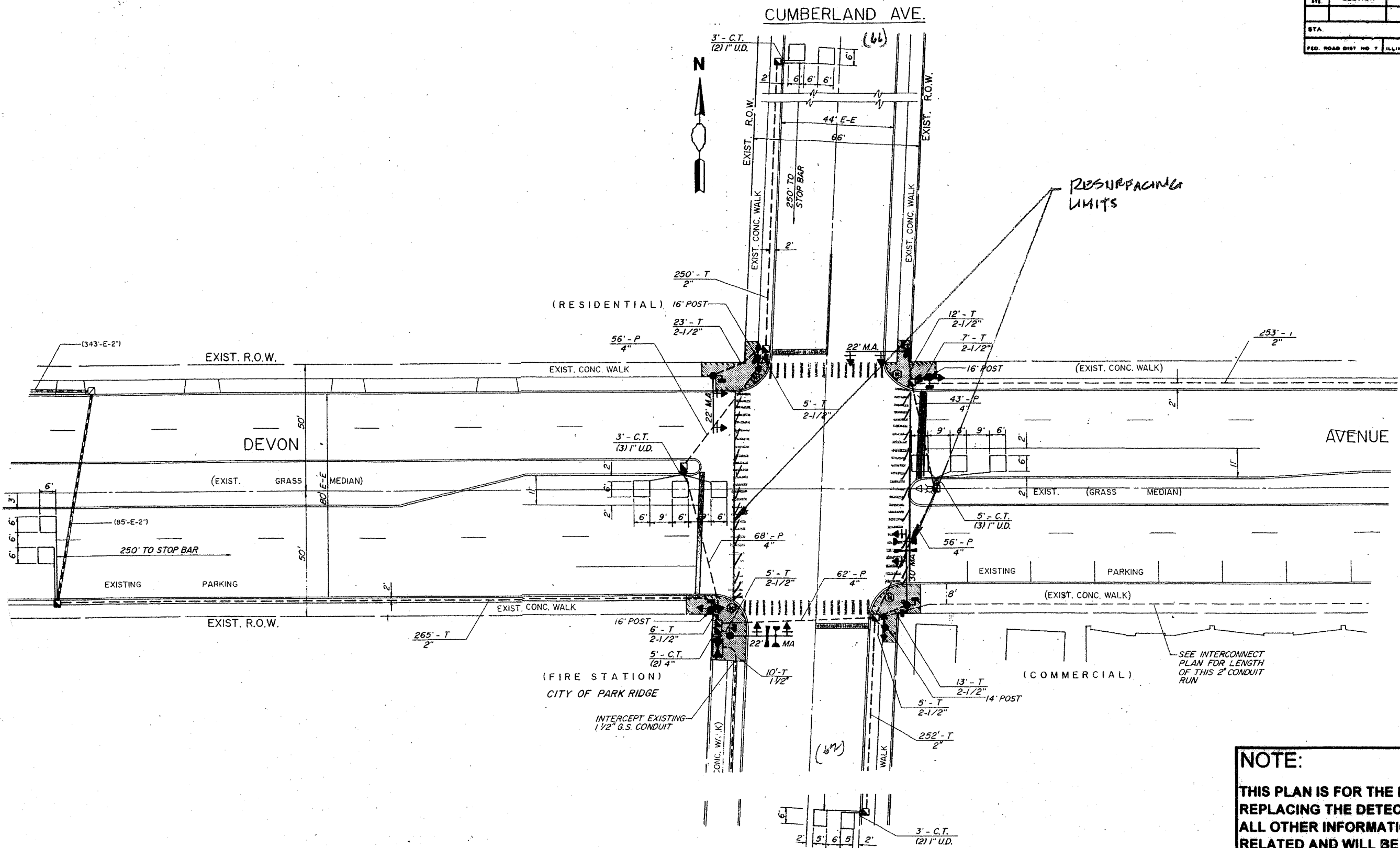

REPLACE ALL DETECTOR LOOPS AS SHOWN
(WITHIN THE RESURFACING LIMITS)

CODE NO.	QUANTITY	UNIT	ITEM
86600600	128	Foot	Detector Loop Replacement

REVISIONS	
NAME	DATE

NOTE:
THIS PLAN IS FOR THE PURPOSE OF REPLACING THE DETECTOR LOOPS ONLY. ALL OTHER INFORMATION SHOWN IS NOT RELATED AND WILL BE DISREGARDED.

ILLINOIS DEPARTMENT OF TRANSPORTATION
DETECTOR LOOP REPLACEMENT
CUMBERLAND AV. @ DEVON AV.
SCALE: *AS SHOWN*
DATE: *APRIL 2008*
DRAWN BY: JHE
DESIGNED BY: JHE
CHECKED BY: DAD.

F. & S. NO.	SECTION	COUNTY	TOTAL SHEETS	SHEET NO.
		COOK		16
STA.		TO STA.		
FED. ROAD DIST. NO. 7		ILLINOIS		FED. AID PROJECT

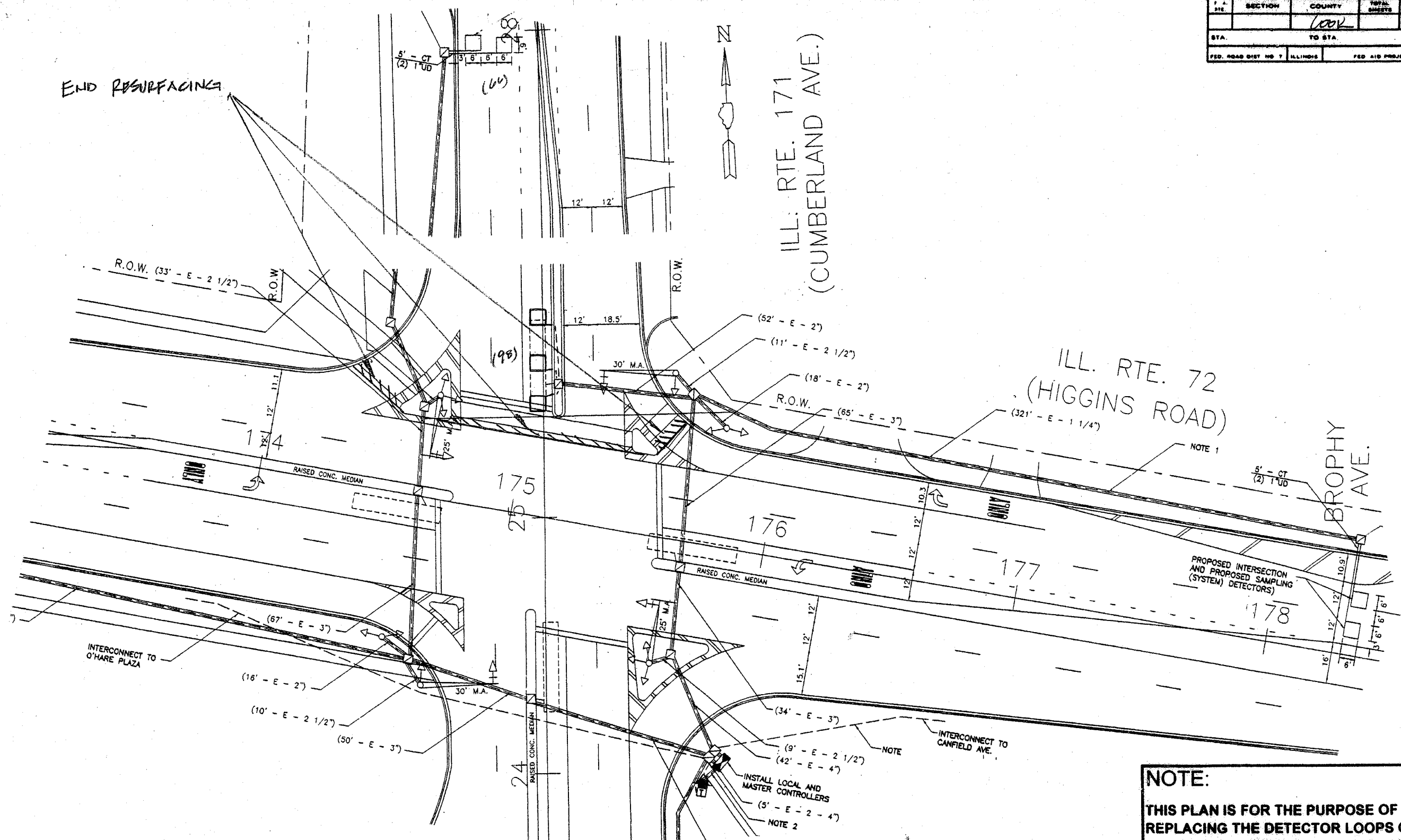

END RESURFACING

ILL. RTE. 171
(CUMBERLAND AVE.)

ILL. RTE. 72
(HIGGINS ROAD)

BROPHY AVE.

NOTE:
THIS PLAN IS FOR THE PURPOSE OF REPLACING THE DETECTOR LOOPS ONLY. ALL OTHER INFORMATION SHOWN IS NOT RELATED AND WILL BE DISREGARDED.

REPLACE ALL DETECTOR LOOPS AS SHOWN
(WITHIN THE RESURFACING LIMITS)

CODE NO.	QUANTITY	UNIT	ITEM
86600600	164	Foot	Detector Loop Replacement

REVISIONS	
NAME	DATE

ILLINOIS DEPARTMENT OF TRANSPORTATION
DETECTOR LOOP REPLACEMENT
CUMBERLAND AV @ ILL. RTE. 72
SCALE: NONE
DATE: APRIL 2008
DRAWN BY: JHE
DESIGNED BY: JHE
CHECKED BY: DAD

SECTION	COUNTY	TOTAL SHEETS	SHEET NO.
	Cook		17
STA.	TO STA.		
FED. ROAD DIST. NO. 7	ILLINOIS	FED. AID PROJECT	

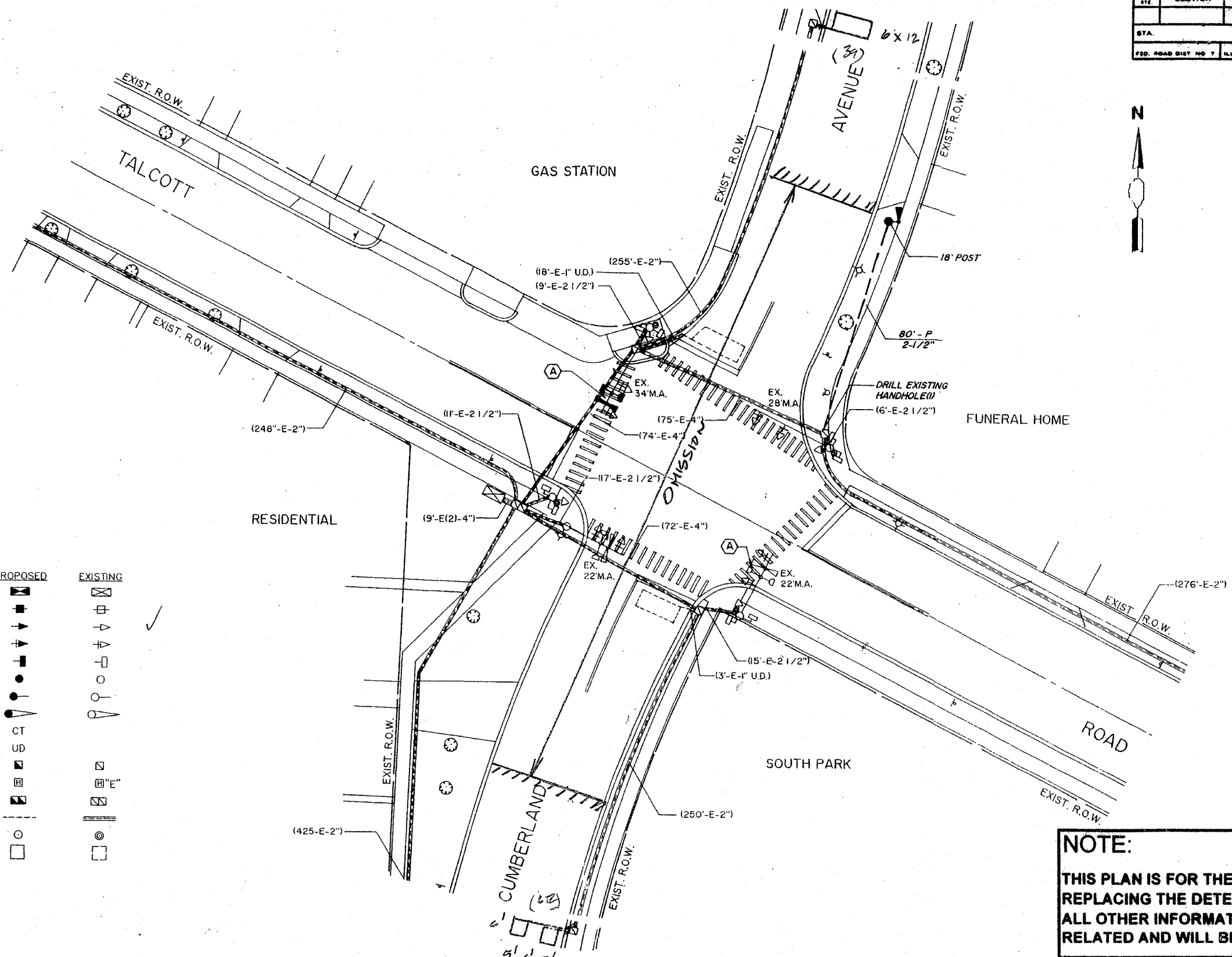

TRAFFIC SIGNAL LEGEND

- CONTROLLER
- SERVICE INSTALLATION
- SIGNAL HEAD AND POST
- SIGNAL HEAD AND BACKPLATE
- SIGNAL HEAD, PEDESTRIAN
- SIGNAL POST
- MAST ARM ASSEMBLY AND POLE, STEEL
- MAST ARM ASSEMBLY AND POLE, ALUMINUM
- COMMON TRENCH
- UNIT DUCT
- HANDHOLE
- HEAVY DUTY HANDHOLE
- DOUBLE HANDHOLE
- GALVANIZED STEEL CONDUIT IN TRENCH OR PUSHED
- PEDESTRIAN PUSHBUTTON DETECTOR
- DETECTOR LOOP

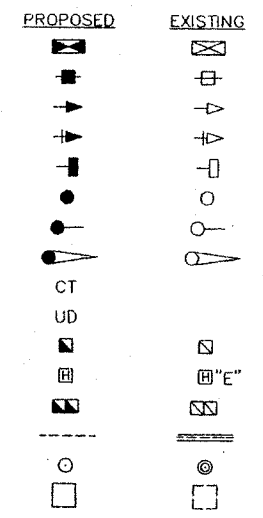

REPLACE ALL DETECTOR LOOPS AS SHOWN
(WITHIN THE RESURFACING LIMITS)

CODE NO.	QUANTITY	UNIT	ITEM
86600600	101	Foot	Detector Loop Replacement

REVISIONS	
NAME	DATE

NOTE:
THIS PLAN IS FOR THE PURPOSE OF REPLACING THE DETECTOR LOOPS ONLY. ALL OTHER INFORMATION SHOWN IS NOT RELATED AND WILL BE DISREGARDED.

ILLINOIS DEPARTMENT OF TRANSPORTATION
DETECTOR LOOP REPLACEMENT
CUMBERLAND AV. @ TALCOTT RD.
SCALE: NONE
DATE: APRIL 2008
DRAWN BY: J.H.E.
DESIGNED BY: J.H.E.
CHECKED BY: D.A.D.

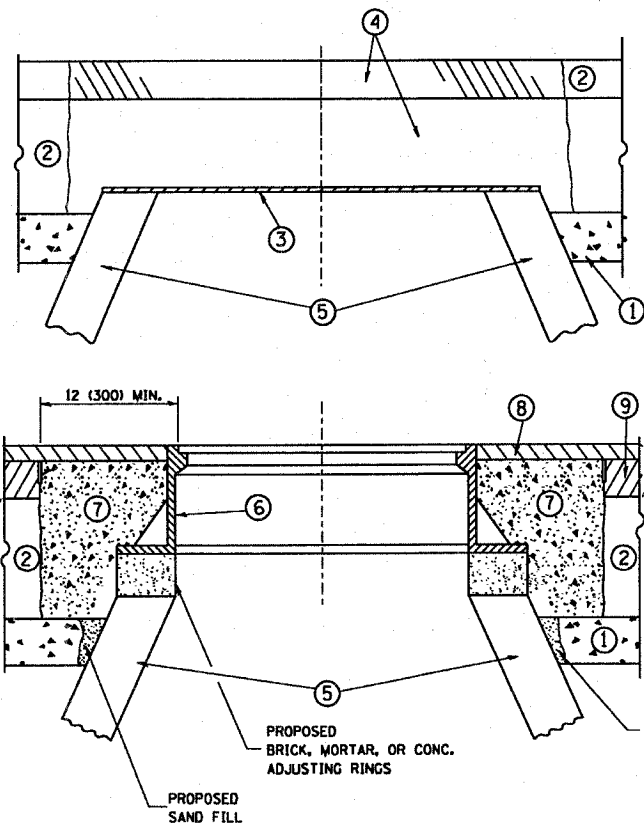

CONSTRUCTION PROCEDURES

STAGE 1 (BEFORE PAVEMENT MILLING)

- A) REMOVE A MINIMUM OF 12 (300) OF THE PAVEMENT FROM AROUND THE STRUCTURE.
- B) REMOVE THE EXISTING FRAME AND LID FROM THE STRUCTURE.
- C) COVER THE STRUCTURE OPENING WITH A 36 (900) DIAMETER METAL PLATE.
- D) BACKFILL WITH CRUSHED STONE AND A MINIMUM 1 1/2 (40) THICK HMA SURFACE MIX APPROVED BY THE ENGINEER.

STAGE 2 (AFTER PAVEMENT MILLING)

- A) REMOVE THE HMA SURFACE MIX AND CRUSHED STONE.
- B) INSTALL THE FRAME AND LID; ADJUST THE FRAME TO ITS FINAL SURFACE ELEVATION.
- C) THE SURROUNDING SPACE SHALL BE FILLED WITH CLASS S1 CONCRETE, OR HMA SURFACE COURSE OR HMA BINDER COURSE TO THE ELEVATION OF THE SURFACE OF THE EXISTING BASE COURSE OR THE BINDER COURSE.

THE PROCEDURE EXPLAINED ABOVE SHALL CONFORM TO THE APPLICABLE PORTIONS OF SECTIONS 353, 406, 602, AND 603 OF THE STANDARD SPECIFICATIONS.

LEGEND

- ① SUB-BASE GRANULAR MATERIAL
- ② EXISTING PAVEMENT
- ③ 36 (900) DIAMETER METAL PLATE
- ④ PROPOSED CRUSHED STONE AND HMA SURFACE MIX
- ⑤ EXISTING STRUCTURE
- ⑥ FRAME AND LID (SEE NOTES)
- ⑦ CLASS S1 CONCRETE, HMA SURFACE COURSE OR HMA BINDER COURSE
- ⑧ PROPOSED HMA SURFACE COURSE
- ⑨ PROPOSED HMA BINDER COURSE

NOTES:

EXISTING BROKEN FRAMES AND LIDS SHALL BE REMOVED AND DISPOSED OF BY THE CONTRACTOR AND SHALL BE REPLACED AS DIRECTED BY THE ENGINEER. REPLACEMENT FRAMES AND LIDS WILL BE PAID FOR IN ACCORDANCE WITH ARTICLE 109.04 OF THE STANDARD SPECIFICATIONS UNLESS A SEPARATE PAY ITEM HAS BEEN PROVIDED.

IF THE EXISTING LIDS ARE OPEN, THE FRAME WILL BE ADJUSTED TO THE ELEVATION OF THE MILLED PAVEMENT SURFACE PRIOR TO THE MILLING OPERATION. THE FRAME WILL NOT BE REMOVED AND COVERED BY THE METAL PLATE.

CITY OF CHICAGO CASTINGS ARE THE PROPERTY OF THE CITY AND THE CONTRACTOR SHALL NOTIFY THE CITY FOR REMOVAL AND DISPOSITION OF THE CASTINGS.

THE METAL PLATE USED TO COVER THE STRUCTURE SHALL REMAIN THE PROPERTY OF THE CONTRACTOR.

WHEN STRUCTURES ARE TO BE ADJUSTED OR RECONSTRUCTED, THE LOWERING AND RAISING OF THE FRAMES AND LIDS WILL NOT BE PAID FOR SEPARATELY BUT WILL BE INCLUDED IN THE COST OF THE CORRESPONDING PAY ITEM.

LOCATION OF STRUCTURES:

THE CONTRACTOR WILL BE REQUIRED TO KEEP A RECORD OF THE LOCATIONS OF THE BURIED STRUCTURES ACCORDING TO THE STATION AND DISTANCE LEFT OR RIGHT OF THE CENTERLINE OF PAVEMENT. UPON COMPLETION OF THE WORK, THE CONTRACTOR WILL DELIVER THE RECORD TO THE ENGINEER.

BASIS OF PAYMENT: THIS WORK WILL BE PAID FOR AT THE CONTRACT UNIT PRICE PER EACH FOR "FRAMES AND LIDS TO BE ADJUSTED, SPECIAL" NEW FRAMES AND LIDS, WHEN SPECIFIED, WILL BE PAID FOR SEPARATELY.

DETAILS FOR FRAMES AND LIDS ADJUSTMENT WITH MILLING

ALL DIMENSIONS ARE IN INCHES (MILLIMETERS) UNLESS OTHERWISE SHOWN

FILE NAME = W:\diststd\22x34\bd88.dgn	USER NAME = geglienobt	DESIGNED - R. SHAH	REVISED - R. SHAH 03-10-95	STATE OF ILLINOIS DEPARTMENT OF TRANSPORTATION	DETAILS FOR FRAMES AND LIDS ADJUSTMENT WITH MILLING		F.A.U. RTE. 2746	SECTION 3215 A- RS	COUNTY COOK	TOTAL SHEETS 27	SHEET NO. 18
	PLOT SCALE = 50.0000' / IN.	CHECKED -	REVISED - R. WIEDEMAN 05-14-04		SCALE: NONE	SHEET NO. 1 OF 1 SHEETS	STA.	BD600-03 (BD-8)		CONTRACT NO. 60559	
	PLOT DATE = 1/4/2008	DATE - 10-25-94	REVISED - R. BORO 01-01-07				TO STA.	FED. ROAD DIST. NO. 1 ILLINOIS FED. AID PROJECT			

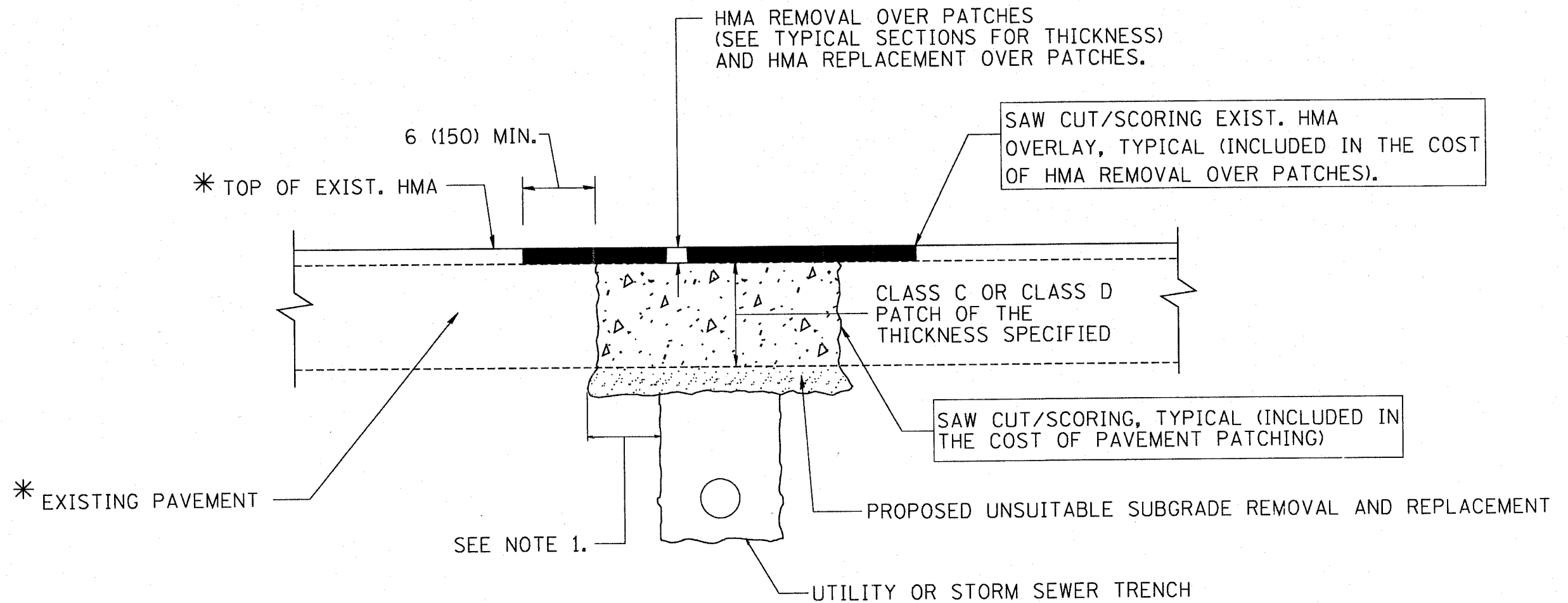

* SEE TYPICAL SECTIONS FOR
THICKNESS AND MATERIALS

NOTES:

1. THE WIDTH OF THE FULL DEPTH PATCH OVER A TRENCH SHALL BE 12 (300) WIDER ON EACH SIDE OF THE TRENCH.
2. FOR METHOD OF MEASUREMENT AND BASIS OF PAYMENT, SEE RECURRING SPECIAL PROVISION "PATCHING WITH HOT-MIX ASPHALT OVERLAY REMOVAL".

SEQUENCE OF CONSTRUCTION

1. REMOVE THE EXISTING HMA MATERIAL OVER THE AREA TO BE PATCHED.
2. REMOVE AND REPLACE FULL DEPTH PATCHES
3. REPLACE HMA MATERIAL OVER THE AREA TO BE PATCHED.

ALL DIMENSIONS ARE IN INCHES (MILLIMETERS) UNLESS OTHERWISE SHOWN.

FILE NAME = W:\state\22e34\bd22.dgn	USER NAME = geglianobt	DESIGNED - R. SHAH	REVISED - A. ABBAS 01-20-98	STATE OF ILLINOIS DEPARTMENT OF TRANSPORTATION	PAVEMENT PATCHING FOR HMA SURFACED PAVEMENT			F.A.U. RTE. 2746	SECTION 3215 A-RS	COUNTY COOK	TOTAL SHEETS 27	SHEET NO. 19
		DRAWN -	REVISED - A. ABBAS 04-27-98		SCALE: NONE	SHEET NO. 1	OF 1	SHEETS	STA.	TO STA.	CONTRACT NO. 60559	
		PLOT SCALE = 58.000' / IN.	REVISED - R. BORO 01-01-07		FED. ROAD DIST. NO. 1 ILLINOIS FED. AID PROJECT							
		PLOT DATE = 1/4/2008	DATE - 10-25-94		REVISED - R. BORO 09-04-07							

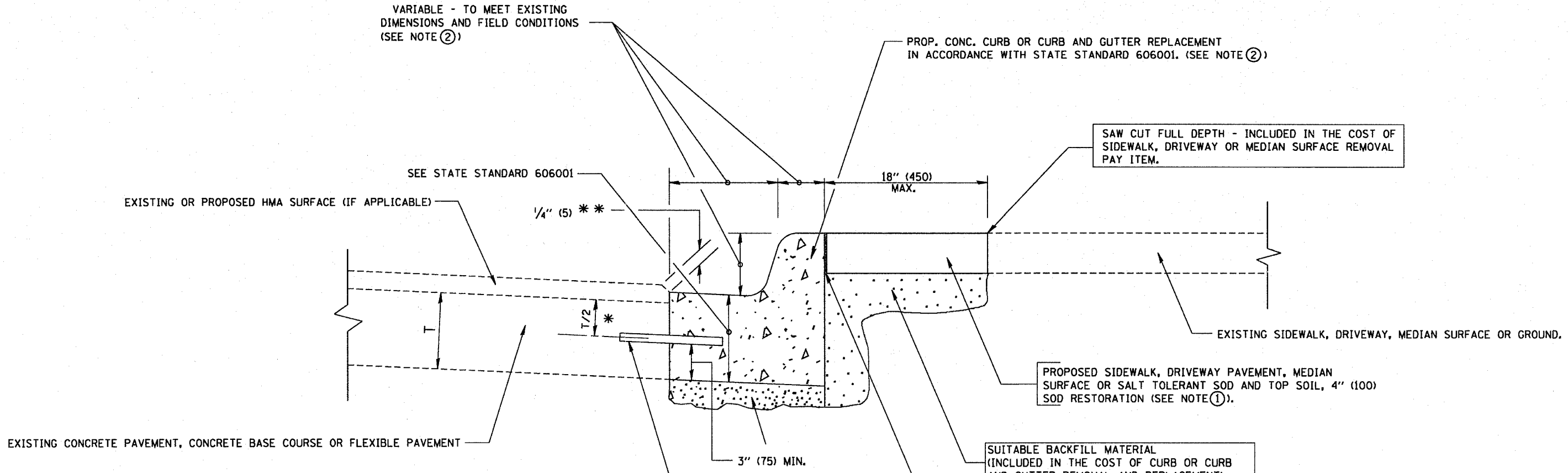

* 3" (75) MINIMUM FROM TOP AND BOTTOM OF THE CONCRETE PAVEMENT OR BASE COURSE.

** IF THE FINAL SURFACE OF THE PAVEMENT IS CONCRETE, THE GUTTER IS TO BE FLUSH WITH THE PAVEMENT.

NOTE: ① SIDEWALK, DRIVEWAY PAVEMENT OR MEDIAN SURFACE SHALL BE SIMILAR TO THE MATERIAL BEING REMOVED AND WILL BE PAID FOR SEPARATELY.

SALT TOLERANT SOD AND TOP SOIL, 4" (100) RESTORATION WILL NOT BE PAID FOR SEPARATELY, BUT SHALL BE INCLUDED IN THE COST OF CURB OR CURB AND GUTTER REMOVAL AND REPLACEMENT.

- ② CURB OR CURB AND GUTTER REPLACEMENT SHALL MATCH THE SHAPE OF THE EXISTING CURB OR CURB AND GUTTER UNLESS OTHERWISE SPECIFIED.
- ③ FOR CURB OR CURB AND GUTTER REMOVAL AND REPLACEMENT ADJACENT TO FLEXIBLE PAVEMENT DELETE EPOXY COATED TIE BARS.
- ④ LONGITUDINAL BARS, IF ENCOUNTERED IN THE EXISTING CURB OR CURB AND GUTTER, ARE NOT TO BE REPLACED. CUTTING AND REMOVING LONGITUDINAL BARS SHALL BE INCLUDED IN THE COST OF CURB OR CURB AND GUTTER REMOVAL AND REPLACEMENT.
- ⑤ THE COST OF HMA SURFACE REMOVAL IN THE EXISTING GUTTER FLAG SHALL BE INCLUDED IN THE COST OF THE CURB AND GUTTER REMOVAL AND REPLACEMENT.
- ⑥ THE REMOVAL AND REPLACEMENT OF THE EXISTING CURB OR CURB AND GUTTER SHALL BE DONE IN ACCORDANCE WITH THE APPLICABLE PORTIONS OF SECTION 440 AND 606 OF THE STANDARD SPECIFICATIONS.
- ⑦ THE LOCATIONS OF REMOVAL AND REPLACEMENT OF EXISTING CURB OR CURB AND GUTTER SHALL BE DETERMINED BY THE RESIDENT ENGINEER AT THE TIME OF CONSTRUCTION.

UNSUITABLE SUB-BASE MATERIAL TO BE REMOVED, IF DIRECTED BY THE ENGINEER, SHALL BE REPLACED WITH EITHER SUB-BASE GRANULAR MATERIAL, TYPE B OR ADDITIONAL THICKNESS OF CONCRETE.

REMOVAL AND REPLACEMENT 4" (100) OR LESS IS INCLUDED IN THE COST OF CURB OR CURB AND GUTTER REMOVAL AND REPLACEMENT.

REMOVAL AND REPLACEMENT IN EXCESS OF 4" (100) WILL BE PAID FOR IN ACCORDANCE WITH ARTICLE 109.04 OF THE STANDARD SPECIFICATIONS.

PROPOSED #6 (20) EPOXY COATED TIE BARS 24" (600) LONG AT 24" (600) CENTERS WILL NOT BE PAID FOR SEPARATELY. DELETE EPOXY COATED TIE BARS IF EXISTING TIE BARS ARE USABLE AS DETERMINED BY THE ENGINEER. (SEE NOTE ③).

BASIS OF PAYMENT:
THIS WORK WILL BE PAID FOR AT THE CONTRACT UNIT PRICE PER FOOT (METER) FOR "CURB REMOVAL AND REPLACEMENT" OR "COMBINATION CONCRETE CURB AND GUTTER REMOVAL AND REPLACEMENT".

CURB OR CURB AND GUTTER REMOVAL AND REPLACEMENT

ALL DIMENSIONS ARE IN INCHES (MILLIMETERS) UNLESS OTHERWISE SHOWN.

FILE NAME = W:\distrad\22x34\bd24.dgn	USER NAME = geglienobt	DESIGNED - A. HOUSEH	REVISED - R. SHAH 10-03-96	STATE OF ILLINOIS DEPARTMENT OF TRANSPORTATION	CURB OR CURB AND GUTTER REMOVAL AND REPLACEMENT	F.A.U. RTE. 2340	SECTION 3215 A-RS	COUNTY COOK	TOTAL SHEETS 27	SHEET NO. 20
	PLOT SCALE = 50.000 / IN.	DRAWN -	REVISED - A. ABBAS 03-21-97			BD600-06 (BD-24)		CONTRACT NO. 60559		
	PLOT DATE = 1/4/2008	CHECKED -	REVISED - M. GOMEZ 01-22-01		SCALE: NONE	SHEET NO. 1	OF 1 SHEETS	STA.	TO STA.	FED. ROAD DIST. NO. 1 ILLINOIS FED. AID PROJECT
		DATE - 03-11-94	REVISED - R. BORO 01-01-07							

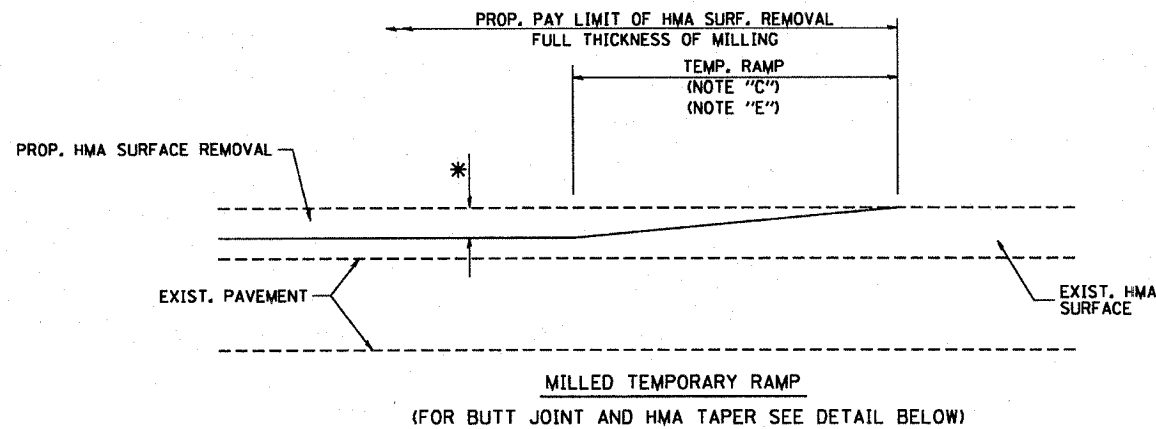

OPTION 1

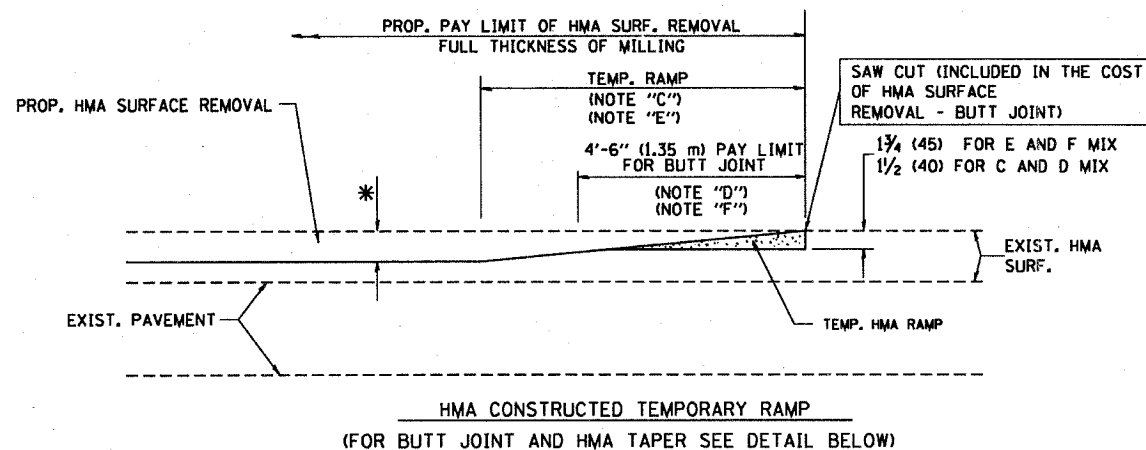

OPTION 2
TYPICAL TEMPORARY RAMP

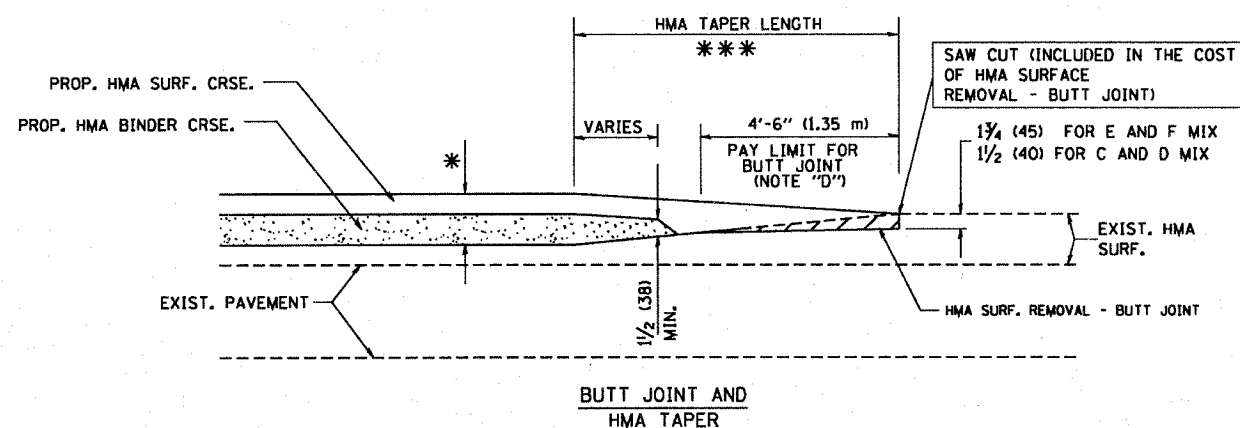

TYPICAL BUTT JOINT AND HMA TAPER
FOR MILLING AND RESURFACING

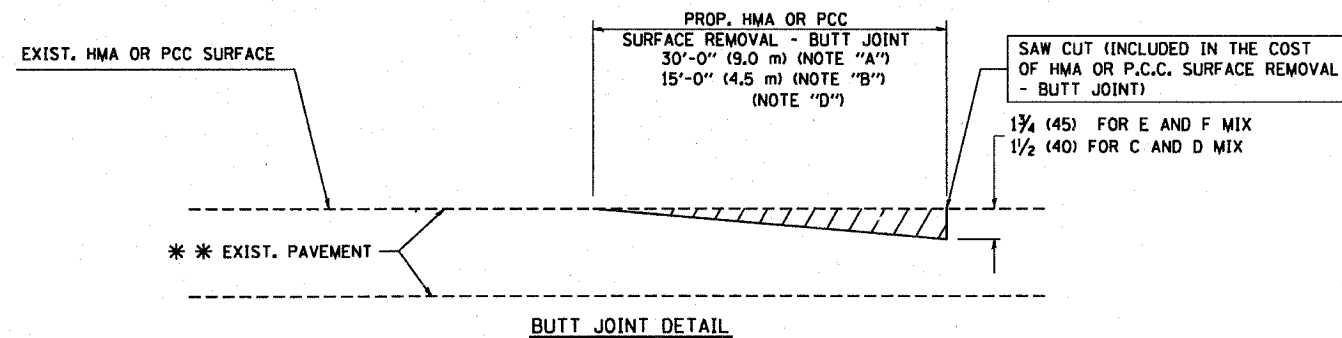

BUTT JOINT DETAIL

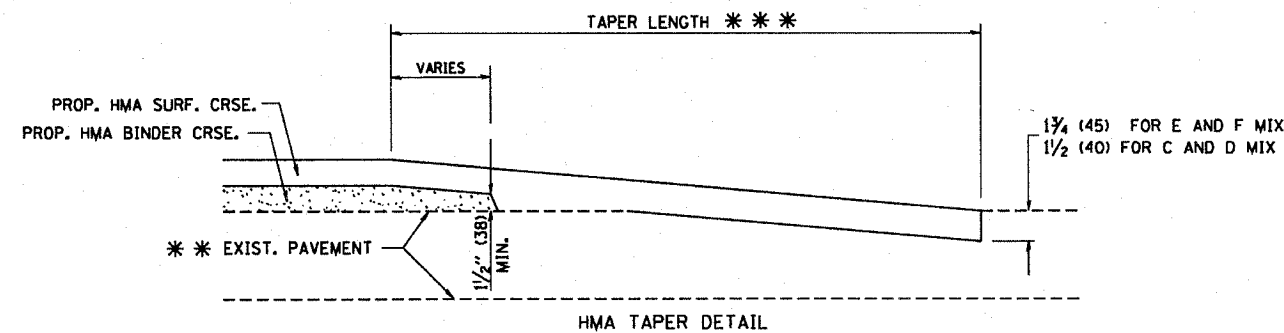

TYPICAL BUTT JOINT AND HMA TAPER
FOR RESURFACING ONLY

** PC CONCRETE, HMA OR HMA RESURFACED PAVEMENT.

NOTES

- A: MAINLINE ROADWAYS AND MAJOR SIDE ROADS.
 - B: MINOR SIDE ROADS.
 - C: THE TEMP. RAMP SHALL BE CONSTRUCTED IMMEDIATELY UPON REMOVAL OF THE EXISTING HMA SURFACE.
 - D: THE BUTT JOINT SHALL BE CONSTRUCTED IMMEDIATELY PRIOR TO PLACING THE PROPOSED HMA COURSES.
 - E: TAPER THE TEMP. RAMP AT A RATE OF 3'-0" (900 mm) PER 1 INCH (25 mm) OF MILLING THICKNESS.
 - F: INSTALLATION AND REMOVAL OF THE 4'-6" (1.35 m) TEMP. RAMP IS INCLUDED IN COST OF HMA SURFACE REMOVAL - BUTT JOINT
 - G: SEE ARTICLE 406.08 AND 406.14 OF THE STANDARD SPECIFICATIONS FOR "HMA AND/OR PCC SURFACE REMOVAL, BUTT JOINT".
- * SEE TYPICAL SECTIONS FOR MILLING THICKNESS.
- *** 20'-0" (6.1 m) PER 1 (25) RESURFACING (NOTE "A")
10'-0" (3.0 m) PER 1 (25) RESURFACING (NOTE "B")

BASIS OF PAYMENT:

THE BUTT JOINT WILL BE PAID FOR AT THE CONTRACT UNIT PRICE PER SQUARE YARD (SQUARE METER) FOR "HOT-MIX ASPHALT SURFACE REMOVAL - BUTT JOINT" OR FOR "PORTLAND CEMENT CONCRETE SURFACE REMOVAL - BUTT JOINT".

ALL DIMENSIONS ARE IN INCHES (MILLIMETERS) UNLESS OTHERWISE SHOWN.

FILE NAME = M:\data\22x34\bd32.dgn	USER NAME = geglionbt	DESIGNED - M. DE YONG	REVISED - R. SHAH 10-25-94
		DRAWN -	REVISED - A. ABBAS 03-21-97
	PLOT SCALE = 50.0000' / IN.	CHECKED -	REVISED - M. GOMEZ 04-06-01
	PLOT DATE = 1/4/2000	DATE - 06-13-90	REVISED - R. BORO 01-01-07

STATE OF ILLINOIS
DEPARTMENT OF TRANSPORTATION

BUTT JOINT AND HMA TAPER DETAILS			
SCALE: NONE	SHEET NO. 1 OF 1 SHEETS	STA.	TO STA.

F.A.J. RTE. 2740	SECTION 3215 A-RS	COUNTY COOK	TOTAL SHEETS 27	SHEET NO. 21
BD400-05 BD32		CONTRACT NO. 60559		
FED. ROAD DIST. NO. 1 ILLINOIS FED. AID PROJECT				

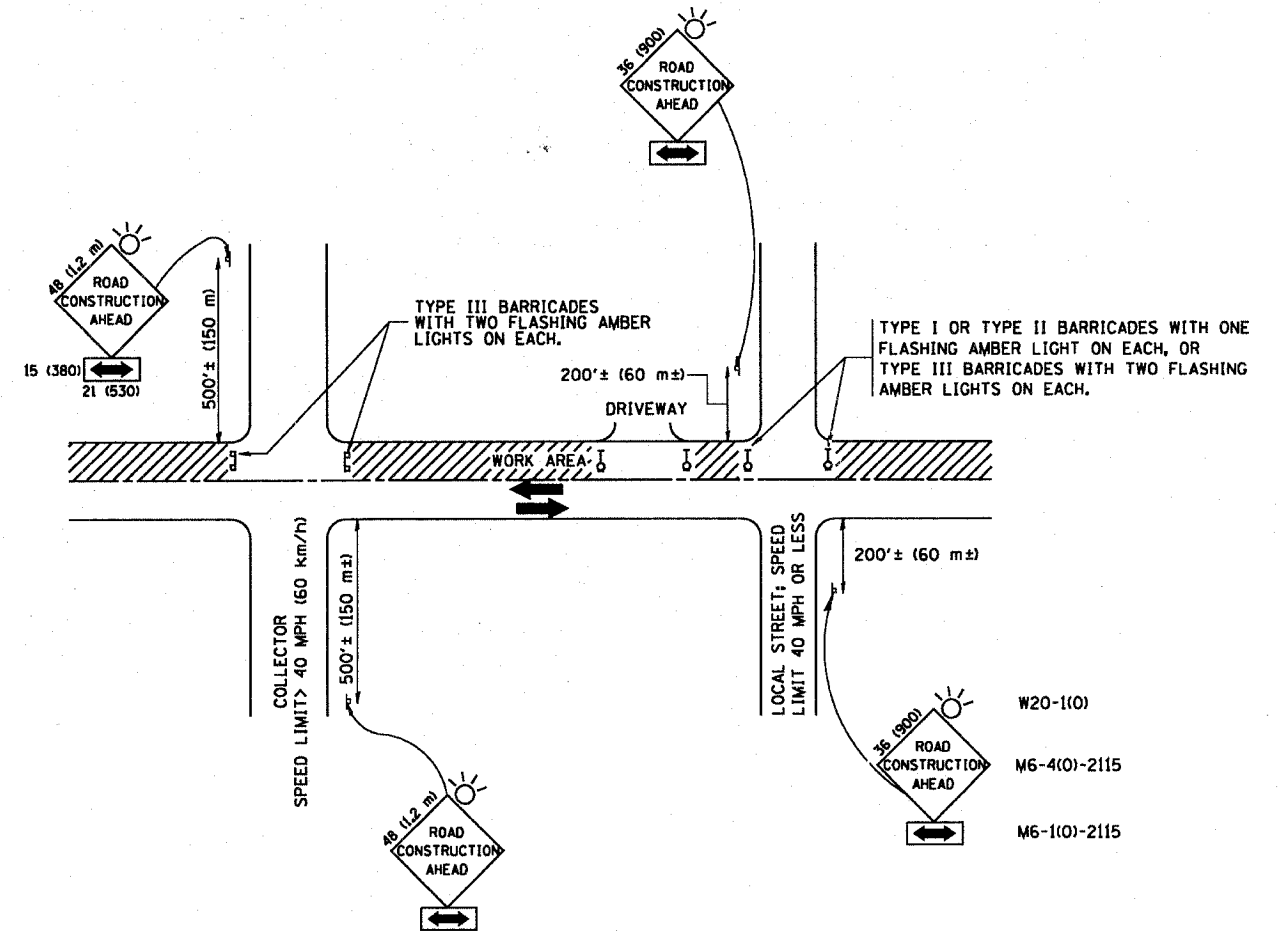

TRAFFIC CONTROL AND PROTECTION FOR SIDE ROADS, INTERSECTIONS, AND DRIVEWAYS

NOTES:

- A. FOR NO LANE RESTRICTION ON THE SIDE ROAD OR DRIVEWAYS
- SIDE ROAD WITH A SPEED LIMIT OF 40 MPH (60 km/h) OR LESS AS SHOWN ON THE DRAWING AND AS DIRECTED BY THE ENGINEER:
 - ONE ROAD CONSTRUCTION AHEAD SIGN 36 x 36 (900x900) WITH A FLASHER AND FLAG MOUNTED ON IT APPROXIMATELY 200' (60 m) IN ADVANCE OF THE MAIN ROUTE.
 - THE CLOSED PORTION OF THE MAIN ROUTE SHALL BE PROTECTED BY BLOCKING WITH TYPE I, TYPE II OR TYPE III BARRICADES, 1/3 OF THE CROSS SECTION OF THE CLOSED PORTION.
 - SIDE ROAD WITH A SPEED LIMIT GREATER THAN 40 MPH (60 km/h) AS SHOWN ON THE DRAWING AND AS DIRECTED BY THE ENGINEER:
 - ONE ROAD CONSTRUCTION AHEAD SIGN 48 x 48 (1.2 m x 1.2 m) WITH A FLASHER MOUNTED ON IT APPROXIMATELY 500' (150 m) IN ADVANCE OF THE MAIN ROUTE.
 - THE CLOSED PORTION OF THE MAIN ROUTE SHALL BE PROTECTED BY BLOCKING WITH TYPE III BARRICADES, 1/2 OF THE CROSS SECTION OF THE CLOSED PORTION.
3. WHEN THE SIDE ROAD LIES BETWEEN THE BEGINNING OF THE MAINLINE SIGNING AND THE WORK ZONE, A SINGLE HEADED ARROW (M6-1) SHALL BE USED IN LIEU OF THE DOUBLE HEADED ARROW (M6-4).
- B. FOR A LANE CLOSURE ON A SIDE ROAD OR DRIVEWAY:
- USE APPLICABLE PORTIONS OF THE TYPICAL APPLICATION OF TRAFFIC CONTROL DEVICES (STD. 701501, STD. 701606 OR THE APPROPRIATE STANDARD). THE SPACING OF SIGNS AND BARRICADES SHALL BE ADJUSTED FOR FIELD CONDITIONS AS DIRECTED BY THE ENGINEER. THE DIRECTIONAL ARROW SHALL BE COVERED OR REMOVED WHEN NO LONGER CONSISTENT WITH THE SIDE ROAD LANE CLOSURE.
- C. ADVANCE WARNING SIGNS ARE TO BE OMITTED ON DRIVEWAY UNLESS OTHERWISE NOTED.
- D. THE TRAFFIC CONTROL AND PROTECTION FOR SIDE ROADS, INTERSECTIONS, AND DRIVEWAYS SHALL BE INCIDENTAL TO THE COST OF SPECIFIED TRAFFIC CONTROL STANDARDS OR ITEMS.

All dimensions are in millimeters (inches) unless otherwise shown.

FILE NAME = V:\distsatd\22x34\td18.dgn	USER NAME = gagitanobt	DESIGNED - LHA	REVISED - J. OBERLE 10-18-95	STATE OF ILLINOIS DEPARTMENT OF TRANSPORTATION	TRAFFIC CONTROL AND PROTECTION FOR SIDE ROADS, INTERSECTIONS, AND DRIVEWAYS			F.A.U. RTE.	SECTION	COUNTY	TOTAL SHEETS	SHEET NO.
	PLOT SCALE = 58.000' / IN.	DRAWN -	REVISED - A. HOUSEH 03-06-96		2746	3215 A-RS	COOK	27	22			
	PLOT DATE = 1/4/2008	CHECKED -	REVISED - A. HOUSEH 10-15-96		SCALE: NONE SHEET NO. 1 OF 1 SHEETS STA. TO STA.			TC-10		CONTRACT NO. 60559		
		DATE - 06-89	REVISED - T. RAMMACHER 01-06-00		FED. ROAD DIST. NO. 1 (ILLINOIS) FED. AID PROJECT							

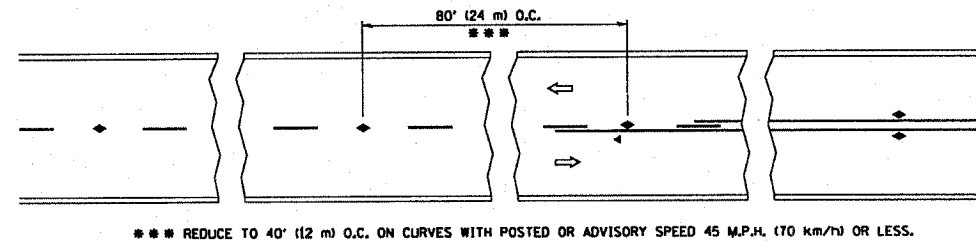

TWO-LANE/TWO-WAY

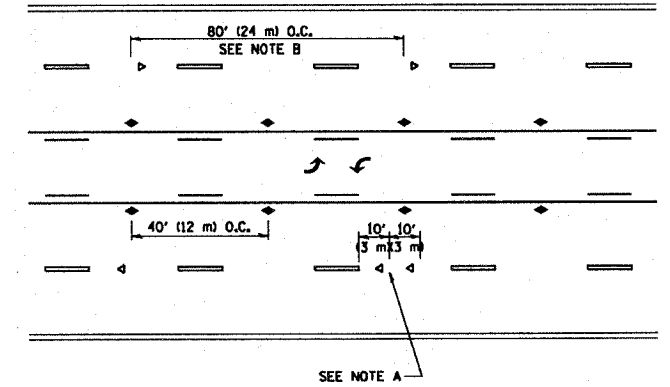
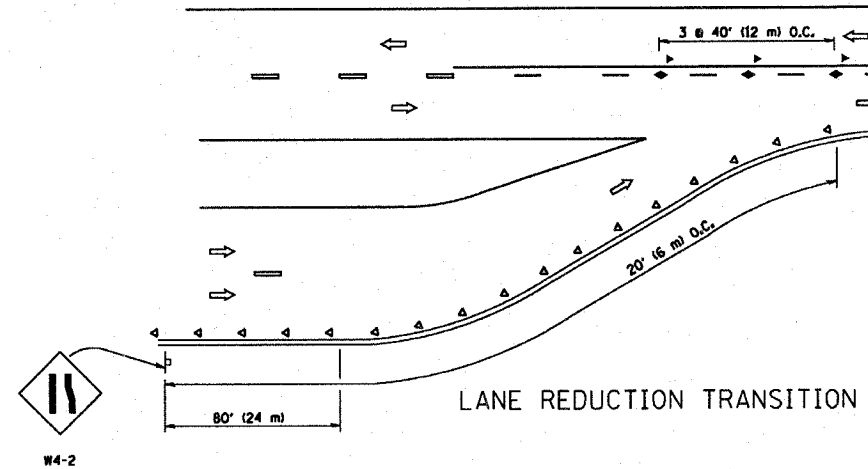

TWO-WAY LEFT TURN

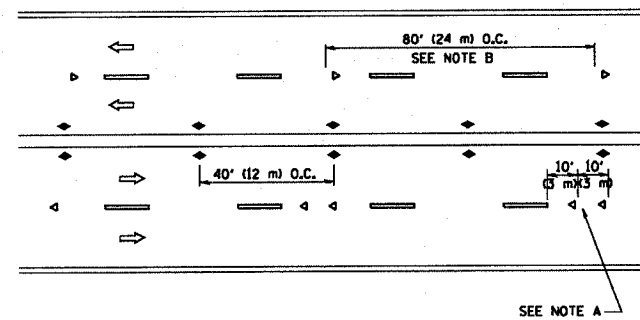

MULTI-LANE/UNDIVIDED

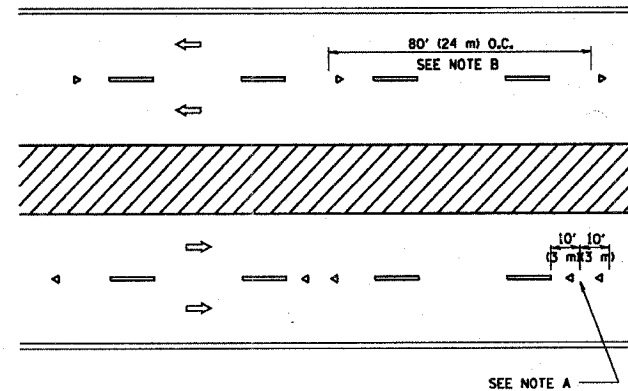

MULTI-LANE/DIVIDED

GENERAL NOTES

1. MARKERS USED WITH DASHED LINES SHALL BE CENTERED IN THE GAP BETWEEN SEGMENTS.
2. MARKERS USED ADJACENT TO SOLID LINES SHALL BE OFFSET 2 TO 3 (50 TO 75) TOWARD TRAFFIC AS SHOWN.
3. MARKERS THROUGH TANGENTS LESS THAN 500' (150 m) IN LENGTH BETWEEN CURVES SHALL BE INSTALLED AT THE LESSER OF THE TWO CURVE SPACINGS.

SYMBOLS

- YELLOW STRIPE
- WHITE STRIPE
- ◀ ONE-WAY AMBER MARKER
- ◀ ONE-WAY CRYSTAL MARKER (W/O)
- ◀ TWO-WAY AMBER MARKER

LANE MARKER NOTES

- A. USE DOUBLE LANE LINE MARKERS SPACED AS SHOWN.
- B. REDUCE TO 40' (12 m) O.C. ON CURVES WHERE ADVISORY SPEEDS ARE 10 M.P.H. (20 km/h) LOWER THAN POSTED SPEEDS.

DESIGN NOTES

1. DOUBLE LANE LINE MARKERS SHALL BE USED UNLESS SPECIFIED OTHERWISE.
2. EXCEPT AS SHOWN ON THE LANE REDUCTION TRANSITION AND FREEWAY EXIT RAMP DETAIL, MARKERS ARE NOT TO BE SPECIFIED ON RIGHT EDGE LINES.
3. THE EXACT MARKER LIMITS, SPACING, AND COLOR SHOULD BE INCLUDED IN THE PLANS.
4. MARKERS SHOULD NOT BE USED ALONGSIDE CURBS EXCEPT FOR EXTREMELY SHORT SECTIONS OF CURBS WHERE NOT MORE THAN TWO MARKERS WOULD BE INVOLVED.

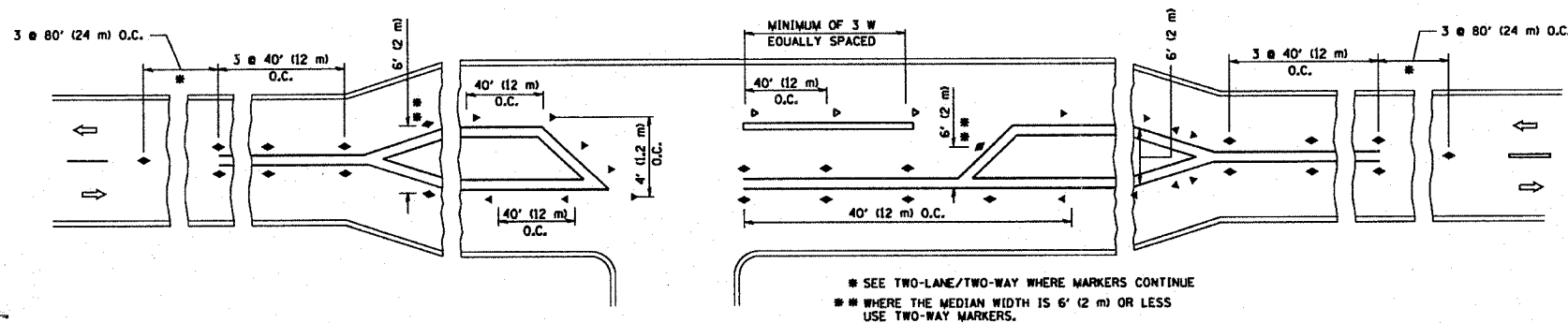

LEFT TURN

All dimensions are in inches (millimeters) unless otherwise shown.

FILE NAME = W:\disc\std\22x34\to11.dgn	USER NAME = geglennob	DESIGNED -	REVISED - T. RAMMACHER 09-19-94
		DRAWN -	REVISED - T. RAMMACHER 03-12-99
	PLOT SCALE = 58.800' / IN.	CHECKED -	REVISED - T. RAMMACHER 01-06-00
	PLOT DATE = 1/4/2008	DATE -	REVISED -

STATE OF ILLINOIS
DEPARTMENT OF TRANSPORTATION

TYPICAL APPLICATIONS			
RAISED REFLECTIVE PAVEMENT MARKERS (SNOW-PLOW RESISTANT)			
SCALE: NONE	SHEET NO. 1 OF 1 SHEETS	STA.	TO STA.

F.A.U. RTE.	SECTION	COUNTY	TOTAL SHEETS	SHEET NO.
2340	3215 A-RS	COOK	27	23
TC-11			CONTRACT NO. 6055A	
FED. ROAD DIST. NO. 1 (ILLINOIS) FED. AID PROJECT				

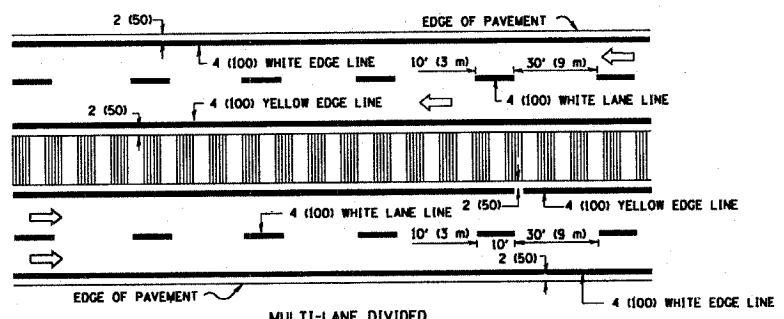
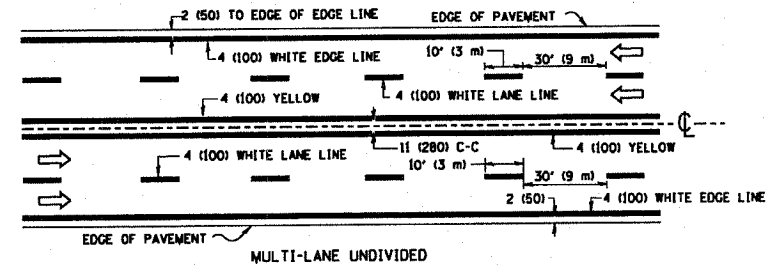
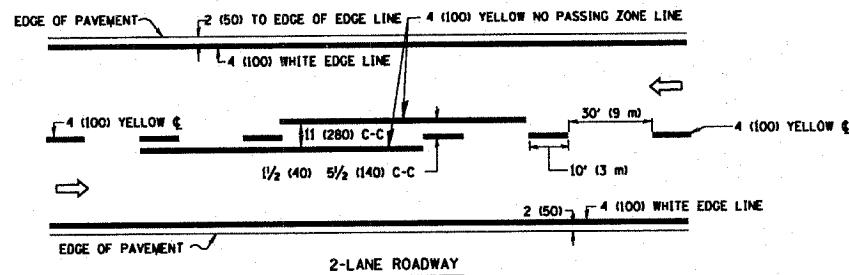

NOTE: MEDIANS WITH BARRIER CURB DO NOT REQUIRE AN EDGE LINE

TYPICAL LANE AND EDGE LINE MARKING

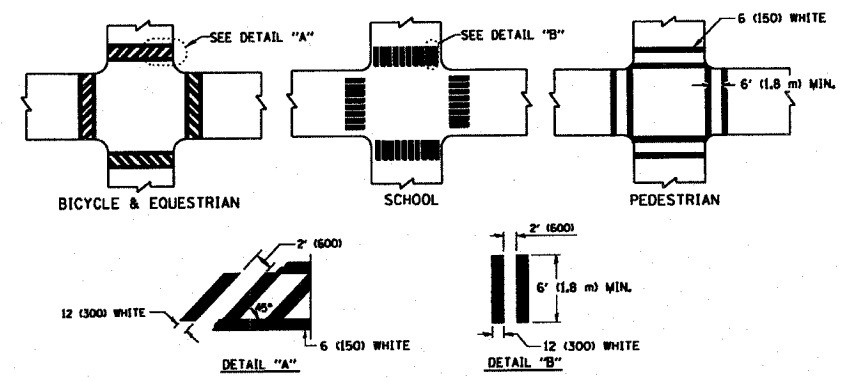

TYPICAL CROSSWALK MARKING

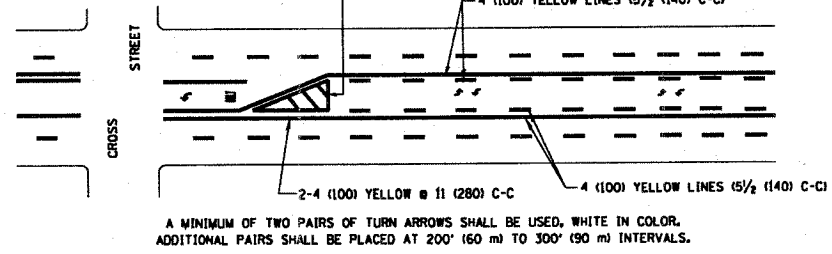
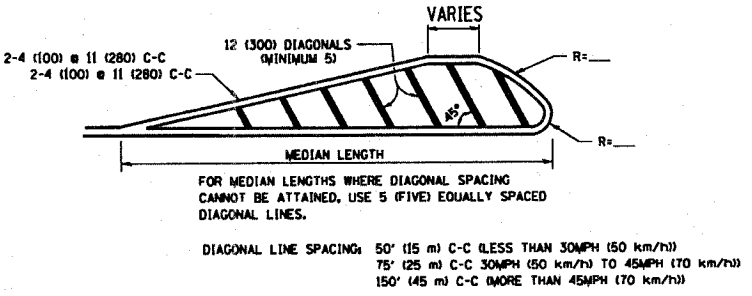
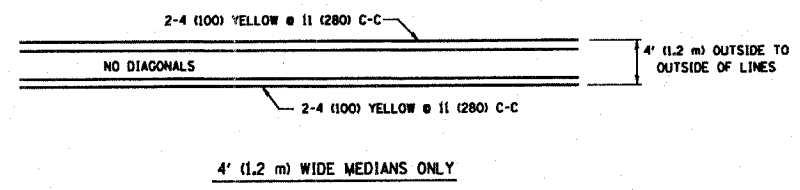

A MINIMUM OF TWO PAIRS OF TURN ARROWS SHALL BE USED, WHITE IN COLOR. ADDITIONAL PAIRS SHALL BE PLACED AT 200' (60 m) TO 300' (90 m) INTERVALS.

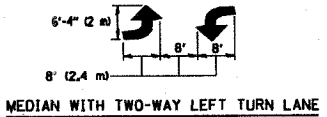

TYPICAL PAINTED MEDIAN MARKING

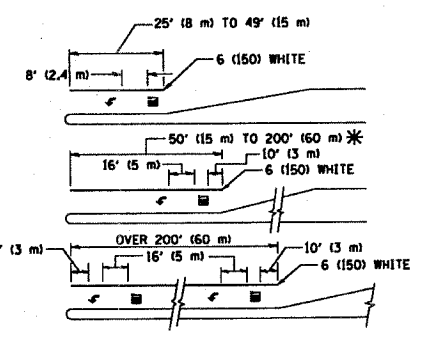

FULL SIZE LETTERS 8' (2.4 m) AND ARROWS SHALL BE USED.
 * AREA = 15.6 SQ. FT. (1.5 m²) □ AREA = 20.8 SQ. FT. (1.9 m²)
 * TURN LANES IN EXCESS OF 400' (120 m) IN LENGTH MAY HAVE AN ADDITIONAL SET OF ARROW - "ONLY" INSTALLED MIDWAY BETWEEN THE OTHER TWO SETS OF ARROW - "ONLY".

TYPICAL TURN LANE MARKING

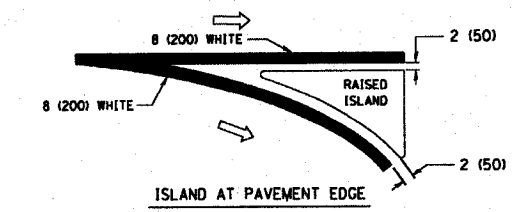
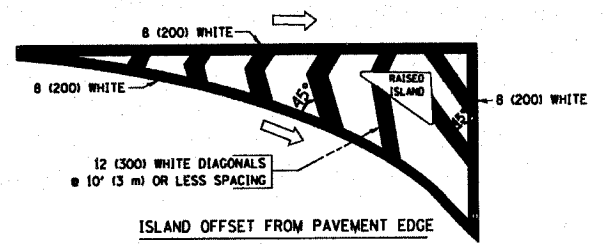

TYPICAL ISLAND MARKING

TYPE OF MARKING	WIDTH OF LINE	PATTERN	COLOR	SPACING / REMARKS
CENTERLINE ON 2 LANE PAVEMENT	4 (100)	SKIP-DASH	YELLOW	10' (3 m) LINE WITH 30' (9 m) SPACE
CENTERLINE ON MULTI-LANE UNDIVIDED PAVEMENT	2 @ 4 (100)	SOLID	YELLOW	11 (280) C-C
NO PASSING ZONE LINES FOR ONE DIRECTION FOR BOTH DIRECTIONS	4 (100) 2 @ 4 (100)	SOLID SOLID	YELLOW YELLOW	5/2 (140) C-C FROM SKIP-DASH CENTERLINE 11 (280) C-C OMIT SKIP-DASH CENTERLINE BETWEEN
LANE LINES	4 (100) 5 (125)	SKIP-DASH SKIP-DASH	WHITE WHITE	10' (3 m) LINE WITH 30' (9 m) SPACE
DOTTED LINES (EXTENSIONS OF CENTER, LANE OR TURN LANE MARKINGS)	SAME AS LINE BEING EXTENDED	SKIP-DASH	SAME AS LINE BEING EXTENDED	2' (600) LINE WITH 6' (1.8 m) SPACE
EDGE LINES	4 (100)	SOLID	YELLOW-LEFT WHITE-RIGHT	OUTLINE MOUNTABLE MEDIANS IN YELLOW; EDGE LINES ARE NOT USED NEXT TO BARRIER CURB
TURN LANE MARKINGS	6 (150) LINE; FULL SIZE LETTERS & SYMBOLS (8' (2.4m))	SOLID	WHITE	SEE TYPICAL TURN LANE MARKING DETAIL
TWO WAY LEFT TURN MARKING	2 @ 4 (100) EACH DIRECTION 8' (2.4m) LEFT ARROW	SKIP-DASH AND SOLID IN PAIRS	YELLOW WHITE	10' (3 m) LINE WITH 30' (9 m) SPACE FOR SKIP-DASH 5/2 (140) C-C BETWEEN SOLID LINE AND SKIP-DASH LINE SEE TYPICAL TWO-WAY LEFT TURN MARKING DETAIL
CROSSWALK LINES (PEDESTRIAN A. DIAGONALS (BIKE & EQUESTRIAN B. LONGITUDINAL BARS (SCHOOL))	2 @ 6 (150) 12 (300) @ 45° 12 (300) @ 90°	SOLID SOLID SOLID	WHITE WHITE WHITE	NOT LESS THAN 6' (1.8 m) APART 2' (600) APART 2' (600) APART SEE TYPICAL CROSSWALK MARKING DETAILS.
STOP LINES	24 (600)	SOLID	WHITE	PLACE 4' (1.2 m) IN ADVANCE OF AND PARALLEL TO CROSSWALK IF PRESENT. OTHERWISE, PLACE AT DESIRED STOPPING POINT, PARALLEL TO CROSSROAD CENTERLINE, WHERE POSSIBLE
PAINTED MEDIANS	2 @ 4 (100) WITH 12 (300) DIAGONALS @ 45° NO DIAGONALS USED FOR 4' (1.2 m) WIDE MEDIANS	SOLID	YELLOW TWO WAY TRAFFIC WHITE ONE WAY TRAFFIC	11 (280) C-C FOR THE DOUBLE LINE SEE TYPICAL PAINTED MEDIAN MARKING.
CORE MARKING AND CHANNELIZING LINES	8 (200) WITH 12 (300) DIAGONALS @ 45°	SOLID	WHITE	DIAGONALS: 15' (4.5 m) C-C (LESS THAN 30MPH (50 km/h)) 20' (6 m) C-C (30MPH (50 km/h) TO 45MPH (70 km/h)) 30' (9 m) C-C (OVER 45MPH (70 km/h))
RAILROAD CROSSING	24 (600) TRANSVERSE LINES "RR" 15' (4.5 m) MIN. LETTERS: 16 (400) LINE FOR "X"	SOLID	WHITE	SEE STATE STANDARD 780001 AREA OF: "R"=3.6 SQ. FT. (0.33 m ²) EACH "X"=54.0 SQ. FT. (5.0 m ²)
SHOULDER DIAGONALS	12 (300) @ 45°	SOLID	WHITE - RIGHT YELLOW - LEFT	50' (15 m) C-C (LESS THAN 30MPH (50 km/h)) 75' (25 m) C-C (30 MPH (50 km/h) TO 45MPH (70 km/h)) 150' (45 m) C-C (OVER 45MPH (70 km/h))

FOR FURTHER DETAILS ON PAVEMENT MARKING REFER TO STANDARD SPECIFICATIONS FOR ROAD AND BRIDGE CONSTRUCTION AND STATE STANDARD 780001.

All dimensions are in inches (millimeters) unless otherwise shown.

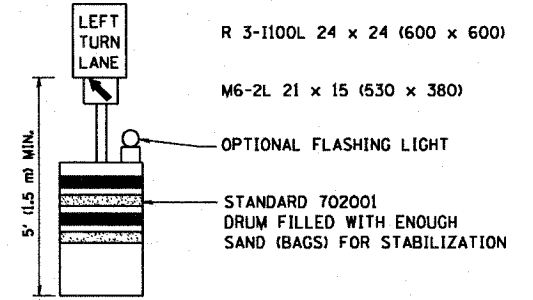
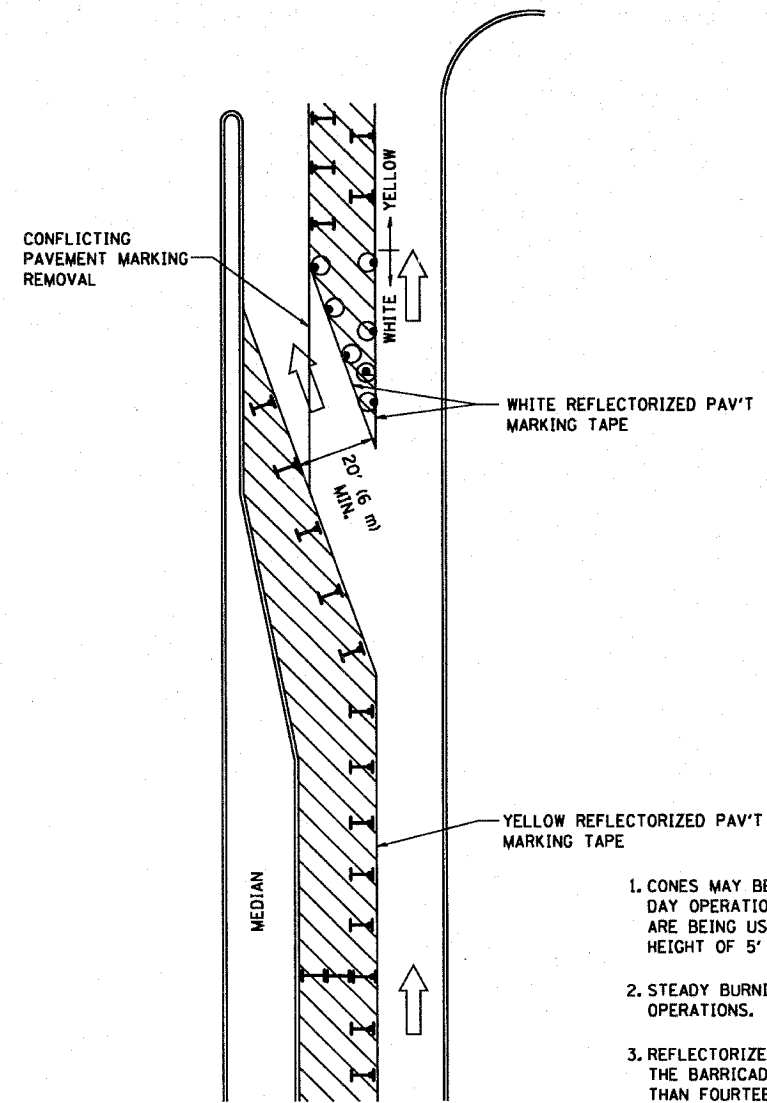





GENERAL NOTES

1. CONES MAY BE SUBSTITUTED FOR BARRICADES OR DRUMS AT HALF THE SPACING DURING DAY OPERATIONS. CONES SHALL BE A MINIMUM OF 28 (710) IN HEIGHT. WHEN CONES ARE BEING USED, THE "LEFT TURN LANE" SIGN MAY BE SKID MOUNTED AT A MINIMUM HEIGHT OF 5' (1.5 m).
2. STEADY BURNING LIGHTS WILL NOT BE REQUIRED ON BARRICADES OR DRUMS FOR DAY OPERATIONS. ALL LIGHTS SHALL BE MONODIRECTIONAL.
3. REFLECTORIZED TEMPORARY PAVEMENT MARKING TAPE SHALL BE PLACED THROUGHOUT THE BARRICADED AREA OF EACH TURN BAY WHERE THE CLOSURE TIME IS GREATER THAN FOURTEEN DAYS.
4. THIS APPLICATION ALSO APPLIES WHEN WORK IS BEING PERFORMED IN THE RIGHT LANE(S) AND THE RIGHT TURN BAY IS TO REMAIN OPEN. UNDER THIS CONDITION, "RIGHT TURN LANE" R3-100 24 x 24 (600 x 600) AND M6-2R 21 x 15 (530 x 380) SHALL BE USED.
5. THESE CONTROLS SHALL SUPPLEMENT MAINLINE TRAFFIC CONTROL FOR LANE CLOSURES.
6. LONGITUDINAL DIMENSIONS MAY BE ADJUSTED TO FIT FIELD CONDITIONS.
7. FORM BT 725 IS REQUIRED.
8. TRAFFIC CONTROL AND PROTECTION AT TURN BAYS (TO REMAIN OPEN TO TRAFFIC) SHALL BE INCLUDED IN THE COST SPECIFIED TRAFFIC CONTROL STANDARDS OR ITEMS.

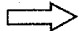
All dimensions are in inches (millimeters) unless otherwise shown.

LEGEND

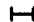
-  WORK AREA
-  LANE OPEN TO TRAFFIC
-  TYPE I OR II BARRICADE WITH STEADY BURN LIGHT
-  DRUM WITH STEADY BURN LIGHT
-  DRUM WITH SIGN (WITH OPTIONAL FLASHING LIGHT) SEE DETAIL
-  TYPE I OR II CHECK BARRICADE WITH FLASHING LIGHT

FILE NAME = W:\data\22x34\to14.dgn	USER NAME = geglianobt	DESIGNED -	REVISED -T, RAMMACHER 09-08-94
		DRAWN -	REVISED - A, HOUSEH 11-07-95
	PLOT SCALE = 50.0000 ' / IN.	CHECKED -	REVISED - A, HOUSEH 10-12-96
	PLOT DATE = 1/4/2000	DATE -	REVISED -T, RAMMACHER 01-06-00

**STATE OF ILLINOIS
DEPARTMENT OF TRANSPORTATION**

**TRAFFIC CONTROL AND PROTECTION AT TURN BAYS
(TO REMAIN OPEN TO TRAFFIC)**

SCALE: NONE SHEET NO. 1 OF 1 SHEETS STA. TO STA.

F.A.U. RTE. 2746	SECTION 3215 A-RS	COUNTY COOK	TOTAL SHEETS 27	SHEET NO. 25
TC-14			CONTRACT NO. 60559	
FED. ROAD DIST. NO. 1 (ILLINOIS) FED. AID PROJECT				

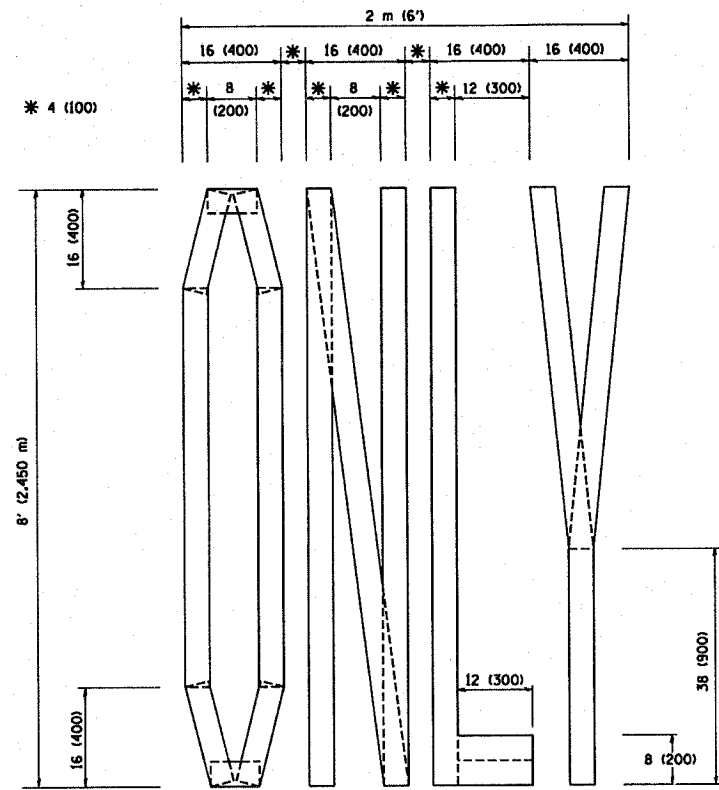

QUANTITY
 4 (100) LINE = 64.1 ft. (19.7 m)
 21.1 sq. ft. (1.97 sq. m)

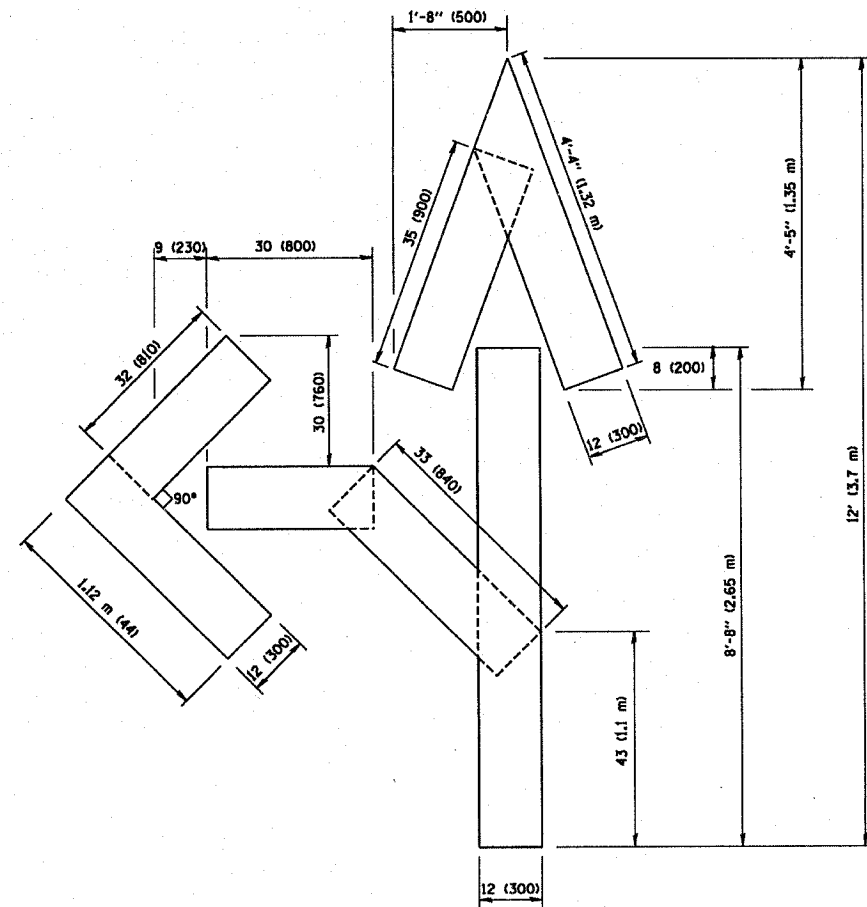

QUANTITY
 4 (100) LINE = 82.5 ft. (25.3 m)
 27.5 sq. ft. (2.53 sq. m)

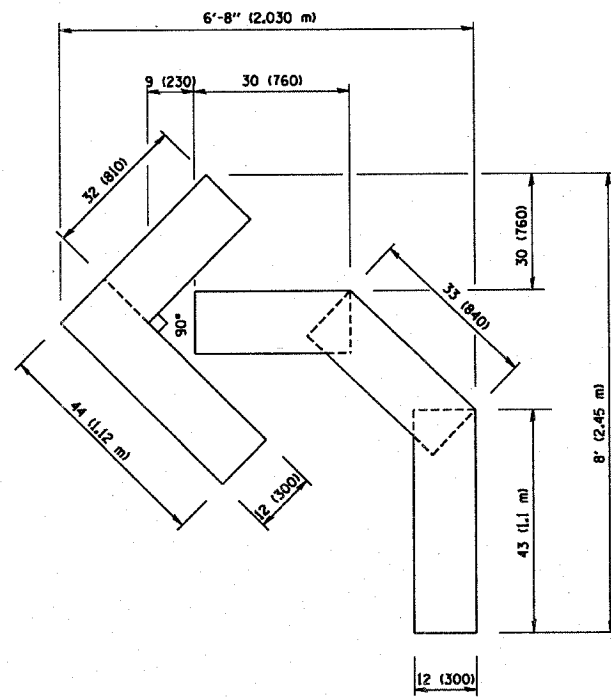

QUANTITY
 4 (100) LINE = 45.5 ft. (13.9 m)
 15.2 sq. ft. (1.39 sq. m)

All dimensions are in Inches (millimeters) unless otherwise shown.

FILE NAME = W:\dist\22x34\1016.dgn	USER NAME = gaglienobt	DESIGNED -	REVISED - T. RAMMACHER 06-05-96
		DRAWN -	REVISED - T. RAMMACHER 11-04-97
	PLOT SCALE = 50.0000" / IN.	CHECKED -	REVISED - T. RAMMACHER 03-02-98
	PLOT DATE = 1/4/2000	DATE - 09-18-94	REVISED - E. GOMEZ 08-28-00

STATE OF ILLINOIS
 DEPARTMENT OF TRANSPORTATION

PAVEMENT MARKING LETTERS AND SYMBOLS
 FOR TRAFFIC STAGING

SCALE: NONE SHEET NO. 1 OF 1 SHEETS STA. TO STA.

F.A.W. RTE.	SECTION	COUNTY	TOTAL SHEETS	SHEET NO.
2746	3215 A-RS	COOK	27	26
TC-16			CONTRACT NO. 60559	
FED. ROAD DIST. NO. 1 ILLINOIS FED. AID PROJECT				

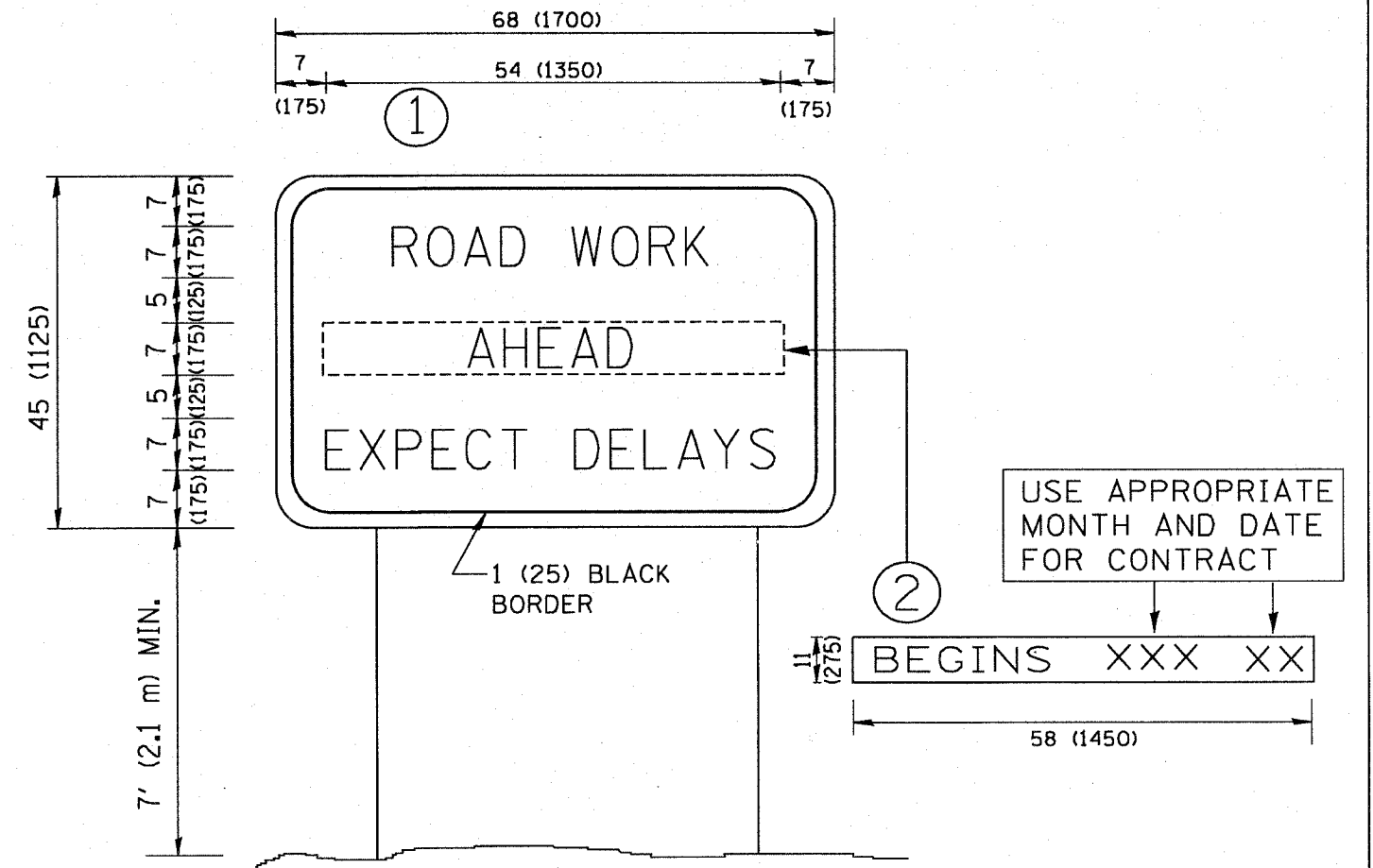

NOTES:

1. USE BLACK LETTERING ON ORANGE BACKGROUND.
2. ERECT SIGNS IN ADVANCE OF THE LOCATION FOR THE "ROAD CONSTRUCTION AHEAD" SIGN AT LOCATIONS AS DIRECTED BY THE ENGINEER.
3. ERECT SIGN ① WITH INSTALLED PANEL ② ONE WEEK PRIOR TO THE START OF CONSTRUCTION.
4. REMOVE PANEL ② SOON AFTER THE START OF CONSTRUCTION.
5. SEE SPECIAL PROVISION FOR "TEMPORARY INFORMATION SIGNING" FOR ADDITIONAL INFORMATION.
6. ONE SIGN ASSEMBLY EQUALS 25.70 SQ. FT. (2.3 SQ. M.)
7. SHALL BE PAID FOR AS TEMPORARY INFORMATION SIGNING.

ALL DIMENSIONS ARE IN INCHES (MILLIMETERS) UNLESS OTHERWISE SHOWN.

FILE NAME = W:\d\statd\22x34\to22.dgn	USER NAME = geglienobt	DESIGNED -	REVISED - R. MIRS 09-15-97	STATE OF ILLINOIS DEPARTMENT OF TRANSPORTATION	ARTERIAL ROAD INFORMATION SIGN			F.A.D. RTE.	SECTION	COUNTY	TOTAL SHEETS	SHEET NO.
	PLOT SCALE = 58.000 ' / IN.	DRAWN -	REVISED - R. MIRS 12-11-97		2746	3215 A-RS	COOK	27	27			
	PLOT DATE = 1/4/2008	CHECKED -	REVISED - T. RAMWACHER 02-02-99		SCALE: NONE SHEET NO. 1 OF 1 SHEETS STA. TO STA.			TC-22	CONTRACT NO. 60559			
		DATE -	REVISED - C. JUCIUS 01-31-07		FED. ROAD DIST. NO. 1 ILLINOIS FED. AID PROJECT							