

F.A.I. RTE.	SECTION	COUNTY	TOTAL SHEETS	SHEET NO.
90/94	2005-066 LS	COOK	77	20
STA. 000+00		TO STA. 000+00		
FED. ROAD DIST. NO. 1 ILLINOIS FED. AID PROJECT				
60A72				

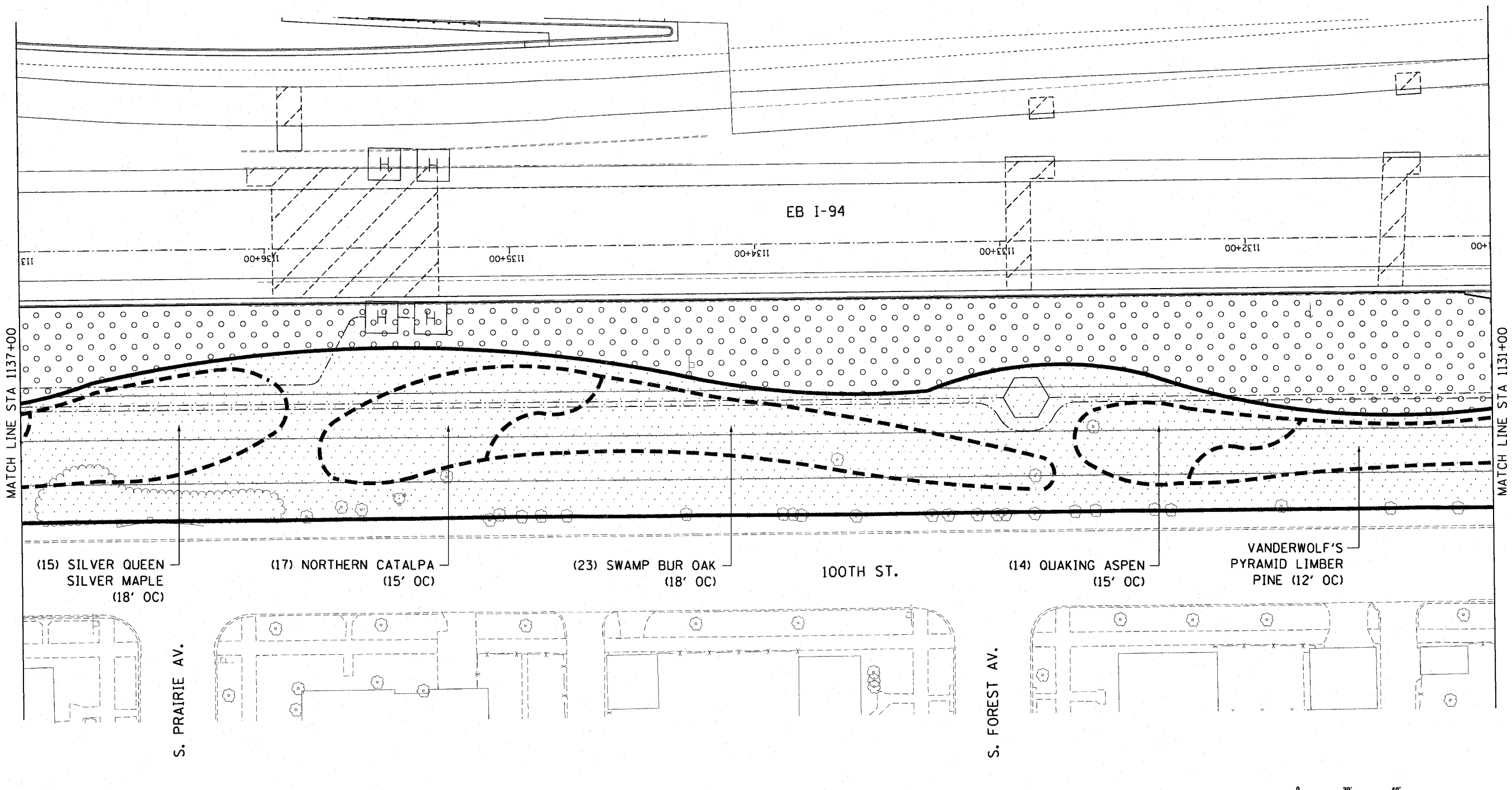

MATCH LINE STA 1137+00

MATCH LINE STA 1131+00

(15) SILVER QUEEN SILVER MAPLE (18' OC)

(17) NORTHERN CATALPA (15' OC)

(23) SWAMP BUR OAK (18' OC)

100TH ST.

(14) QUAKING ASPEN (15' OC)

VANDERWOLF'S PYRAMID LIMBER PINE (12' OC)

S. PRAIRIE AV.

S. FOREST AV.

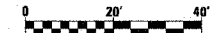

SHT-11 of 67

REVISIONS	
NAME	DATE

ILLINOIS DEPARTMENT OF TRANSPORTATION  
 F.A.I. 90/94 (DAN RYAN EXPRESSWAY)  
 NB ROADSIDE EMBANKMENT LANDSCAPE

**PROPOSED IMPROVEMENT**  
 I-57 INTERCHANGE TO 31ST STREET

SCALE: 1"=20'  
 DATE: JUNE 2008

DRAWN BY: LAM  
 CHECKED BY: JWM



p:\040466\1\30-roadside embankment\11-57-20a.rvt