

F.A.I. RTE.	SECTION	COUNTY	TOTAL SHEETS	SHEET NO.
90/94	2005-066 LS	COOK	77	51
STA. 4393+50		TO STA. 4398+25		
FED. ROAD DIST. NO. 1		ILLINOIS		FED. AID PROJECT

60A72

(76) VIRGINIA CREEPER (2' OC - ALONG BASE OF RETAINING WALL)  
 INTERPLANTED WITH (7) YELLOW TRUMPET VINE (20' OC - ALONG  
 BASE OF RETAINING WALL/MULCH BED)  
 (150) HAPPY RETURNS DAYLILY  
 (12' OC - IN FRONT OF VINES/MULCH BED)

(135) MISS KIM MANCHURIAN LILAC  
 (3' OC - STAGGERED/MULCH BED)

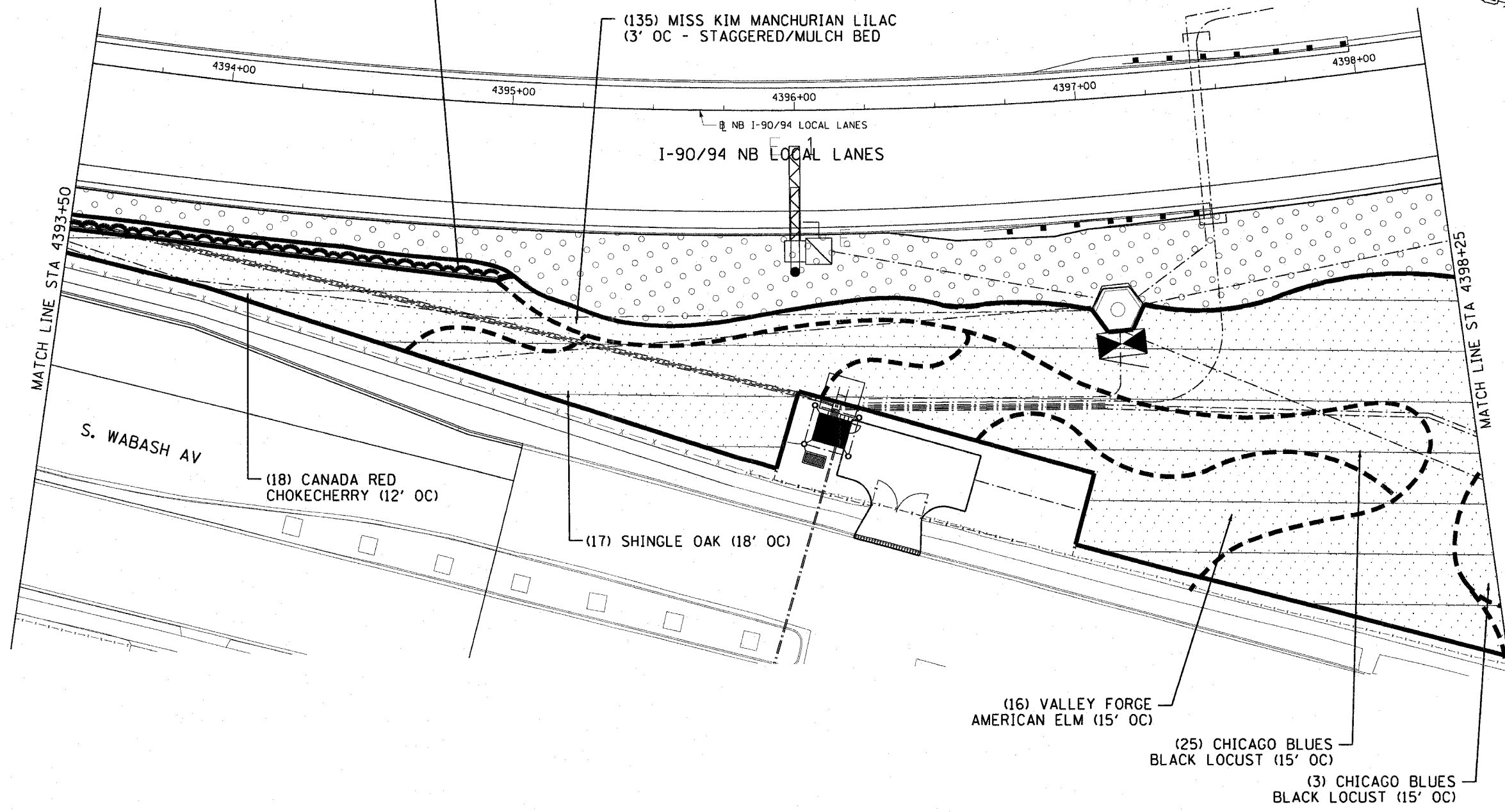

S. WABASH AV

(18) CANADA RED  
 CHOKECHERRY (12' OC)

(17) SHINGLE OAK (18' OC)

(16) VALLEY FORGE  
 AMERICAN ELM (15' OC)

(25) CHICAGO BLUES  
 BLACK LOCUST (15' OC)

(3) CHICAGO BLUES  
 BLACK LOCUST (15' OC)

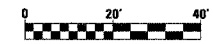

SHT-42 of 67

REVISIONS	
NAME	DATE

ILLINOIS DEPARTMENT OF TRANSPORTATION  
 F.A.I. 90/94 (DAN RYAN EXPRESSWAY)  
 NB ROADSIDE EMBANKMENT LANDSCAPE

**PROPOSED IMPROVEMENT**  
**I-57 INTERCHANGE TO 31ST STREET**

SCALE: 1"=20'  
 DATE: JUNE 2008

DRAWN BY: LAM  
 CHECKED BY: RMG

CTE | AECOM

P:\P\0468\civil\30-roadside embankment\sh42a.mxd 6/19/2008 6:57:18 PM