

F.A.I. RTE.	SECTION	COUNTY	TOTAL SHEETS	SHEET NO.
90/94	2005-066 LS	COOK	77	52
STA. 4398+25	TO STA. 4403+00			
FED. ROAD DIST. NO. 1 ILLINOIS FED. AID PROJECT				
60A72				

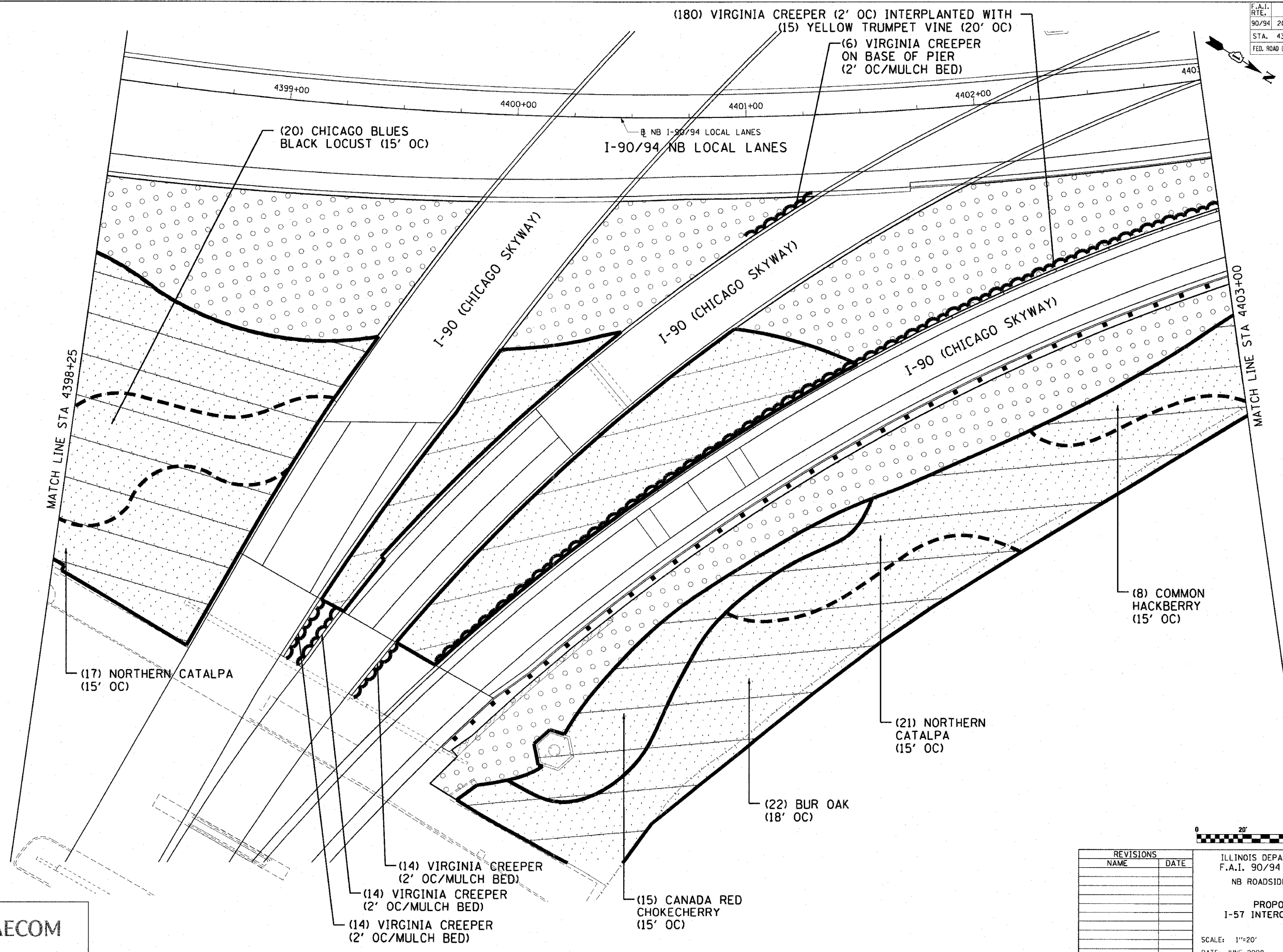

(20) CHICAGO BLUES
BLACK LOCUST (15' OC)

(180) VIRGINIA CREEPER (2' OC) INTERPLANTED WITH
(15) YELLOW TRUMPET VINE (20' OC)

(6) VIRGINIA CREEPER
ON BASE OF PIER
(2' OC/MULCH BED)

MATCH LINE STA 4398+25

I-90 (CHICAGO SKYWAY)

NB I-90/94 LOCAL LANES
I-90/94 NB LOCAL LANES

I-90 (CHICAGO SKYWAY)

I-90 (CHICAGO SKYWAY)

MATCH LINE STA 4403+00

(17) NORTHERN CATALPA
(15' OC)

(8) COMMON
HACKBERRY
(15' OC)

(21) NORTHERN
CATALPA
(15' OC)

(22) BUR OAK
(18' OC)

(14) VIRGINIA CREEPER
(2' OC/MULCH BED)

(14) VIRGINIA CREEPER
(2' OC/MULCH BED)

(14) VIRGINIA CREEPER
(2' OC/MULCH BED)

(15) CANADA RED
CHOKECHERRY
(15' OC)

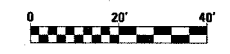

SHT-43 of 67

REVISIONS	
NAME	DATE

ILLINOIS DEPARTMENT OF TRANSPORTATION
F.A.I. 90/94 (DAN RYAN EXPRESSWAY)
NB ROADSIDE EMBANKMENT LANDSCAPE

PROPOSED IMPROVEMENT
I-57 INTERCHANGE TO 31ST STREET

SCALE: 1"=20'
DATE: JUNE 2008

DRAWN BY: LAM
CHECKED BY: RMG

CTE | AECOM

P:\P40468\GWIN-30-roadside-embankment\STA220-NB\5220A43-2.dwg 6/19/2008 6:54:20 PM