

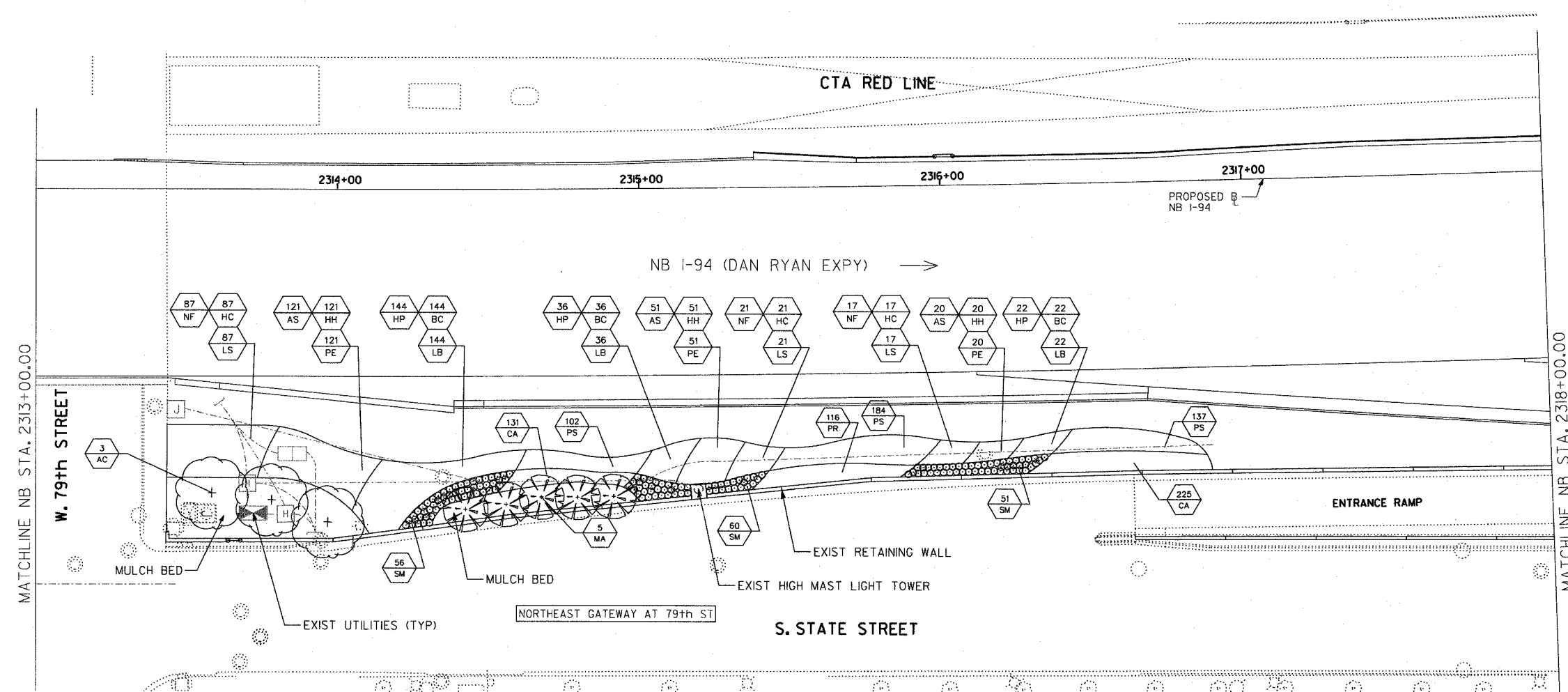

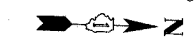

F.A.I. RTE.	SECTION	COUNTY	TOTAL SHEETS	SHEET NO.
94	2005-070 LS	COOK	65	27
STA. 2313+00		TO STA. 2318+00		
FED. ROAD DIST. NO.	ILLINOIS	FED. AID PROJECT		

60A76

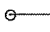

LEGEND:

-  SHADE TREE
-  ORNAMENTAL TREE
-  SHRUB
-  PERENNIALS/
ORNAMENTAL GRASSES

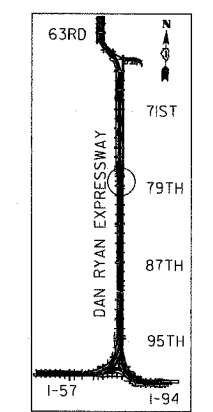

LOCATION MAP

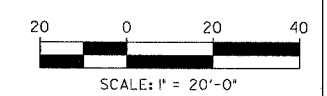

SITE DESIGN GROUP

TYLIN INTERNATIONAL

REVISIONS	
NAME	DATE

ILLINOIS DEPARTMENT OF TRANSPORTATION
F.A.I. 94 (DAN RYAN EXPRESSWAY)
79TH STREET GATEWAY LANDSCAPING AND IRRIGATION
LANDSCAPE PLAN
NE QUADRANT AT 79TH ST. - NB I-94
SCALE: 1"=20'
DATE: May 1, 2008
DRAWN BY: EM
CHECKED BY: JO