

PROFILE SURVEYED  
 PLOTTED  
 NOTE BOOK  
 NO. \_\_\_\_\_  
 DATE \_\_\_\_\_  
 BY \_\_\_\_\_  
 CHECKED \_\_\_\_\_  
 STRUCTURE NOTATION CIRCD

F.A.I. RTE.	SECTION	COUNTY	TOTAL SHEETS	SHEET NO.
90/94	2005-070 LS	COOK	65	51
STA. 1308+46 (SB I-94)		TO STA. 1316+90 (NB I-94)		
FED. ROAD DIST. NO.		ILLINOIS		FED. AID PROJECT

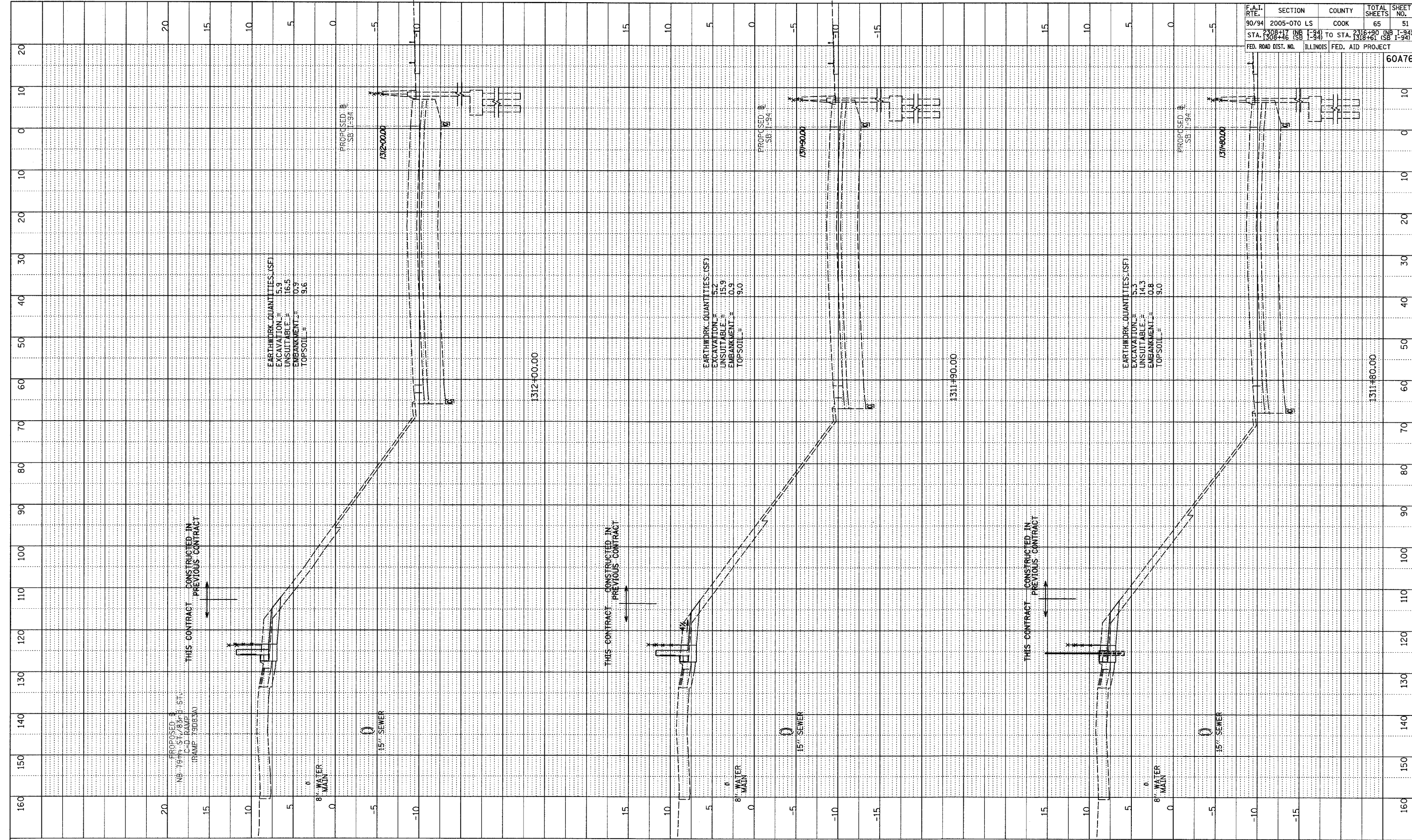

EARTHWORK QUANTITIES (SF)  
 EXCAVATION = 5.3  
 UNSUITABLE = 16.5  
 EMBANKMENT = 0.9  
 TOPSOIL = 9.6

EARTHWORK QUANTITIES (SF)  
 EXCAVATION = 5.2  
 UNSUITABLE = 15.9  
 EMBANKMENT = 0.9  
 TOPSOIL = 9.0

EARTHWORK QUANTITIES (SF)  
 EXCAVATION = 5.3  
 UNSUITABLE = 14.3  
 EMBANKMENT = 0.8  
 TOPSOIL = 9.0

TYLIN INTERNATIONAL

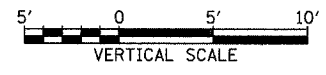
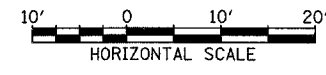

SB I-94 (DAN RYAN EXPRESSWAY)  
 STA. 1311+80 TO STA. 1312+00

60A76