

F.A.P. RTE.	SECTION	COUNTY	TOTAL SHEETS	SHEET NO.
353	12R - 4	WILL	199	35
STA.		TO STA.		
FED. ROAD DIST. NO.		ILLINOIS	FED. AID PROJECT	

# PRE-STAGE 1 GENERAL NOTES

## PRE-STAGE 1 CONSTRUCTION

ALL UTILITY RELOCATIONS SHALL TAKE PLACE DURING PRE-STAGE 1.

ALL TREE REMOVAL TO TAKE PLACE DURING PRE-STAGE 1.

STORM SEWER LATERALS SHALL BE INSTALLED AS SHOWN ON THE PRE-STAGE 1 PLANS. STORM SEWER MAINLINE SHALL BE CONSTRUCTED AT THE FOLLOWING LOCATIONS:

- FROM STA. 293+72 TO STA. 299+50
- FROM STA. 301+10 TO STA. 304+70
- FROM STA. 305+50 TO STA. 311+35
- FROM STA. 318+38 TO STA. 318+59

TEMPORARY PAVEMENT AND AGGREGATE SHOULDERS SHALL BE CONSTRUCTED AS SHOWN ON THE PRE-STAGE 1 PLANS.

## PRE-STAGE 1 GENERAL NOTES

THE CONTRACTOR SHALL PROVIDE AND MAINTAIN ACCESS TO ALL PUBLIC AND PRIVATE ENTRANCES UNLESS INDICATED OTHERWISE IN THE PLANS.

STORM SEWER STRUCTURES SHALL BE CONSTRUCTED TO AN ELEVATION BELOW EXISTING GRADE, SUFFICIENT FOR CONSTRUCTION OF STORM SEWER, AND THEN COVERED WITH A STEEL PLATE UNTIL FINAL FRAME AND GRATE CAN BE CONSTRUCTED, UNLESS PLANS INDICATE OTHERWISE.

STORM SEWER CONSTRUCTED NOT TERMINATING AT A DRAINAGE STRUCTURE SHALL BE TEMPORARILY PLUGGED UNTIL DRAINAGE STRUCTURE IS CONSTRUCTED OR STORM SEWER CONSTRUCTION RESUMES.

## PRE-STAGE 1 TRAFFIC

US RTE 30

1. USE IDOT STANDARD 701326 TO CONSTRUCT TEMPORARY PAVEMENT.

2. USE IDOT STANDARD 701502 FOR TRENCHING AND PATCHING OPERATIONS ACROSS US RTE 30.

WOLF ROAD

1. USE IDOT STANDARD 701326 TO CONSTRUCT TEMPORARY PAVEMENT.

USE IDOT STANDARDS 701001, 701006, AND 701011 AS NEEDED ON US RTE 30 AND WOLF ROAD.

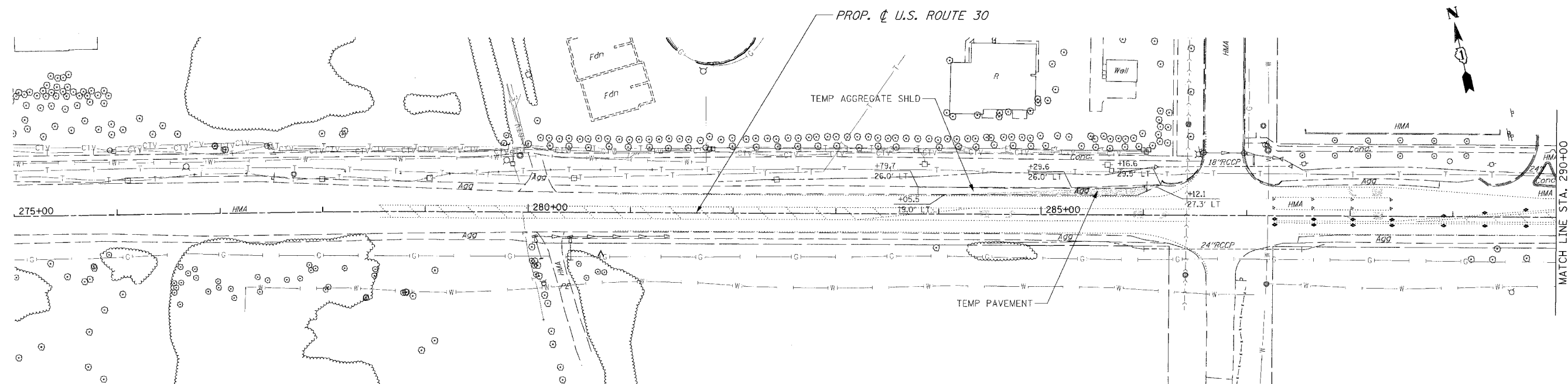

### LEGEND

- TEMPORARY PAVEMENT
- CONSTRUCTION ZONE
- TYPE III BARRICADE
- TYPE 1 OR 2 BARRICADE
- TEMPORARY STRUCTURE NUMBER
- TEMPORARY PIPE NUMBER

REVISIONS	
NAME	DATE

ILLINOIS DEPARTMENT OF TRANSPORTATION  
**MAINTENANCE OF TRAFFIC**  
 PRE-STAGE 1  
 U.S. RTE. 30 (LINCOLN HIGHWAY)  
 STA. 275+00 TO STA. 290+00  
 SCALE : 1" = 50'  
 DATE : 03/21/2008  
 DRAWN BY : BAE  
 CHECKED BY : GB