

F.A.P. RTE.	SECTION	COUNTY	TOTAL SHEETS	SHEET NO.
353	12R - 4	WILL	199	43
STA.	TO STA.			
FED. ROAD EST. NO.	BILLING	FED. AID PROJECT		

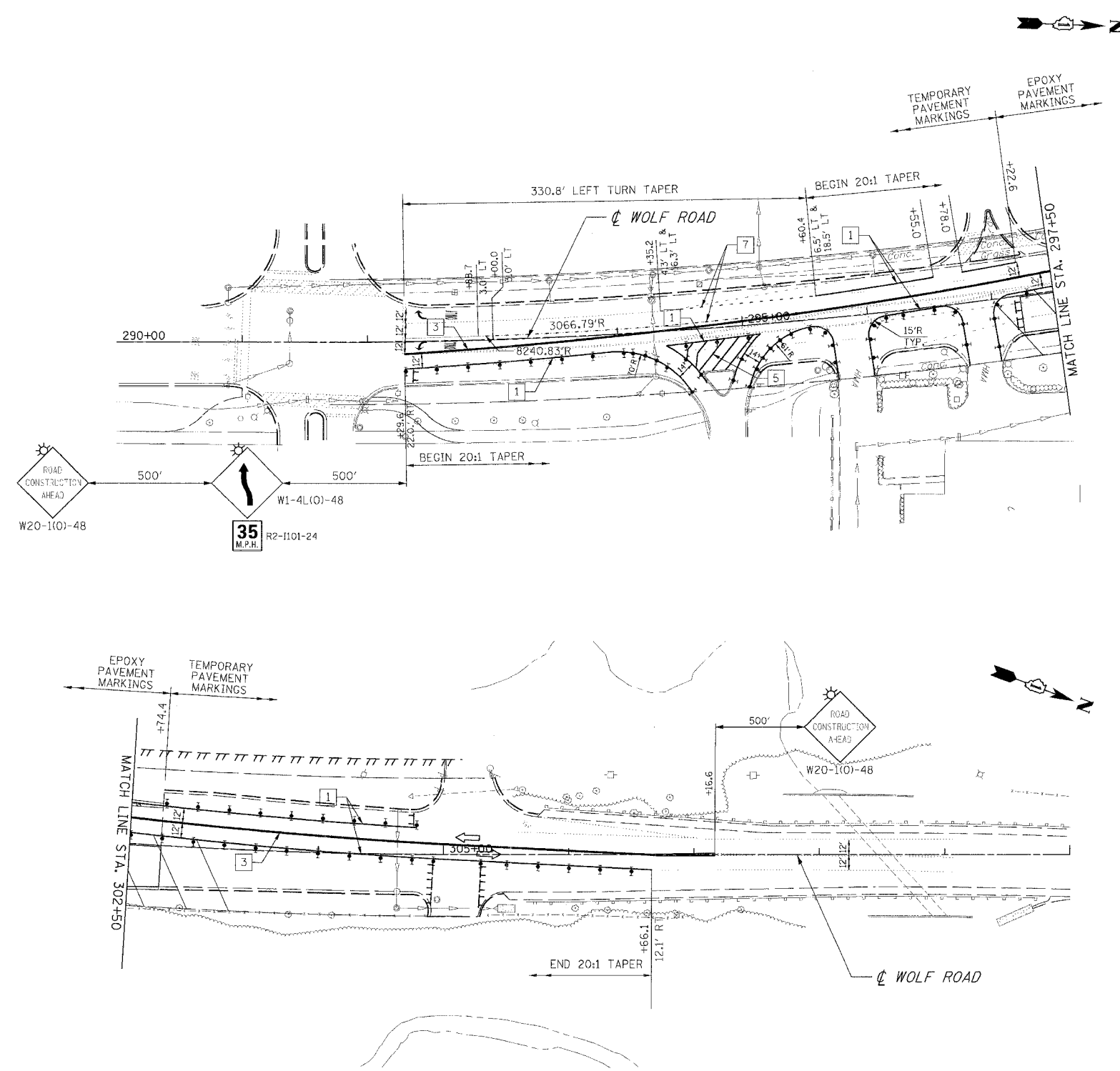

- PAVEMENT MARKING KEY**
- 1 4" SOLID - WHITE
 - 2 12" SOLID - YELLOW @ 20' C-C (5 MIN.)
 - 3 4" SOLID - YELLOW @ 11" C-C
 - 4 24" STOP BAR - WHITE
 - 5 12" SOLID - WHITE
 - 6 6" SOLID - WHITE
 - 7 6"- 6' SKIP/2' DASH - WHITE

- LEGEND**
- [] TEMPORARY PAVEMENT
 - [X] TEMPORARY PAVEMENT CONSTRUCTED IN EARLIER STAGE
 - [Z] CONSTRUCTION ZONE
 - [B] TYPE II BARRICADE, DRUM OR VERTICAL BARRICADE WITH STEADY BURN MONODIRECTIONAL LIGHT
 - [C] 50' C-C ON TANGENT
 - [D] 25' C-C ON TAPER
 - [E] 10' C-C ON CURVES
 - [>] DIRECTION OF TRAFFIC FLOW
 - [S] SIGN
 - [T] TYPE III BARRICADE WITH FLASHING LIGHTS
 - (XX) TEMPORARY STRUCTURE NUMBER
 - (XX) TEMPORARY PIPE NUMBER

REVISIONS	
NAME	DATE

ILLINOIS DEPARTMENT OF TRANSPORTATION
MAINTENANCE OF TRAFFIC
 STAGE 1
 WOLF ROAD
 SCALE : 1" = 50'
 DATE : 03/21/2008
 DRAWN BY : BAE
 CHECKED BY : GB