

F.A.P. RTE.	SECTION	COUNTY	TOTAL SHEETS	SHEET NO.
353	12R - 4	WILL	199	50
STA.		TO STA.		
FED. ROAD DIST. NO.		ILLINOIS		FED. AID PROJECT

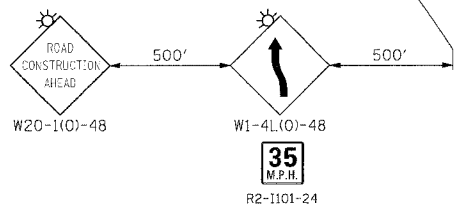
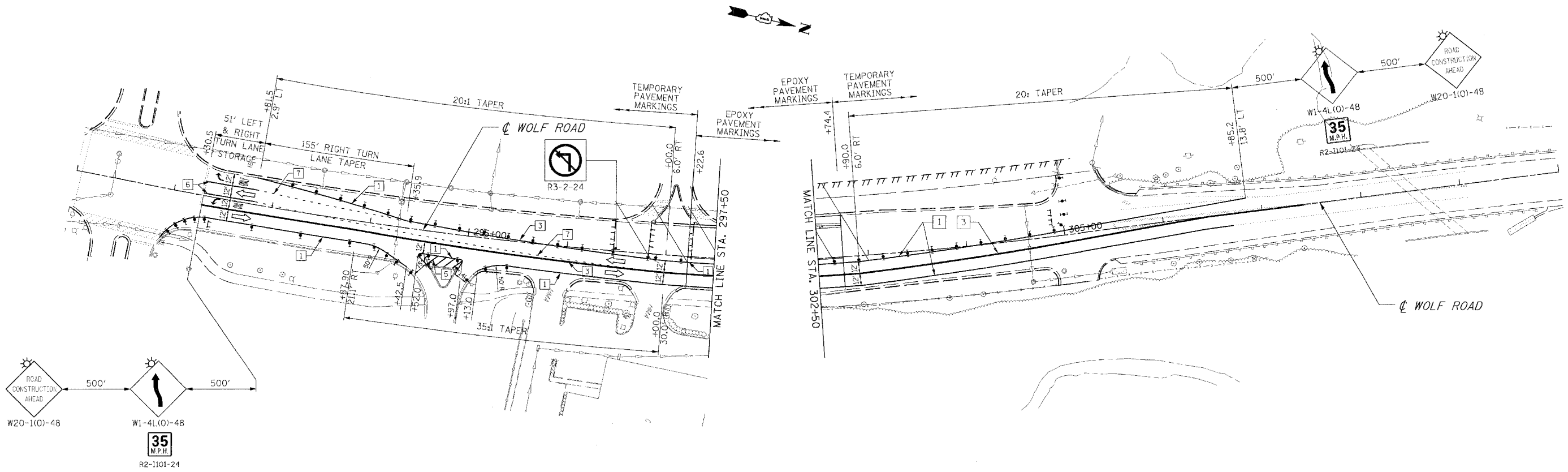

**LEGEND**

- [ ] TEMPORARY PAVEMENT
- [ ] TEMPORARY PAVEMENT CONSTRUCTED IN PRE-STAGE1
- [ ] TEMPORARY PAVEMENT CONSTRUCTED IN STAGE 1
- [ ] CONSTRUCTION ZONE
- [ ] TYPE II BARRICADE, DRUM OR VERTICAL BARRICADE WITH STEADY BURN MONODIRECTIONAL LIGHT
  - 50' C-C ON TANGENT
  - 25' C-C ON TAPER
  - 10' C-C ON CURVES
- [ ] DIRECTION OF TRAFFIC FLOW
- [ ] SIGN
- [ ] TYPE III BARRICADE WITH FLASHING LIGHTS
- (XX) TEMPORARY STRUCTURE NUMBER
- (XX) TEMPORARY PIPE NUMBER

**PAVEMENT MARKING KEY**

- [1] 4" SOLID - WHITE
- [2] 12" SOLID - YELLOW @ 20' C-C (5 MIN.)
- [3] 4" SOLID - YELLOW @ 11" C-C
- [4] 24" STOP BAR - WHITE
- [5] 12" SOLID - WHITE
- [6] 6" SOLID - WHITE
- [7] 4" SOLID - WHITE (2' DASH - 6' SKIP)

REVISIONS		ILLINOIS DEPARTMENT OF TRANSPORTATION MAINTENANCE OF TRAFFIC STAGE 2 WOLF ROAD
NAME	DATE	

SCALE : 1" = 50'  
DATE : 03/21/2008  
DRAWN BY : BAE  
CHECKED BY : GB