

F.A.P. RTE.	SECTION	COUNTY	TOTAL SHEETS	SHEET NO.
353	12R - 4	WILL	199	96
STA.	TO STA.			
FED. ROAD DIST. NO.	ILLINOIS	FED. AID PROJECT		

TEMPORARY TRAFFIC SIGNAL LEGEND

- ▶ TEMPORARY TRAFFIC SIGNAL HEAD SPAN WIRE MOUNTED ORIGINAL LOCATION
- ▶ TEMPORARY TRAFFIC SIGNAL HEAD SPAN WIRE MOUNTED SECONDARY LOCATION
- ⊗ TEMPORARY WOOD POLE (CLASS 5 OR BETTER) 45 FOOT (13.7m) MINIMUM
- ⊠ TEMPORARY CONTROLLER CABINET
- TEMPORARY SPAN WIRE, TETHER WIRE, AND CABLE
- ⊕ TEMPORARY SERVICE INSTALLATION
- TEMPORARY PEDESTRIAN SIGNAL HEAD, BRACKET MOUNTED
- MICROWAVE VEHICLE SENSOR
- CT COMMON TRENCH
- ▶ EMERGENCY VEHICLE LIGHT DETECTOR
- ▶ CONFIRMATION BEACON
- VEHICLE DETECTOR, INDUCTION LOOP
- UD UNIT DUCT
- G.S. CONDUIT IN TRENCH OR PUSHED
- HANDHOLE
- HEAVY-DUTY HANDHOLE
- TEMPORARY PEDESTRIAN PUSHBUTTON DETECTOR

EXISTING EQUIPMENT TO BE REMOVED LEGEND

- ⊗ EXISTING SIGNAL HEAD TO BE REMOVED
- EXISTING SERVICE INSTALLATION TO BE REMOVED
- EXISTING SIGNAL POST AND FOUNDATION TO BE REMOVED
- ⊗ EXISTING ALUMINUM MAST ARM POLE AND FOUNDATION TO BE REMOVED
- ⊠ EXISTING CONTROLLER AND FOUNDATION TO BE REMOVED
- ⊕ EXISTING HANDHOLE TO BE REMOVED
- EXISTING PEDESTRIAN SIGNAL HEAD TO BE REMOVED
- ⊗ EXISTING PEDESTRIAN PUSH BUTTON TO BE REMOVED
- ▶ EMERGENCY VEHICLE LIGHT DETECTOR TO BE REMOVED
- ▶ CONFIRMATION BEACON TO BE REMOVED
- ⊕ EXISTING HEAVY-DUTY HANDHOLE TO BE REMOVED
- ⊗ EXISTING STEEL MAST ARM POLE AND FOUNDATION TO BE REMOVED
- ⊗ EXISTING TEMPORARY WOOD POLE TO BE REMOVED
- ⊕ EXISTING VIDEO IMAGE SENSOR TO BE REMOVED
- ⊕ EXISTING RADIO INTERCONNECT ANTENNA TO BE REMOVED
- ⊕ EXISTING TEMPORARY SPAN, TETHER WIRE AND CABLE TO BE REMOVED

NOTE: EXISTING EMERGENCY VEHICLE LIGHT DETECTORS, CONFIRMATION BEACONS AND LIGHT DETECTOR AMPLIFIER SHALL BE RELOCATED TO PROPOSED PERMANENT TRAFFIC SIGNAL INSTALLATION.

NOTE: EXISTING MASTER CONTROLLER SHALL BE RELOCATED TO THE PROPOSED TRAFFIC CONTROLLER CABINET.

- THE FOLLOWING ITEMS SHALL BE REMOVED BY THE CONTRACTOR AND SHALL BE DISPOSED OF BY THEM OUTSIDE THE RIGHT-OF-WAY AT THEIR EXPENSE. THE SALVAGE VALUE OF THE REMOVED EQUIPMENT SHALL BE REFLECTED IN THE CONTRACT BID PRICE.
- 1 EACH SERVICE INSTALLATION
 - 1 EACH FULL-ACTUATED CONTROLLER AND TYPE V CABINET, SPECIAL
 - 1 EACH TRANSCEIVER
 - 4 EACH SIGNAL HEAD, LED, 1 FACE, 3 SECTION, SPAN WIRE MOUNTED
 - 8 EACH SIGNAL HEAD, LED, 1 FACE, 5 SECTION, SPAN WIRE MOUNTED
 - 1 EACH UNINTERRUPTIBLE POWER SUPPLY (UPS)

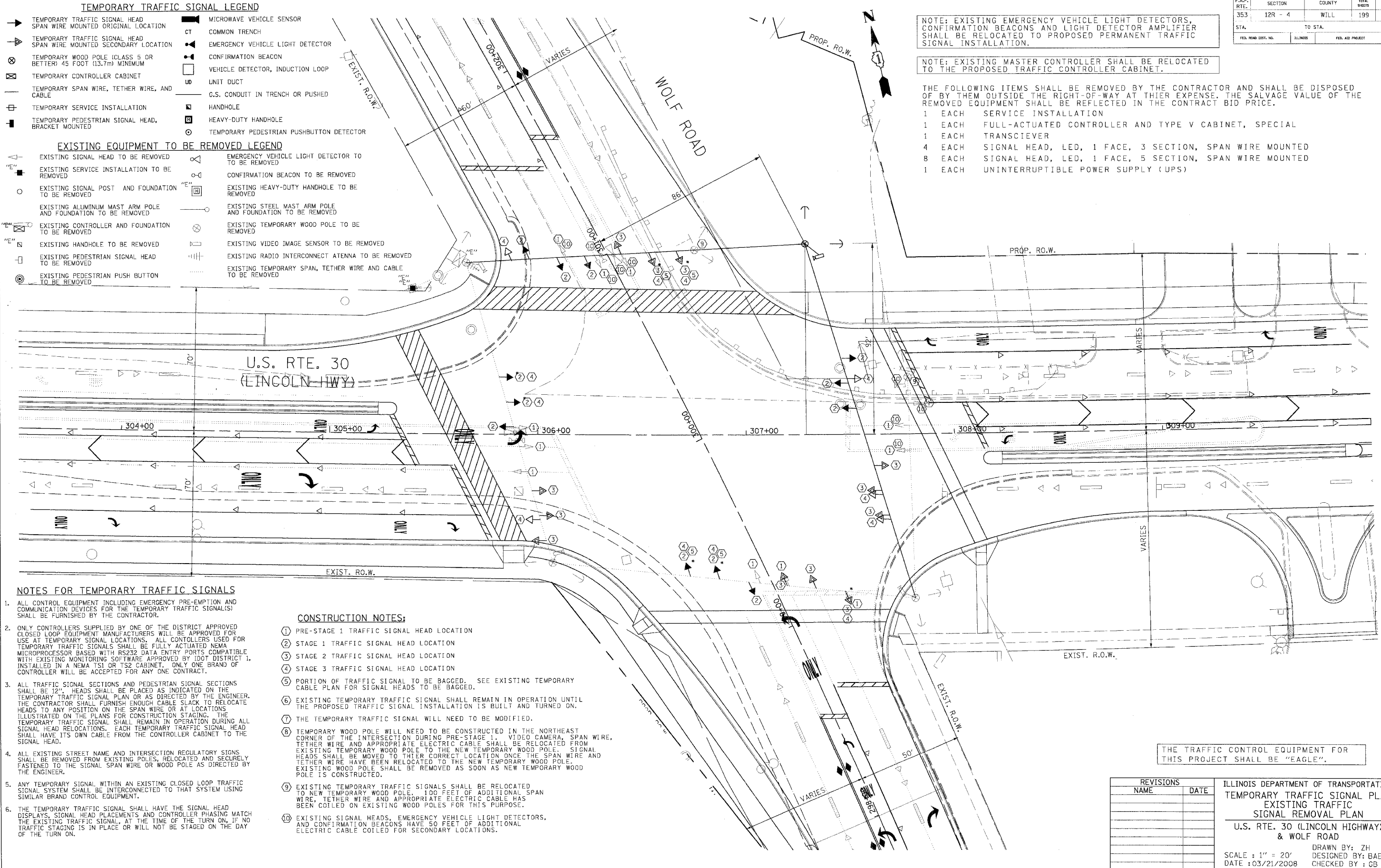

NOTES FOR TEMPORARY TRAFFIC SIGNALS

1. ALL CONTROL EQUIPMENT INCLUDING EMERGENCY PRE-EMPTION AND COMMUNICATION DEVICES FOR THE TEMPORARY TRAFFIC SIGNAL(S) SHALL BE FURNISHED BY THE CONTRACTOR.
2. ONLY CONTROLLERS SUPPLIED BY ONE OF THE DISTRICT APPROVED CLOSED LOOP EQUIPMENT MANUFACTURERS WILL BE APPROVED FOR USE AT TEMPORARY SIGNAL LOCATIONS. ALL CONTROLLERS USED FOR TEMPORARY TRAFFIC SIGNALS SHALL BE FULLY ACTUATED NEMA MICROPROCESSOR BASED WITH RS232 DATA ENTRY PORTS COMPATIBLE WITH EXISTING MONITORING SOFTWARE APPROVED BY IDOT DISTRICT 1. INSTALLED IN A NEMA TS1 OR TS2 CABINET. ONLY ONE BRAND OF CONTROLLER WILL BE ACCEPTED FOR ANY ONE CONTRACT.
3. ALL TRAFFIC SIGNAL SECTIONS AND PEDESTRIAN SIGNAL SECTIONS SHALL BE 12". HEADS SHALL BE PLACED AS INDICATED ON THE TEMPORARY TRAFFIC SIGNAL PLAN OR AS DIRECTED BY THE ENGINEER. THE CONTRACTOR SHALL FURNISH ENOUGH CABLE SLACK TO RELOCATE HEADS TO ANY POSITION ON THE SPAN WIRE OR AT LOCATIONS ILLUSTRATED ON THE PLANS FOR CONSTRUCTION STAGING. THE TEMPORARY TRAFFIC SIGNAL SHALL REMAIN IN OPERATION DURING ALL SIGNAL HEAD RELOCATIONS. EACH TEMPORARY TRAFFIC SIGNAL HEAD SHALL HAVE ITS OWN CABLE FROM THE CONTROLLER CABINET TO THE SIGNAL HEAD.
4. ALL EXISTING STREET NAME AND INTERSECTION REGULATORY SIGNS SHALL BE REMOVED FROM EXISTING POLES, RELOCATED AND SECURELY FASTENED TO THE SIGNAL SPAN WIRE OR WOOD POLE AS DIRECTED BY THE ENGINEER.
5. ANY TEMPORARY SIGNAL WITHIN AN EXISTING CLOSED LOOP TRAFFIC SIGNAL SYSTEM SHALL BE INTERCONNECTED TO THAT SYSTEM USING SIMILAR BRAND CONTROL EQUIPMENT.
6. THE TEMPORARY TRAFFIC SIGNAL SHALL HAVE THE SIGNAL HEAD DISPLAYS, SIGNAL HEAD PLACEMENTS AND CONTROLLER PHASING MATCH THE EXISTING TRAFFIC SIGNAL, AT THE TIME OF THE TURN ON, IF NO TRAFFIC STAGING IS IN PLACE OR WILL NOT BE STAGED ON THE DAY OF THE TURN ON.

CONSTRUCTION NOTES:

- ① PRE-STAGE 1 TRAFFIC SIGNAL HEAD LOCATION
- ② STAGE 1 TRAFFIC SIGNAL HEAD LOCATION
- ③ STAGE 2 TRAFFIC SIGNAL HEAD LOCATION
- ④ STAGE 3 TRAFFIC SIGNAL HEAD LOCATION
- ⑤ PORTION OF TRAFFIC SIGNAL TO BE BAGGED. SEE EXISTING TEMPORARY CABLE PLAN FOR SIGNAL HEADS TO BE BAGGED.
- ⑥ EXISTING TEMPORARY TRAFFIC SIGNAL SHALL REMAIN IN OPERATION UNTIL THE PROPOSED TRAFFIC SIGNAL INSTALLATION IS BUILT AND TURNED ON.
- ⑦ THE TEMPORARY TRAFFIC SIGNAL WILL NEED TO BE MODIFIED.
- ⑧ TEMPORARY WOOD POLE WILL NEED TO BE CONSTRUCTED IN THE NORTHEAST CORNER OF THE INTERSECTION DURING PRE-STAGE 1. VIDEO CAMERA, SPAN WIRE, TETHER WIRE AND APPROPRIATE ELECTRIC CABLE SHALL BE RELOCATED FROM EXISTING TEMPORARY WOOD POLE TO THE NEW TEMPORARY WOOD POLE. SIGNAL HEADS SHALL BE MOVED TO THEIR CORRECT LOCATION ONCE THE SPAN WIRE AND TETHER WIRE HAVE BEEN RELOCATED TO THE NEW TEMPORARY WOOD POLE. EXISTING WOOD POLE SHALL BE REMOVED AS SOON AS NEW TEMPORARY WOOD POLE IS CONSTRUCTED.
- ⑨ EXISTING TEMPORARY TRAFFIC SIGNALS SHALL BE RELOCATED TO NEW TEMPORARY WOOD POLE. 100 FEET OF ADDITIONAL SPAN WIRE, TETHER WIRE AND APPROPRIATE ELECTRIC CABLE HAS BEEN COILED ON EXISTING WOOD POLES FOR THIS PURPOSE.
- ⑩ EXISTING SIGNAL HEADS, EMERGENCY VEHICLE LIGHT DETECTORS, AND CONFIRMATION BEACONS HAVE 50 FEET OF ADDITIONAL ELECTRIC CABLE COILED FOR SECONDARY LOCATIONS.

THE TRAFFIC CONTROL EQUIPMENT FOR THIS PROJECT SHALL BE "EAGLE".

REVISIONS	
NAME	DATE

ILLINOIS DEPARTMENT OF TRANSPORTATION
 TEMPORARY TRAFFIC SIGNAL PLAN
 EXISTING TRAFFIC SIGNAL REMOVAL PLAN
 U.S. RTE. 30 (LINCOLN HIGHWAY) & WOLF ROAD

SCALE : 1" = 20'
 DATE : 03/21/2008

DRAWN BY: ZH
 DESIGNED BY: BAE
 CHECKED BY: GB