

F.A.P. RTE.	SECTION	COUNTY	TOTAL SHEETS	SHEET NO.
353	12R - 4	WILL	199	99
STA.	TO STA.			
FED. ROAD DIST. NO.	ILLINOIS	FED. AID PROJECT		

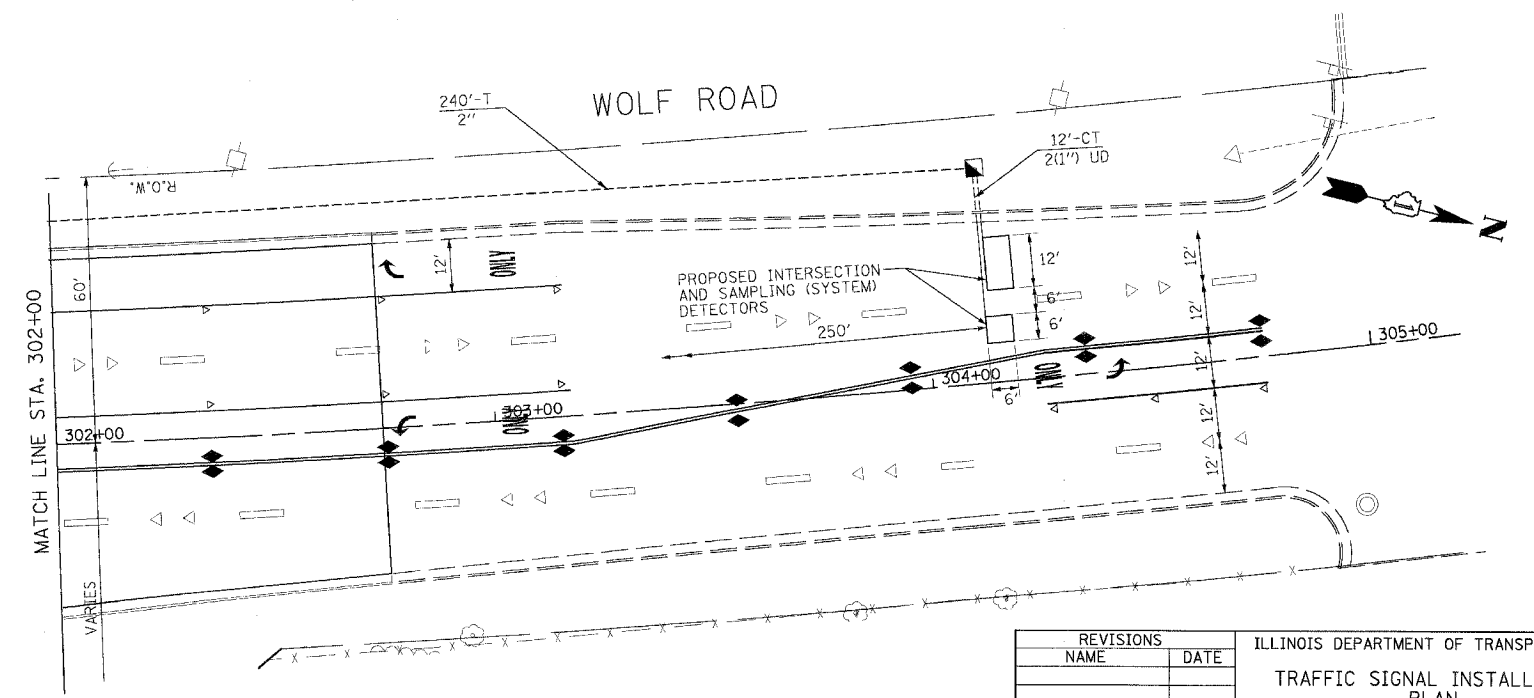
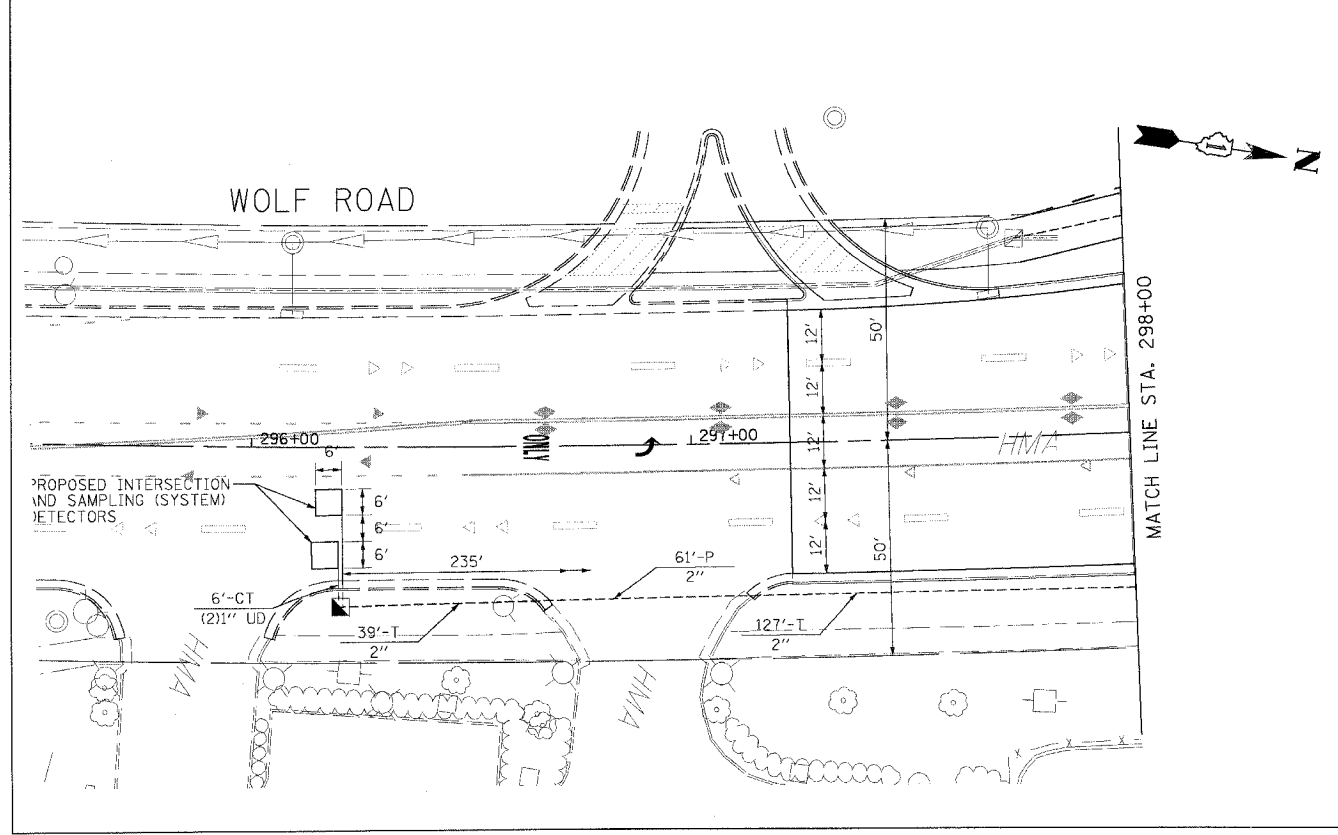
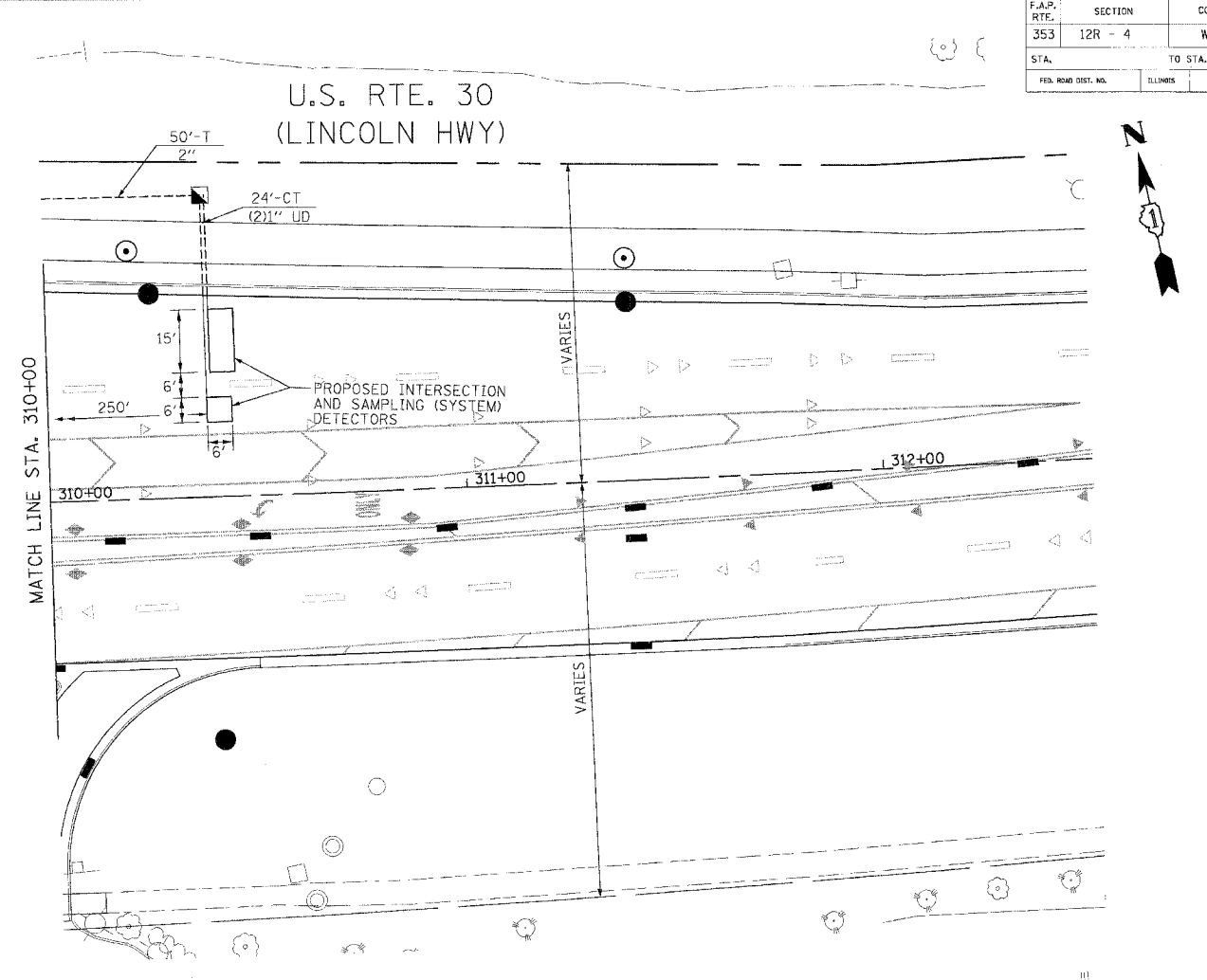
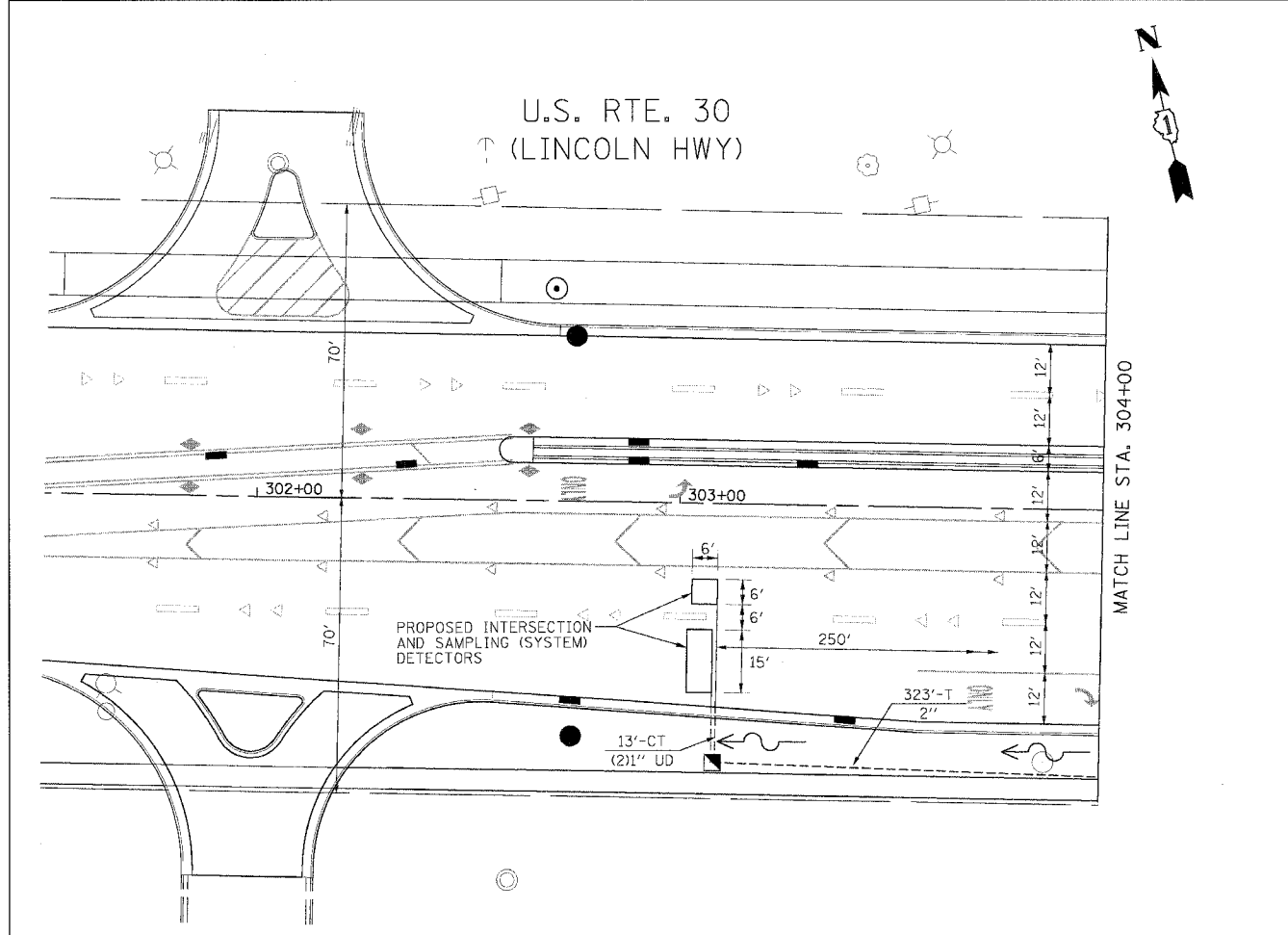

REVISIONS	
NAME	DATE

ILLINOIS DEPARTMENT OF TRANSPORTATION  
 TRAFFIC SIGNAL INSTALLATION PLAN  
 U.S. RTE. 30 AT WOLF ROAD  
 SCALE : 1" = 20'  
 DATE : 03/21/2008  
 DRAWN BY : ZH  
 DESIGNED BY: BAE  
 CHECKED BY : GB