

FINAL SURVEY SHEET
 NO. 101
 DATE 11/15/07
 BY [Signature]
 CHECKED [Signature]
 APPROVED [Signature]
 DATE 11/15/07

ORIGINAL SURVEY SHEET
 NO. 101
 DATE 11/15/07
 BY [Signature]
 CHECKED [Signature]
 APPROVED [Signature]
 DATE 11/15/07

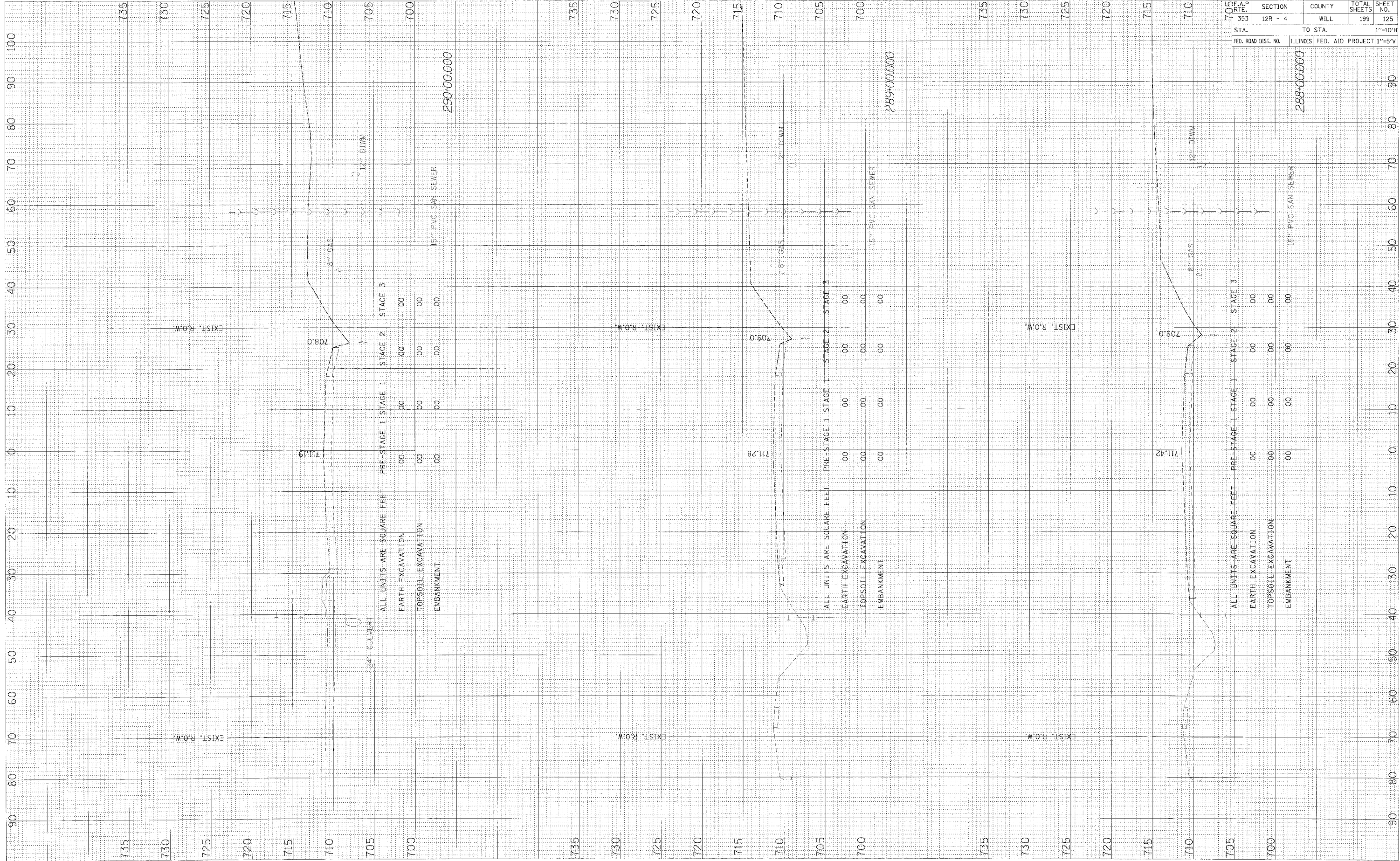

F.A.P. R.T.E.	SECTION	COUNTY	TOTAL SHEETS	SHEET NO.
353	12R - 4	WILL	199	125
STA.	TO STA.		1"=10'H	
FED. ROAD DIST. NO.	ILLINOIS	FED. AID PROJECT	1"=5'V	

US ROUTE 30 - PRE-STAGE 1 X-SECS

F:\GIS\2\Work\111\10R-FSISEC.dwg 8/19/2008