

ROUTE	SECTION	COUNTY	TOTAL SHEETS	SHEET NUMBER
VARIOUS	2008-046 RS	LAKE	29	1

**STATE OF ILLINOIS**  
**DEPARTMENT OF TRANSPORTATION**  
**DIVISION OF HIGHWAYS**  
**DISTRICT ONE**  
**PROPOSED HIGHWAY PLANS**

**CONTRACT NO. 60E95**

D-91-549-08

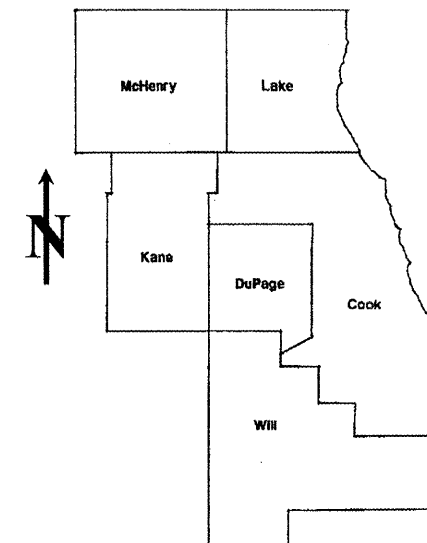

LOCATION OF IMPROVEMENT INDICATED THUS: 

VARIOUS ROUTES  
 SECTION: 2008-046 RS  
 VARIOUS LOCATIONS IN EAST LAKE COUNTY  
 INTERMITTANT PAVEMENT RESURFACING  
 LAKE COUNTY  
 C-91-549-08

FOR INDEX OF SHEETS SEE SHEET 2

**STATE OF ILLINOIS**  
**DEPARTMENT OF TRANSPORTATION**  
**DIVISION OF HIGHWAYS**

SUBMITTED: JUNE 18, 2008  
*Diane M. O'Keefe*  
 DEPUTY DIRECTOR OF HIGHWAYS, REGION ENGINEER

June 27, 2008  
*Eric E. Horn*  
 ENGINEER OF DESIGN AND ENVIRONMENT

June 27, 2008  
*Christine M. Reed*  
 DIRECTOR, DIVISION OF HIGHWAYS

**PRINTED BY THE AUTHORITY**  
**OF THE STATE OF ILLINOIS**

**J.U.L.I.E.: JOINT UTILITY LOCATION**  
**INFORMATION FOR EXCAVATION**  
 (312) 744-7000

**CONTRACT NO. 60E95**

DISTRICT ONE - DESIGN - PLAN PREPARATION ENGINEER:  
 KEN ENG / (847) 705-4247

INDEX OF SHEETS

<u>SHEET NO.</u>	<u>DESCRIPTION</u>
1	TITLE SHEET
2	INDEX OF SHEETS, STATE STANDARDS AND GENERAL NOTES
3	SUMMARY OF QUANTITIES
4	GENERAL LOCATION MAP
5	SUMMARY OF PATCHING SCHEDULE
6-23	PATCHING SCHEDULE
24	BUTT JOINT AND HMA TAPER DETAILS
25	TRAFFIC CONTROL AND PROTECTION FOR SIDE ROADS, INTERSECTIONS AND DRIVEWAYS
26	TYPICAL APPLICATIONS: RAISED REFLECTIVE PAVEMENT MARKERS (SNOW-PLOW RESISTANT)
27	DISTRICT ONE TYPICAL PAVEMENT MARKINGS
28	TRAFFIC CONTROL AND PROTECTION OF TURN BAYS (TO REMAIN OPEN TO TRAFFIC)
29	ARTERIAL ROAD INFORMATION SIGN

STATE STANDARDS

<u>STANDARD NO.</u>	<u>DESCRIPTION</u>
000001-05	TYPICAL SYMBOLS, ABBREVIATIONS AND PATTERNS
701201-02	LANE CLOSURE, 2L, 2W, DAY ONLY
701301-02	LANE CLOSURE, 2L, 2W, SHORT TIME OPERATIONS
701306-01	LANE CLOSURE, 2L, 2W, SLOW MOVING OPERATIONS - DAY ONLY
701336-04	LANE CLOSURE, 2L, 2W, WORK AREAS IN SERIES
701501-04	URBAN LANE CLOSURE, 2L, 2W, UNDIVIDED
701601-05	URBAN LANE CLOSURE, MULTILANE, 1W OR 2W WITH NONTRAVERSABLE MEDIAN
701606-05	URBAN LANE CLOSURE, MULTILANE, 2W WITH MOUNTABLE MEDIAN
701701-05	URBAN LANE CLOSURE, MULTILANE INTERSECTION
701901	TRAFFIC CONTROL DEVICES

GENERAL NOTES

BEFORE STARTING ANY EXCAVATION, THE CONTRACTOR SHALL CALL "JULIE" AT (800) 892-0123 OR 811 FOR FIELD LOCATIONS OF BURIED ELECTRIC, TELEPHONE AND GAS FACILITIES. (48 HOUR NOTIFICATION REQUIRED)

THE CONTRACTOR WILL NOT BE ALLOWED TO SET UP A YARD OR FIELD OFFICE ON STATE (OR TOLLWAY) PROPERTY WITHOUT WRITTEN PERMISSION FROM THE DEPARTMENT (OR ISTHA)

WHEN ARTIFICIAL LIGHTING IS UTILIZED IN NIGHT OPERATIONS, THE CONTRACTOR SHALL EXERCISE THE UTMOST PRECAUTIONS IN PREVENTING ADVERSE VISABILITY TO THE MOTORING PUBLIC AND ADJOINING RESIDENTIAL AREAS.

ANY PAVEMENT MARKINGS AND RAISED REFLECTIVE PAVEMENT MARKERS OBLITERATED BY MILLING AND RESURFACING OPERATIONS ON SIDE STREETS AND ENTRANCES SHALL BE REPLACED AND PAID FOR IN KIND.

BEFORE BEGINNING ANY WORK, THE CONTRACTOR SHALL RETAIN AND RECORD FOR FUTURE REFERENCE, ALL EXISTING PAVEMENT MARKING LINES (AND RAISED REFLECTIVE PAVEMENT MARKERS) IN ORDER THAT THESE LOCATIONS CAN BE RE-ESTABLISHED FOR STRIPING. EXACT LOCATIONS OF ALL PAVEMENT MARKINGS SHALL BE AS DIRECTED BY THE ENGINEER.

ALL PAVEMENT PATCHING LOCATIONS WILL BE DETERMINED IN THE FIELD BY THE ENGINEER.

THE CONTRACTOR SHALL CONTACT THE DISTRICT ONE TRAFFIC CONTROL SUPERVISOR AT (847) 705-4470 A MINIMUM OF 72 HOURS IN ADVANCE OF BEGINNING WORK.

THE ENGINEER SHALL CONTACT MS. DEBBIE HANLON, AREA TRAFFIC FIELD ENGINEER AT (815) 438-2300 MINIMUM OF TWO (2) WEEKS PRIOR TO PLACEMENT OF PERMANENT PAVEMENT MARKINGS.

DOUBLE LANE MARKERS ARE TO BE USED AS SHOWN ON THE DISTRICT ONE DETAIL "TYPICAL APPLICATIONS - RAISED REFLECTIVE PAVEMENT MARKERS (SNOW-PLOW RESISTANT)" SHOWN IN THE PLANS.

THE EXISTING ROADWAY TYPICAL SECTION IS ASSUMED TO HAVE A 3 INCH HOT-MIX ASPHALT OVERLAY ON TOP OF A TEN INCH CONCRETE BASE.

THE COST OF TRAFFIC CONTROL AND PROTECTION FOR THE PROJECT SHALL BE INCLUDED IN THE COST OF THE ASSOCIATED ROAD WORK.

THE COST OF ANY PARTIAL OR FULL DEPTH PATCHING REQUIRED AFTER THE REMOVAL OF THE EXISTING 2 INCH HOT-MIX ASPHALT SURFACE SHALL BE PAID FOR IN ACCORDANCE WITH ARTICLE 109.04 OF THE STANDARD SPECIFICATIONS.

HOT-MIX ASPHALT MIXTURE REQUIREMENTS

MIXTURE TYPE	AC TYPE	AIR VOIDS (%)
HOT-MIX ASPHALT SURFACE COURSE, MIX "D", N70 (IL 9.5MM), 2"	PG 64-22	4% @ 70 GYR

THE UNIT WEIGHT USED TO CALCULATE ALL HOT-MIX ASPHALT SURFACE MIXTURE QUANTITIES IS 112 LBS/SY/IN.

SUMMARY OF QUANTITIES			URBAN 100% STATE		CONSTRUCTION TYPE CODE				
CODE NO	ITEM	UNIT	TOTAL QUANTITIES						
				1000-2A					
40600200	BITUMINOUS MATERIALS (PRIME COAT)	TON	22	22					
40600300	AGGREGATE (PRIME COAT)	TON	107	107					
40600400	MIXTURE FOR CRACKS, JOINTS, AND FLANGEWAYS	TON	160	160					
40600982	HOT-MIX ASPHALT SURFACE REMOVAL - BUTT JOINT	SO YD	1193	1193					
40603340	HOT-MIX ASPHALT SURFACE COURSE, MIX "D", N70	TON	5948	5948					
44000157	HOT-MIX ASPHALT SURFACE REMOVAL, 2"	SO YD	53103	53103					
67000400	ENGINEER'S FIELD OFFICE, TYPE A	CAL MO	3	3					
67100100	MOBILIZATION	L SUM	1	1					
70300100	SHORT-TERM PAVEMENT MARKING	FOOT	16228	16228					
70301000	WORK ZONE PAVEMENT MARKING REMOVAL	SO FT	5410	5410					
* 78000200	THERMOPLASTIC PAVEMENT MARKING - LINE 4"	FOOT	243414	243414					
* 78100100	RAISED REFLECTIVE PAVEMENT MARKER	EACH	1014	1014					
78300200	RAISED REFLECTIVE PAVEMENT MARKER REMOVAL	EACH	1014	1014					
X0322256	TEMPORARY INFORMATION SIGNING	SO FT	669	669					

SUMMARY OF QUANTITIES			CONSTRUCTION TYPE CODE						
CODE NO	ITEM	UNIT	TOTAL QUANTITIES						

\* SPECIALTY ITEM

REVISIONS	
NAME	DATE

ILLINOIS DEPARTMENT OF TRANSPORTATION  
SUMMARY OF QUANTITIES

PLOT DATE: 6/26/2008

6/26/2008 2:00:00 PM P:\projects\136008\design\as.dgn

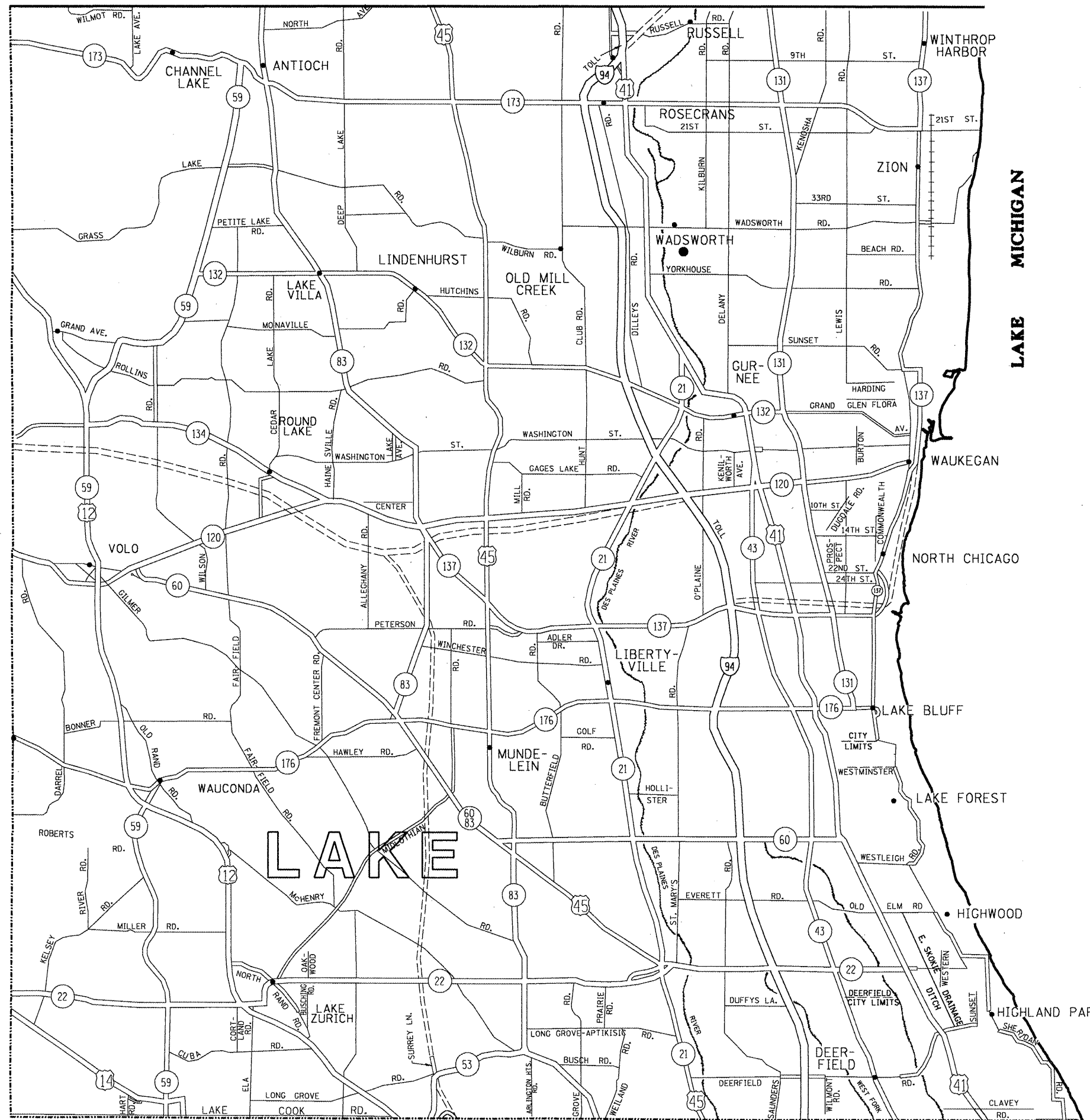

**STATE OF ILLINOIS  
DEPARTMENT OF TRANSPORTATION**

**GENERAL LOCATION MAP - LAKE COUNTY**

FILE NAME =  
c:\projects\136008\design\_aa.dgn

USER NAME = wilgreendp  
PLOT SCALE = 100.0000' / IN.  
PLOT DATE = 6/26/2008

DESIGNED -	REVISED -
DRAWN -	REVISED -
CHECKED -	REVISED -
DATE -	REVISED -

SCALE: SHEET NO. OF SHEETS STA. TO STA.

F.A. RTE.	SECTION	COUNTY	TOTAL SHEETS	SHEET NO.
VAR.	2008-046 RS	LAKE	29	4
CONTRACT NO. 60E95				
FED. ROAD DIST. NO. 1 [ILLINOIS] FED. AID PROJECT				

EAST LAKE COUNTY ROUTE SEGMENT	MILL & RESURFACE (SY)
US 41(Washington St. to S/O IL 132)	1432
IL 21 (Lake Cook Rd to IL 60)	3774
IL. RTE 137 (IL. 83 TO IL RTE 21)	4094
IL Rte 137 (Wadsworth Rd to 33rd St)	757
IL Rte 43 (Talbot Ave to Albrecht Dr)	4544
IL Rte 22 (Rte 43 to Westminster Way)	1350
IL 22	1715
IL Rte 132 (US Rte 45 to I-94 Tollway)	7876
RTE 131 (GREENBAY ROAD): From RTE 137 to RTE 120	536
IL Rte 176 (St. mary's Road to IL 21)	271
Old Skokie Hwy (Wisc.State Line to I94 Tollway Ramp)	708
22ND STREET (MARTIN LUTHER KING DRIVE)	514
SHERIDAN ROAD: From Amstutz Expressway to 22ND STREET IN North Chicago	25532
<b>SUMMARY TOTALS:</b>	<b>53103</b>
	<b>SY</b>

FILE NAME =  
 c:\projects\136000\design\_aa.dgn  
 USER NAME = wilgreendp  
 PLLOT SCALE = 100.0000 ' / IN.  
 PLOT DATE = 6/26/2008

DESIGNED -	REVISED -
DRAWN -	REVISED -
CHECKED -	REVISED -
DATE -	REVISED -

**STATE OF ILLINOIS  
 DEPARTMENT OF TRANSPORTATION**

**SUMMARY OF PATCHING SCHEDULE  
 LAKE COUNTY**

SCALE: SHEET NO. OF SHEETS STA. TO STA.

F.A. RTE.	SECTION	COUNTY	TOTAL SHEETS	SHEET NO.
VAR.	2008-046 RS	LAKE	29	5
FED. ROAD DIST. NO. 1   ILLINOIS   FED. AID PROJECT			CONTRACT NO. 60E95	

ROUTE: US 41(Washington St. to S/O IL 132)

CROSS STREETS		DIRECTION (EB/WB) (NB/SB)	LANE NO. (1, 2, 3)	PAVEMENT PATCH WIDTH	PAVEMENT PATCH LENGTH	REPAIR AREA (SQ FT)	REPAIR AREA (SQ YD)
FROM	TO						
Washington	IL 132	NB	1&2	2	1500	2250	250
		NB	1&2	3	500	1500	167
		NB	1	12	30	360	40
		NB	2	12	30	360	40
		NB	1	6	12	72	8
		NB	2	6	12	72	8
		NB	1	4	4	16	2
		NB	2	4	4	16	2
		NB	1	6	12	72	8
		NB	2	4	12	48	5
		NB	1	4	12	48	5
		NB	1	4	12	48	5
		NB	1	4	12	48	5
		NB	1	8	12	96	11
		NB	1	8	12	96	11
		NB	2	8	12	96	11
		NB	2	8	12	96	11
		NB	1	4	12	48	5
		NB	2	6	12	72	8
		NB	2	4	30	120	13
		NB	2	4	6	24	3
		NB	2	4	6	24	3
		NB	2	4	12	48	5
		NB	1	4	12	48	5
		NB	2	4	12	48	5
		NB	1	4	12	48	5
		NB	2	12	12	144	16
		NB	2	4	12	48	5
		NB	2	4	4	16	2
		NB	2	4	4	16	2
		NB	2	4	100	400	44
		NB	2	6	150	900	100
		NB	2	6	100	600	67
		SB	2	4	4	16	2
		SB	2	4	4	16	2
		SB	1&2	2	1500	2250	250
		SB	1&2	3	500	1500	167
		SB	2	4	4	16	2
		SB	2	4	4	16	2
		SB	1	4	12	48	5
		SB	1	4	6	24	3
		SB	2	4	4	16	2
		SB	2	4	12	48	5
		SB	2	4	6	24	3
		SB	2	4	4	16	2
		SB	2	6	30	180	20
		SB	2	4	4	16	2
		SB	2	4	4	16	2
		SB	2	4	12	48	5
		SB	Ramp	12	30	360	40
		SB	1	4	4	16	2
		SB	1	4	4	16	2
		SB	2	4	4	16	2
		SB	2	4	4	16	2
		SB	1	4	8	32	4
		SB	1	4	8	32	4
		SB	2	4	8	32	4
		SB	2	4	8	32	4
		SB	1	4	12	48	5
		SB	1	4	12	48	5
		SB	2	4	12	48	5
		SB	2	4	12	48	5

TOTALS 4932 1432 SY

FILE NAME =  
c:\projects\136008\design\_sa.dgn  
USER NAME = wilgreendp  
DESIGNED -  
DRAWN -  
PLOT SCALE = 100.0000' / IN.  
CHECKED -  
PLOT DATE = 6/26/2008  
DATE -

DESIGNED -  
DRAWN -  
CHECKED -  
DATE -  
REVISED -  
REVISED -  
REVISED -  
REVISED -

**STATE OF ILLINOIS  
DEPARTMENT OF TRANSPORTATION**

**PATCHING SCHEDULE  
US 41**

SCALE: SHEET NO. OF SHEETS STA. TO STA.

F.A. RTE.	SECTION	COUNTY	TOTAL SHEETS	SHEET NO.
VAR.	2008-046 RS	LAKE	29	6
FED. ROAD DIST. NO. 1   ILLINOIS FED. AID PROJECT			CONTRACT NO. 60E95	



ROUTE: IL 21 (Lake Cook Rd to IL 60)

CROSS STREETS		DIRECTION (EB/WB) (NB/SB)	LANE NO. (1, 2, 3)	PAVEMENT PATCH WIDTH	PAVEMENT PATCH LENGTH	REPAIR AREA (SQ FT)	REPAIR AREA (SQ YD)		
FROM	TO								
Marriott Drive	Aptakistic Road	SB	2	12	4	48	5		
		SB	2	12	4	48	5		
		SB	2	12	6	72	8		
		SB	2	12	4	48	5		
		SB	2	3	200	600	67		
		SB	2	12	4	48	5		
		SB	2	12	10	120	13		
		SB	1	12	4	48	5		
		SB	1	12	4	48	5		
		SB	1	12	4	48	5		
Aptakistic Road	Deerfield Parkway	SB	2	4	20	80	9		
		SB	2	12	8	96	11		
		SB	2	12	8	96	11		
		SB	2	12	4	48	5		
		SB	2	12	4	48	5		
		SB	2	4	12	48	5		
		SB	2	12	4	48	5		
		SB	2	12	4	48	5		
		SB	2	12	4	48	5		
		SB	2	12	10	120	13		
Deerfield Parkway	Lake Cook Road	SB	2	12	12	144	16		
		SB	2	12	12	144	16		
		SB	2	12	4	48	5		
		SB	2	12	8	96	11		
		SB	2	12	4	48	5		
		SB	1&2	3	800	2400	267		
		SB	2	12	4	48	5		
		Lake Cook Road	Deerfield Parkway	NB	2	12	4	48	5
				NB	2	12	4	48	5
				NB	2	12	6	72	8
NB	2			12	6	72	8		
NB	2			12	4	48	5		
NB	2			12	4	48	5		
NB	1			6	12	72	8		
NB	2			12	4	48	5		
NB	2			6	6	36	4		
NB	2			6	6	36	4		
Deerfield Pkwy	Aptakistic	NB	2	12	4	48	5		
		NB	2	12	4	48	5		
		NB	2	12	4	48	5		
		NB	2	12	4	48	5		
		NB	1	12	4	48	5		
		NB	2	12	4	48	5		
		NB	2	12	4	48	5		
		NB	2	4	20	80	9		
		NB	1&2	2	500	750	83		
		Aptakistic	IL 22	NB	1	12	4	48	5
NB	1			12	4	48	5		
NB	1			12	4	48	5		
NB	LT TN			12	4	48	5		
NB	1			12	4	48	5		
NB	2			3	200	600	67		
NB	2			12	4	48	5		
NB	2			4	15	60	7		
IL 22	IL 45			NB	2	6	10	60	7
				NB	1	12	4	48	5
		NB	2	12	6	72	8		
		NB	2	12	6	72	8		
		NB	2	12	6	72	8		
		NB	2	12	15	180	20		
		NB	2	12	4	48	5		
		NB	2	12	4	48	5		
		NB	2	12	4	48	5		
		NB	2	12	4	48	5		

ROUTE: IL 21 (Lake Cook Rd to IL 60)

CROSS STREETS		DIRECTION (EB/WB) (NB/SB)	LANE NO. (1, 2, 3)	PAVEMENT PATCH WIDTH	PAVEMENT PATCH LENGTH	REPAIR AREA (SQ FT)	REPAIR AREA (SQ YD)		
FROM	TO								
IL 22	IL 45	NB	1&2	3	100	300	33		
		NB	2	12	20	240	27		
		NB	1	12	12	144	16		
		NB	1&2	2	100	150	17		
		NB	2	12	4	48	5		
		NB	2	12	4	48	5		
		NB	1	12	4	48	5		
		IL 45	Woodlands Pkwy	NB	1	12	4	48	5
				NB	1	12	4	48	5
				NB	2	12	4	48	5
NB	2			12	4	48	5		
NB	2			12	4	48	5		
NB	2			12	4	48	5		
NB	1			4	12	48	5		
NB	1			12	4	48	5		
NB	1			12	4	48	5		
NB	1			12	4	48	5		
Woodlands Pkwy	CDW Way	NB	1	12	4	48	5		
		NB	2	12	4	48	5		
		NB	1	12	4	48	5		
		NB	1	12	4	48	5		
		NB	1	12	4	48	5		
		NB	1	12	4	48	5		
		NB	1	6	10	60	7		
		NB	1	12	4	48	5		
		NB	1	12	4	48	5		
		NB	1	12	4	48	5		
CDW Way	Executive Dr	NB	1&2	2	200	300	33		
		NB	2	12	4	48	5		
		NB	2	12	4	48	5		
		NB	2	12	4	48	5		
		NB	2	12	4	48	5		
		NB	2	12	4	48	5		
		NB	2	12	12	144	16		
		NB	2	12	15	180	20		
		NB	2	12	12	144	16		
		NB	2	12	4	48	5		
Executive Dr	IL 60	NB	2	12	6	72	8		
		NB	2	12	4	48	5		
		NB	2	12	4	48	5		
		NB	2	12	4	48	5		
		NB	2	12	4	48	5		
		NB	1	12	4	48	5		
		NB	1&2	3	300	900	100		
		NB	1	12	4	48	5		
		NB	RT EP	3	500	1500	167		
		NB	2	12	4	48	5		

TOTALS: 8460 3774 SY







ROUTE: IL RTE 137 (IL. 83 TO IL RTE 21)

CROSS STREETS		DIRECTION (EB/WB) (NB/SB)	LANE NO. (1, 2, 3)	PAVEMENT PATCH WIDTH	PAVEMENT PATCH LENGTH	REPAIR AREA (SQ FT)	REPAIR AREA (SQ YD)
FROM	TO						
US. RTE 45		EB	1	12	6	72	8
		EB	1	12	6	72	8
		EB	1	12	6	72	8
		EB	1	12	6	72	8
		EB	1	12	6	72	8
		EB	1	12	6	72	8
		EB	1	12	6	72	8
		EB	1	12	6	72	8
		EB	1	12	6	72	8
		EB	1	12	6	72	8
		EB	1	12	6	72	8
		EB	1	12	6	72	8
		EB	1	12	6	72	8
		EB	1	12	6	72	8
		WB	1	12	4	48	5
		WB	1	12	4	48	5
		WB	1	12	4	48	5
		WB	1	12	6	72	8
		WB	1	12	6	72	8
		WB	1	12	6	72	8
		WB	1	12	6	72	8
		WB	1	12	6	72	8
		WB	1	12	6	72	8
		WB	1	12	6	72	8
		WB	1	12	6	72	8
		WB	1	12	6	72	8
		WB	1	12	6	72	8
		WB	1	12	6	72	8
		WB	1	12	6	72	8
		WB	1	12	6	72	8
		WB	1	12	6	72	8
		WB	1	12	6	72	8
		WB	1	6	40	240	27
		CL	CL	3	50	150	17
		CL	CL	3	50	150	17
		CL	CL	3	50	150	17
		CL	CL	3	100	300	33
		CL	CL	3	100	300	33
		CL	CL	3	100	300	33
		CL	CL	3	200	600	67
		CL	CL	3	200	600	67
	IL. RTE 137	CL	CL	3	200	600	67

TOTALS: 8934 4094 SY

ROUTE: IL Rte 137 (Wadsworth Rd to 33rd St)

CROSS STREETS		DIRECTION (EB/WB) (NB/SB)	LANE NO. (1, 2, 3)	PAVEMENT PATCH WIDTH	PAVEMENT PATCH LENGTH	REPAIR AREA (SQ FT)	REPAIR AREA (SQ YD)
FROM	TO						
Wadsworth Rd	33rd St	NB	1	3	400	1200	133
Wadsworth Rd	33rd St	NB	2	12	140	1680	187
Wadsworth Rd	33rd St	NB	2	12	4	48	1
Wadsworth Rd	33rd St	NB	1	3	100	300	33
Wadsworth Rd	33rd St	NB	1	12	4	48	5
Wadsworth Rd	33rd St	NB	2	12	4	48	5
Wadsworth Rd	33rd St	NB	1	12	4	48	5
Wadsworth Rd	33rd St	NB	2	12	4	48	5
Wadsworth Rd	33rd St	NB	1	12	4	48	5
Wadsworth Rd	33rd St	NB	2	12	4	48	5
Wadsworth Rd	33rd St	NB	2	12	4	48	1
Wadsworth Rd	33rd St	NB	2	12	4	48	1
Wadsworth Rd	33rd St	NB	2	12	4	48	5
Wadsworth Rd	33rd St	NB	2	4	12	48	5
Wadsworth Rd	33rd St	NB	1	3	50	150	17
Wadsworth Rd	33rd St	NB	2	6	15	90	10
Wadsworth Rd	33rd St	NB	2	12	4	48	5
Wadsworth Rd	33rd St	NB	1	3	300	900	100
Wadsworth Rd	33rd St	NB	2	12	4	48	1
Wadsworth Rd	33rd St	NB	2	12	4	48	1
Wadsworth Rd	33rd St	NB	2	12	4	48	5
Wadsworth Rd	33rd St	NB	2	12	4	48	1
Wadsworth Rd	33rd St	NB	2	12	4	48	1
33rd St	Wadsworth Rd	SB	1	12	4	48	1
33rd St	Wadsworth Rd	SB	2	12	4	48	1
33rd St	Wadsworth Rd	SB	2	12	4	48	1
33rd St	Wadsworth Rd	SB	1	3	50	150	17
33rd St	Wadsworth Rd	SB	2	12	4	48	5
33rd St	Wadsworth Rd	SB	2	12	4	48	1
33rd St	Wadsworth Rd	SB	2	12	4	48	1
33rd St	Wadsworth Rd	SB	2	12	4	48	5
33rd St	Wadsworth Rd	SB	2	12	4	48	1
33rd St	Wadsworth Rd	SB	2	12	4	48	1
33rd St	Wadsworth Rd	SB	1	3	200	600	67
33rd St	Wadsworth Rd	SB	2	12	4	48	1
33rd St	Wadsworth Rd	SB	2	12	4	48	1
33rd St	Wadsworth Rd	SB	2	12	4	48	5
33rd St	Wadsworth Rd	SB	2	12	4	48	5
33rd St	Wadsworth Rd	SB	2	12	4	48	5
33rd St	Wadsworth Rd	SB	1	3	50	150	17
33rd St	Wadsworth Rd	SB	2	12	4	48	5
33rd St	Wadsworth Rd	SB	1	12	4	48	1
33rd St	Wadsworth Rd	SB	2	12	4	48	1
33rd St	Wadsworth Rd	SB	1	12	4	48	5
33rd St	Wadsworth Rd	SB	2	12	4	48	5
33rd St	Wadsworth Rd	SB	2	12	4	48	5
33rd St	Wadsworth Rd	SB	2	12	4	48	5
33rd St	Wadsworth Rd	SB	1	12	4	48	5
33rd St	Wadsworth Rd	SB	2	12	4	48	5
33rd St	Wadsworth Rd	SB	2	12	4	48	5
33rd St	Wadsworth Rd	SB	2	12	4	48	5
33rd St	Wadsworth Rd	SB	1	12	4	48	5
33rd St	Wadsworth Rd	SB	2	12	4	48	5
33rd St	Wadsworth Rd	SB	1	12	4	48	1
33rd St	Wadsworth Rd	SB	1	12	4	48	5
33rd St	Wadsworth Rd	SB	2	12	4	48	5
33rd St	Wadsworth Rd	SB	2	12	4	48	5
33rd St	Wadsworth Rd	SB	2	12	4	48	5
33rd St	Wadsworth Rd	SB	2	8	8	64	7
33rd St	Wadsworth Rd	SB	2	8	8	64	7
33rd St	Wadsworth Rd	SB	2	12	4	48	5

TOTALS: 1513 757 SY

FILE NAME = c:\projects\dl36808\design_aa.dgn	USER NAME = wilgreendp	DESIGNED -	REVISED -	<b>STATE OF ILLINOIS DEPARTMENT OF TRANSPORTATION</b>	<b>PATCHING SCHEDULE IL 137</b>				F.A. RTE.	SECTION	COUNTY	TOTAL SHEETS	SHEET NO.
		DRAWN -	REVISED -		SCALE:	SHEET NO.	OF	SHEETS	STA.	TO STA.	LAKE	29	12
		CHECKED -	REVISED -		CONTRACT NO. 60E95								
		DATE -	REVISED -		FED. ROAD DIST. NO. 1 ILLINOIS FED. AID PROJECT								

ROUTE: IL Rte 43 (Talbot Ave to Albrecht Dr)

CROSS STREETS		DIRECTION (EB/WB) (NB/SB)	LANE NO. (1, 2, 3)	PAVEMENT PATCH WIDTH	PAVEMENT PATCH LENGTH	REPAIR AREA (SQ FT)	REPAIR AREA (SQ YD)
FROM	TO						
Talbot Ave	Foster Ave	SB	2	3	1600	4800	533
Talbot Ave	Foster Ave	SB	1	12	6	72	8
Talbot Ave	Foster Ave	SB	2	12	6	72	8
Talbot Ave	Foster Ave	SB	2	12	4	48	5
Talbot Ave	Foster Ave	SB	2	12	4	48	5
Talbot Ave	Foster Ave	SB	1	12	250	3000	333
Talbot Ave	Foster Ave	SB	1	12	150	1800	200
Talbot Ave	Foster Ave	SB	1	12	30	360	40
Talbot Ave	Foster Ave	SB	1	12	25	300	33
Foster Ave	IL Rte 176	SB	2	3	1500	4500	500
Foster Ave	IL Rte 176	SB	2	12	6	72	8
Foster Ave	IL Rte 176	SB	1	12	6	72	8
Foster Ave	IL Rte 176	SB	2	12	6	72	8
Foster Ave	IL Rte 176	SB	1	12	6	72	8
Foster Ave	IL Rte 176	SB	2	12	6	72	8
Foster Ave	IL Rte 176	SB	2	3	25	75	8
IL Rte 176	Albrecht Dr	SB	2	3	1500	4500	500
IL Rte 176	Albrecht Dr	SB	2	12	4	48	5
IL Rte 176	Albrecht Dr	SB	2	2	24	48	5
IL Rte 176	Albrecht Dr	SB	1	12	150	1800	200
IL Rte 176	Albrecht Dr	SB	2	12	5	60	7
IL Rte 176	Albrecht Dr	SB	2	12	8	96	11
IL Rte 176	Albrecht Dr	SB	2	12	8	96	11
IL Rte 176	Albrecht Dr	SB	2	12	4	48	5
IL Rte 176	Albrecht Dr	SB	2	3	8	24	3
IL Rte 176	Albrecht Dr	SB	2	3	500	1500	167
Albrecht Dr	IL Rte 176	NB	2	3	2200	6600	733
Albrecht Dr	IL Rte 176	NB	2	12	4	48	5
Albrecht Dr	IL Rte 176	NB	2	12	4	48	5
Albrecht Dr	IL Rte 176	NB	2	12	4	48	5
Albrecht Dr	IL Rte 176	NB	2	12	4	48	5
Albrecht Dr	IL Rte 176	NB	2	12	4	48	5
Albrecht Dr	IL Rte 176	NB	2	12	4	48	5
Albrecht Dr	IL Rte 176	NB	2	12	4	48	5
Albrecht Dr	IL Rte 176	NB	2	12	4	48	5
Albrecht Dr	IL Rte 176	NB	2	3	150	450	50
Albrecht Dr	IL Rte 176	NB	2	12	4	48	5
IL Rte 176	Foster Ave	NB	2	3	1500	4500	500
IL Rte 176	Foster Ave	NB	2	4	24	96	11
IL Rte 176	Foster Ave	NB	2	2	24	48	5
IL Rte 176	Foster Ave	NB	2	3	40	120	13
IL Rte 176	Foster Ave	NB	2	12	8	96	11
Foster Ave	Talbot Ave	NB	2	3	1600	4800	533
Foster Ave	Talbot Ave	NB	2	12	4	48	5
Foster Ave	Talbot Ave	NB	2	12	4	48	5

TOTALS: 11431 4544 SY

FILE NAME = e:\projects\136008\design_aa.dgn	USER NAME = wilgreendp	DESIGNED - DRAWN -	REVISED - REVISED -	<b>STATE OF ILLINOIS DEPARTMENT OF TRANSPORTATION</b>	<b>PATCHING SCHEDULE IL 43</b>			F.A. RTE. VAR.	SECTION 2008-046 RS	COUNTY LAKE	TOTAL SHEETS 29	SHEET NO. 13	
PLOT SCALE = 100.0000' / IN.	CHECKED -	REVISED -	REVISED -		SCALE:	SHEET NO.	OF	SHEETS	STA.	TO STA.	FED. ROAD DIST. NO. 1	ILLINOIS	FED. AID PROJECT
PLOT DATE = 6/26/2008	DATE -	REVISED -	REVISED -										



ROUTE: IL 22

CROSS STREETS		DIRECTION (EB/WB) (NB/SB)	LANE NO. (1, 2, 3)	PAVEMENT PATCH WIDTH	PAVEMENT PATCH LENGTH	REPAIR AREA (SQ FT)	REPAIR AREA (SQ YD)		
FROM	TO								
US 14	Kelsey Rd	EB	1	12	12	144	16		
		EB	1	12	4	48	5		
		EB	1	12	4	48	5		
		EB	1	12	20	240	27		
		EB	1	12	6	72	8		
		EB	1	4	100	400	44		
		EB	1	4	20	80	9		
		EB	1	12	6	72	8		
		EB	1	12	10	120	13		
		EB	1	12	50	600	67		
Kelsey Rd	IL 59	EB	1	4	10	40	4		
		EB	CL	3	200	600	67		
		EB	1	12	10	120	13		
		EB	1	4	500	2000	222		
		EB	1	4	100	400	44		
		EB	1	12	4	48	5		
		EB	1	4	20	80	9		
		EB	1	4	30	120	13		
		EB	RT EP	4	20	80	9		
		EB	RT EP	4	20	80	9		
IL 59	US 12	EB	1	12	4	48	5		
		EB	1	12	6	72	8		
Quentin	Old McHenry	EB	1	12	10	120	13		
		EB	1	12	8	96	11		
		EB	1	4	300	1200	133		
		EB	CL	3	300	900	100		
		EB	1	4	6	24	3		
		EB	1	12	20	240	27		
		EB	1	12	4	48	5		
		EB	1	12	4	48	5		
		EB	1	12	4	48	5		
		EB	1	12	4	48	5		
Old McHenry	IL 83	EB	1	12	4	48	5		
		EB	1	12	4	48	5		
		EB	1	12	4	48	5		
		EB	1	12	25	300	33		
		EB	CL	2	200	300	33		
		EB	1	6	12	72	8		
		EB	2	6	12	72	8		
		IL 83	Old McHenry	WB	1	12	4	48	5
				WB	1	12	4	48	5
				WB	1	4	6	24	3

ROUTE: IL 22

CROSS STREETS		DIRECTION (EB/WB) (NB/SB)	LANE NO. (1, 2, 3)	PAVEMENT PATCH WIDTH	PAVEMENT PATCH LENGTH	REPAIR AREA (SQ FT)	REPAIR AREA (SQ YD)
FROM	TO						
Old McHenry	Quentin	WB	1	4	12	48	5
		WB	1	12	4	48	5
		WB	1	4	12	48	5
		WB	1	12	4	48	5
		WB	1	12	4	48	5
		WB	1	12	100	1200	133
		WB	1	4	12	48	5
		WB	1	4	20	80	9
		WB	1	12	6	72	8
		WB	1	4	12	48	5
@ IL 59 intersection	Kelsey	WB	1	6	100	600	67
		WB	1	6	50	300	33
		WB	1	12	100	1200	133
		WB	1	12	12	144	16
		WB	1	12	4	48	5
		WB	1	12	4	48	5
		WB	1	12	4	48	5
		WB	1	12	4	48	5
		WB	1	12	4	48	5
		WB	1	12	20	240	27
Kelsey	US 14	WB	1	12	12	144	16
		WB	1	6	100	600	67

TOTALS: 2889 1715 SY







ROUTE: IL Rte 132 (US Rte 45 to I-94 Tollway)

CROSS STREETS		DIRECTION (EB/WB (NB/SB)	LANE NO. (1, 2, 3)	PAVEMENT PATCH WIDTH	PAVEMENT PATCH LENGTH	REPAIR AREA (SQ FT)	REPAIR AREA (SQ YD)
FROM	TO						
Bridlewood Ave.	Hutchins Rd	WB	2	3	120	360	40
Bridlewood Ave.	Hutchins Rd	WB	1	3	20	60	7
Bridlewood Ave.	Hutchins Rd	WB	1	12	4	48	5
Bridlewood Ave.	Hutchins Rd	WB	1	12	4	48	5
Bridlewood Ave.	Hutchins Rd	WB	2	3	300	900	100
Bridlewood Ave.	Hutchins Rd	WB	2	12	4	48	5
Bridlewood Ave.	Hutchins Rd	WB	LT TL	12	4	48	5
Bridlewood Ave.	Hutchins Rd	WB	LT TL	12	4	48	5
Bridlewood Ave.	Hutchins Rd	WB	LT TL	12	4	48	5
Bridlewood Ave.	Hutchins Rd	WB	LT TL	3	125	375	42
Bridlewood Ave.	Hutchins Rd	WB	1	3	100	300	33
Hutchins Rd	Grandwood Dr	WB	1	12	4	48	5
Hutchins Rd	Grandwood Dr	WB	1	12	4	48	5
Hutchins Rd	Grandwood Dr	WB	1	12	4	48	5
Hutchins Rd	Grandwood Dr	WB	1	3	75	225	25
Hutchins Rd	Grandwood Dr	WB	1	6	12	72	8
Hutchins Rd	Grandwood Dr	WB	2	6	20	120	13
Hutchins Rd	Grandwood Dr	WB	2	8	35	280	31
Hutchins Rd	Grandwood Dr	WB	1	6	12	72	8
Hutchins Rd	Grandwood Dr	WB	1	6	12	72	8
Hutchins Rd	Grandwood Dr	WB	2	6	12	72	8
Hutchins Rd	Grandwood Dr	WB	2	3	300	900	100
Hutchins Rd	Grandwood Dr	WB	1	3	100	300	33
Hutchins Rd	Grandwood Dr	WB	2	6	12	72	8
Hutchins Rd	Grandwood Dr	WB	1	12	4	48	5
Hutchins Rd	Grandwood Dr	WB	1	12	4	48	5
Hutchins Rd	Grandwood Dr	WB	1	12	4	48	5
Hutchins Rd	Grandwood Dr	WB	1	3	75	225	25
Hutchins Rd	Grandwood Dr	WB	RT TL	12	4	48	5
Grandwood Dr	Oakwood Dr	WB	2	6	10	60	7
Grandwood Dr	Oakwood Dr	WB	2	12	12	144	16
Oakwood Dr	Rte 45	WB	1	3	15	45	5
Oakwood Dr	Rte 46	WB	2	3	20	60	7
Oakwood Dr	Rte 47	WB	1	3	200	600	67
Oakwood Dr	Rte 48	WB	2	3	20	60	7
Oakwood Dr	Rte 49	WB	2	3	20	60	7
Oakwood Dr	Rte 50	WB	1	12	4	48	5
Oakwood Dr	Rte 51	WB	1	3	30	90	10
Oakwood Dr	Rte 52	WB	2	3	30	90	10
Oakwood Dr	Rte 53	WB	2	3	50	150	17
Oakwood Dr	Rte 54	WB	2	3	100	300	33
Oakwood Dr	Rte 55	WB	2	12	4	48	5
Oakwood Dr	Rte 56	WB	1	12	6	72	8
Oakwood Dr	Rte 57	WB	2	12	6	72	8
Oakwood Dr	Rte 58	WB	2	3	50	150	17
Oakwood Dr	Rte 59	WB	2	3	200	600	67
Oakwood Dr	Rte 60	WB	LT TL	12	50	600	67
Oakwood Dr	Rte 61	WB	LT TL	12	25	300	33
Oakwood Dr	Rte 62	WB	LT TL	3	12	36	4

TOTALS: 17760 7876 SY

FILE NAME *	USER NAME * wilgreendp	DESIGNED -	REVISED -	<b>STATE OF ILLINOIS DEPARTMENT OF TRANSPORTATION</b>	<b>PATCHING SCHEDULE IL 132</b>	F.A. RTE.	SECTION	COUNTY	TOTAL SHEETS	SHEET NO.
PROJECTS\dl136008\design_aa.dgn	DRAWN -	REVISED -	VAR.			2008-046 RS	LAKE	29	18	
PLDT SCALE = 100.0000' / IN.	CHECKED -	REVISED -	CONTRACT NO. 60E95							
PLDT DATE = 6/26/2008	DATE -	REVISED -	SCALE:			SHEET NO. OF SHEETS	STA. TO STA.	FED. ROAD DIST. NO. 1	ILLINOIS FED. AID PROJECT	

...projects\dl136008\design\_aa.dgn 6/26/2008 1:32:04 PM User:wilgreendp

ROUTE: RTE 131 (GREENBAY ROAD): From RTE 137 to RTE 120

CROSS STREETS		DIRECTION (EB/WB) (NB/SB)	LANE NO. (1, 2, 3)	PAVEMENT PATCH WIDTH	PAVEMENT PATCH LENGTH	REPAIR AREA (SQ FT)	REPAIR AREA (SQ YD)
FROM	TO						
RTE 137	RTE 120	SB	1	6 FT	12FT		8.0**
					**	17 Patches on the SB lane 1	
RTE 137	RTE 120	SB	2	6FT	12FT		8.00***
				NOTE: Total of 20 Patches on SB lane 2 = 160 SQ YD			
RTE 137	RTE 120	NB	1	6FT	12 FT		8.00*
				NOTE: Total of 20 Patches on NB lane 1= 160 SQ YD			
RTE 137	RTE 120	NB	2	6 FT	12 FT		8.00 ****
				NOTE: Total of 20 Patches on NB Lane 2 = 160 SQ YD			

TOTALS:

536  
SY





ROUTE: 22ND STREET (MARTIN LUTHER KING DRIVE)

CROSS STREETS		DIRECTION (EB/WB) (NB/SB)	LANE NO. (1, 2, 3)	PAVEMENT PATCH WIDTH	PAVEMENT PATCH LENGTH	REPAIR AREA (SQ FT)	REPAIR AREA (SQ YD)
FROM	TO						
RTE 131 (Greenbay Rd)	W. of Sherridan Road						
		TYPE II PATCHES = 342 sq yd					
		TYPE III = 172SQ YD					

TOTALS:

514  
SY

ROUTE: **SHERRIDAN ROAD: From Amstutz Expressway to 22ND STREET IN North Chicago**

CROSS STREETS		DIRECTION (EB/WB) (NB/SB)	LANE NO. (1, 2, 3)	PAVEMENT PATCH WIDTH	PAVEMENT PATCH LENGTH	REPAIR AREA (SQ FT)	REPAIR AREA (SQ YD)
FROM	TO						
		NB & SB					
	Two lanes in each direction separated barrier wall median						
	SB LANES SIX PATCHES TYPE II =72 SQ YD						
	NB LANES PATCHES TYPE II (7Patches)=79 SQ YD						
	TYPE III PATCHES (TWO)=37SQ YD						
	TOTAL LENGTH=0.8MILE						
	MILLING & RESURFACING AREA = 25344 SQ YD						

TOTALS:

25532  
SY

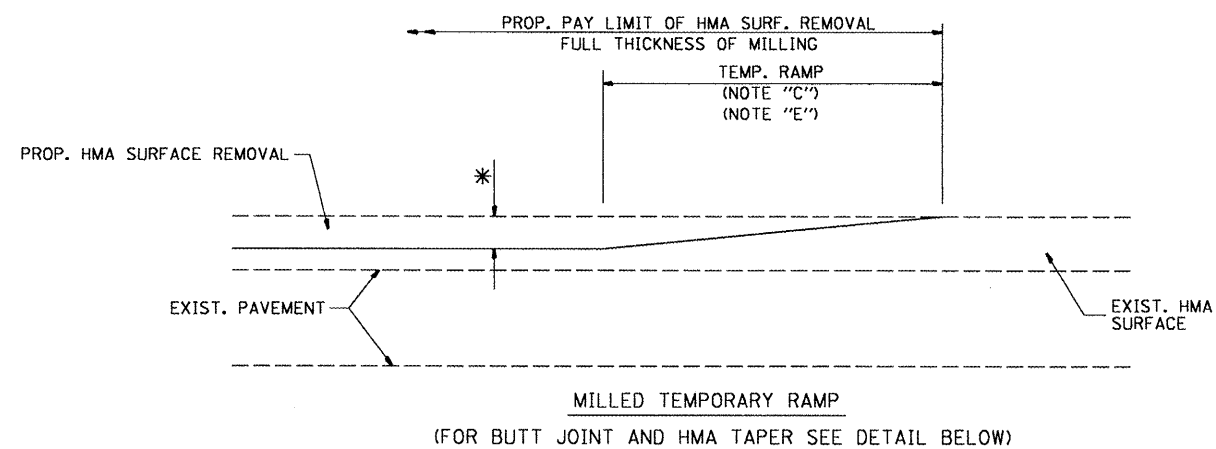

**OPTION 1**

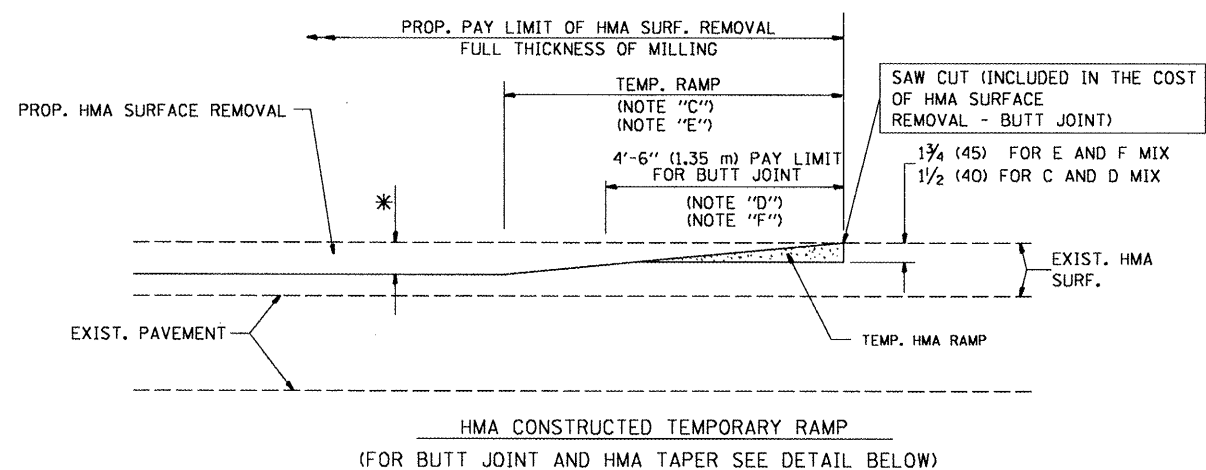

**OPTION 2**

**TYPICAL TEMPORARY RAMP**

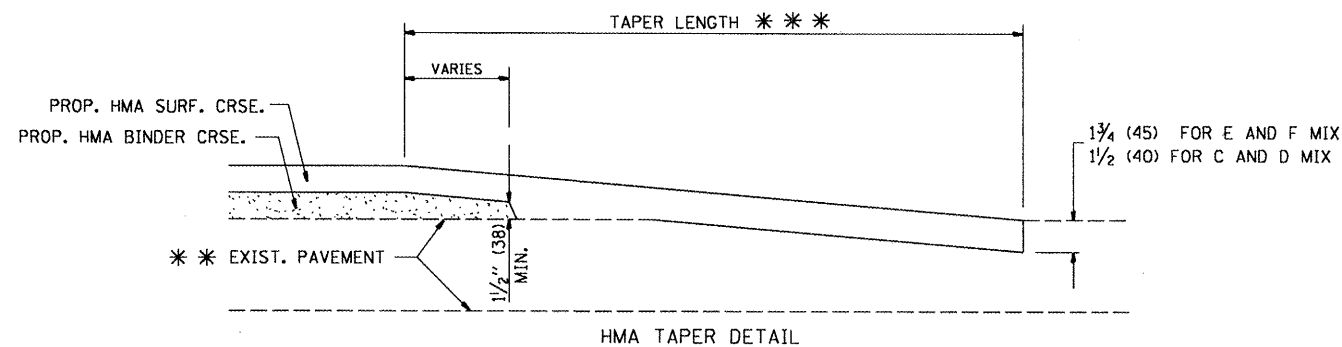
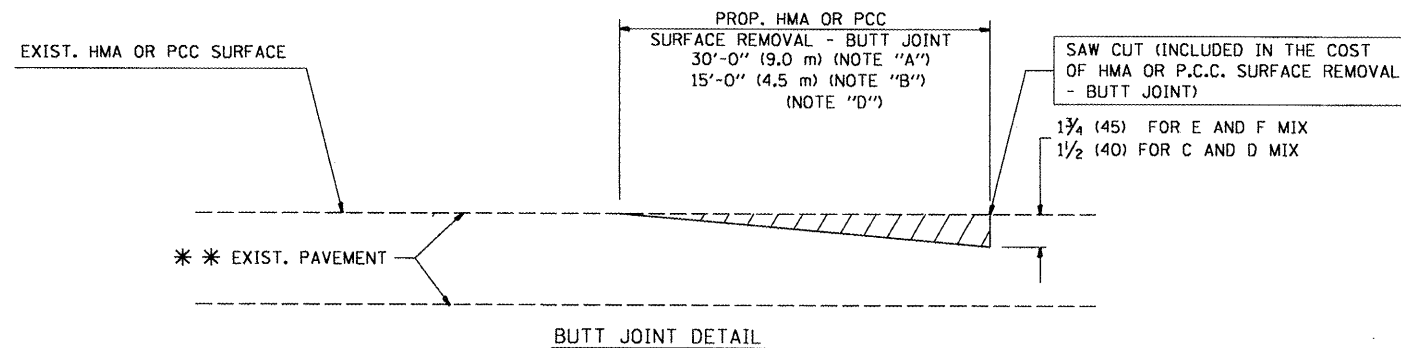

**TYPICAL BUTT JOINT AND HMA TAPER FOR RESURFACING ONLY**

\*\*\* PC CONCRETE, HMA OR HMA RESURFACED PAVEMENT.

**NOTES**

- A: MAINLINE ROADWAYS AND MAJOR SIDE ROADS.
  - B: MINOR SIDE ROADS.
  - C: THE TEMP. RAMP SHALL BE CONSTRUCTED IMMEDIATELY UPON REMOVAL OF THE EXISTING HMA SURFACE.
  - D: THE BUTT JOINT SHALL BE CONSTRUCTED IMMEDIATELY PRIOR TO PLACING THE PROPOSED HMA COURSES.
  - E: TAPER THE TEMP. RAMP AT A RATE OF 3'-0" (900 mm) PER 1 INCH (25 mm) OF MILLING THICKNESS.
  - F: INSTALLATION AND REMOVAL OF THE 4'-6" (1.35 m) TEMP. RAMP IS INCLUDED IN COST OF HMA SURFACE REMOVAL - BUTT JOINT
  - G: SEE ARTICLE 406.08 AND 406.14 OF THE STANDARD SPECIFICATIONS FOR "HMA AND/OR PCC SURFACE REMOVAL, BUTT JOINT".
- \* SEE TYPICAL SECTIONS FOR MILLING THICKNESS.
- \*\*\* 20'-0" (6.1 m) PER 1 (25) RESURFACING (NOTE "A")  
10'-0" (3.0 m) PER 1 (25) RESURFACING (NOTE "B")

**BASIS OF PAYMENT:**

THE BUTT JOINT WILL BE PAID FOR AT THE CONTRACT UNIT PRICE PER SQUARE YARD (SQUARE METER) FOR "HOT-MIX ASPHALT SURFACE REMOVAL - BUTT JOINT" OR FOR "PORTLAND CEMENT CONCRETE SURFACE REMOVAL - BUTT JOINT".

ALL DIMENSIONS ARE IN INCHES (MILLIMETERS) UNLESS OTHERWISE SHOWN.

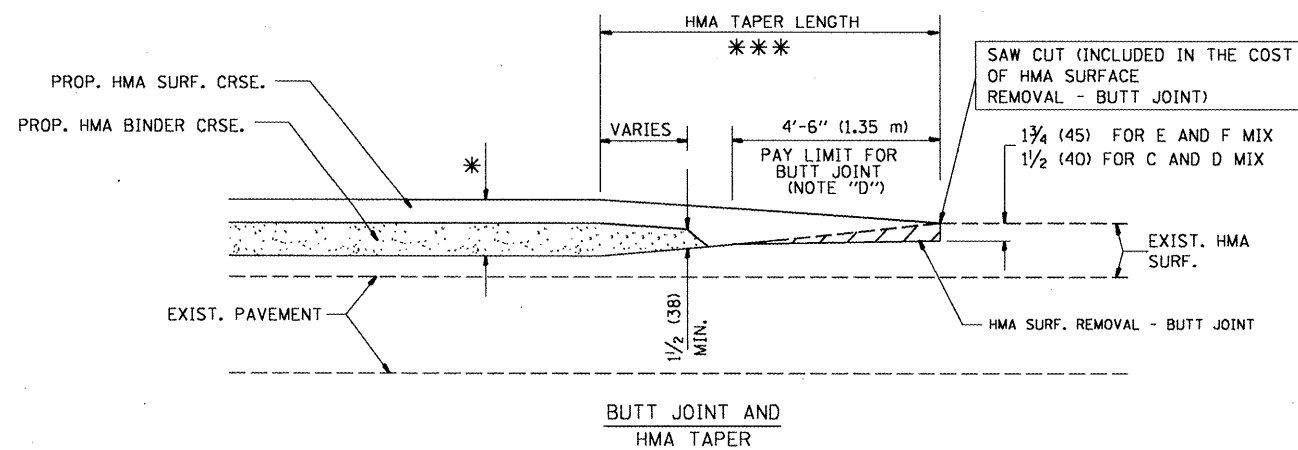

**TYPICAL BUTT JOINT AND HMA TAPER FOR MILLING AND RESURFACING**

**STATE OF ILLINOIS  
DEPARTMENT OF TRANSPORTATION**

**BUTT JOINT AND  
HMA TAPER DETAILS**

SCALE: NONE SHEET NO. 1 OF 1 SHEETS STA. TO STA.

F.A. - RTE.	SECTION	COUNTY	TOTAL SHEETS	SHEET NO.
VAR.	2008-046 RS	LAKE	29	24
BD400-05 BD32			CONTRACT NO. 60E95	
FED. ROAD DIST. NO. 1 ILLINOIS FED. AID PROJECT				

FILE NAME =	USER NAME = sm1thk1	DESIGNED - M. DE YONG	REVISED - R. SHAH 10-25-94
\\dist\intsa2\users\sm1thk1\Desktop\CADD	DETAILS\bd32.dgn	DRAWN -	REVISED - A. ABBAS 03-21-97
PLOT SCALE = 99.9998 "/td> <td></td> <td>CHECKED -</td> <td>REVISED - M. GOMEZ 04-06-01</td>		CHECKED -	REVISED - M. GOMEZ 04-06-01
PLOT DATE = 6/26/2008		DATE - 06-13-90	REVISED - R. BORO 01-01-07

DESIGNED - M. DE YONG	REVISED - R. SHAH 10-25-94
DRAWN -	REVISED - A. ABBAS 03-21-97
CHECKED -	REVISED - M. GOMEZ 04-06-01
DATE - 06-13-90	REVISED - R. BORO 01-01-07



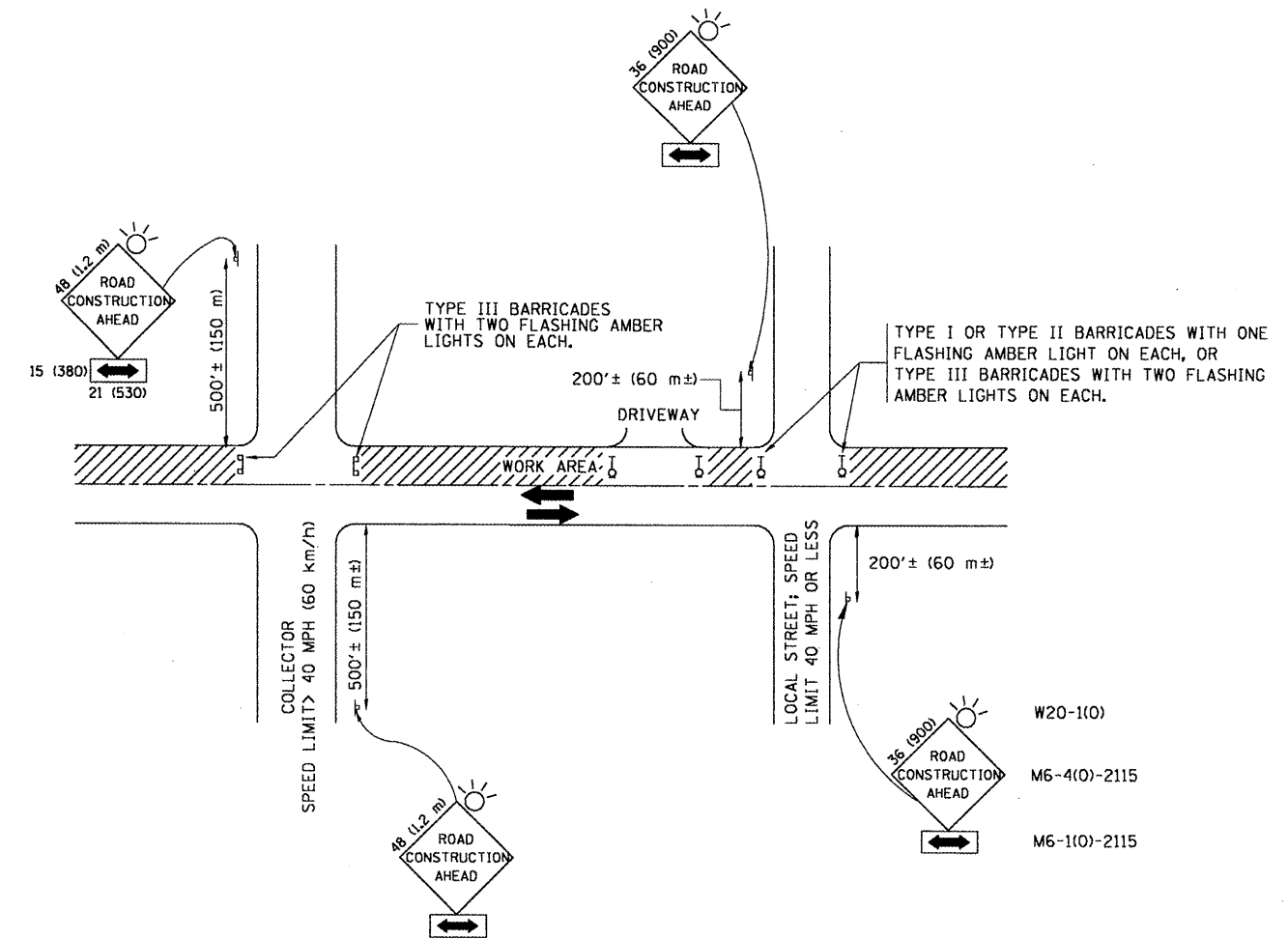

**TRAFFIC CONTROL AND PROTECTION FOR SIDE ROADS, INTERSECTIONS, AND DRIVEWAYS**

**NOTES:**

- A. FOR NO LANE RESTRICTION ON THE SIDE ROAD OR DRIVEWAYS:
    1. SIDE ROAD WITH A SPEED LIMIT OF 40 MPH (60 km/h) OR LESS AS SHOWN ON THE DRAWING AND AS DIRECTED BY THE ENGINEER:
      - a) ONE **ROAD CONSTRUCTION AHEAD** SIGN 36 x 36 (900x900) WITH A FLASHER AND FLAG MOUNTED ON IT APPROXIMATELY 200' (60 m) IN ADVANCE OF THE MAIN ROUTE.
      - b) THE CLOSED PORTION OF THE MAIN ROUTE SHALL BE PROTECTED BY BLOCKING WITH TYPE I, TYPE II OR TYPE III BARRICADES, 1/3 OF THE CROSS SECTION OF THE CLOSED PORTION.
    2. SIDE ROAD WITH A SPEED LIMIT GREATER THAN 40 MPH (60 km/h) AS SHOWN ON THE DRAWING AND AS DIRECTED BY THE ENGINEER:
      - a) ONE **ROAD CONSTRUCTION AHEAD** SIGN 48 x 48 (1.2 m x 1.2 m) WITH A FLASHER MOUNTED ON IT APPROXIMATELY 500' (150 m) IN ADVANCE OF THE MAIN ROUTE.
      - b) THE CLOSED PORTION OF THE MAIN ROUTE SHALL BE PROTECTED BY BLOCKING WITH TYPE III BARRICADES, 1/2 OF THE CROSS SECTION OF THE CLOSED PORTION.
  - 3. WHEN THE SIDE ROAD LIES BETWEEN THE BEGINNING OF THE MAINLINE SIGNING AND THE WORK ZONE, A SINGLE HEADED ARROW (M6-1) SHALL BE USED IN LIEU OF THE DOUBLE HEADED ARROW (M6-4).
- B. FOR A LANE CLOSURE ON A SIDE ROAD OR DRIVEWAY:
 

USE APPLICABLE PORTIONS OF THE TYPICAL APPLICATION OF TRAFFIC CONTROL DEVICES (STD. 701501, STD. 701606 OR THE APPROPRIATE STANDARD). THE SPACING OF SIGNS AND BARRICADES SHALL BE ADJUSTED FOR FIELD CONDITIONS AS DIRECTED BY THE ENGINEER. THE DIRECTIONAL ARROW SHALL BE COVERED OR REMOVED WHEN NO LONGER CONSISTENT WITH THE SIDE ROAD LANE CLOSURE.
  - C. ADVANCE WARNING SIGNS ARE TO BE OMITTED ON DRIVEWAY UNLESS OTHERWISE NOTED.
  - D. THE TRAFFIC CONTROL AND PROTECTION FOR SIDE ROADS, INTERSECTIONS, AND DRIVEWAYS SHALL BE INCIDENTAL TO THE COST OF SPECIFIED TRAFFIC CONTROL STANDARDS OR ITEMS.

All dimensions are in millimeters (inches) unless otherwise shown.

FILE NAME =	USER NAME = smthk1	DESIGNED - LHA	REVISED - J. OBERLE 10-18-95	<b>STATE OF ILLINOIS DEPARTMENT OF TRANSPORTATION</b>	<b>TRAFFIC CONTROL AND PROTECTION FOR SIDE ROADS, INTERSECTIONS, AND DRIVEWAYS</b>	F.A. -	SECTION	COUNTY	TOTAL SHEETS	SHEET NO.
\\dist\inf2\users\smthk1\Desk top\CADD	DETAILS\td10.dgn	DRAWN -	REVISED - A. HOUSEH 03-06-96			VAR.	2008-046 RS	LAKE	29	25
PLOT SCALE = 100.000' / IN.	CHECKED -	REVISED - A. HOUSEH 10-15-96				<b>TC-10</b>		<b>CONTRACT NO. 60E95</b>		
PLOT DATE = 6/26/2008	DATE - 06-89	REVISED - T. RAMMACHER 01-06-00				FED. ROAD DIST. NO. 1   ILLINOIS FED. AID PROJECT				
				SCALE: NONE	SHEET NO. 1 OF 1 SHEETS	STA.	TO STA.			

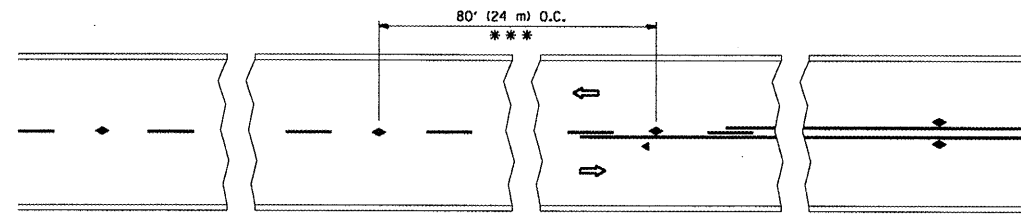

\*\*\* REDUCE TO 40' (12 m) O.C. ON CURVES WITH POSTED OR ADVISORY SPEED 45 M.P.H. (70 km/h) OR LESS.

TWO-LANE/TWO-WAY

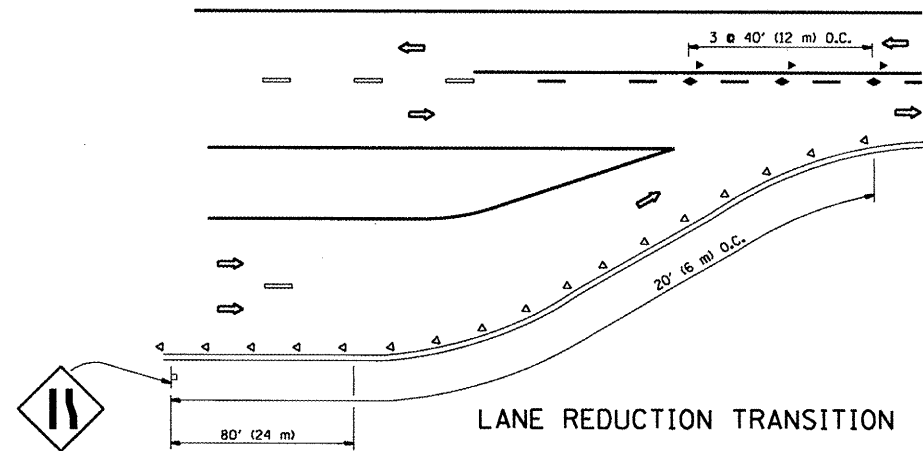

LANE REDUCTION TRANSITION

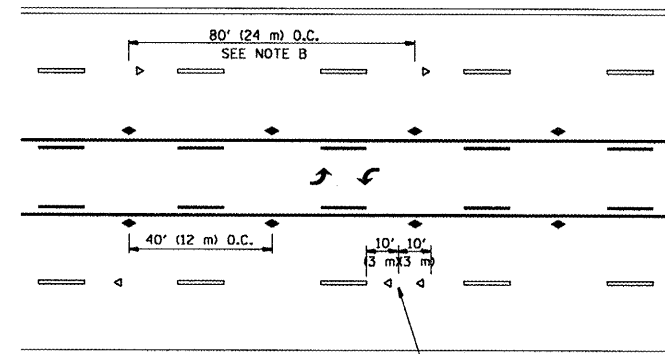

TWO-WAY LEFT TURN

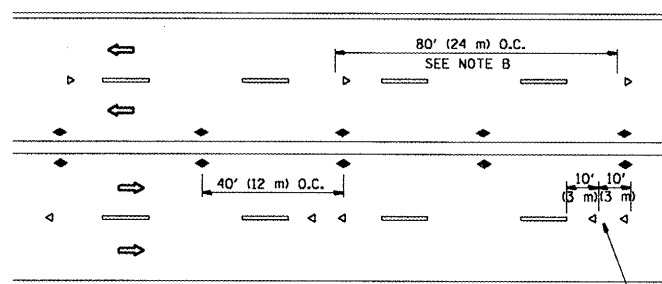

MULTI-LANE/UNDIVIDED

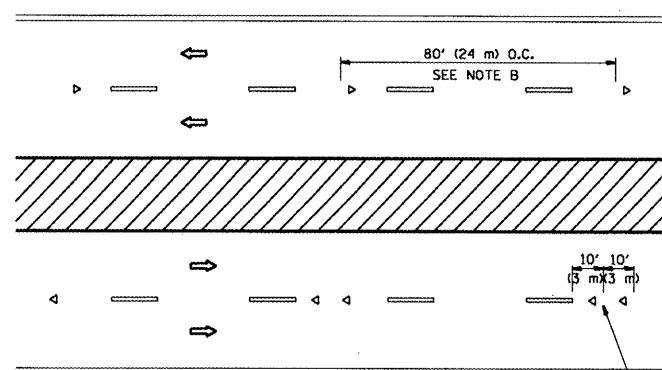

MULTI-LANE/DIVIDED

GENERAL NOTES

1. MARKERS USED WITH DASHED LINES SHALL BE CENTERED IN THE GAP BETWEEN SEGMENTS.
2. MARKERS USED ADJACENT TO SOLID LINES SHALL BE OFFSET 2 TO 3 (50 TO 75) TOWARD TRAFFIC AS SHOWN.
3. MARKERS THROUGH TANGENTS LESS THAN 500' (150 m) IN LENGTH BETWEEN CURVES SHALL BE INSTALLED AT THE LESSER OF THE TWO CURVE SPACINGS.

SYMBOLS

- YELLOW STRIPE
- WHITE STRIPE
- ◀ ONE-WAY AMBER MARKER
- ◀ ONE-WAY CRYSTAL MARKER (W/O)
- ◆ TWO-WAY AMBER MARKER

LANE MARKER NOTES

- B. REDUCE TO 40' (12 m) O.C. ON CURVES WHERE ADVISORY SPEEDS ARE 10 M.P.H. (20 km/h) LOWER THAN POSTED SPEEDS.
- A. USE DOUBLE LANE LINE MARKERS SPACED AS SHOWN.

DESIGN NOTES

1. DOUBLE LANE LINE MARKERS SHALL BE USED UNLESS SPECIFIED OTHERWISE.
2. EXCEPT AS SHOWN ON THE LANE REDUCTION TRANSITION AND FREEWAY EXIT RAMP DETAIL, MARKERS ARE NOT TO BE SPECIFIED ON RIGHT EDGE LINES.
3. THE EXACT MARKER LIMITS, SPACING, AND COLOR SHOULD BE INCLUDED IN THE PLANS.
4. MARKERS SHOULD NOT BE USED ALONGSIDE CURBS EXCEPT FOR EXTREMELY SHORT SECTIONS OF CURBS WHERE NOT MORE THAN TWO MARKERS WOULD BE INVOLVED.

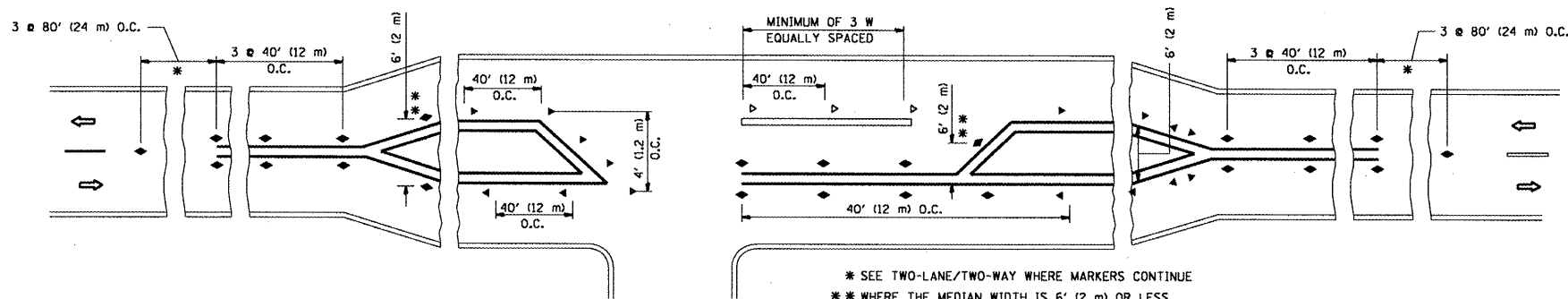

LEFT TURN

\* SEE TWO-LANE/TWO-WAY WHERE MARKERS CONTINUE  
 \*\* WHERE THE MEDIAN WIDTH IS 6' (2 m) OR LESS USE TWO-WAY MARKERS.

All dimensions are in inches (millimeters) unless otherwise shown.

FILE NAME =	USER NAME = smthk1	DESIGNED -	REVISED - T. RAMMACHER 09-19-94
\\dist1\ntfa2\users\smthk1\Desk top\CADD	DETAILS\to11.dgn	DRAWN -	REVISED - T. RAMMACHER 03-12-99
	PLOT SCALE = 100.000 / IN.	CHECKED -	REVISED - T. RAMMACHER 01-06-00
	PLOT DATE = 6/26/2008	DATE -	REVISED -

STATE OF ILLINOIS  
DEPARTMENT OF TRANSPORTATION

TYPICAL APPLICATIONS			
RAISED REFLECTIVE PAVEMENT MARKERS (SNOW-PLOW RESISTANT)			
SCALE: NONE	SHEET NO. 1 OF 1 SHEETS	STA.	TO STA.

F.A. RTE.	SECTION	COUNTY	TOTAL SHEETS	SHEET NO.
VAR.	2008-046 RS	LAKE	29	26
TC-11			CONTRACT NO. 60E95	
FED. ROAD DIST. NO. 1 (ILLINOIS) FED. AID PROJECT				

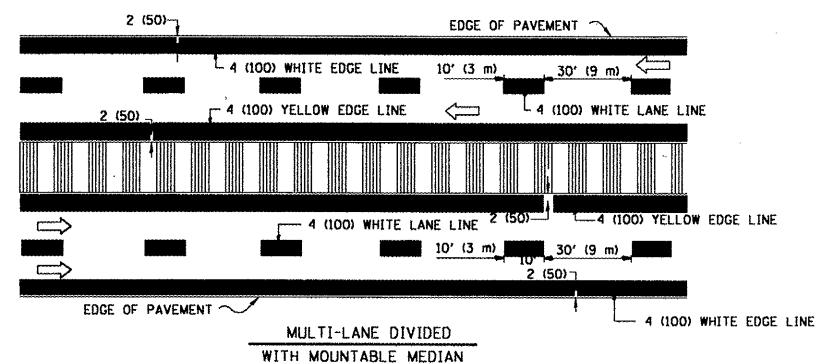
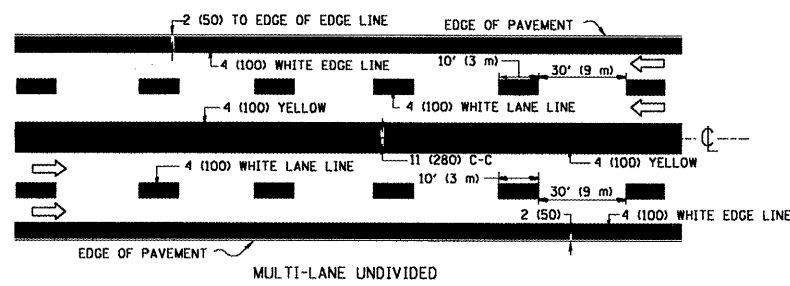
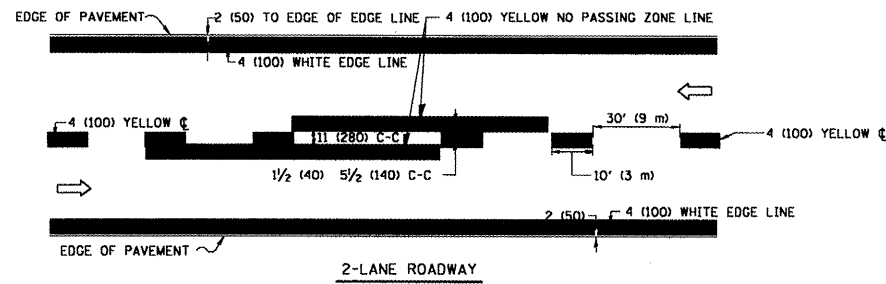

NOTE: MEDIANS WITH BARRIER CURB DO NOT REQUIRE AN EDGE LINE

**TYPICAL LANE AND EDGE LINE MARKING**

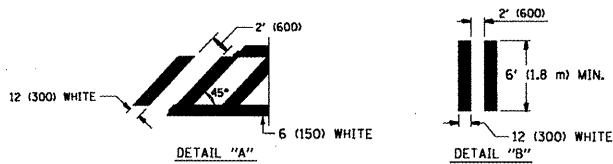
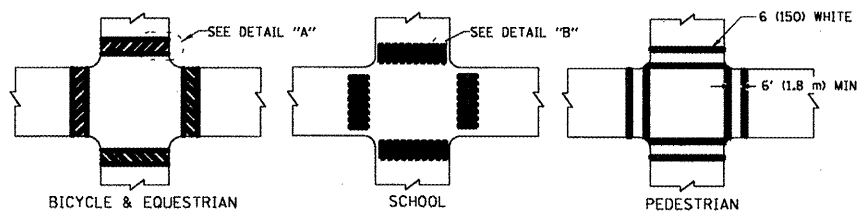

**TYPICAL CROSSWALK MARKING**

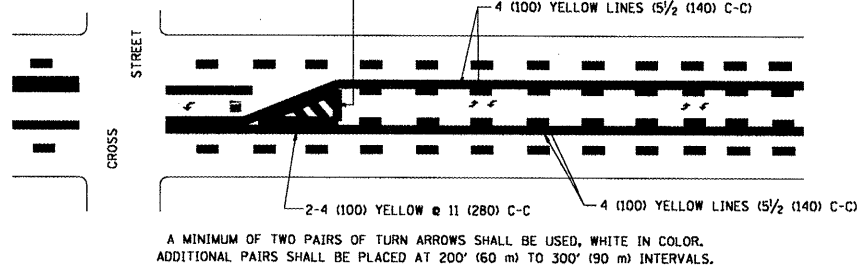
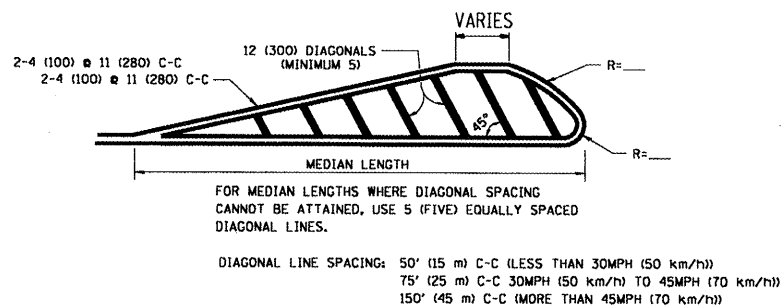
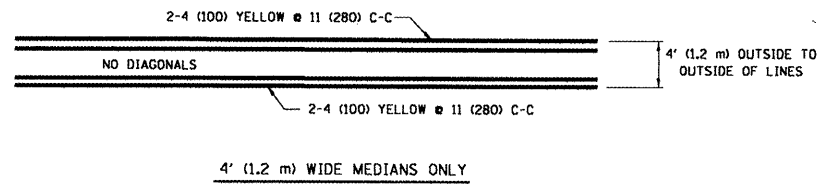

**TYPICAL PAINTED MEDIAN MARKING**

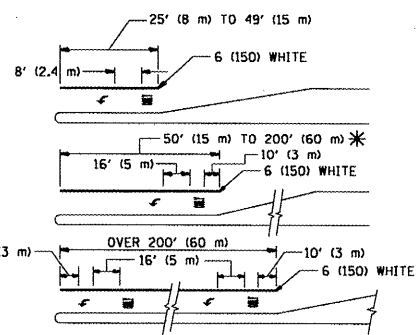

FULL SIZE LETTERS 8' (2.4 m) AND ARROWS SHALL BE USED.  
 \* AREA = 15.6 SQ. FT. (1.5 m<sup>2</sup>) ONLY AREA = 20.8 SQ. FT. (1.9 m<sup>2</sup>)  
 \* TURN LANES IN EXCESS OF 400' (120 m) IN LENGTH MAY HAVE AN ADDITIONAL SET OF ARROW - "ONLY" INSTALLED MIDWAY BETWEEN THE OTHER TWO SETS OF ARROW - "ONLY".

**TYPICAL TURN LANE MARKING**

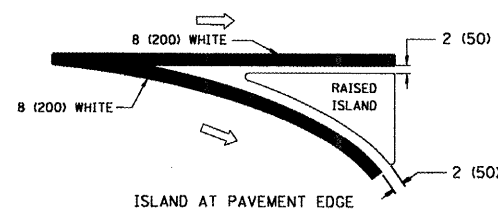
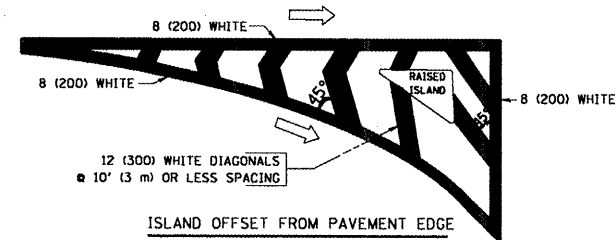

**TYPICAL ISLAND MARKING**

TYPE OF MARKING	WIDTH OF LINE	PATTERN	COLOR	SPACING / REMARKS
CENTERLINE ON 2 LANE PAVEMENT	4 (100)	SKIP-DASH	YELLOW	10' (3 m) LINE WITH 30' (9 m) SPACE
CENTERLINE ON MULTI-LANE UNDIVIDED PAVEMENT	2 @ 4 (100)	SOLID	YELLOW	11 (280) C-C
NO PASSING ZONE LINES FOR ONE DIRECTION FOR BOTH DIRECTIONS	4 (100) 2 @ 4 (100)	SOLID SOLID	YELLOW YELLOW	5 1/2 (140) C-C FROM SKIP-DASH CENTERLINE 11 (280) C-C OMIT SKIP-DASH CENTERLINE BETWEEN
LANE LINES	4 (100) 5 (125) ON FREEWAYS	SKIP-DASH SKIP-DASH	WHITE WHITE	10' (3 m) LINE WITH 30' (9 m) SPACE
DOTTED LINES (EXTENSIONS OF CENTER, LANE OR TURN LANE MARKINGS)	SAME AS LINE BEING EXTENDED	SKIP-DASH	SAME AS LINE BEING EXTENDED	2' (600) LINE WITH 6' (1.8 m) SPACE
EDGE LINES	4 (100)	SOLID	YELLOW-LEFT WHITE-RIGHT	OUTLINE MOUNTABLE MEDIANS IN YELLOW; EDGE LINES ARE NOT USED NEXT TO BARRIER CURB
TURN LANE MARKINGS	6 (150) LINE; FULL SIZE LETTERS & SYMBOLS (8' (2.4m))	SOLID	WHITE	SEE TYPICAL TURN LANE MARKING DETAIL
TWO WAY LEFT TURN MARKING	2 @ 4 (100) EACH DIRECTION 8' (2.4m) LEFT ARROW	SKIP-DASH AND SOLID IN PAIRS	YELLOW WHITE	10' (3 m) LINE WITH 30' (9 m) SPACE FOR SKIP-DASH; 5 1/2 (140) C-C BETWEEN SOLID LINE AND SKIP-DASH LINE SEE TYPICAL TWO-WAY LEFT TURN MARKING DETAIL
CROSSWALK LINES (PEDESTRIAN) A. DIAGONALS (BIKE & EQUESTRIAN) B. LONGITUDINAL BARS (SCHOOL)	2 @ 6 (150) 12 (300) @ 45° 12 (300) @ 90°	SOLID SOLID SOLID	WHITE WHITE WHITE	NOT LESS THAN 6' (1.8 m) APART 2' (600) APART SEE TYPICAL CROSSWALK MARKING DETAILS.
STOP LINES	24 (600)	SOLID	WHITE	PLACE 4' (1.2 m) IN ADVANCE OF AND PARALLEL TO CROSSWALK, IF PRESENT, OTHERWISE, PLACE AT DESIRED STOPPING POINT, PARALLEL TO CROSSROAD CENTERLINE, WHERE POSSIBLE
PAINTED MEDIANS	2 @ 4 (100) WITH 12 (300) DIAGONALS @ 45° NO DIAGONALS USED FOR 4' (1.2 m) WIDE MEDIANS	SOLID	YELLOW: TWO WAY TRAFFIC WHITE: ONE WAY TRAFFIC	11 (280) C-C FOR THE DOUBLE LINE SEE TYPICAL PAINTED MEDIAN MARKING.
GORE MARKING AND CHANNELIZING LINES	8 (200) WITH 12 (300) DIAGONALS @ 45°	SOLID	WHITE	DIAGONALS: 15' (4.5 m) C-C (LESS THAN 30MPH (50 km/h)) 20' (6 m) C-C 30MPH (50 km/h) TO 45MPH (70 km/h) 30' (9 m) C-C (OVER 45MPH (70 km/h))
RAILROAD CROSSING	24 (600) TRANSVERSE LINES; "RR" 15 6' (1.8 m) LETTERS; 16 (400) LINE FOR "X"	SOLID	WHITE	SEE STATE STANDARD 780001 AREA OF: "RR"-3.6 SQ. FT. (0.33 m <sup>2</sup> ) EACH "X"-54.0 SQ. FT. (5.0 m <sup>2</sup> )
SHOULDER DIAGONALS	12 (300) @ 45°	SOLID	WHITE - RIGHT YELLOW - LEFT	50' (15 m) C-C (LESS THAN 30MPH (50 km/h)) 75' (25 m) C-C 30 MPH (50 km/h) TO 45MPH (70 km/h) 150' (45 m) C-C (OVER 45MPH (70 km/h))

FOR FURTHER DETAILS ON PAVEMENT MARKING REFER TO STANDARD SPECIFICATIONS FOR ROAD AND BRIDGE CONSTRUCTION AND STATE STANDARD 780001.

All dimensions are in inches (millimeters) unless otherwise shown.

**STATE OF ILLINOIS  
DEPARTMENT OF TRANSPORTATION**

**DISTRICT ONE  
TYPICAL PAVEMENT MARKINGS**

SCALE: NONE SHEET NO. 1 OF 1 SHEETS STA. TO STA.

F.A. - RTE.	SECTION	COUNTY	TOTAL SHEETS	SHEET NO.
VAR.	2008-046 RS	LAKE	29	27
TC-13			CONTRACT NO. 60E95	
FED. ROAD DIST. NO. 1 ILLINOIS FED. AID PROJECT				

FILE NAME =	USER NAME = smthk1	DESIGNED - EVERS	REVISED - T. RAMMACHER 10-27-94
\\d1st1nrtf2\users\smthk1\Desktop\CADD	DETAILS\td13.dgn	DRAWN -	REVISED - A. HOUSEH 10-09-96
PLOT SCALE = 100.000' / IN.	CHECKED -	REVISOR - A. HOUSEH 10-17-96	
PLOT DATE = 6/26/2008	DATE - 03-19-90	REVISED - T. RAMMACHER 01-06-00	

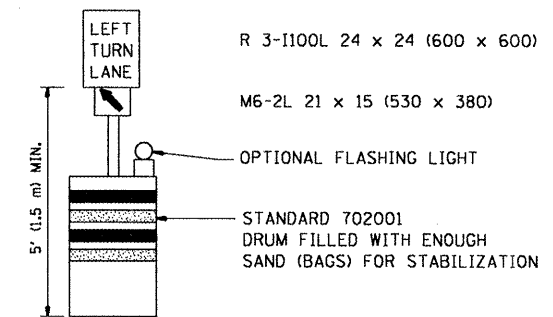
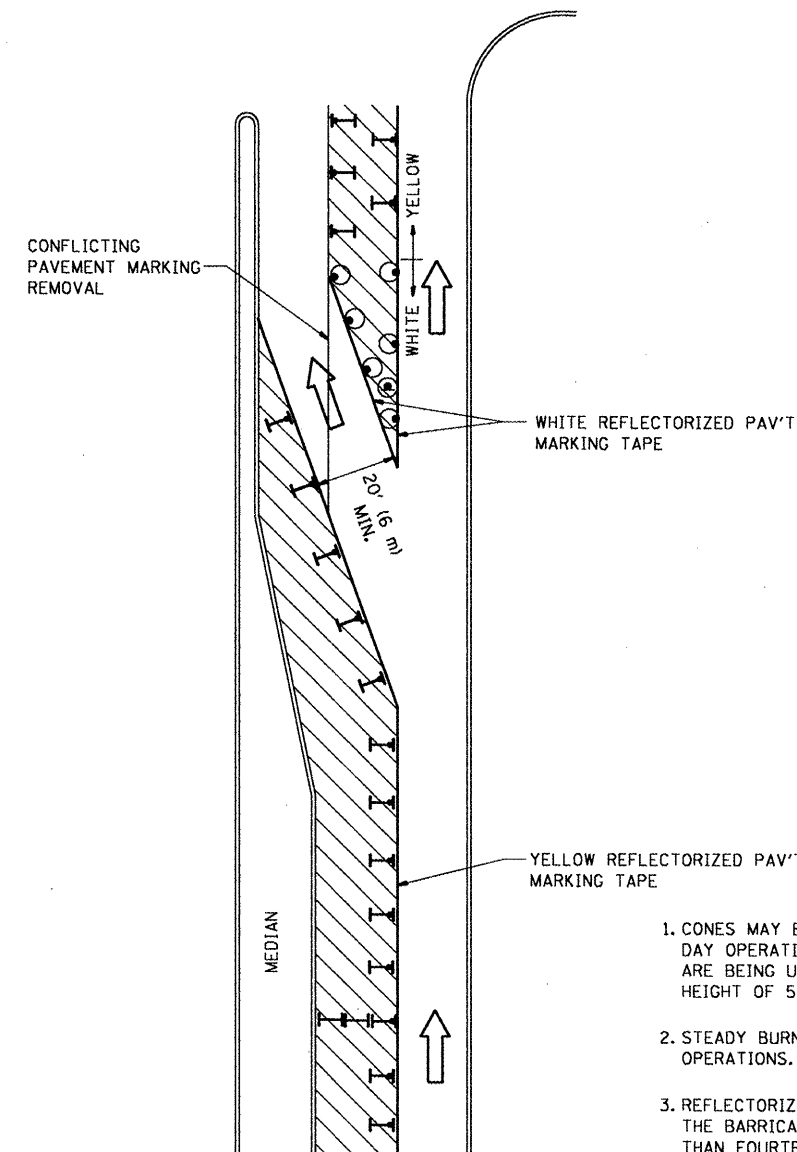





**GENERAL NOTES**

1. CONES MAY BE SUBSTITUTED FOR BARRICADES OR DRUMS AT HALF THE SPACING DURING DAY OPERATIONS. CONES SHALL BE A MINIMUM OF 28 (710) IN HEIGHT. WHEN CONES ARE BEING USED, THE "LEFT TURN LANE" SIGN MAY BE SKID MOUNTED AT A MINIMUM HEIGHT OF 5' (1.5 m).
2. STEADY BURNING LIGHTS WILL NOT BE REQUIRED ON BARRICADES OR DRUMS FOR DAY OPERATIONS. ALL LIGHTS SHALL BE MONODIRECTIONAL.
3. REFLECTORIZED TEMPORARY PAVEMENT MARKING TAPE SHALL BE PLACED THROUGHOUT THE BARRICADED AREA OF EACH TURN BAY WHERE THE CLOSURE TIME IS GREATER THAN FOURTEEN DAYS.
4. THIS APPLICATION ALSO APPLIES WHEN WORK IS BEING PERFORMED IN THE RIGHT LANE(S) AND THE RIGHT TURN BAY IS TO REMAIN OPEN. UNDER THIS CONDITION, "RIGHT TURN LANE" R3-100 24 x 24 (600 x 600) AND M6-2R 21 x 15 (530 x 380) SHALL BE USED.
5. THESE CONTROLS SHALL SUPPLEMENT MAINLINE TRAFFIC CONTROL FOR LANE CLOSURES.
6. LONGITUDINAL DIMENSIONS MAY BE ADJUSTED TO FIT FIELD CONDITIONS.
7. FORM BT 725 IS REQUIRED.
8. TRAFFIC CONTROL AND PROTECTION AT TURN BAYS (TO REMAIN OPEN TO TRAFFIC) SHALL BE INCLUDED IN THE COST SPECIFIED TRAFFIC CONTROL STANDARDS OR ITEMS.

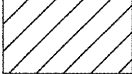
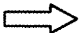
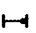
All dimensions are in inches (millimeters) unless otherwise shown.

**LEGEND**

-  WORK AREA
-  LANE OPEN TO TRAFFIC
-  TYPE I OR II BARRICADE WITH STEADY BURN LIGHT
-  DRUM WITH STEADY BURN LIGHT
-  DRUM WITH SIGN (WITH OPTIONAL FLASHING LIGHT) SEE DETAIL
-  TYPE I OR II CHECK BARRICADE WITH FLASHING LIGHT

**STATE OF ILLINOIS  
DEPARTMENT OF TRANSPORTATION**

**TRAFFIC CONTROL AND PROTECTION AT TURN BAYS  
(TO REMAIN OPEN TO TRAFFIC)**

F.A. RTE.	SECTION	COUNTY	TOTAL SHEETS	SHEET NO.
VAR.	2008-046 RS	LAKE	29	28
TC-14			CONTRACT NO. 60E95	
FED. ROAD DIST. NO. 1 [ILLINOIS] FED. AID PROJECT				

SCALE: NONE SHEET NO. 1 OF 1 SHEETS STA. TO STA.

FILE NAME =	USER NAME = sm1thk1	DESIGNED -	REVISED -T. RAMMACHER 09-08-94
\\dist1\ntfs2\user\sm1thk1\Desktop\CADD	DETAILS\tc14.dgn	DRAWN -	REVISED - A. HOUSEH 11-07-95
	PLOT SCALE = 99.9998 / IN.	CHECKED -	REVISED - A. HOUSEH 10-12-96
	PLOT DATE = 6/26/2008	DATE -	REVISED -T. RAMMACHER 01-06-00

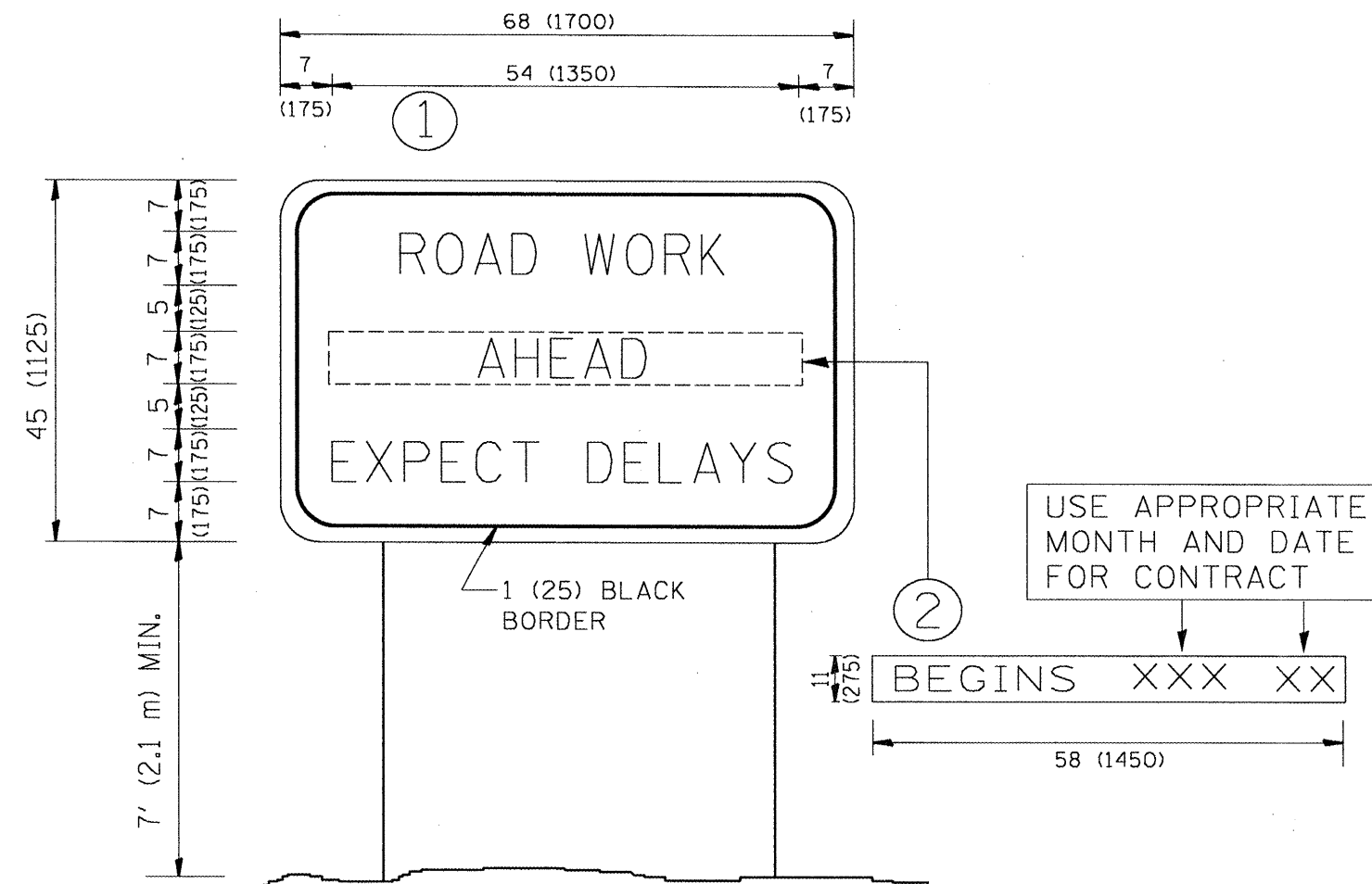

**NOTES:**

1. USE BLACK LETTERING ON ORANGE BACKGROUND.
2. ERECT SIGNS IN ADVANCE OF THE LOCATION FOR THE "ROAD CONSTRUCTION AHEAD" SIGN AT LOCATIONS AS DIRECTED BY THE ENGINEER.
3. ERECT SIGN ① WITH INSTALLED PANEL ② ONE WEEK PRIOR TO THE START OF CONSTRUCTION.
4. REMOVE PANEL ② SOON AFTER THE START OF CONSTRUCTION.
5. SEE SPECIAL PROVISION FOR "TEMPORARY INFORMATION SIGNING" FOR ADDITIONAL INFORMATION.
6. ONE SIGN ASSEMBLY EQUALS 25.70 SQ. FT. (2.3 SQ. M.)
7. SHALL BE PAID FOR AS TEMPORARY INFORMATION SIGNING.

ALL DIMENSIONS ARE IN INCHES (MILLIMETERS) UNLESS OTHERWISE SHOWN.

FILE NAME =	USER NAME = smthk1	DESIGNED -	REVISED - R. MIRS 09-15-97
\\dist1ntfa2\users\smthk1\Desktop\CADD	DETAILS\tc22.dgn	DRAWN -	REVISED - R. MIRS 12-11-97
	PLOT SCALE = 100.000 / IN.	CHECKED -	REVISED - T. RAMMACHER 02-02-99
	PLOT DATE = 6/26/2008	DATE -	REVISED - C. JUCIUS 01-31-07

**STATE OF ILLINOIS  
DEPARTMENT OF TRANSPORTATION**

**ARTERIAL ROAD  
INFORMATION SIGN**

SCALE: NONE SHEET NO. 1 OF 1 SHEETS STA. TO STA.

F.A. RTE.	SECTION	COUNTY	TOTAL SHEETS	SHEET NO.
VAR.	2008-046 RS	LAKE	29	29
TC-22		CONTRACT NO. 60E95		
FED. ROAD DIST. NO. 1 [ILLINOIS] FED. AID PROJECT				