

F. A. U. NO.	SECTION	COUNTY	TOTAL SHEETS	SHEET NO.
2947	08-00148-00-RS	COOK	011	008
STA. 52+00	TO STA. 70+00			
FED. ROAD DIST. NO.	KLINGS	FED. AID PROJECT		

CONTRACT #63044

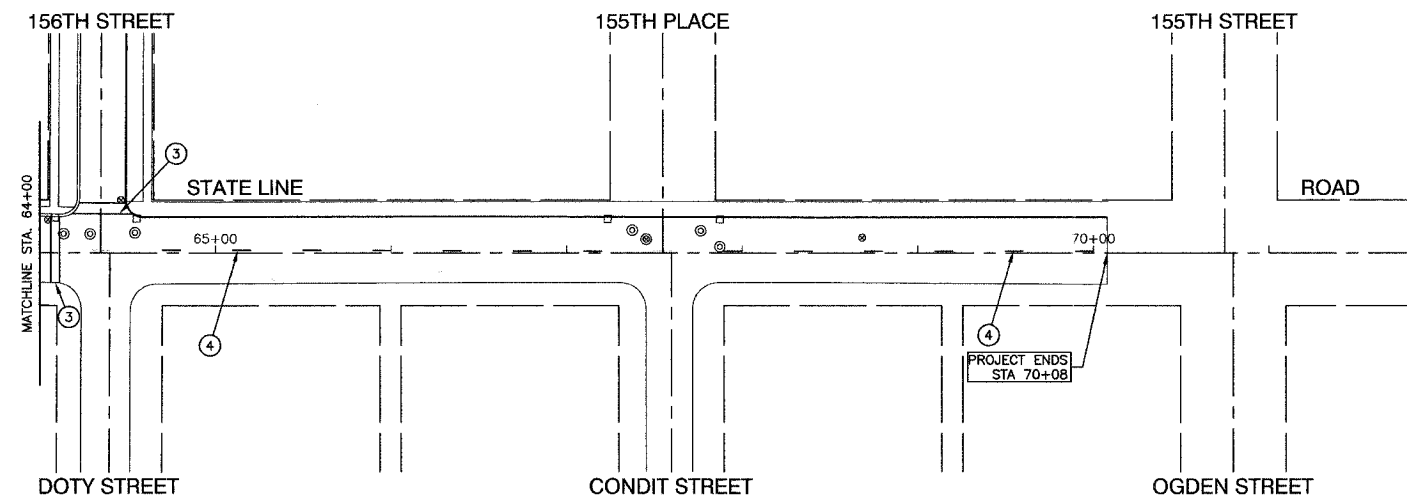
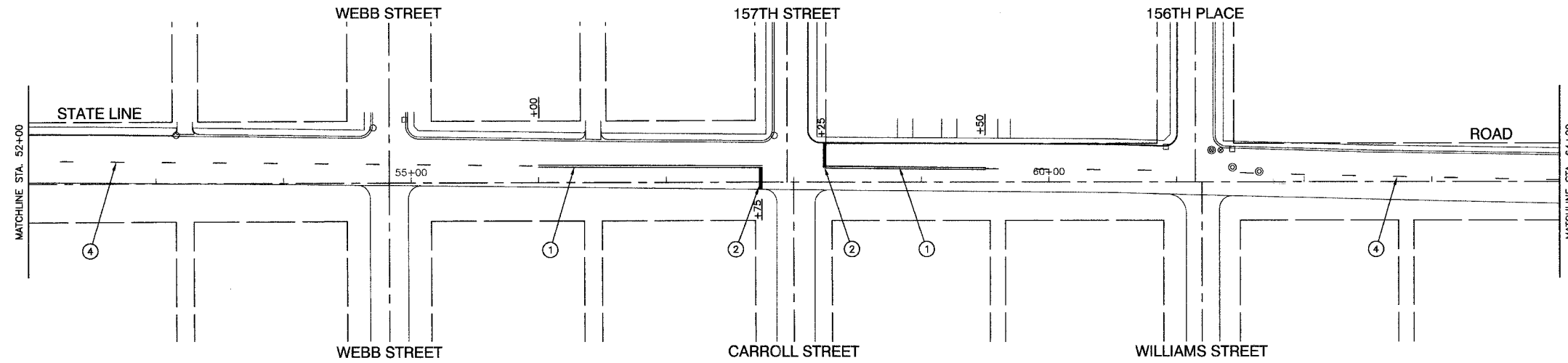
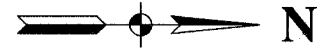

**NOTE:**  
ALL LEGEND ITEMS ARE PAINTED  
PAVEMENT MARKING OF THE WIDTH AND TYPE SPECIFIED

**PAVEMENT MARKING LEGEND**

- ① PAINT PAVEMENT MARKING—LINE 4" (YELLOW)
- ② PAINT PAVEMENT MARKING—LINE 24" (WHITE)
- ③ PAINT PAVEMENT—LINE 6" (WHITE)
- ④ 4" YELLOW SKIP - DASH LINE (10' LINE - 30' SPACE)

REVISIONS	
NAME	DATE

ILLINOIS DEPARTMENT OF TRANSPORTATION

**STATELINE ROAD  
ROADWAY RESURFACING  
PAVEMENT MARKING PLAN**

SCALE: VERT. NA  
HORIZ. 1"=50'  
DATE 04/23/08

DRAWN BY PS  
CHECKED BY RW