

F.A.U. RTE.	SECTION	COUNTY	TOTAL SHEETS	SHEET NO.
2689	06-00087-00-PK	COOK	18	1
FED. ROAD DIST. NO.	ILLINOIS	FED. AID PROJECT		
CONTRACT NO: 63057				

**STATE OF ILLINOIS  
DEPARTMENT OF TRANSPORTATION  
DIVISION OF HIGHWAYS**

**PLANS FOR PROPOSED  
FEDERAL AID HIGHWAY**

**CONGESTION MITIGATION  
AND AIR QUALITY (CMAQ)  
IMPROVEMENT PROGRAM  
SECTION: 06-00087-00-PK  
WOLF ROAD (FAU 2689)  
COMMUTER PARKING FACILITY EXPANSION  
PROJECT: CMM-8003(751)  
VILLAGE OF WESTERN SPRINGS  
COOK COUNTY  
C-91-144-07**

FOR INDEX OF SHEETS, SEE SHEET NO. 2

**TRAFFIC DATA**

**ADT:**

WOLF ROAD = 9700

**SPEED LIMIT:**

WOLF ROAD = 35 MPH (POSTED)  
40 MPH (DESIGN)

DESIGN DESIGNATION: COLLECTOR

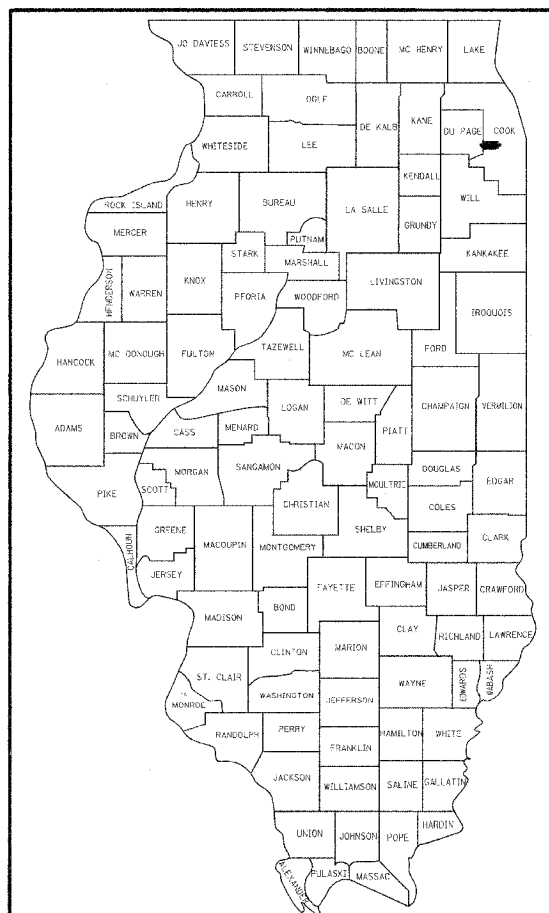

LOCATION OF SECTION INDICATED THUS: - [Symbol] -

PROJECT LOCATED IN  
VILLAGE OF WESTERN SPRINGS

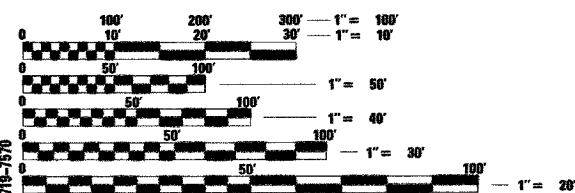

FULL SIZE PLANS HAVE BEEN PREPARED USING STANDARD ENGINEERING SCALES. REDUCED SIZED PLANS WILL NOT CONFORM TO STANDARD SCALES. IN MAKING MEASUREMENTS ON REDUCED PLANS, THE ABOVE SCALES MAY BE USED.

J.U.L.I.E.  
JOINT UTILITY LOCATION INFORMATION FOR EXCAVATION  
1-800-892-0123

CONTRACT NO. 63057

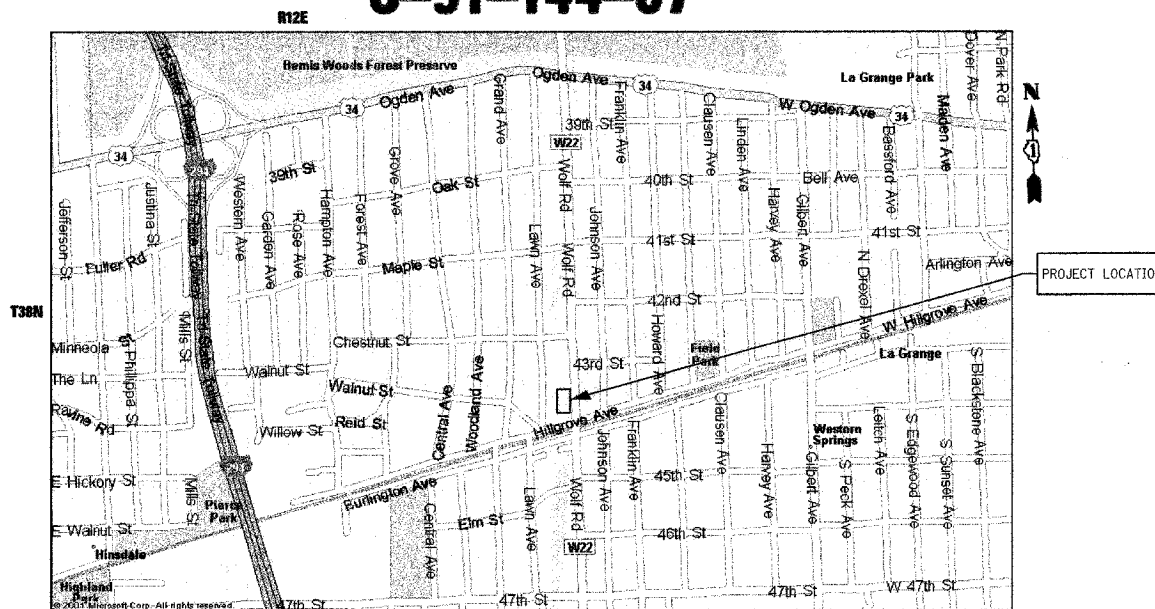

LOCATION MAP  
SCALE: NTS

GROSS & NET LENGTH OF PROJECT: 106.00 FT. (0.019 MILES)

STATE OF ILLINOIS  
DEPARTMENT OF TRANSPORTATION  
DIVISION OF HIGHWAYS

APPROVED: 6-2 2008

*William M. [Signature]*  
Western Springs, Director of Municipal Services

PASSED: JUNE 5 2008

*Christopher Holt*  
District 1 Engineer of Local Roads & Streets

Releasing for Bid  
Based on Limited  
Review JUNE 6, 2008

*Diane M. O'Keefe*  
Deputy Director of Highways, Region 1 Engineer

PRINTED BY AUTHORITY OF THE STATE OF ILLINOIS

**JJB** JAMES J. BENES & ASSOCIATES  
CONSULTING ENGINEERS  
950 WARRENVILLE ROAD, SUITE 101  
LISLE, IL 60532  
(630) 719-7570

SIGNATURE: *[Signature]*  
DATE: 6/2/08

IL LICENSE NO: 062-080441  
EXP. DATE: NOVEMBER 30, 2009  
FIELD: JAMES J. BENES AND ASSOCIATES, INC.  
CIVIL ENGINEERING

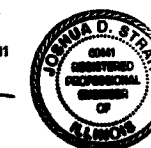

FIELD ENGINEER: MARILIN SOLOMON (847) 705-4407  
CONSULTANT: JAMES J. BENES & ASSOCIATES, INC. (630) 719-7570