

MATCH LINE STA. 243+00

MATCH LINE STA. 249+00

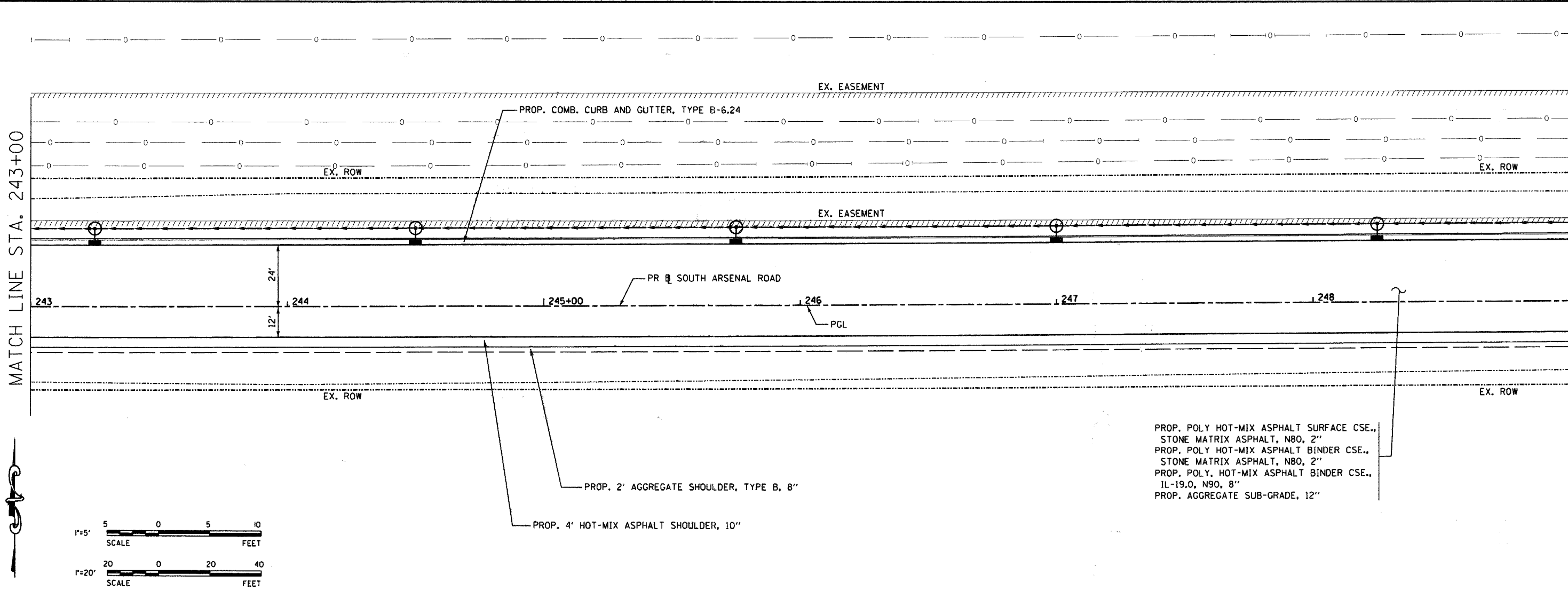

PROP. POLY HOT-MIX ASPHALT SURFACE CSE.,
 STONE MATRIX ASPHALT, N80, 2"
 PROP. POLY HOT-MIX ASPHALT BINDER CSE.,
 STONE MATRIX ASPHALT, N80, 2"
 PROP. POLY. HOT-MIX ASPHALT BINDER CSE.,
 IL-19.0, N90, 8"
 PROP. AGGREGATE SUB-GRADE, 12"

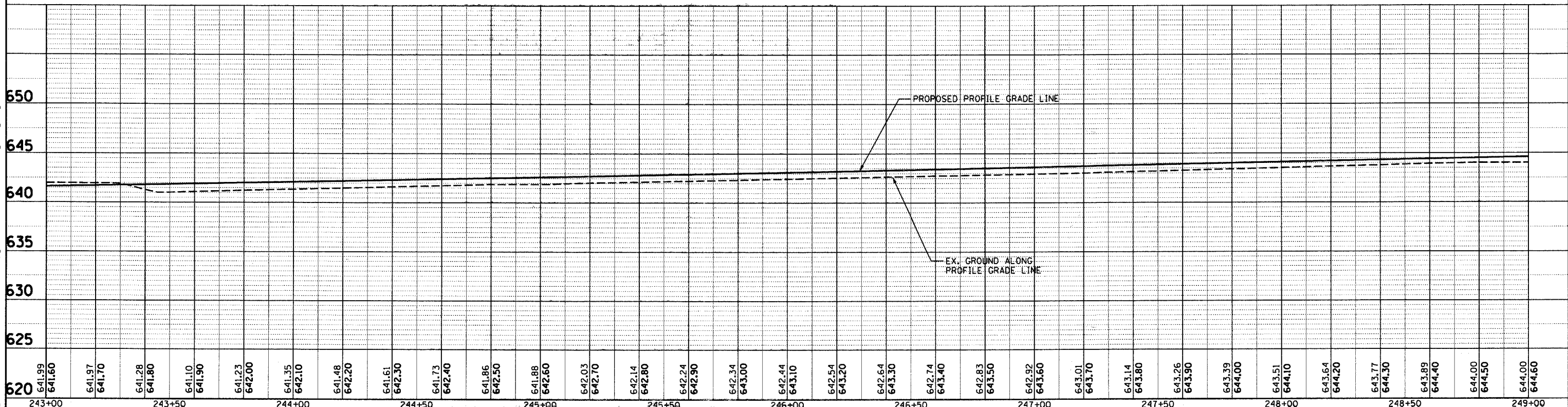
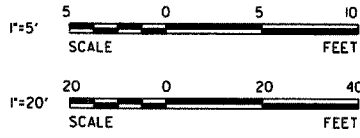

620	641.99	641.60	641.97	641.70	641.28	641.80	641.10	641.90	641.23	642.00	641.35	642.10	641.48	642.20	641.61	642.30	641.73	642.40	641.86	642.50	641.88	642.60	642.03	642.70	642.14	642.80	642.24	642.90	642.34	643.00	642.44	643.10	642.54	643.20	642.64	643.30	642.74	643.40	642.83	643.50	642.92	643.60	643.01	643.70	643.14	643.80	643.26	643.90	643.39	644.00	643.51	644.10	643.64	644.20	643.77	644.30	643.89	644.40	644.00	644.50	644.00	644.60
243+00	243+50				244+00				244+50				245+00				245+50				246+00				246+50				247+00				247+50				248+00				248+50				249+00																	

ESI CONSULTANTS, LTD
 1078 N. MILL STREET, SUITE 100
 NAPERVILLE, IL 60563
 (630) 420-1730
 WWW.ESICONSULTANTS.LTD.COM
 ILLINOIS DEPARTMENT OF PROFESSIONAL REGULATION REGISTRATION #184-003893

DESIGNED - JRS	REVISED -
DRAWN - DJN	REVISED -
CHECKED - MAR	REVISED -
DATE - 6/16/2008	REVISED -

STATE OF ILLINOIS
 DEPARTMENT OF TRANSPORTATION

PLAN AND PROFILE

SCALE: 1"=20' SHEET NO. OF SHEETS STA. 243+00 TO STA. 249+00

F.A. RTE.	SECTION	COUNTY	TOTAL SHEETS	SHEET NO.
	08-00039-00-FP	WILL	89	22
CONTRACT NO. 63066				
ILLINOIS FED. AID PROJECT				

6/16/2008 HighProject\Boulet Arsenal Development Authority\South Arsenal Road.Eos\CADD\Sheet\22 PP10.sht