

ROAD CLOSED SIGNING LOCATIONS



LOCATION A - SPRINGFIELD



LOCATION B - JACKSONVILLE

SUGGESTED CONSTRUCTION SEQUENCE

WORK DONE UNDER ROAD CLOSURE

- 1.) THE CONTRACTOR SHALL PLACE ROAD CLOSED SIGNS IN ACCORDANCE WITH THIS SHEET AND STANDARD BLR 21-7.
- 2.) REMOVE EXISTING PAVEMENT AND PAVED SHOULDERS FROM STA. 639+50 TO STA. 639+90.
- 3.) REMOVE EXISTING STRUCTURE STA. 639+70, GUARDRAIL AND EXISTING PAVED SHOULDERS FROM STA. 636+55 TO STA. 642+85 LT. & RT.
- 4.) INSTALL PRECAST CONCRETE BOX CULVERT AND GRANULAR CULVERT BACKFILL STA. 639+70.
- 5.) INSTALL HMA BASE COURSE, 10" STA. 639+50 TO STA. 639+90.
- 6.) INSTALL HMA LEVELING BINDER FROM STA. 636+75 TO STA. 639+50 AND STA. 639+90 TO STA. 641+05.
- 7.) INSTALL HMA SHOULDERS, 8" STA. 636+55 TO STA. 642+85 LT. & RT.
- 8.) THE CONTRACTOR SHALL OPEN THE ROAD TO TRAFFIC AND COMPLETE REMAINING WORK UNDER FLAGGERS.

WORK DONE UNDER FLAGGERS

- 1.) CONSTRUCT CAST IN PLACE CONCRETE END SECTIONS STA. 639+70.
- 2.) REMOVE PIPE CULVERTS STA. 636+90 LT., STA. 639+11 RT., STA. 639+90 LT. AND STA. 640+39 RT.
- 3.) INSTALL NEW PIPE CULVERTS AND METAL END SECTIONS STA. 636+90 LT, STA. 639+11 RT. AND STA. 640+39 RT.
- 4.) SHAPE AND GRADE EARTH FOR SHOULDERS, DITCHES AND ENTRANCES STA. 636+55 TO STA. 642+85.
- 5.) CONSTRUCT AGGREGATE SHOULDERS STA. 636+55 TO STA. 642+85 LT. & RT. AND AGGREGATE ENTRANCES STA. 636+90 LT., STA. 639+11 RT. AND STA. 640+39 RT.
- 6.) PLACE HMA SURFACE COURSE STA. 636+55 TO STA. 642+85.
- 7.) FINAL STRIPING, SEEDING AND MISCELLANEOUS CLEANUP.

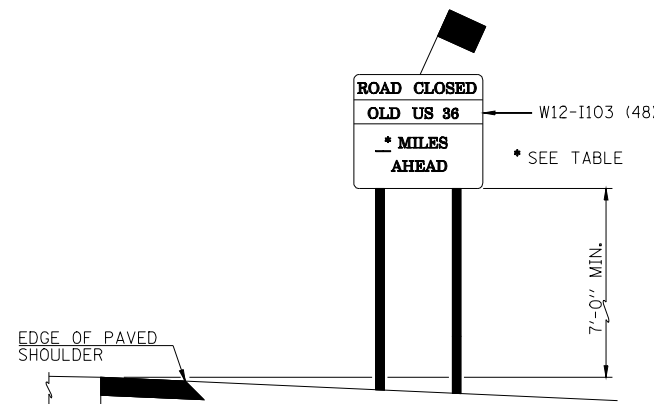

SIGN A, B, C & D

NOTE: AT ALL LOCATIONS FOR SIGN A, B & C, TWO SIGNS WILL BE PLACED, ONE ON EACH SIDE OF THE INTERSTATE.

SIGN	MILES AHEAD
A	7
B	4
C	15
D	2

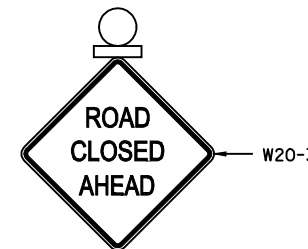

SIGN D
WITH FLASHING LIGHT

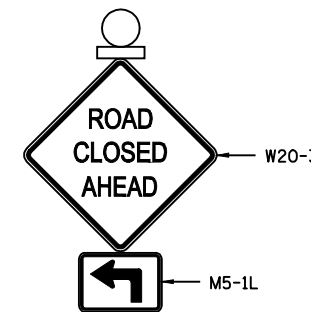

SIGN E
WITH FLASHING LIGHT

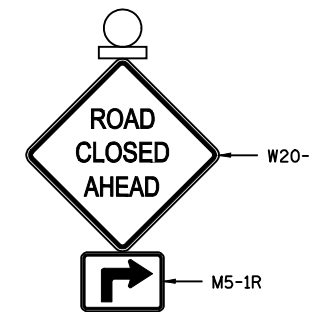

SIGN F
WITH FLASHING LIGHT

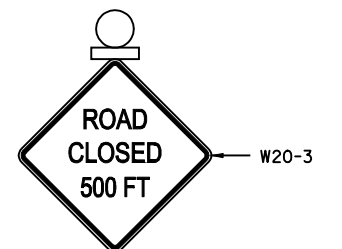

SIGN G
WITH FLASHING LIGHT

FILE NAME = d672b44-sh1-sign.dgn

USER NAME =
PLOT SCALE =
PLOT DATE = May-09-2008 02:19:01PM

DESIGNED - RKA
DRAWN - RKA
CHECKED - CPK
DATE - 3/25/08

REVISED -
REVISED -
REVISED -
REVISED -



Allen Henderson & Associates, Inc.
Civil and Structural Engineers Springfield, IL.
62708 Phone: (217)544-8033 IL Design Firm
No. 184-001907

CONSTRUCTION SEQUENCE & ROAD CLOSED SIGNING

SCALE: NONE SHEET NO. 9 OF 19 SHEETS STA. 636+55 TO STA. 642+85

F.A.S. RTE.	SECTION	COUNTY	TOTAL SHEETS	SHEET NO.
1613	23B	SANGAMON	19	9
CONTRACT NO. 72B44				
FED. ROAD DIST. NO. ILLINOIS FED. AID PROJECT				