

F.A.S. RTE.	SECTION	COUNTY	TOTAL SHEETS	SHEET NO.
1613	23B	SANGAMON	19	1
FED. ROAD DIST. NO.	ILLINOIS	CONTRACT NO. 72B44		

STATE OF ILLINOIS  
DEPARTMENT OF TRANSPORTATION  
DIVISION OF HIGHWAYS

**PROPOSED  
HIGHWAY PLANS**

F.A.S. ROUTE 1613 (OLD US 36)  
SECTION 23B  
PROJECT : RS-1613(106)  
SANGAMON COUNTY  
C-96-123-07

FOR INDEX OF SHEETS, SEE SHEET NO. 2

D-96-123-07

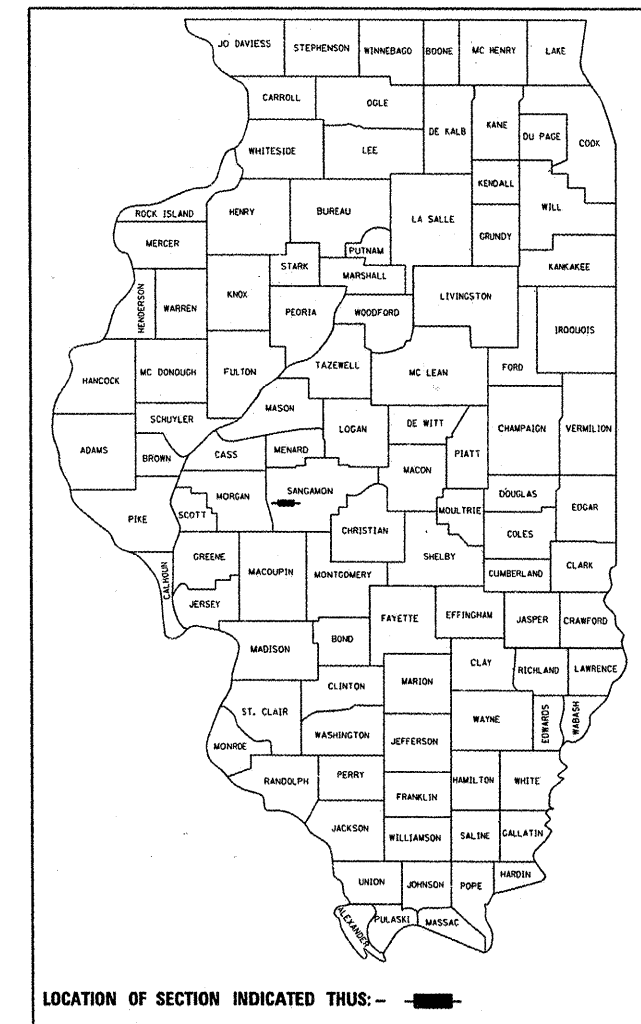

LOCATION OF SECTION INDICATED THUS: — ■ —

ADT = 2500 (2008)  
% SU = NOT AVAILABLE  
% MU = NOT AVAILABLE  
TOWNSHIP: NEW BERLIN  
FUNCTIONAL CLASSIFICATION: MAJOR COLLECTOR

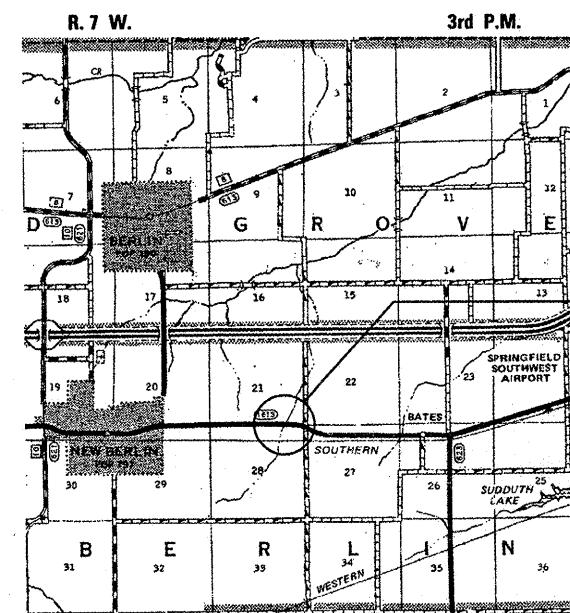

**LOCATION MAP**

BOX CULVERT REPLACEMENT OVER  
UNNAMED TRIB. TO SPRING CREEK

PROPOSED PROJECT BEGINS  
-STA. 636 + 55

PROPOSED PRECAST CONCRETE  
BOX CULVERT (12'-0"W X 5'-0"H)  
OVER UNNAMED TRIBUTARY OF  
SPRING CREEK, 0° SKEW  
S.N. 084-7132  
-STA. 639 + 70

PROPOSED PROJECT ENDS  
-STA. 642 + 85

NET LENGTH OF PROJECT = 630.00 FEET = 0.119 MILES

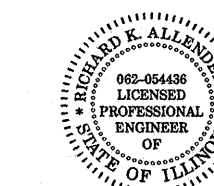
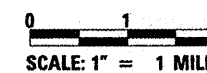

*Richard K. Allender III*  
EXPIRATION: 11/30/2009

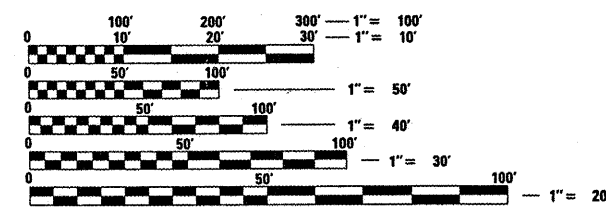

FULL SIZE PLANS HAVE BEEN PREPARED USING STANDARD  
ENGINEERING SCALES. REDUCED SIZED PLANS WILL NOT  
CONFORM TO STANDARD SCALES. IN MAKING MEASUREMENTS  
ON REDUCED PLANS, THE ABOVE SCALES MAY BE USED.

J.U.L.I.E.  
JOINT UTILITY LOCATION INFORMATION FOR EXCAVATION  
1-800-892-0123  
OR 811

SQUAD LEADER: MARCUS BRUCE (217)524-0946  
PROJECT ENGINEER: SAL MADONIA (217)782-4761

CONTRACT NO. 72B44

STATE OF ILLINOIS  
DEPARTMENT OF TRANSPORTATION  
DIVISION OF HIGHWAYS

SUBMITTED *May 9, 2008*  
*Christina M. Reed*  
DEPUTY DIRECTOR OF HIGHWAYS, REGION FOUR ENGINEER

*June 27, 2008*  
*Eric E. Harn*  
Interim ENGINEER OF DESIGN AND ENVIRONMENT

*June 27, 2008*  
*Christina M. Reed*  
DIRECTOR OF HIGHWAYS, CHIEF ENGINEER

**PRINTED BY THE AUTHORITY  
OF THE STATE OF ILLINOIS**

**PROPERTY OWNER ACCESS REQUIREMENT**

ACCESS MUST BE MAINTAINED TO ALL EXISTING PROPERTIES DURING CONSTRUCTION PER ARTICLE 107.09 UNLESS ARRANGEMENTS ARE MADE IN WRITING BY THE CONTRACTOR WITH THE PROPERTY OWNERS WITH A COPY TO THE ENGINEER FOR SHORT-TERM CLOSURES.

**GENERAL NOTES**

- 1.) THE THICKNESS OF HOT-MIX ASPHALT MIXTURES SHOWN ON THE PLANS IS THE NOMINAL THICKNESS. DEVIATIONS FROM THE NOMINAL THICKNESS WILL BE PERMITTED WHEN SUCH DEVIATIONS OCCUR DUE TO IRREGULARITIES IN THE EXISTING SURFACE OR BASE ON WHICH THE BITUMINOUS MIXTURE IS PLACED.
- 2.) EXCEPT AS NOTED IN THE PLANS, PAVEMENT GRADES SHOWN ARE AT THE TOP OF PAVEMENT SURFACES.
- 3.) WHERE SECTION OR SUBSECTION MONUMENTS ARE ENCOUNTERED, THE ENGINEER SHALL BE NOTIFIED BEFORE SUCH MONUMENTS ARE REMOVED. THE CONTRACTOR SHALL PROTECT AND CAREFULLY PRESERVE ALL PROPERTY MARKERS AND MONUMENTS UNTIL THE OWNER OR AN AUTHORIZED SURVEYOR OR AGENT HAS WITNESSED OR OTHERWISE REFERENCED THEIR LOCATION. THE CONTRACTOR WILL BE RESPONSIBLE FOR HAVING AN AUTHORIZED SURVEYOR RE-ESTABLISH ANY SECTION OR SUBSECTION MONUMENTS DESTROYED BY HIS OPERATIONS.
- 4.) SEEDING WILL NOT BE PERMITTED AT ANY TIME WHEN THE GROUND IS FROZEN, WET OR IN AN UNTILLABLE CONDITION. AREAS TO BE SEEDED SHALL BE DETERMINED BY THE ENGINEER AND SEEDED AS SOON AS POSSIBLE.
- 5.) ALL SAW CUTS, NECESSARY TO COMPLETE THE WORK DETAILED IN THESE PLANS, SHALL BE INCLUDED IN THE COST FOR THE VARIOUS PAY ITEMS INVOLVED. THE MINIMUM SAW CUT DEPTH IN THE PAVEMENT SHALL BE 1/2" UNLESS UNLESS OTHERWISE SPECIFIED IN A DETAIL SHOWN IN THE PLANS.
- 6.) UNLESS DIRECTED BY THE ENGINEER, PAVEMENT MARKING LINES SHALL NOT BE LAID DIRECTLY OVER A LONGITUDINAL CRACK OR JOINT NOR OVER A TAR OR ASPHALT PAINTED LINE. THE EDGE OF A CENTERLINE OR LANE LINE SHALL BE OFFSET A MINIMUM DISTANCE OF 2" FROM A LONGITUDINAL CRACK OR JOINT. EDGE LINES SHALL BE APPROXIMATELY 2" FROM THE EDGE LINE OF PAVEMENT. SEE SECTION 780 OF THE STANDARD SPECIFICATIONS FOR TRAFFIC CONTROL ITEMS.
- 7.) ABANDONED UNDERGROUND UTILITIES THAT CONFLICT WITH CONSTRUCTION SHALL BE DISPOSED OUTSIDE THE LIMITS OF RIGHT OF WAY ACCORDING TO ARTICLE 202.03 OF THE STANDARD SPECIFICATIONS AND AS DIRECTED BY THE ENGINEER. THIS WORK WILL NOT BE PAID FOR SEPERATELY BUT SHALL BE INCLUDED IN THE COST PER CUBIC YARD FOR EARTH EXCAVATION AND NO ADDITIONAL COMPENSATION WILL BE ALLOWED.
- 8.) ANY REFERENCE TO A STANDARD IN THESE PLANS SHALL BE INTERPRETED TO MEAN THE EDITION AS INDICATED BY THE SUBNUMBER LISTED IN THE INDEX OF SHEETS OR THE COPY OF THE STANDARD INCLUDED IN THESE PLANS.

- 9.) IN ADDITION TO THE FIELD SURVEYS, PLAN DIMENSIONS AND DETAILS RELATIVE TO THE EXISTING FACILITIES HAVE BEEN TAKEN FROM EXISTING PLANS AND ARE SUBJECT TO CONSTRUCTION VARIATIONS. IT SHALL BE THE CONTRACTOR'S RESPONSIBILITY TO VERIFY SUCH DIMENSIONS AND DETAILS IN THE FIELD. SUCH VARIATIONS SHALL NOT BE A CAUSE FOR ADDITIONAL COMPENSATION DUE TO CHANGE IN THE SCOPE OF WORK. HOWEVER, THE CONTRACTOR WILL BE PAID FOR THE QUANTITY ACTUALLY FURNISHED AT THE UNIT PRICE BID FOR THE WORK.
- 10.) THE EXISTING ROAD SIGNS THAT INTERFERE WITH CONSTRUCTION WILL BE REMOVED OR RELOCATED AS DIRECTED BY THE ENGINEER. AFTER THE CONSTRUCTION IS COMPLETED, THE CONTRACTOR WILL REPLACE THE SIGNS AS DIRECTED BY THE ENGINEER. THIS WORK WILL NOT BE PAID FOR SEPERATELY BUT SHALL BE CONSIDERED INCLUDED IN THE CONTRACT, AND NO COMPENSATION WILL BE ALLOWED.
- 11.) THE LOCATION OF ALL UTILITIES ARE BASED ON INFORMATION PROVIDED BY OTHERS AND IS INTENDED TO BE APPROXIMATE. IT SHALL BE THE CONTRACTOR'S RESPONSIBILITY TO COORDINATE HIS CONSTRUCTION ACTIVITIES WITH THE VARIOUS UTILITY OWNERS. ALL POTENTIAL CONFLICTS SHALL BE INVESTIGATED AND REMEDIAL ACTION TAKEN PRIOR TO INTERRUPTION OF THE CONTRACTOR'S PROGRESS.
- 12.) THE CONTRACTOR SHALL BE RESPONSIBLE FOR PROTECTING UTILITY PROPERTY FROM CONSTRUCTION OPERATIONS AS OUTLINED IN ARTICLE 107.31 OF THE STANDARD SPECIFICATIONS. THE J.U.L.I.E. NUMBER IS 800-892-0123. A MINIMUM OF FORTY-EIGHT HOURS ADVANCE NOTICE IS REQUIRED.
- 13.) ALL ELEVATIONS SHOWN ON THE PLANS ARE BASED ON U.S.G.S. MEAN SEA LEVEL DATUM. ALL STATION AND OFFSET REFERENCES ARE TO THE ROADWAY CENTERLINE UNLESS OTHERWISE NOTED. THE STATE PLANE COORDINATE SYSTEM HAS BEEN USED FOR THE HORIZONTAL CONTROL.
- 14.) THE DISTRICT BUREAU OF OPERATIONS SHALL BE NOTIFIED AT LEAST 21 DAYS PRIOR TO CLOSING THE ROAD TO TRAFFIC (PH: 217-785-5312).
- 15.) THE DISTRICT BUREAU OF OPERATIONS SHALL BE NOTIFIED AT LEAST 14 DAYS PRIOR TO PLACEMENT OF FINAL PAVEMENT MARKINGS (PH: 217-785-5312)

**COMMITMENTS**

- 1.) CONSTRUCTION OF THE CONCRETE DROP BOX STRUCTURE ON THE SOUTH SIDE OF THE STRUCTURE. THE DROP BOX SHALL BE CONSTRUCTED WITH THE OVERFLOW ELEVATION AT 633.00 AND THE APRON INVERT AT 632.42.

**INDEX OF SHEETS**

1	TITLE SHEET
2	GENERAL NOTES, UTILITIES & MIXTURE REQUIREMENTS
3	SUMMARY OF QUANTITIES
4 - 5	DETAILS & TYPICAL ROADWAY SECTIONS
6	QUANTITY SCHEDULES
7	PLAN & PROFILE
8	EROSION CONTROL PLAN
9	CONSTRUCTION SEQUENCE & ROAD CLOSED SIGNING
10 - 13	STRUCTURE PLANS
14 - 19	CROSS SECTIONS
---	STANDARDS

THE FOLLOWING RATES OF APPLICATION HAVE BEEN USED TO CALCULATE THE PLAN QUANTITIES:

HOT MIX ASPHALT MATERIALS (PRIME COAT)	0.00038 TON/SO. YD. (ON PAVEMENT)
HOT MIX ASPHALT MATERIALS (PRIME COAT)	0.001425 TON/SO.YD. (ON AGG)
HOT MIX ASPHALT SURFACE / BINDER	0.056 TON/SO. YD. PER 1"
AGGREGATE MATERIAL	2.05 TON/CU. YD.
RIPRAP	1.5 TON/CU. YD.
NITROGEN FERTILIZER NUTRIENT	90 LBS./ACRE
PHOSPHOROUS FERTILIZER NUTRIENT	90 LBS./ACRE
POTASSIUM FERTILIZER NUTRIENT	90 LBS./ACRE
AGGREGATE PRIME COAT	0.002 TON/SO. YD.
AGRICULTURAL GROUND LIMESTONE	2.0 TON/ACRE
ROCKFILL - FOUNDATION	1.89 TON/CU. YD.

**LIST OF ILLINOIS DOT HIGHWAY STANDARDS**

000001-05	701011-01
001001-01	701301-02
001006	701306-01
280001-04	701311-02
482001-02	701901
542401	780001-01
666001	781001-02
701001-01	BLR 21-7
701006-02	

**MIXTURE REQUIREMENTS**

MIXTURE USE(S)	HOT MIX ASPHALT SURFACE COURSE, MIX "C", N50	LEVELING BINDER (MACHINE METHOD), N50	HOT MIX ASPHALT BASE COURSE & SHOULDERS
AC/PG	PG 64-22	PG 64-22	PG 64-22
DESIGN AIR VOIDS	4.0% @ N DESIGN = 50	4.0% @ N DESIGN = 50	4.0% @ N DESIGN = 50
MIXTURE COMPOSITION	IL 9.5 OR 12.5	IL 9.5 ONLY	IL 19.0
FRICTION AGGREGATE	MIX C	N/A	N/A

<b>DISTRICT SIX</b>	
EXAMINED <i>May 6</i> 20 <i>08</i>	
<i>James J. Hoast</i>	
OPERATIONS ENGINEER	
EXAMINED <i>May 6</i> 20 <i>08</i>	
<i>W.R. Jones</i>	
PROGRAM IMPLEMENTATION ENGINEER	
EXAMINED <i>May 6</i> 20 <i>08</i>	
<i>W.R. Jones</i>	
PROGRAM DEVELOPMENT ENGINEER	

FILE NAME = D672B44-sh1-gennote.dgn	USER NAME =	DESIGNED - RKA	REVISED -
		DRAWN - RKA	REVISED -
	PLOT SCALE =	CHECKED - CPK	REVISED -
	PLOT DATE = 5/9/2008	DATE - 04/10/08	REVISED -

**Allen Henderson & Associates, Inc.**  
Civil and Structural Engineers Springfield, IL  
62703 Phone: (217)544-8033 IL Design Firm  
No. 184-001907

<b>GENERAL NOTES</b>		
SCALE: NONE	SHEET NO. 2 OF 19 SHEETS	STA. 636+55 TO STA. 642+85

F.A.S. RTE.	SECTION	COUNTY	TOTAL SHEETS	SHEET NO.
1613	23B	SANGAMON	19	2
FED. ROAD DIST. NO. ILLINOIS FED. AID PROJECT			CONTRACT NO. 72B44	

SUMMARY OF QUANTITIES					
CODE NO.	SUMMARY OF QUANTITIES PAY ITEM	UNIT	TOTAL QUANTITY	ROADWAY FAS 1613 80% FEDERAL 20% STATE	STRUCTURE S.N. 084-7132 80% FEDERAL 20% STATE
				CONSTRUCTION 1000-2A	TYPE CODE 4007
20200100	EARTH EXCAVATION	CU YD	730	730	
20400800	FURNISHED EXCAVATION	CU YD	70	70	
25000200	SEEDING, CLASS 2	ACRE	0.9	0.9	
25000400	NITROGEN FERTILIZER NUTRIENT	POUND	81	81	
25000500	PHOSPHORUS FERTILIZER NUTRIENT	POUND	81	81	
25000600	POTASSIUM FERTILIZER NUTRIENT	POUND	81	81	
25000700	AGRICULTURAL GROUND LIMESTONE	TON	1.8	1.8	
25100115	MULCH, METHOD 2	ACRE	0.9	0.9	
28000250	TEMPORARY EROSION CONTROL SEEDING	POUND	90	90	
28000400	PERIMETER EROSION BARRIER	FOOT	1197	1197	
28001000	AGGREGATE (EROSION CONTROL)	TON	20	20	
28100205	STONE RIPRAP, CLASS A3	TON	52		52
28200200	FILTER FABRIC	SQ YD	103		103
35501324	HOT-MIX ASPHALT BASE COURSE, 10"	SQ YD	98	98	
40600200	BITUMINOUS MATERIALS (PRIME COAT)	TON	1.0	1.0	
40600300	AGGREGATE (PRIME COAT)	TON	5.3	5.3	
40600625	LEVELING BINDER (MACHINE METHOD), N50	TON	103	103	
40600982	HOT-MIX ASPHALT SURFACE REMOVAL - BUTT JOINT	SQ YD	343	343	
40603310	HOT-MIX ASPHALT SURFACE COURSE, MIX "C" N50	TON	163	163	
44000100	PAVEMENT REMOVAL	SQ YD	98	98	
44004250	PAVED SHOULDER REMOVAL	SQ YD	210	210	
48101200	AGGREGATE SHOULDERS, TYPE B	TON	213	213	
48203029	HOT-MIX ASPHALT SHOULDERS, 8"	SQ YD	397	397	
50100200	REMOVAL OF EXISTING STRUCTURES	L SUM	1		1
50105220	PIPE CULVERT REMOVAL	FOOT	110	110	
50800105	REINFORCEMENT BARS	POUND	3890		3890
54003000	CONCRETE BOX CULVERTS	CU YD	35.0		35.0
54021205	PRECAST CONCRETE BOX CULVERT 12' X 5' (M273)	FOOT	58		58
54200640	PIPE CULVERTS, TYPE 1, CORRUGATED STEEL OR ALUMINUM CULVERT PIPE 15"	FOOT	174	174	
63200310	GUARDRAIL REMOVAL	FOOT	178	178	
66600105	FURNISHING AND ERECTING RIGHT-OF-WAY MARKERS	EACH	12	12	

SUMMARY OF QUANTITIES					
CODE NO.	SUMMARY OF QUANTITIES PAY ITEM	UNIT	TOTAL QUANTITY	ROADWAY FAS 1613 80% FEDERAL 20% STATE	STRUCTURE S.N. 084-7132 80% FEDERAL 20% STATE
				CONSTRUCTION 1000-2A	TYPE CODE 4007
67000400	ENGINEER'S FIELD OFFICE, TYPE A	CAL MO	3	3	
67100100	MOBILIZATION	L SUM	1	1	
70101830	TRAFFIC CONTROL AND PROTECTION, STANDARD BLR 21	L SUM	1	1	
70103700	TRAFFIC CONTROL COMPLETE	L SUM	1	1	
70300100	SHORT-TERM PAVEMENT MARKING	FOOT	252	252	
* 78001120	PAINT PAVEMENT MARKING - LINE 5"	FOOT	2050	2050	
78300100	PAVEMENT MARKING REMOVAL	SQ FT	745	745	
78300200	RAISED REFLECTIVE PAVEMENT MARKER REMOVAL	EACH	8	8	
X0324118	GRANULAR CULVERT BACKFILL	CU YD	189		189
Z0013798	CONSTRUCTION LAYOUT	L SUM	1	1	
* Z0054517	ROCKFILL - FOUNDATION	TON	43		43

\* SPECIALTY ITEMS

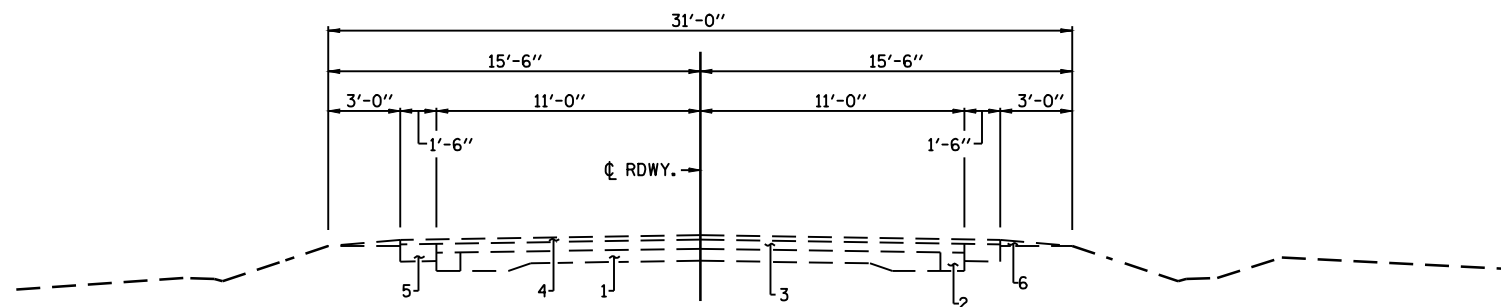

**EXISTING TYPICAL SECTION**  
(STA. 636+55 TO STA. 642+85)

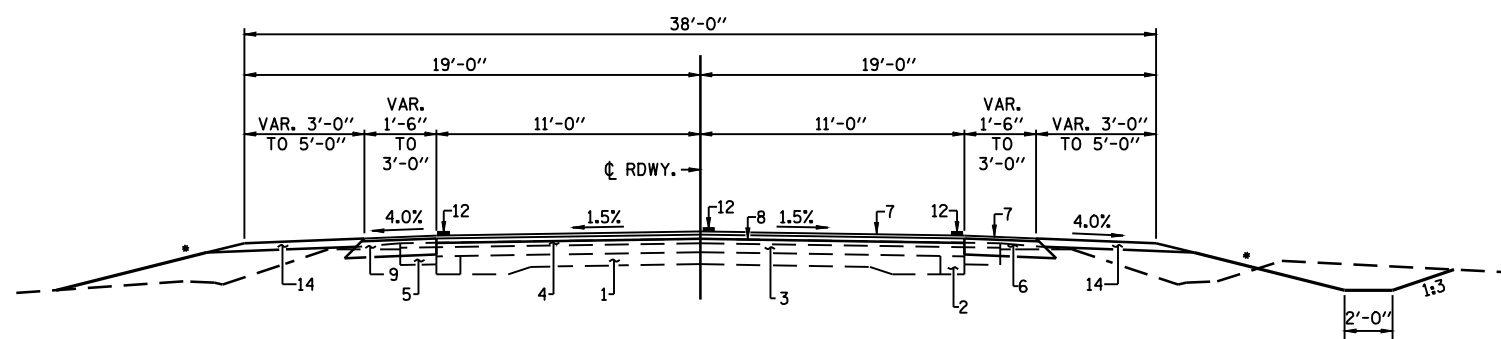

**PROPOSED TYPICAL SECTION**  
(STA. 636+55 TO STA. 637+25 & STA. 642+15 TO STA. 642+85)

• VARIES 1:4 TO 1:6

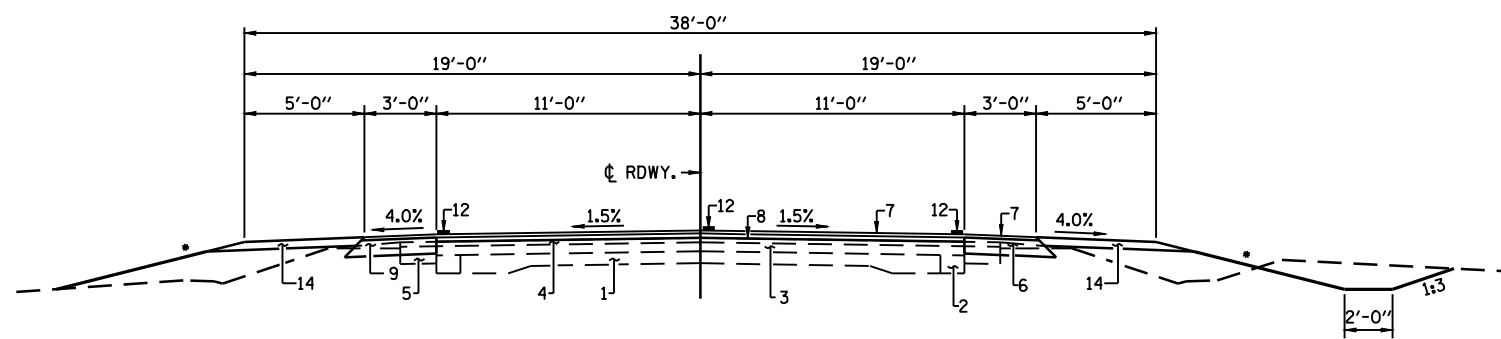

**PROPOSED TYPICAL SECTION**  
(STA. 637+25 TO STA. 639+50 & STA. 639+90 TO STA. 642+15)

• VARIES 1:4 TO 1:6

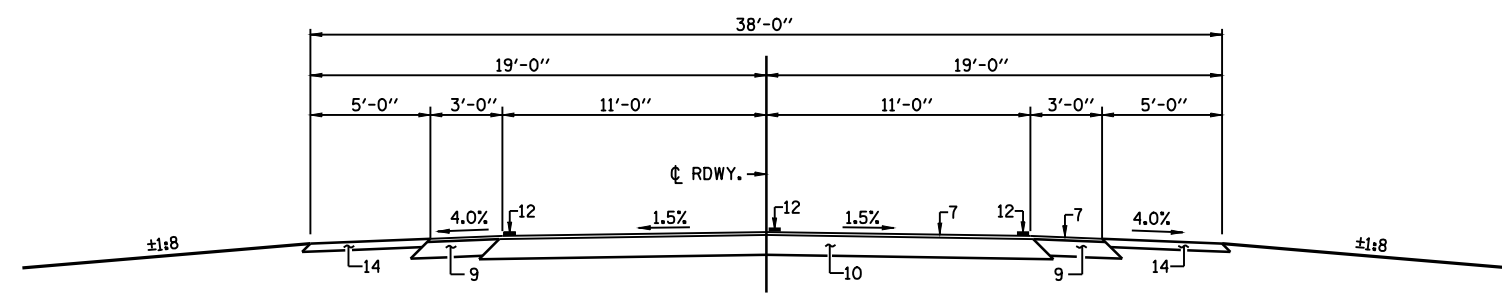

**PROPOSED TYPICAL SECTION**  
(STA. 639+50 TO STA. 639+90)

**PAVEMENT LEGEND**

1. EXISTING P.C.C. PAVEMENT 9'-6"-9"
2. EXISTING HOT MIX ASPHALT WIDENING
3. EXISTING HOT MIX ASPHALT OVERLAY 6"
4. EXISTING HOT MIX ASPHALT OVERLAY VARIABLE
5. EXISTING HOT MIX ASPHALT SHOULDER 6"
6. EXISTING AGGREGATE SHOULDER WEDGE, TYPE B
7. PROPOSED HOT MIX ASPHALT SURFACE COURSE, 1 1/2" MIX. C N50
8. PROPOSED LEVELING BINDER (MACHINE METHOD) 3/4" (MIN)
9. PROPOSED HOT MIX ASPHALT SHOULDER, 8"
10. PROPOSED HOT MIX ASPHALT BASE COURSE, 10"
11. PROPOSED CULVERT GRANULAR BACKFILL
12. PROPOSED PAINT PAVEMENT MARKING LINE 5"
13. PROPOSED ROCKFILL - FOUNDATION
14. PROPOSED AGGREGATE SHOULDERS, TYPE B, 4"

FILE NAME = d672b44-sh-typical.dgn	USER NAME =	DESIGNED - RKA	REVISED -	 <b>Allen Henderson &amp; Associates, Inc.</b> Civil and Structural Engineers Springfield, IL. 62708 Phone: (217)544-8033 IL Design Firm No. 184-001907	<b>DETAILS &amp; TYPICAL ROADWAY SECTIONS</b>			F.A.S. RTE.	SECTION	COUNTY	TOTAL SHEETS	SHEET NO.
PLOT SCALE =	CHECKED - CPK	REVISED -	REVISED -		SCALE: NONE	SHEET NO. 4 OF 19 SHEETS	STA. 636+55 TO STA. 642+85	1613	23B	SANGAMON	19	4
PLOT DATE = May-09-2008 02:18:49PM	DATE - 3/25/08	REVISED -	REVISED -					CONTRACT NO. 72B44				
								FED. ROAD DIST. NO. ILLINOIS FED. AID PROJECT				

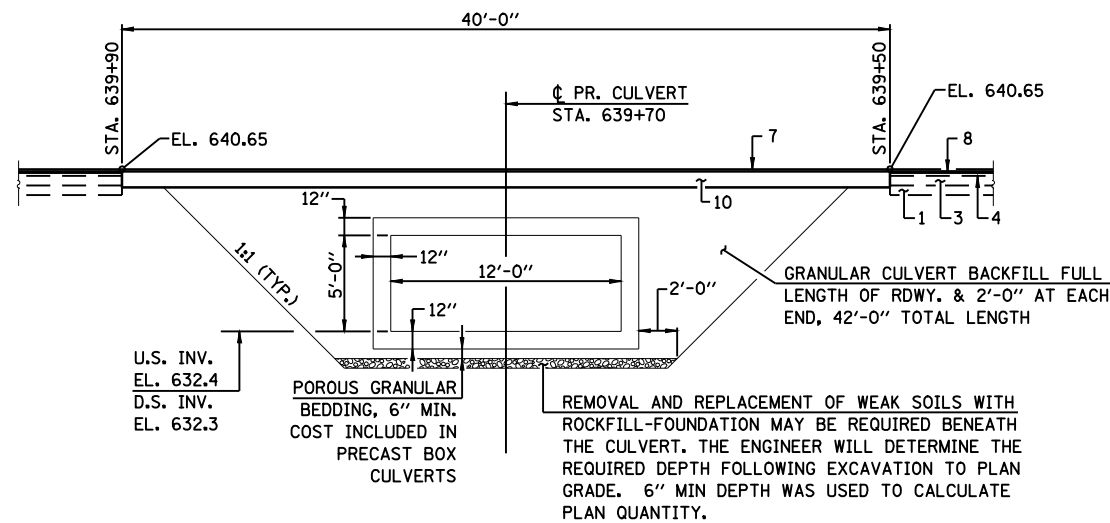

ELEVATION - BOX CULVERT

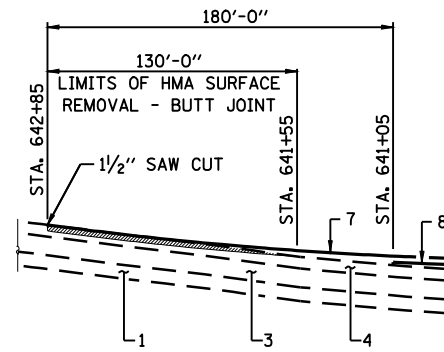

BUTT JOINT DETAIL  
 (STA. 641+05 TO STA. 642+85)

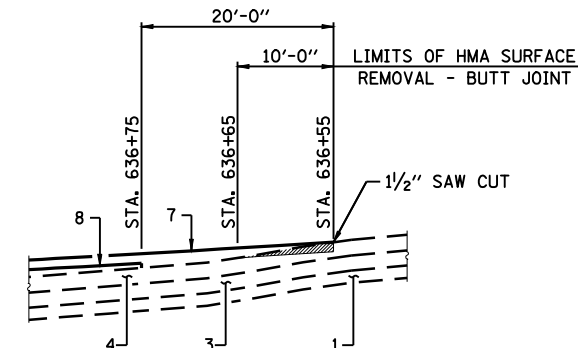

BUTT JOINT DETAIL  
 (STA. 636+55 TO STA. 636+75)

PAVEMENT LEGEND

1. EXISTING P.C.C. PAVEMENT 9'-6"-9"
2. EXISTING HOT MIX ASPHALT WIDENING
3. EXISTING HOT MIX ASPHALT OVERLAY 6"
4. EXISTING HOT MIX ASPHALT OVERLAY VARIABLE
5. EXISTING HOT MIX ASPHALT SHOULDER 6"
6. EXISTING AGGREGATE SHOULDER WEDGE, TYPE B
7. PROPOSED HOT MIX ASPHALT SURFACE COURSE, 1 1/2" MIX. C N50
8. PROPOSED LEVELING BINDER (MACHINE METHOD) 3/4" (MIN)
9. PROPOSED HOT MIX ASPHALT SHOULDER, 8"
10. PROPOSED HOT MIX ASPHALT BASE COURSE, 10"
11. PROPOSED CULVERT GRANULAR BACKFILL
12. PROPOSED PAINT PAVEMENT MARKING LINE 5"
13. PROPOSED ROCKFILL - FOUNDATION
14. PROPOSED AGGREGATE SHOULDERS, TYPE B, 4"

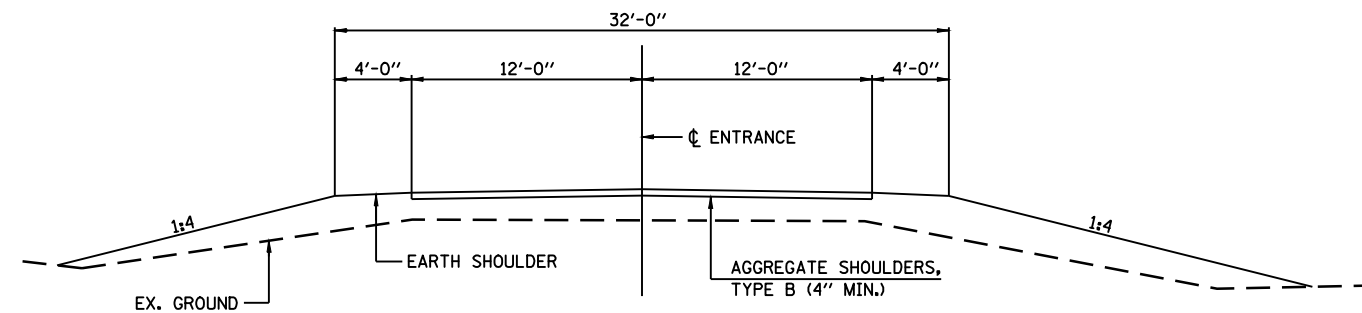

TYPICAL ENTRANCE SECTION  
 (FIELD AND PRIVATE)

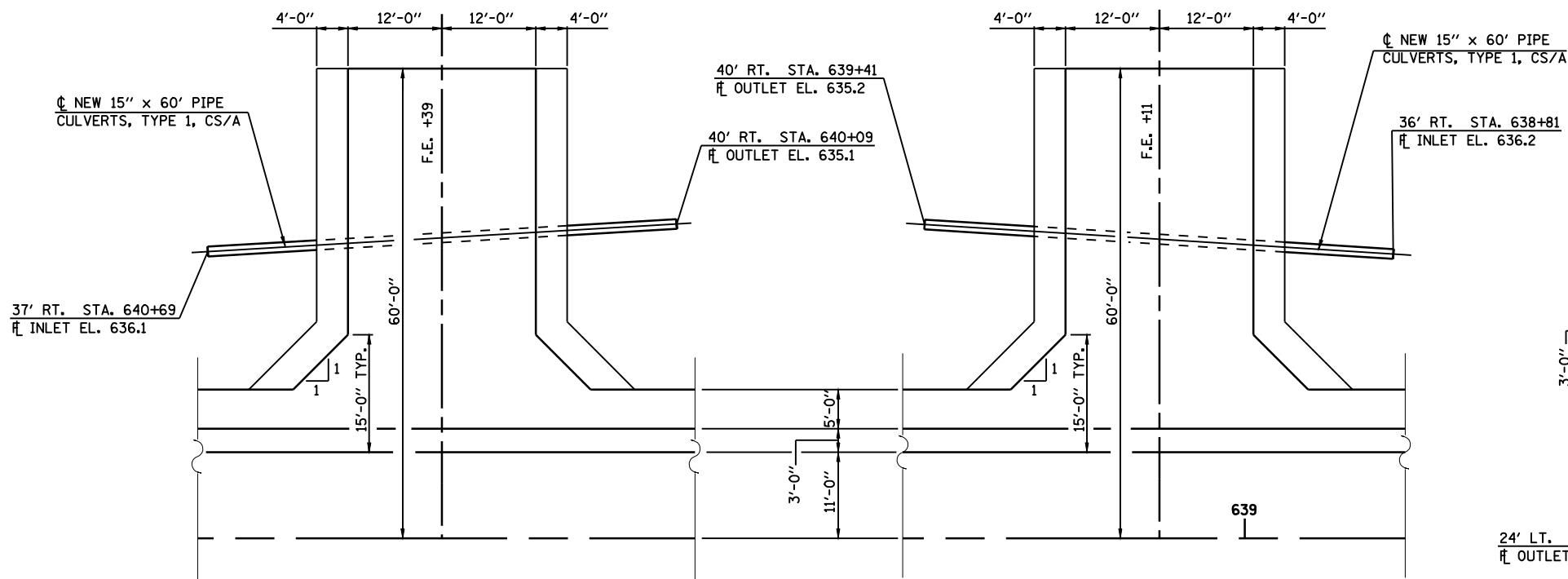

PLAN  
 (F.E. STA. 640+39)

PLAN  
 (F.E. STA. 639+11)

PLAN  
 (P.E. STA. 636+90)

FILE NAME = d672b44-sht-details.dgn

USER NAME =  
 PLOT SCALE =  
 PLOT DATE = May-09-2008 02:18:51PM

DESIGNED - RKA  
 DRAWN - RKA  
 CHECKED - CPK  
 DATE - 3/25/08

REVISED -  
 REVISED -  
 REVISED -  
 REVISED -



Allen Henderson & Associates, Inc.  
 Civil and Structural Engineers Springfield, IL  
 62708 Phone: (217)544-8033 IL Design Firm  
 No. 184-001907

DETAILS & TYPICAL ROADWAY SECTIONS

SCALE: VARIES SHEET NO. 5 OF 19 SHEETS STA. 636+55 TO STA. 642+85

F.A.S. RTE.	SECTION	COUNTY	TOTAL SHEETS	SHEET NO.
1613	23B	SANGAMON	19	5
CONTRACT NO. 72B44				
FED. ROAD DIST. NO. ILLINOIS FED. AID PROJECT				

**PAVEMENT MARKING SCHEDULE**

LOCATION	LENGTH (FT.)	PAVEMENT MK. REMOVAL		SHORT TERM PVMT. MARKING		PAINT PVMT. MK. LINE - 5"	
		WHITE (SQ. FT.)	YELLOW (SQ. FT.)	WHITE (FOOT)	YELLOW (FOOT)	WHITE (FOOT)	YELLOW (FOOT)
STA. 636+55 TO STA. 642+85	630				*252		
STA. 636+55 TO STA. 639+50 LT.	295	123				295	
STA. 639+50 TO STA. 639+90 LT.	40					40	
STA. 639+90 TO STA. 642+85 LT.	295	123				295	
STA. 636+55 TO STA. 639+50 C (SOLID)	295		123				295
STA. 636+55 TO STA. 639+50 C (SKIP DASH)	295		3.5				75
STA. 639+50 TO STA. 639+90 C (SOLID)	40						40
STA. 639+50 TO STA. 639+90 C (SKIP DASH)	40		3.5				10
STA. 639+90 TO STA. 642+85 C (SOLID)	295		123				295
STA. 639+90 TO STA. 642+85 C (SKIP DASH)	295						75
STA. 636+55 TO STA. 639+50 RT.	295	123				295	
STA. 639+50 TO STA. 639+90 RT.	40					40	
STA. 639+50 TO STA. 642+85 RT.	295	123				295	
	SUBTOTAL	492	253		252	1260	790
	TOTAL	745		252		2050	

NOTE: SHORT-TERM PAVEMENT MARKING QUANTITIES ARE FOR TWO APPLICATIONS.  
 • 10% OF TOTAL LENGTH FOR SHORT-TERM PAVEMENT MARKING

**HOT MIX ASPHALT SCHEDULE**

LOCATION	HOT MIX ASPHALT BASE COURSE, 10" (SQ. YD.)	HMA SURFACE COURSE, MIXTURE C, N50 (TON)	LEVELING BINDER (MACHINE METHOD) N50 (TON)	BITUMINOUS MATERIALS (PRIME COAT) (TON)	AGGREGATE PRIME COAT (TON)	HMA SHOULDERS 8" (SQ. YD.)	HMA SURFACE REMOVAL, BUTT JOINT (SQ. YD.)	PAVED SHOULDER REMOVAL (SQ. YD.)
STA. 636+55 TO STA. 642+85		163		1.0	5.3	397		210
STA. 636+55 TO STA. 636+65							25	
STA. 636+75 TO STA. 639+50			72					
STA. 639+50 TO STA. 639+90	98							
STA. 639+90 TO STA. 641+05			31					
STA. 641+55 TO STA. 642+85							318	
	TOTAL	98	163	103	5.3	397	343	210

**EARTHWORK SCHEDULE**

LOCATION	EARTH EXCAVATION	EARTH EXCAVATION ADJUSTED FOR SHRINKAGE	EMBANKMENT	EARTHWORK BALANCE WASTE (+) OR SHORTAGE (-)
	CUBIC YARD	CUBIC YARD	CUBIC YARD	CUBIC YARD
STA. 636+55 TO STA. 639+50	270	203	310	-107
STA. 639+90 TO STA. 642+85	460	345	308	37
	TOTAL	730	548	618

**SCHEDULE PAVEMENT REMOVAL**

LOCATION	QUANTITY (SQ. YD.)
STA. 639+50 TO STA. 639+90	98
	TOTAL
	98

**SCHEDULE PIPE CULVERTS, TYPE 1, CS/A CULVERT PIPE 15"**

LOCATION	QUANTITY (FOOT)
STA. 636+64 TO STA. 637+18 LT.	54
STA. 638+81 TO STA. 639+41 RT.	60
STA. 640+09 TO STA. 640+69 RT.	60
	TOTAL
	174

**SCHEDULE PIPE CULVERT REMOVAL**

LOCATION	QUANTITY (FOOT)
STA. 636+90 LT.	28
STA. 639+11 RT.	24
STA. 639+90 LT.	28
STA. 640+39 RT.	30
	TOTAL
	110

**SCHEDULE GUARDRAIL REMOVAL**

LOCATION	QUANTITY (FOOT)
STA. 639+27 TO STA. 640+16 LT. & RT.	178
	TOTAL
	178

**SCHEDULE RAISED REFLECTIVE PAVEMENT MARKER REMOVAL**

LOCATION	RAISED REF. MKR. REMOVAL (EACH)
STA. 636+55 TO STA. 642+85	8
	TOTAL
	8

**SCHEDULE AGGREGATE SHOULDERS, TYPE B**

LOCATION	QUANTITY (TON)
STA. 636+55 TO STA. 642+85 LT. & RT.	153
P.E. STA. 636+90 LT.	8
F.E. STA. 639+11 RT.	26
F.E. STA. 640+39 RT.	26
	TOTAL
	213

**SCHEDULE FURNISHING & ERECTING RIGHT OF WAY MARKERS**

LOCATION	QUANTITY (EACH)
STA. 636+55 27' RT.	1
STA. 637+00 27' LT.	1
STA. 637+00 40' LT.	1
STA. 638+75 60' RT.	1
STA. 639+00 40' LT.	1
STA. 639+00 50' LT.	1
STA. 640+50 50' LT.	1
STA. 640+50 40' LT.	1
STA. 641+25 60' RT.	1
STA. 642+50 40' LT.	1
STA. 642+85 27' LT.	1
STA. 642+85 27' RT.	1
	TOTAL
	12

PLAN	SURVEYED	DATE
	PLOTTED	BY
	CHECKED	
	NOTED	
	FILE NAME	
	NO.	

PROFILE	SURVEYED	DATE
	PLOTTED	BY
	CHECKED	
	NOTED	
	FILE NAME	
	NO.	

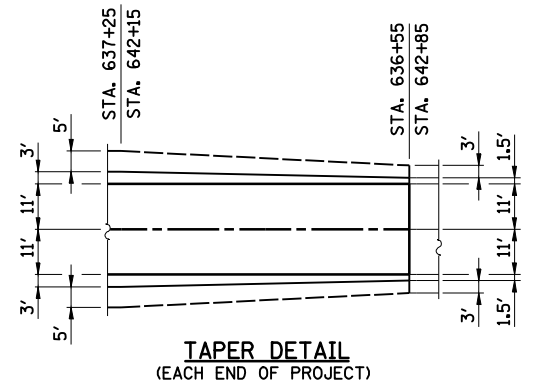
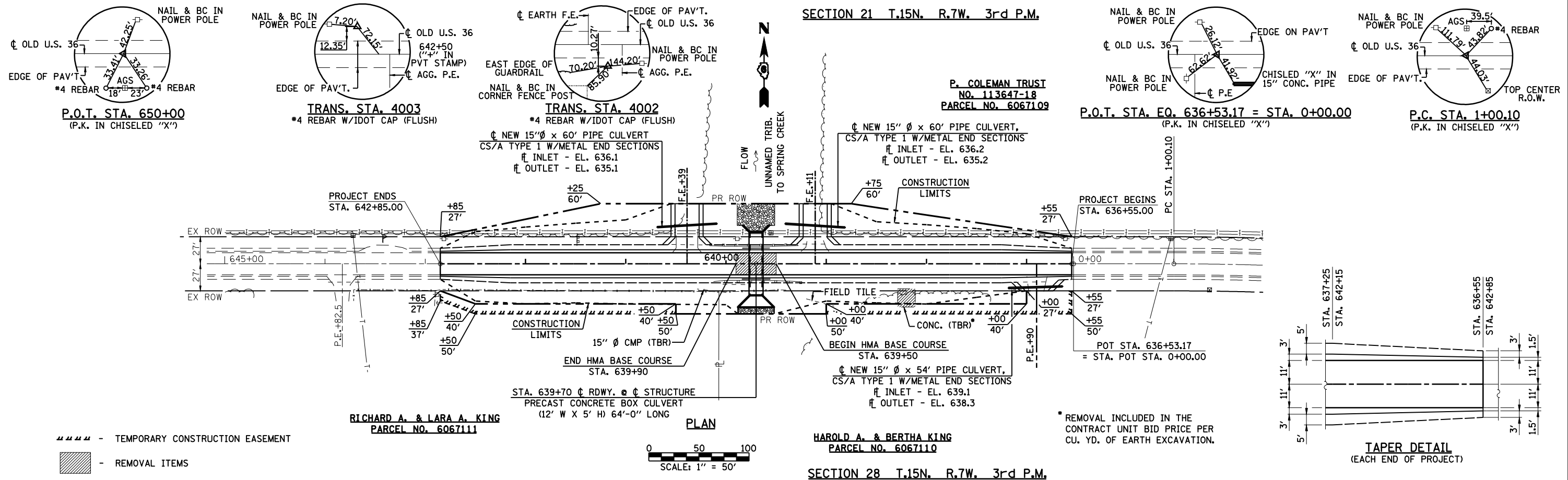

\* REMOVAL INCLUDED IN THE CONTRACT UNIT BID PRICE PER CU. YD. OF EARTH EXCAVATION.

- TEMPORARY CONSTRUCTION EASEMENT
- ▨ REMOVAL ITEMS

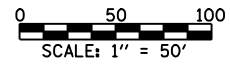

SECTION 28 T.15N. R.7W. 3rd P.M.

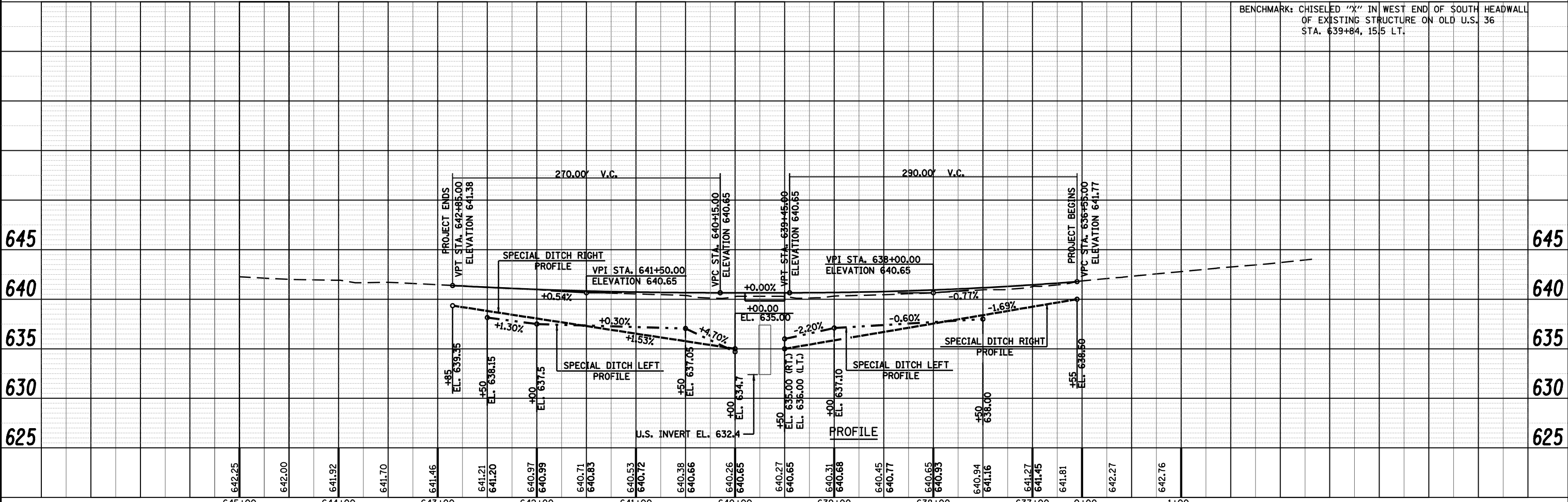

BENCHMARK: CHISELED "X" IN WEST END OF SOUTH HEADWALL OF EXISTING STRUCTURE ON OLD U.S. 36 STA. 639+84, 15' LT.



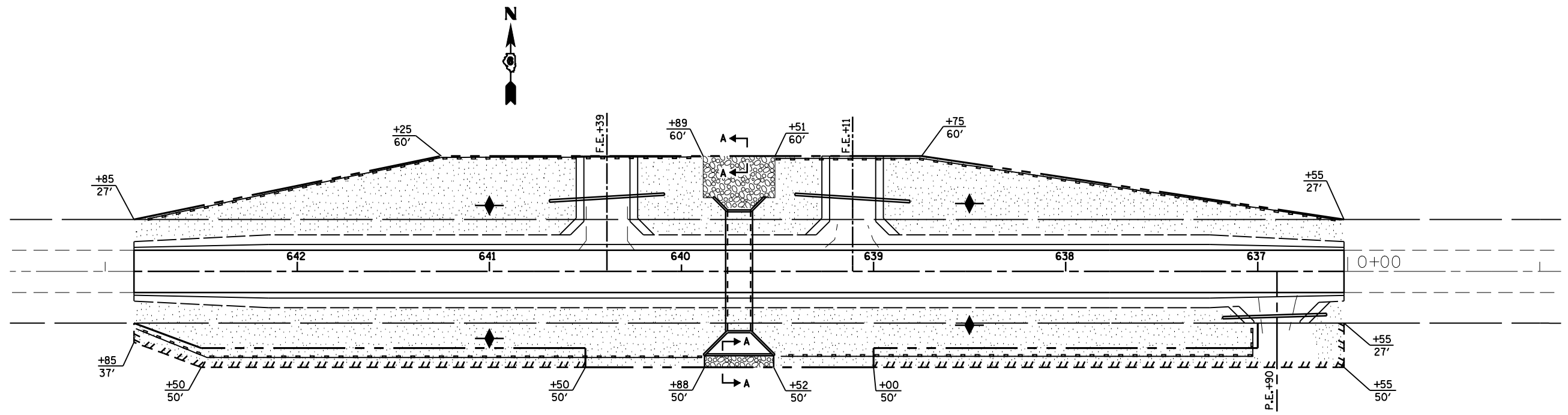

FILE NAME = d672b44-shr-planprofile.dgn	USER NAME =	DESIGNED - RKA	REVISED -	<p><b>Allen Henderson &amp; Associates, Inc.</b> Civil and Structural Engineers Springfield, IL. 62708 Phone: (217)544-8083 IL Design Firm No. 184-001907</p>	<b>PLAN &amp; PROFILE</b>		F.A.S. RTE. 1613	SECTION 23B	COUNTY SANGAMON	TOTAL SHEETS 19	SHEET NO. 7
PLOT SCALE =	DRAWN - CPK	REVISED -	SCALE: 1"=50'		SHEET NO. 7 OF 19 SHEETS		STA. 636+55 TO STA. 642+85		CONTRACT NO. 72B44		
PLOT DATE = May-09-2008 02:28:34PM	CHECKED - 3/25/08	REVISED -			FED. ROAD DIST. NO. ILLINOIS FED. AID PROJECT						

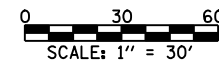

EROSION CONTROL PLAN

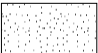

LEGEND

-  AGGREGATE (EROSION CONTROL)
-  PERIMETER EROSION BARRIER
-  SEEDING, CLASS 2
-  STONE RIPRAP, CLASS A3

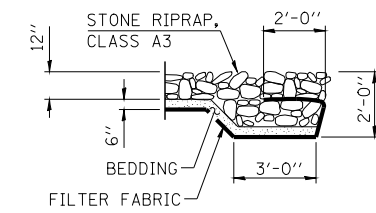

SECTION A-A

SCHEDULE  
PERMANENT SEEDING

LOCATION	SEEDING CLASS 2 (ACRE)	NITROGEN FERT. NUT. (POUND)	PHOSPHORUS FERT. NUT. (POUND)	POTASSIUM FERT. NUT. (POUND)	MULCH METHOD 2 (ACRE)	AGRICULTURAL GROUND LIMESTONE (TON)
STA. 636+55 TO STA. 642+85	0.9	81	81	81	0.9	1.8
TOTAL	0.9	81	81	81	0.9	1.8

SCHEDULE  
EROSION CONTROL ITEMS

LOCATION	AGGREGATE (EROSION CONTROL) (TON)	TEMP. EROSION CONTROL SEEDING (POUND)	PERIMETER EROSION BARRIER (FOOT)
STA. 636+55 TO STA. 642+85		90	1197
STA. 638+50 LT. & RT.	10		
STA. 641+00 LT. & RT.	10		
TOTAL	20	90	1197

FILE NAME = d672b44-sht-eros.dgn

USER NAME =

DESIGNED - RKA

REVISED -

DRAWN - RKA

REVISED -

PLOT SCALE =

CHECKED - CPK

REVISED -

PLOT DATE = May-09-2008 02:18:58PM

DATE - 04/10/08

REVISED -



**Allen Henderson & Associates, Inc.**  
Civil and Structural Engineers Springfield, IL  
62708 Phone: (217)544-8033 IL Design Firm  
No. 184-001907

EROSION CONTROL PLAN

SCALE: 1"=30'

SHEET NO. 8 OF 19 SHEETS

STA. 636+55 TO STA. 642+85

F.A.S. RTE.	SECTION	COUNTY	TOTAL SHEETS	SHEET NO.
1613	23B	SANGAMON	19	8
CONTRACT NO. 72B44				
FED. ROAD DIST. NO. ILLINOIS FED. AID PROJECT				



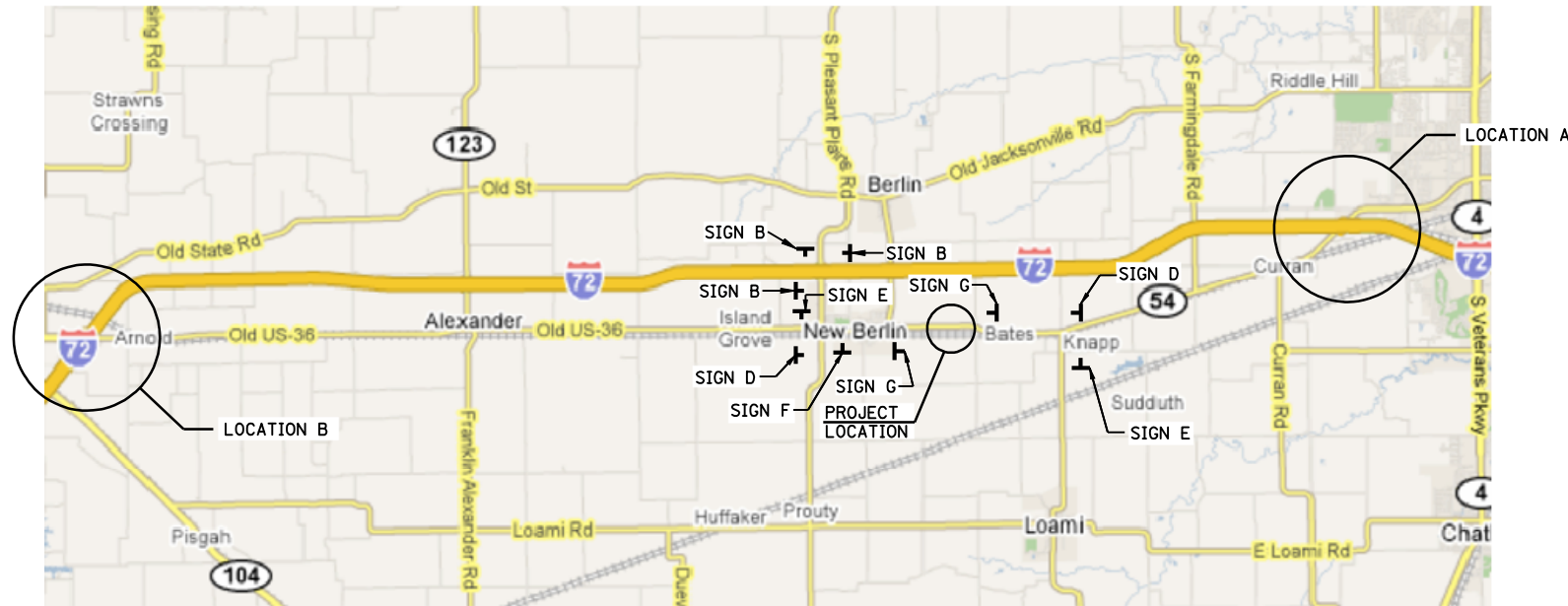

**ROAD CLOSED SIGNING LOCATIONS**



**LOCATION A - SPRINGFIELD**



**LOCATION B - JACKSONVILLE**

**SUGGESTED CONSTRUCTION SEQUENCE**

**WORK DONE UNDER ROAD CLOSURE**

- 1.) THE CONTRACTOR SHALL PLACE ROAD CLOSED SIGNS IN ACCORDANCE WITH THIS SHEET AND STANDARD BLR 21-7.
- 2.) REMOVE EXISTING PAVEMENT AND PAVED SHOULDERS FROM STA. 639+50 TO STA. 639+90.
- 3.) REMOVE EXISTING STRUCTURE STA. 639+70, GUARDRAIL AND EXISTING PAVED SHOULDERS FROM STA. 636+55 TO STA. 642+85 LT. & RT.
- 4.) INSTALL PRECAST CONCRETE BOX CULVERT AND GRANULAR CULVERT BACKFILL STA. 639+70.
- 5.) INSTALL HMA BASE COURSE, 10" STA. 639+50 TO STA. 639+90.
- 6.) INSTALL HMA LEVELING BINDER FROM STA. 636+75 TO STA. 639+50 AND STA. 639+90 TO STA. 641+05.
- 7.) INSTALL HMA SHOULDERS, 8" STA. 636+55 TO STA. 642+85 LT. & RT.
- 8.) THE CONTRACTOR SHALL OPEN THE ROAD TO TRAFFIC AND COMPLETE REMAINING WORK UNDER FLAGGERS.

**WORK DONE UNDER FLAGGERS**

- 1.) CONSTRUCT CAST IN PLACE CONCRETE END SECTIONS STA. 639+70.
- 2.) REMOVE PIPE CULVERTS STA. 636+90 LT., STA. 639+11 RT., STA. 639+90 LT. AND STA. 640+39 RT.
- 3.) INSTALL NEW PIPE CULVERTS AND METAL END SECTIONS STA. 636+90 LT, STA. 639+11 RT. AND STA. 640+39 RT.
- 4.) SHAPE AND GRADE EARTH FOR SHOULDERS, DITCHES AND ENTRANCES STA. 636+55 TO STA. 642+85.
- 5.) CONSTRUCT AGGREGATE SHOULDERS STA. 636+55 TO STA. 642+85 LT. & RT. AND AGGREGATE ENTRANCES STA. 636+90 LT., STA. 639+11 RT. AND STA. 640+39 RT.
- 6.) PLACE HMA SURFACE COURSE STA. 636+55 TO STA. 642+85.
- 7.) FINAL STRIPING, SEEDING AND MISCELLANEOUS CLEANUP.

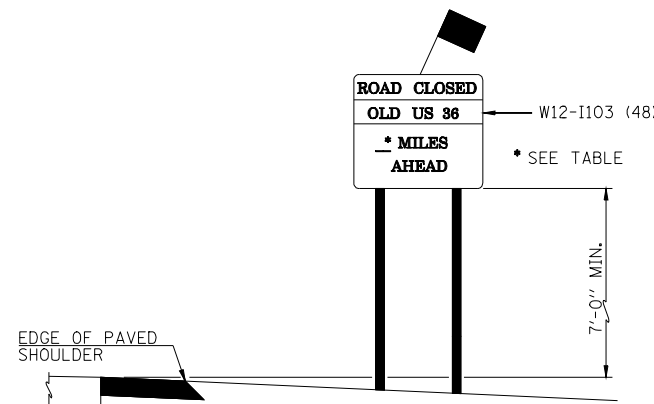

**SIGN A, B, C & D**

NOTE: AT ALL LOCATIONS FOR SIGN A, B & C, TWO SIGNS WILL BE PLACED, ONE ON EACH SIDE OF THE INTERSTATE.

SIGN	MILES AHEAD
A	7
B	4
C	15
D	2

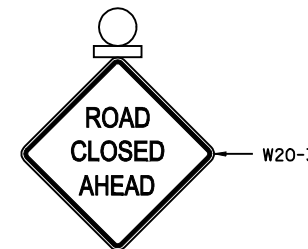

**SIGN D**  
WITH FLASHING LIGHT

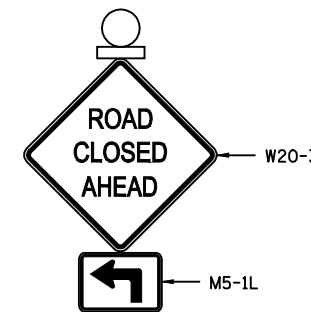

**SIGN E**  
WITH FLASHING LIGHT

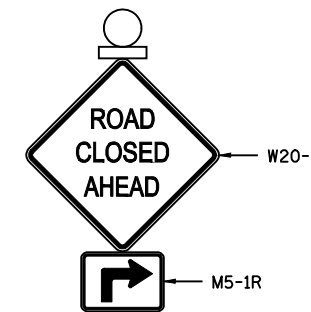

**SIGN F**  
WITH FLASHING LIGHT

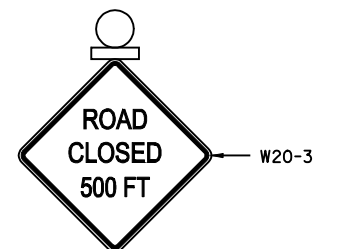

**SIGN G**  
WITH FLASHING LIGHT

FILE NAME = d672b44-sh1-sign.dgn

USER NAME =  
PLOT SCALE =  
PLOT DATE = May-09-2008 02:19:01PM

DESIGNED - RKA  
DRAWN - RKA  
CHECKED - CPK  
DATE - 3/25/08

REVISED -  
REVISED -  
REVISED -  
REVISED -



**Allen Henderson & Associates, Inc.**  
Civil and Structural Engineers Springfield, IL.  
62708 Phone: (217)544-8033 IL Design Firm  
No. 184-001907

**CONSTRUCTION SEQUENCE & ROAD CLOSED SIGNING**

SCALE: NONE SHEET NO. 9 OF 19 SHEETS STA. 636+55 TO STA. 642+85

F.A.S. RTE.	SECTION	COUNTY	TOTAL SHEETS	SHEET NO.
1613	23B	SANGAMON	19	9
CONTRACT NO. 72B44				
FED. ROAD DIST. NO. ILLINOIS FED. AID PROJECT				

STATE OF ILLINOIS  
DEPARTMENT OF TRANSPORTATION

- INDEX OF SHEETS**
- 1.) General Plan & Elevation
  - 2.) Culvert Details (South End Section)
  - 3.) Culvert Details (North End Section)
  - 4.) Boring Sheet

ROUTE NO.	SECTION	COUNTY	TOTAL SHEETS	SHEET NO.
F.A.S. 1613	23B	SANGAMON	19	10
SHEET NO. 1 4 SHEETS				

**TOTAL BILL OF MATERIAL**

Item	Unit	Quantity
Precast Concrete Box Culverts 12' x 5' (M273)	Foot	58
Concrete Box Culverts	Cu. Yd.	35.0
Reinforcement Bars	Pound	3890
Granular Culvert Backfill	Cu. Yd.	189
Rockfill Foundation	Ton	43
Stone Riprap, Class A3	Tons	52
Filter Fabric	Sq. Yd.	103
Removal of Existing Structures	L. Sum	1

**WATERWAY INFORMATION**

Drainage Area = 1.55 Sq. Mi.	Ex. Low Grade Elev. 640.25 ft. @ Sta. 640+00						
	Pr. Low Grade Elev. 640.38 ft. @ Sta. 640+00						
Flood	Freq. Yr.	Q C.F.S.	Opening Exist.	Sq. Ft. Prop.	Natural H.W.E.	Head - ft. Exist.	Headwater El. Prop.
Design	10	193	43	51	636.63	0.42	637.05
Base	100	406	56	60.0	637.38	0.94	638.32
Overtopping					637.69	1.26	638.95
Max. Calc.	500	655	60/81	60/37	638.39	2.20	640.59

Benchmark: Chisled "X" in west end of south headwall of existing structure on old U.S. 36. Sta. 639+84, 15.5' L.T. El. 638.83  
Existing Structure: Built in 1920 as Section 23 of Station 640+60 of S.B.I. Route 10 Structure is a single barrel RC box culvert, 32' out to out headwalls. The existing structure is to be removed.  
Proposed Structure: Single 12'x5' precast box culvert with cast in place end sections.  
No salvage.

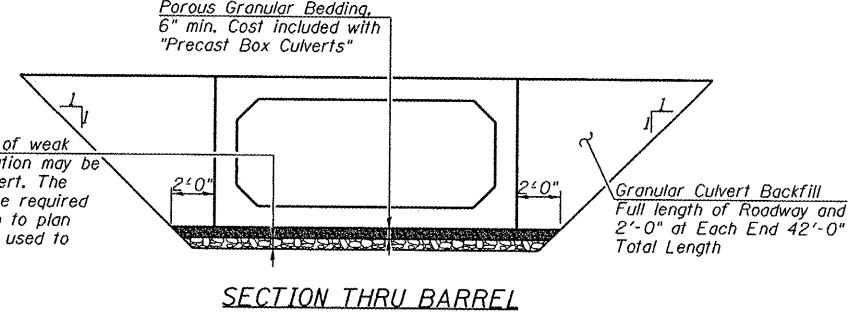
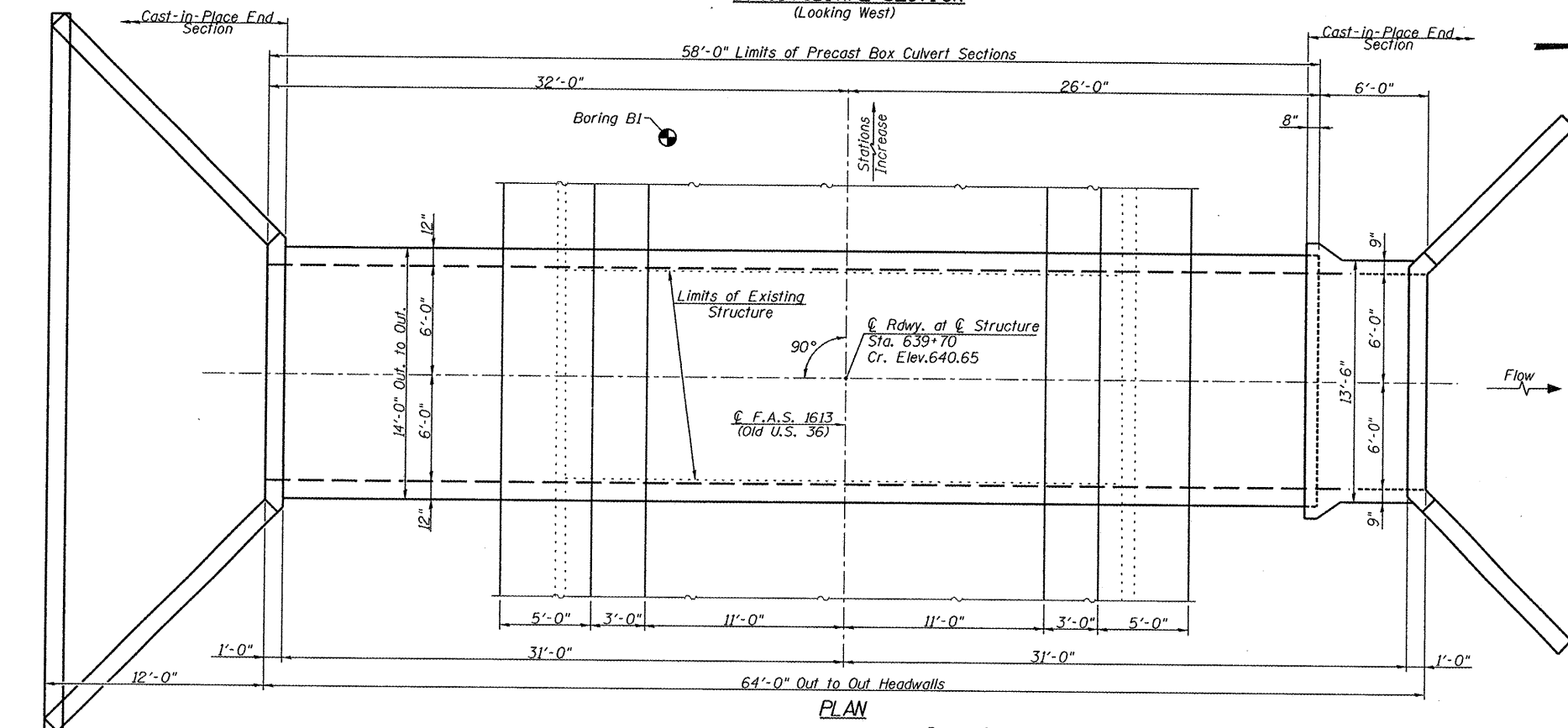
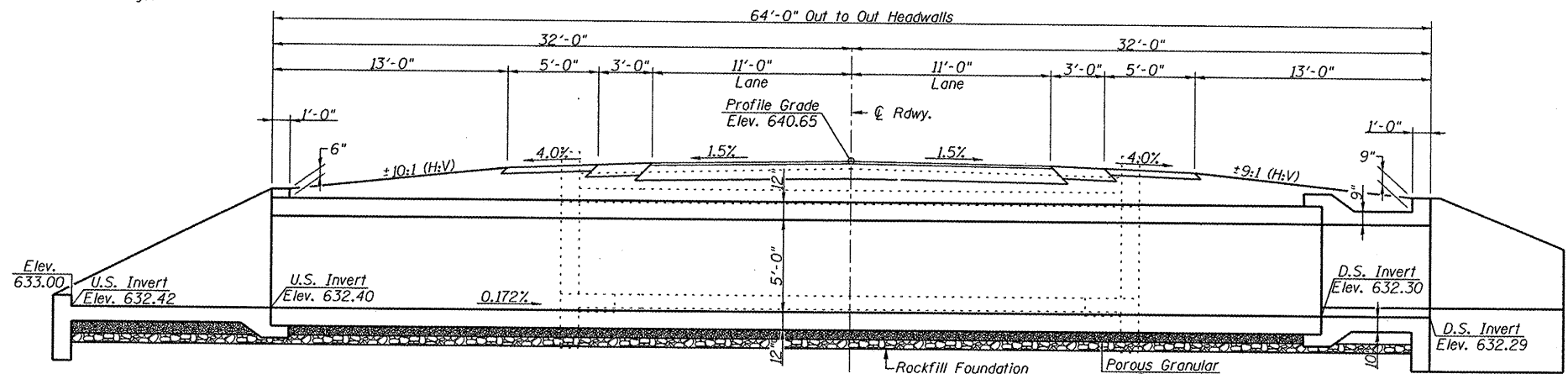

DESIGNED - GBR
CHECKED - MAH
DRAWN - MJS
CHECKED - GBR

Note: See roadway plans for riprap layout and details

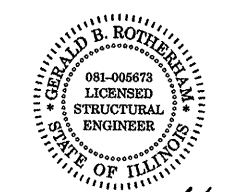

*Gerald B. Rothermel* 5/8/08  
EXPIRATION: 11/30/2008

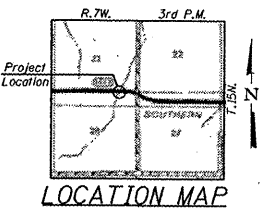

**GENERAL NOTES**

Reinforcement bars shall conform to the requirements of A.S.T.M. A 706, Grade 60 (IL Modified). See Special Provisions.

For backfilling and embankment, see Special Provisions.

Concrete required for the construction of the end sections is included in the quantity for Concrete Box Culverts.

Layout of the riprap may be varied in the field to suit ground conditions as directed by the Engineer.

Lifting holes shall be filled with concrete plugs and mastic after box sections are in place.

Precast concrete box culvert sections shall conform to the requirements of Article 540.06 of the Standard Specifications and the applicable requirements of A.A.S.H.T.O. M 273.

Precast End Sections will not be allowed. Cast in place concrete exposed edges shall be beveled 3/4".

Outside end of precast sections at the ends of the culvert shall not have a bell or spigot.

**LOADING HS 20-44**  
Allow 50#/sq.ft. for future wearing surface

**DESIGN SPECIFICATIONS**  
2002 A.A.S.H.T.O.

**DESIGN STRESSES**

**FIELD UNITS**  
f'c = 3,500 psi  
fy = 60,000 psi (reinforcement)

**PRECAST UNITS**  
f'c = 5,000 psi  
fy = 65,000 psi (welded wire fabric)

**GENERAL PLAN & ELEVATION**  
**OLD U.S. 136 OVER UNNAMED**  
**TRIBUTARY OF SPRING CREEK**  
**F.A.S. ROUTE 1613 - SECTION 23B**  
**SANGAMON COUNTY**  
**STA. 639+70.00**  
**S.N. 084-7132**

ROUTE NO.	SECTION	COUNTY	TOTAL SHEETS	SHEET NO.	SHEET NO. 2
F.A.S. 1613	23B	SANGAMON	19	11	4 SHEETS
FED. ROAD DIST. NO. 7	ILLINOIS	FED. AID PROJECT-			

Contract # 72B44

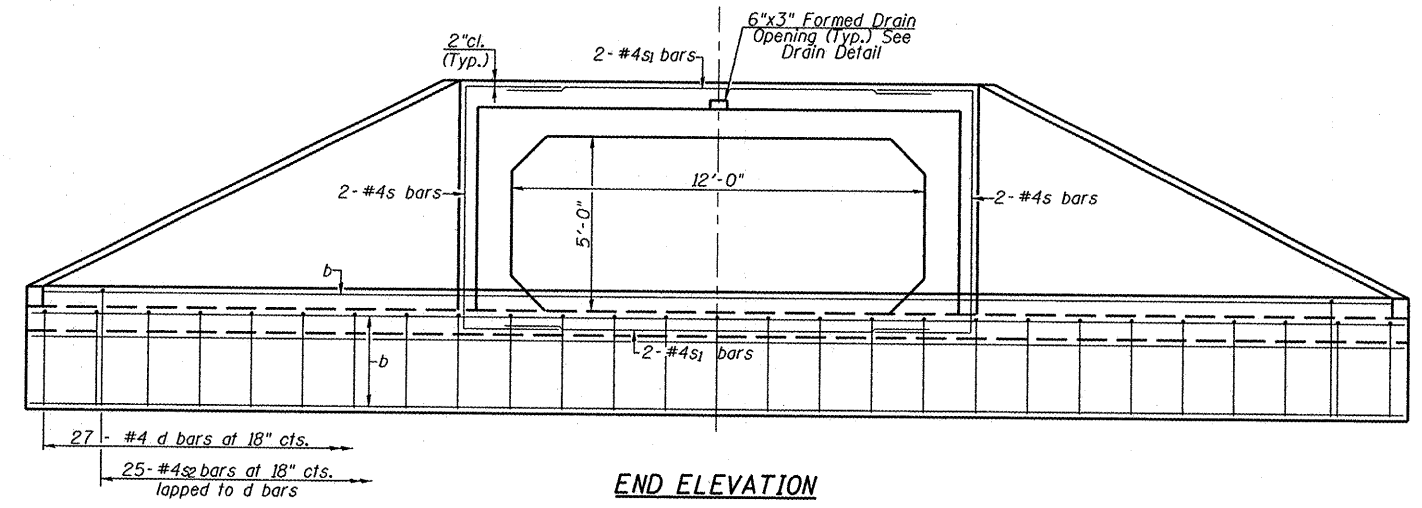

**END ELEVATION**

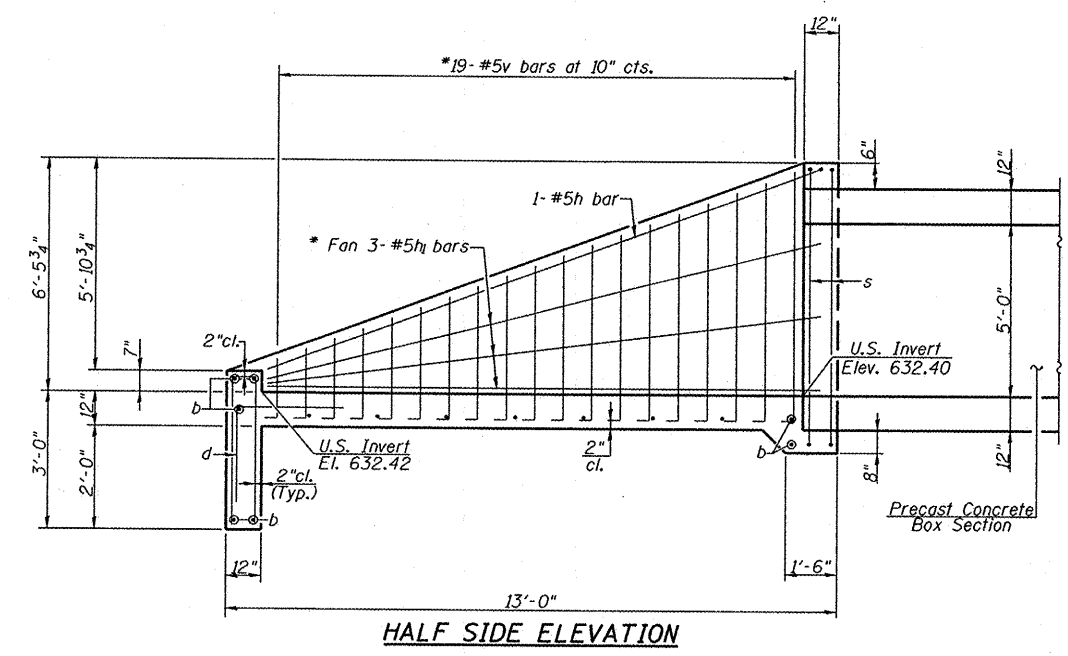

**HALF SIDE ELEVATION**

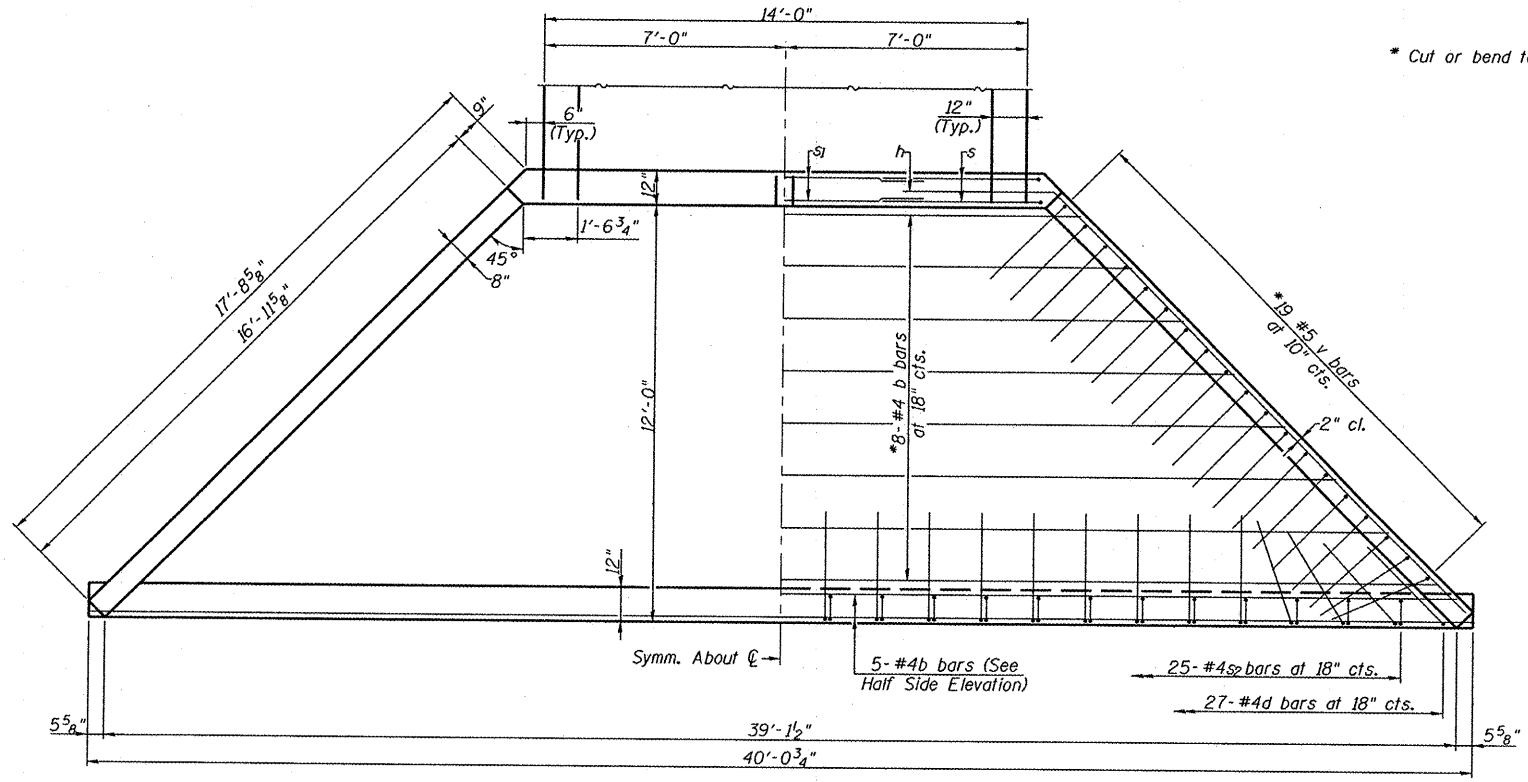

**END PLAN**

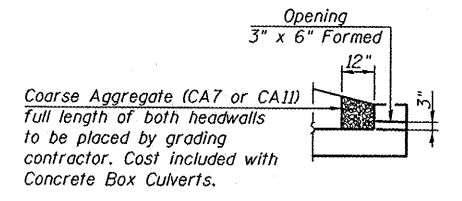

**DRAIN DETAIL**

**BILL OF MATERIAL**

Bar	No.	Size	Length	Shape
b	13	#4	39'-8"	—
d	27	#4	5'-4"	┌
h	2	#5	23'-0"	┌
h1	6	#5	18'-0"	—
s	4	#4	17'-10"	┌
s1	4	#4	9'-0"	—
s2	25	#4	7'-2"	┌
v	19	#5	15'-0"	┌
Concrete Box Culverts			Cu. Yd.	21.5
Reinforcement Bars			Pound	1090

**Min. Bar Lap**  
#4 = 1'-8"

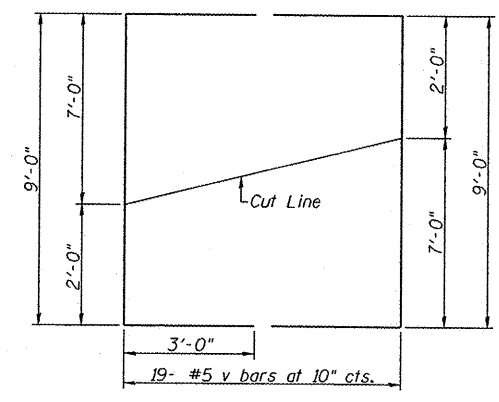
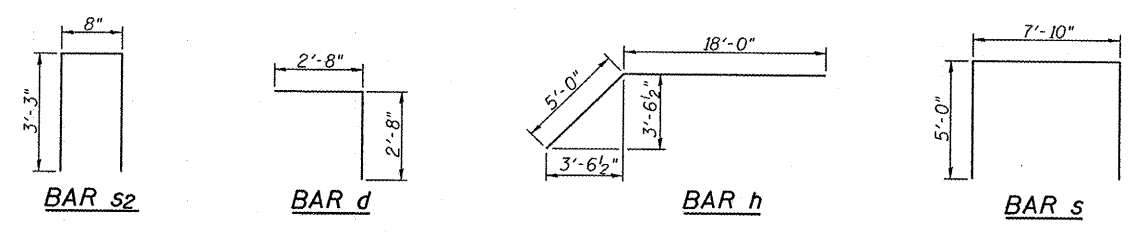

**BAR v CUT DIAGRAM**

Note: Order bars full length. Lay out in field as shown. Cut along cut line. Use remainder of v in opposite wing wall.

**CULVERT DETAILS**  
(SOUTH END SECTION)  
OLD U.S. 136 OVER UNNAMED  
TRIBUTARY OF SPRING CREEK  
F.A.S. ROUTE 1613 - SECTION 23B  
SANGAMON COUNTY  
STA. 639+70.00  
S.N. 084-7132

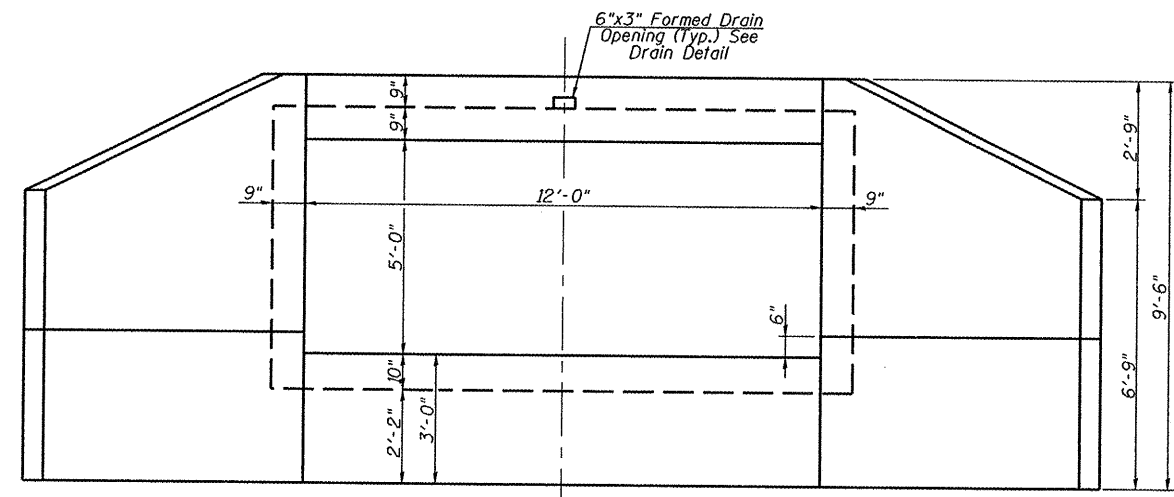

END ELEVATION

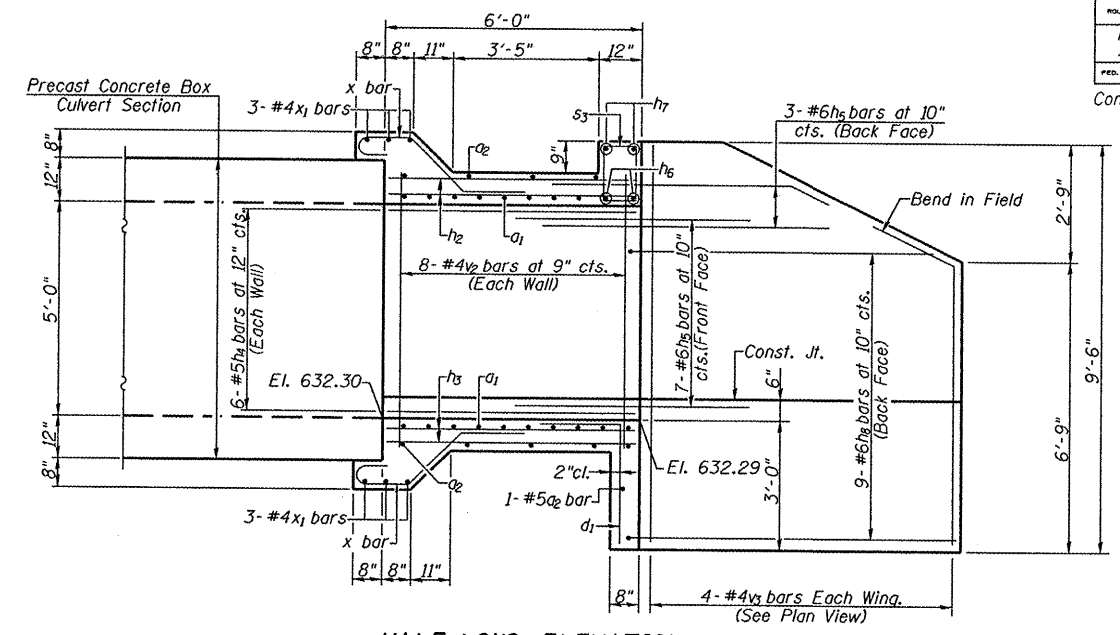

HALF LONG. ELEVATION

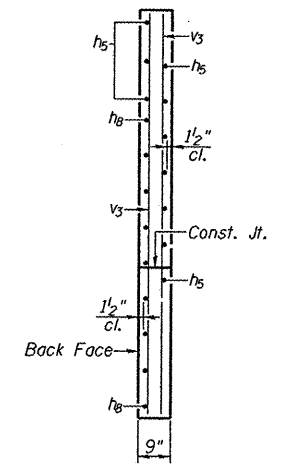

SECTION A-A

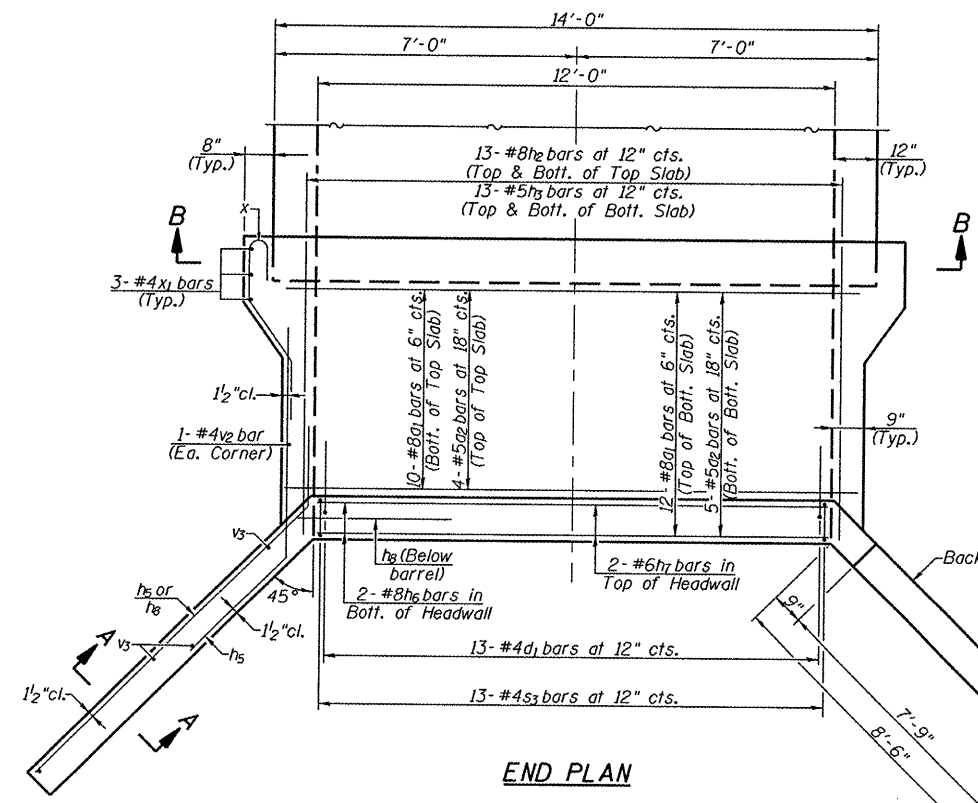

END PLAN

MIN. BAR LAP  
1'-8"

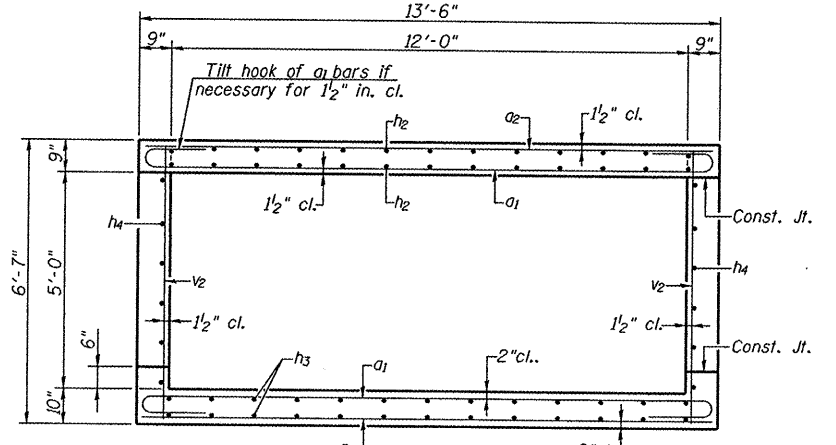

SECTION THRU CAST-IN-PLACE BARREL

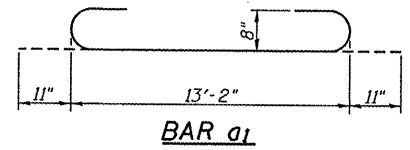

BAR a1

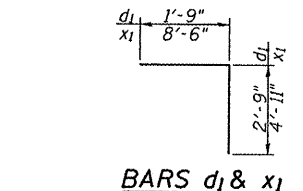

BARS d1 & x1

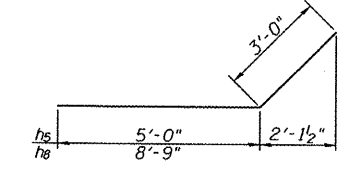

BARS h5 & h6

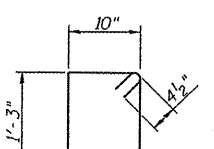

BAR s3

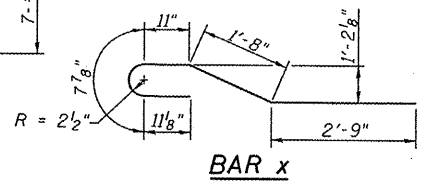

BAR x

BILL OF MATERIAL

Bar	No.	Size	Length	Shape
a1	22	#8	15'-0"	U
a2	10	#5	13'-2"	—
d1	13	#5	4'-6"	L
h2	26	#8	5'-8"	—
h3	26	#5	5'-8"	—
h4	12	#5	5'-8"	—
h5	20	#6	8'-0"	—
h6	2	#8	13'-2"	—
h7	2	#6	11'-9"	—
h8	18	#6	11'-9"	—
s3	13	#4	4'-11"	U
v2	18	#4	6'-3"	—
v3	8	#4	9'-2"	—
x	35	#4	6'-11"	—
x1	12	#4	13'-5"	L
Concrete Box Culverts			Cu. Yd.	13.5
Reinforcement Bars			Pound	2800

CULVERT DETAILS  
(NORTH END SECTION)  
OLD U.S. 136 OVER UNNAMED  
TRIBUTARY OF SPRING CREEK  
F.A.S. ROUTE 1613 - SECTION 23B  
SANGAMON COUNTY  
STA. 639+70.00  
S.N. 084-7132

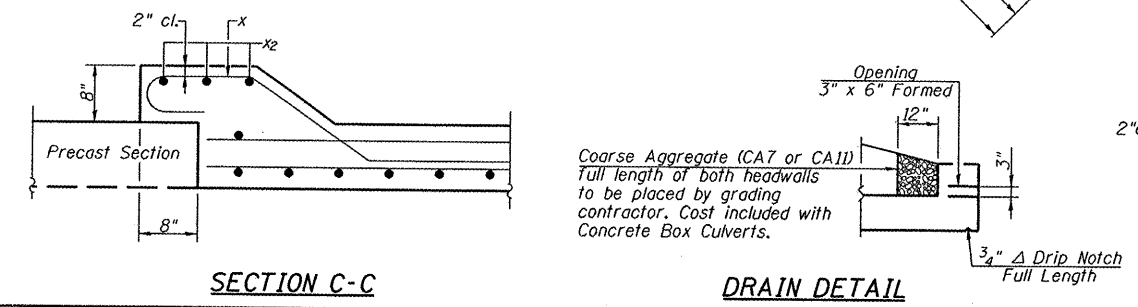

SECTION C-C

DRAIN DETAIL

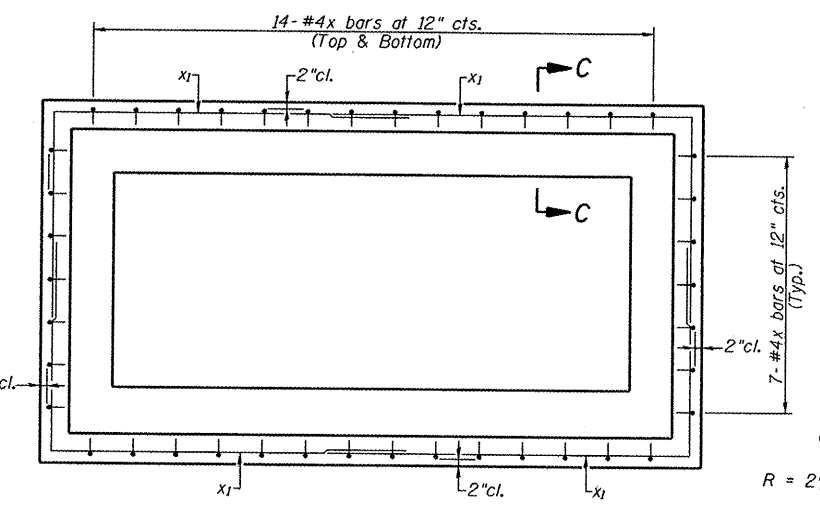

SECTION B-B



Illinois Department  
of Transportation  
Division of Highways  
District 6

### SOIL BORING LOG

Page 1 of 1

Date 9/26/07

ROUTE FAS 1613 DESCRIPTION Old US 36 over a tributary to Little Spring Creek,  
(Old US 36) 1.2 Miles East of New Berlin LOGGED BY M. Tappan  
SECTION 23B LOCATION SE 1/4, SEC. 21, TWP. 15 N, RNG. 7 W, 3 PM  
COUNTY Sangamon DRILLING METHOD HSA HAMMER TYPE 140# Auto

STRUCT. NO. 084-7052 Ex D E L C M  
Station 639+70 +/- P O S I  
BORING NO. 1 H S Qu T  
Station 639+90 H S Qu T  
Offset 10.0ft Lt  
Ground Surface Elev. 637.6 ft (ft) /6" (1st) (%)

Surface Water Elev. 631.6 ft D E L C M  
Stream Bed Elev. 631.6 ft P O S I  
Groundwater Elev.:  
First Encounter No Encounter ft H S Qu T  
Upon Completion Dry ft  
After Hrs. \_\_\_\_\_ ft (ft) /6" (1st) (%)

Black Moist SILTY CLAY (Till)	0				CLAY LOAM (Till) (continued)				
	1	0.6	36		Olive Brown and Grey Dry CLAY	4			
	1	B			LOAM (Till)	16	+4.5	9	
					Broken Sample	29	P		
					Refer STA to STA 640+00				
	0				Stamped In Pavement, STA				
	5	0.5	35		Increase to West				
w/ Limestone Cobble	-5	B			Refer Elevation to BM#102,	-25			
					Chisled Square on SW Corner =				
					638.8'				
V. Dark Grey Moist SILTY CLAY	0								
	1	0.4	34						
	1	B							
	0								
Dark Grey	2	0.8	30						
	2	B							
	-10								
Olive Brown and Light Blue Grey	1								
Moist SILTY CLAY (Till)	1	0.6	28						
	2	B							
	0								
	1	0.6	27						
	1	B							
	-15								
CLAY LOAM (Till)	1								
	3	2.8	12						
Grey Moist CLAY LOAM (Till)	5	B							
	2								
Olive Brown and Grey	14	3.3	12						
	15	B							
	-20								

File Name: S:\SOILS\GINT FILES\SANGAMON\084-7052 OLD US 36 1.2 MILES EAST OF NEW BERLIN.DWG Date Plotted: 10/2/07  
Latitude: 39 Deg 43.581' N Longitude: 89 Deg 52.624' W Datum: NAD83 Job Number: 084-7052-13-07

The Unconfined Compressive Strength (UCS) Failure Mode is indicated by (B-Bulge, S-Shear, P-Penetrometer, E-Estimated)  
Abbreviations W.O.H - Sampler Advanced By Weight of Hammer, W.O.P - Advanced by Weight of Pipe, B.S. - Before Seating  
The SPT (N value) is the sum of the last two blow values in each sampling zone (AASHTO T206) BBS, from 137 (Rev. 8-99)

DESIGNED	-
CHECKED	-
DRAWN	-
CHECKED	-

ROUTE NO.	SECTION	COUNTY	SHEET	SHEET NO.
F.A.S. 1613	23B	SANGAMON	13	4
FED. ROAD DIST. NO. 7	ILLINOIS	FED. AID PROJECT		

Contract # 72B44

**BORINGS**  
**OLD U.S. 136 OVER UNNAMED**  
**TRIBUTARY OF SPRING CREEK**  
**F.A.S. ROUTE 1613 - SECTION 23B**  
**SANGAMON COUNTY**  
**STA. 639+70.00**  
**S.N. 084-7132**

DATE	
BY	
FINAL SURVEY	
SURVEYED	
PLOTTED	
TEMPLATE	
AREAS	
CHECKED	
NO.	

DATE	
BY	
ORIGINAL SURVEY	
SURVEYED	
PLOTTED	
TEMPLATE	
AREAS	
CHECKED	
NO.	

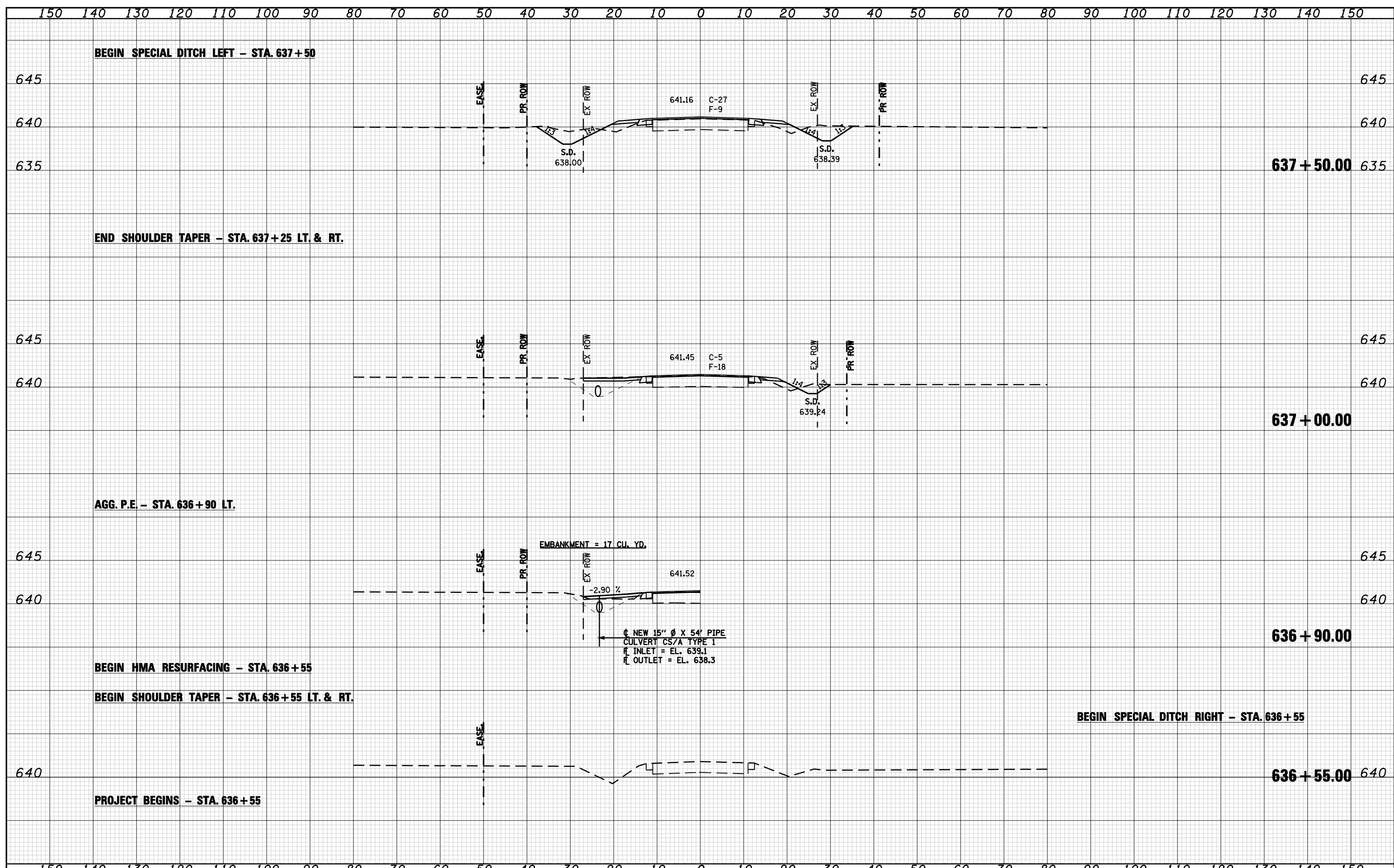

FILE NAME = d672b44-sht-xssht.dgn

USER NAME =	DESIGNED - RKA	REVISIONS
	DRAWN - RKA	REVISIONS
PLOT SCALE =	CHECKED - CPK	REVISIONS
PLOT DATE = May-09-2008 02:19:21PM	DATE - 3/25/08	REVISIONS

DESIGNED - RKA	REVISIONS
DRAWN - RKA	REVISIONS
CHECKED - CPK	REVISIONS
DATE - 3/25/08	REVISIONS

**Allen Henderson & Associates, Inc.**  
 Civil and Structural Engineers Springfield, IL.  
 62708 Phone: (217)544-8033 IL. Design Firm  
 No. 184-001907

SCALE: VARIES		SHEET NO. 14 OF 19 SHEETS		STA. 636+55.00 TO STA. 637+50.00	
---------------	--	---------------------------	--	----------------------------------	--

F.A.S. RTE.	SECTION	COUNTY	TOTAL SHEETS	SHEET NO.
1613	23B	SANGAMON	19	14
CONTRACT NO. 72B44				
FED. ROAD DIST. NO. ILLINOIS FED. AID PROJECT				

150 140 130 120 110 100 90 80 70 60 50 40 30 20 10 0 10 20 30 40 50 60 70 80 90 100 110 120 130 140 150

DATE	
BY	
SURVEYED	
PLOTTED	
TEMPLATE	
AREAS	
CHECKED	
FINAL SURVEY	
NOTE BOOK	
NO.	

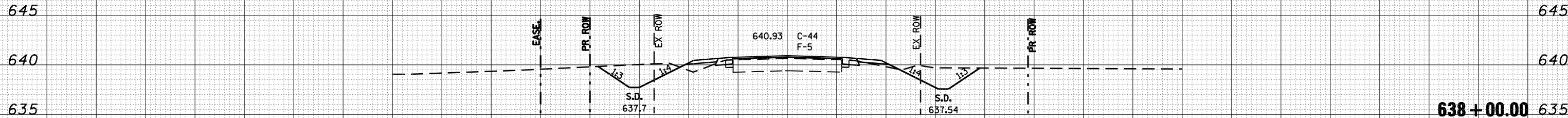
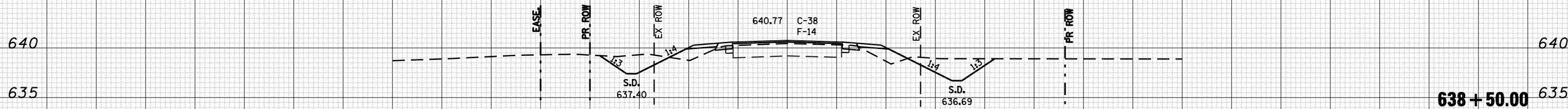
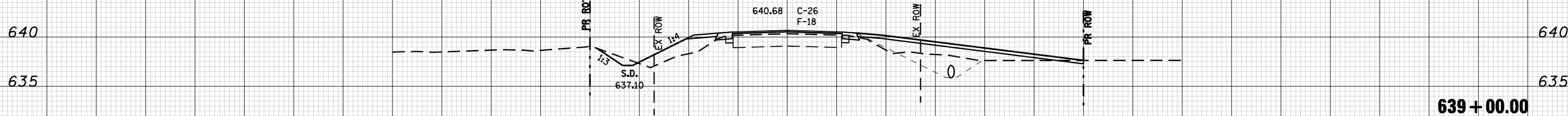

DATE	
BY	
SURVEYED	
PLOTTED	
TEMPLATE	
AREAS	
CHECKED	
ORIGINAL SURVEY	
NOTE BOOK	
NO.	

150 140 130 120 110 100 90 80 70 60 50 40 30 20 10 0 10 20 30 40 50 60 70 80 90 100 110 120 130 140 150

FILE NAME = d672b44-sht-xssht.dgn

USER NAME =  
 DESIGNED - RKA  
 DRAWN - RKA  
 CHECKED - CPK  
 DATE - 3/25/08

REVISIED -  
 REVISIED -  
 REVISIED -  
 REVISIED -



**Allen Henderson & Associates, Inc.**  
 Civil and Structural Engineers Springfield, IL  
 62708 Phone: (217)544-8033 IL Design Firm  
 No. 184-001907

**CROSS SECTIONS**

SCALE: VARIES SHEET NO. 15 OF 19 SHEETS STA. 638+00.00 TO STA. 639+00.00

F.A.S. RTE.	SECTION	COUNTY	TOTAL SHEETS	SHEET NO.
1613	23B	SANGAMON	19	15
CONTRACT NO. 72B44				
FED. ROAD DIST. NO. ILLINOIS FED. AID PROJECT				

DATE	
BY	
SURVEYED	
PLOTTED	
TEMPLATE	
AREAS	
CHECKED	
FINAL SURVEY	
NOTE BOOK	
NO.	

DATE	
BY	
SURVEYED	
PLOTTED	
TEMPLATE	
AREAS	
CHECKED	
ORIGINAL SURVEY	
NOTE BOOK	
NO.	

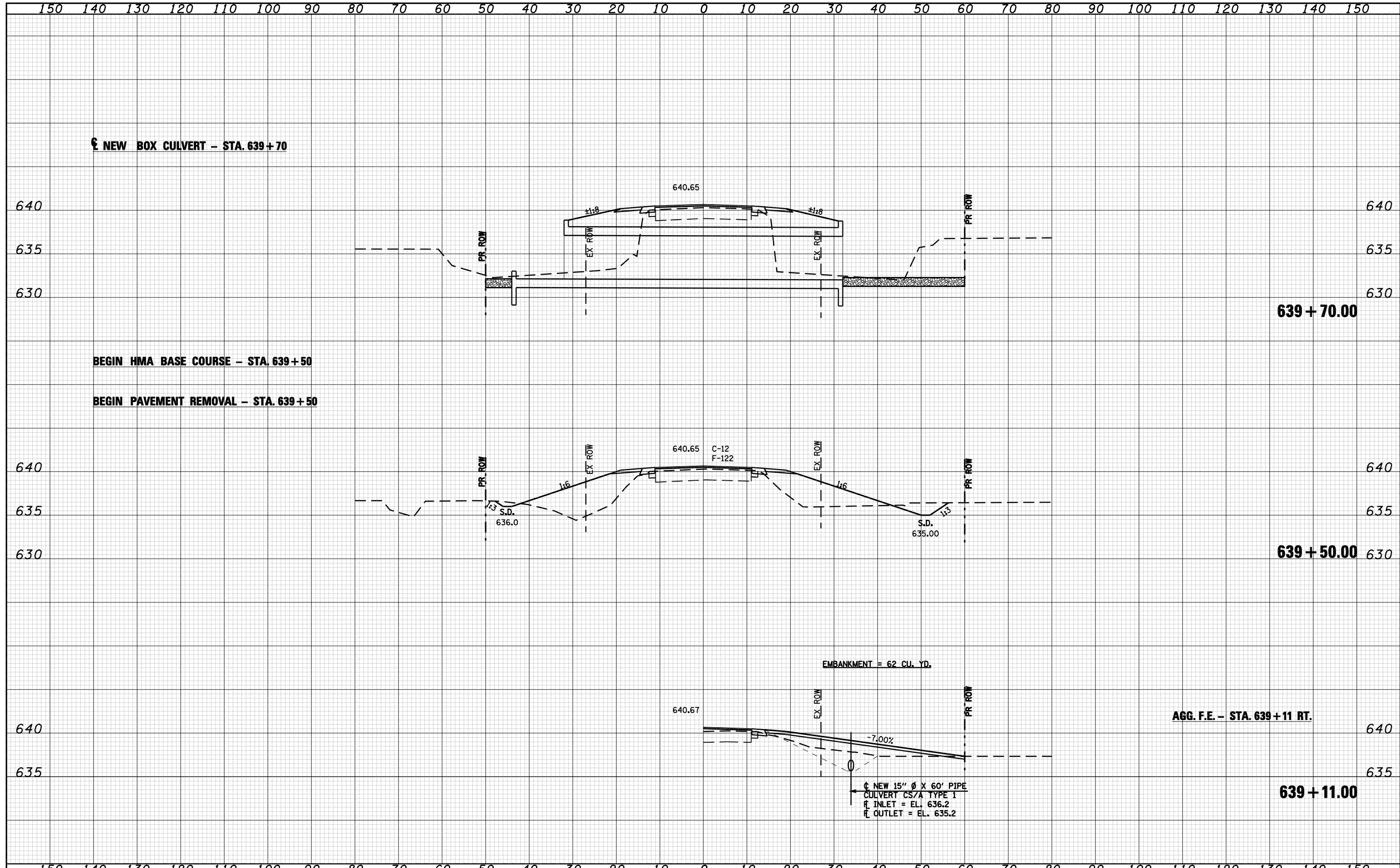

FILE NAME =	USER NAME =	DESIGNED - RKA	REVISED -	<b>Allen Henderson &amp; Associates, Inc.</b> Civil and Structural Engineers Springfield, IL. 62708 Phone: (217)544-8033 IL Design Firm No. 184-001907	<b>CROSS SECTIONS</b>			F.A.S. RTE.	SECTION	COUNTY	TOTAL SHEETS	SHEET NO.
d672b44-sht-xssht.dgn		DRAWN - RKA	REVISED -					1613	23B	SANGAMON	19	16
PLOT SCALE =		CHECKED - CPK	REVISED -		SCALE: VARIES	SHEET NO. 16 OF 19 SHEETS	STA. 639+11.00	TO STA. 639+70.00	CONTRACT NO. 72B44			
PLOT DATE = May-09-2008 02:19:34PM		DATE - 3/25/08	REVISED -		FED. ROAD DIST. NO.			ILLINOIS FED. AID PROJECT				



DATE	
BY	
SURVEYED	
PLOTTED	
TEMPLATE	
AREAS	
CHECKED	
FINAL SURVEY	
NOTE BOOK	
NO.	

DATE	
BY	
SURVEYED	
PLOTTED	
TEMPLATE	
AREAS	
CHECKED	
ORIGINAL SURVEY	
NOTE BOOK	
NO.	

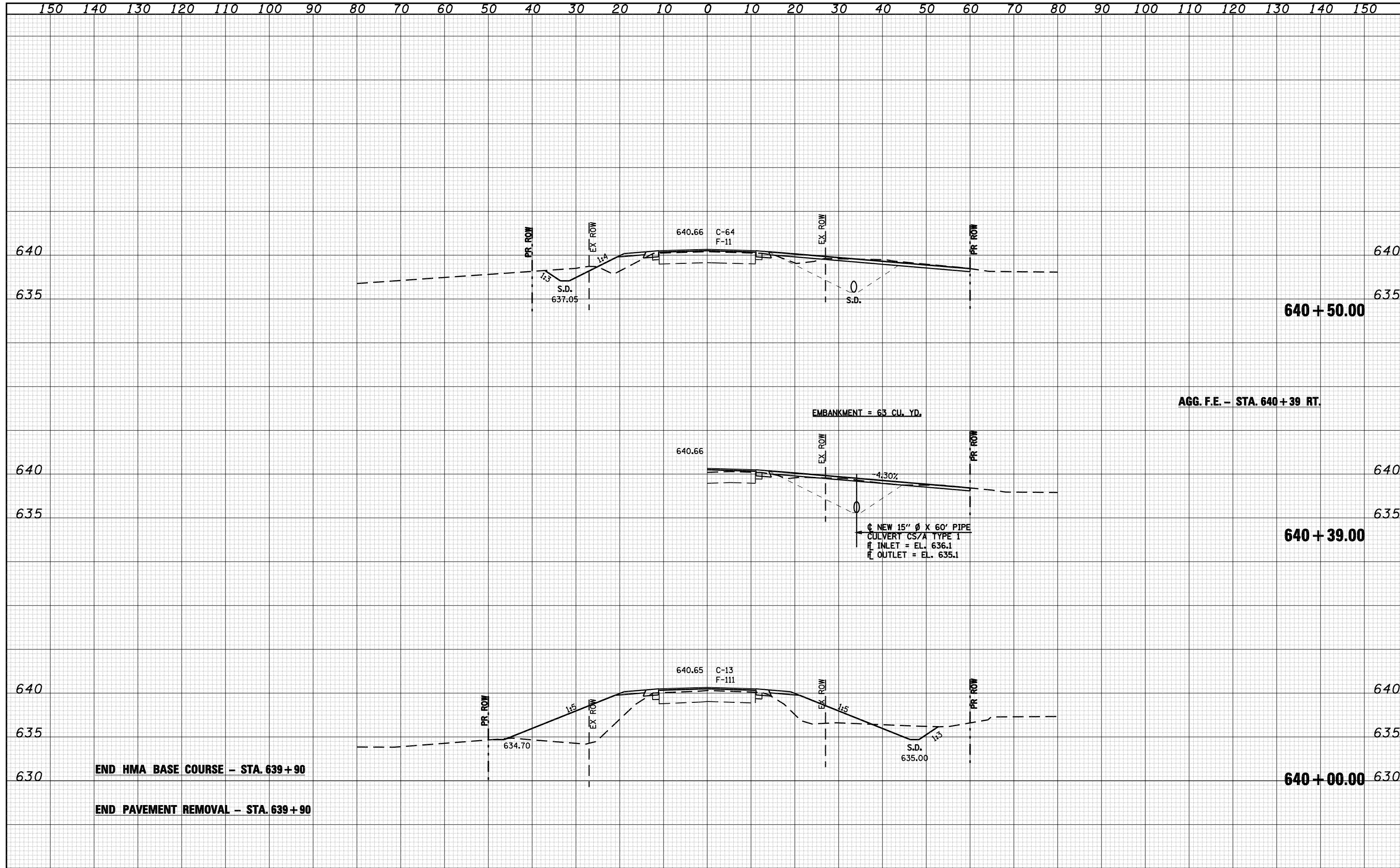

150 140 130 120 110 100 90 80 70 60 50 40 30 20 10 0 10 20 30 40 50 60 70 80 90 100 110 120 130 140 150

**BEGIN SHOULDER TAPER - STA. 642+15 LT. & RT.**

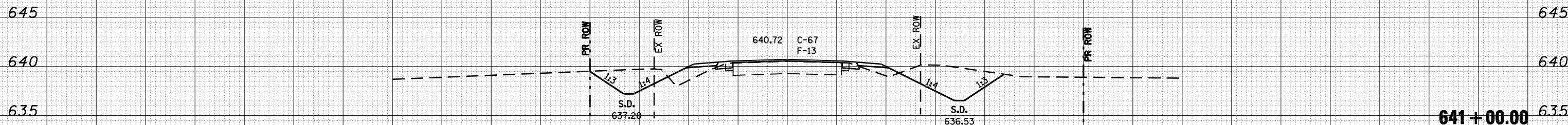
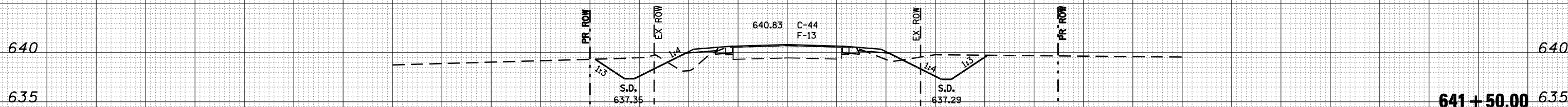
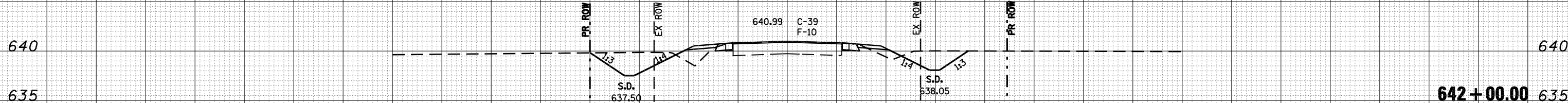

150 140 130 120 110 100 90 80 70 60 50 40 30 20 10 0 10 20 30 40 50 60 70 80 90 100 110 120 130 140 150

DATE	
BY	
SURVEYED	
PLOTTED	
TEMPLATE	
AREAS	
CHECKED	
FINAL SURVEY	
NOTE BOOK	
NO.	

DATE	
BY	
SURVEYED	
PLOTTED	
TEMPLATE	
AREAS	
CHECKED	
ORIGINAL SURVEY	
NOTE BOOK	
NO.	

FILE NAME = d672b44-sht-xssht.dgn

USER NAME =  
 PLOT SCALE =  
 PLOT DATE = May-09-2008 02:19:47PM

DESIGNED - RKA  
 DRAWN - RKA  
 CHECKED - CPK  
 DATE - 3/25/08

REVISED -  
 REVISED -  
 REVISED -  
 REVISED -



**Allen Henderson & Associates, Inc.**  
 Civil and Structural Engineers Springfield, IL  
 62708 Phone: (217)544-8033 IL Design Firm  
 No. 184-001907

**CROSS SECTIONS**  
 SCALE: VARIES SHEET NO. 18 OF 19 SHEETS STA. 641+00.00 TO STA. 642+00.00

F.A.S. RTE.	SECTION	COUNTY	TOTAL SHEETS	SHEET NO.
1613	23B	SANGAMON	19	18
CONTRACT NO. 72B44				
FED. ROAD DIST. NO. ILLINOIS FED. AID PROJECT				

150 140 130 120 110 100 90 80 70 60 50 40 30 20 10 0 10 20 30 40 50 60 70 80 90 100 110 120 130 140 150

FINAL SURVEY NO.	SURVEYED PLOTTED AREAS CHECKED	BY	DATE

ORIGINAL SURVEY NO.	SURVEYED PLOTTED AREAS CHECKED	BY	DATE

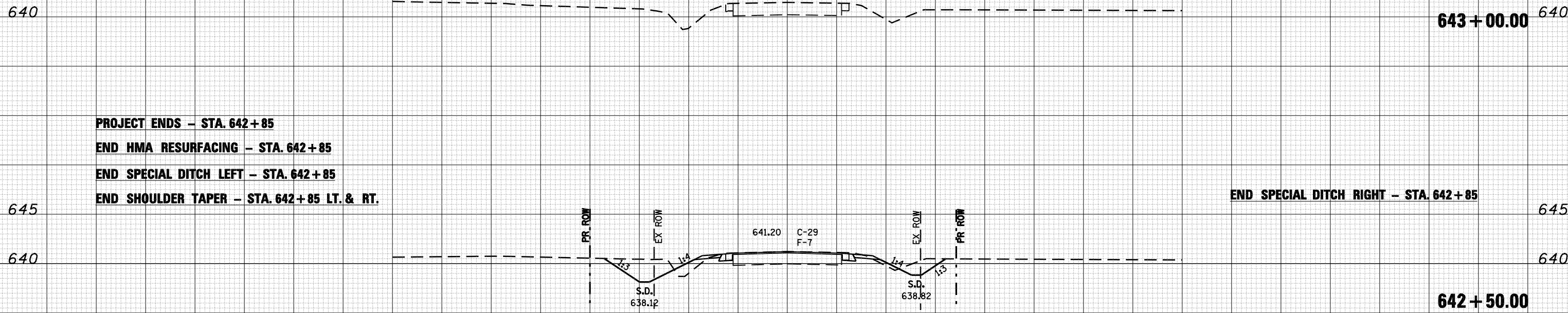

**PROJECT ENDS - STA. 642+85**  
**END HMA RESURFACING - STA. 642+85**  
**END SPECIAL DITCH LEFT - STA. 642+85**  
**END SHOULDER TAPER - STA. 642+85 LT. & RT.**

**END SPECIAL DITCH RIGHT - STA. 642+85**

FILE NAME = d672b44-sht-xssht.dgn

USER NAME =  
 DESIGNED - RKA  
 DRAWN - RKA  
 CHECKED - CPK  
 DATE - 3/25/08

REVISED -  
 REVISED -  
 REVISED -  
 REVISED -



**Allen Henderson & Associates, Inc.**  
 Civil and Structural Engineers Springfield, IL.  
 62708 Phone: (217)544-8033 IL Design Firm  
 No. 184-001907

**CROSS SECTIONS**

SCALE: VARIES SHEET NO. 19 OF 19 SHEETS STA. 642+50.00 TO STA. 643+00.00

F.A.S. RTE.	SECTION	COUNTY	TOTAL SHEETS	SHEET NO.
1613	23B	SANGAMON	19	19
CONTRACT NO. 72B44				
FED. ROAD DIST. NO. ILLINOIS FED. AID PROJECT				