

F.A.S. RTE.	SECTION	COUNTY	TOTAL SHEETS	SHEET NO.
1832	5BR-2	WASHINGTON	97	14
STA. 1444+00.00		TO STA. 1450+00.00		
FED. ROAD DIST. NO. ILLINOIS FED. AID PROJECT				

**PRE-STAGE I CONSTRUCTION:**

- PRE-STAGE I CONSTRUCTION SHALL CONSIST OF THE CONSTRUCTION OF THE 3' PAVEMENT WIDENING ON THE NORTHEAST AND NORTHWEST CORNERS OF THE STRUCTURE. TRAFFIC CONTROL SHALL BE IN ACCORDANCE WITH TRAFFIC CONTROL AND PROTECTION, STANDARD 701326.

**STAGE I CONSTRUCTION:**

- STAGE I CONSTRUCTION SHALL CONSIST OF STAGE I REMOVAL OF THE EXISTING STRUCTURE, AND STAGE I CONSTRUCTION OF THE REPLACEMENT STRUCTURE, PAVEMENT REMOVAL, PAVEMENT WIDENING ON THE LEFT, GRADING, RESURFACING THE EAST AND WEST SIDES OF THE STRUCTURE, GUARDRAIL, RIPRAP, ETC. STAGE I CONSTRUCTION SHALL BE DONE ACCORDING TO STAGE CONSTRUCTION AS DETAILED IN THE BRIDGE PLANS. TRAFFIC CONTROL SHALL BE IN ACCORDANCE WITH THE APPLICABLE PORTIONS OF STANDARD 701321 AND AS DETAILED IN THE STAGE CONSTRUCTION PLANS. THIS TRAFFIC CONTROL SHALL BE PAID FOR AS TRAFFIC CONTROL AND PROTECTION 701321 (SPECIAL).

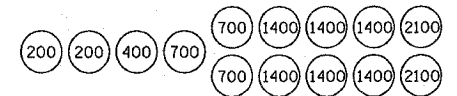

SAND MODULE IMPACT ATTENUATOR LAYOUT (IF OPTION USED)

**NOTES:**

- THE CONTRACTOR SHALL MAINTAIN ACCESS TO PRIVATE AND FIELD ENTRANCES LOCATED WITHIN THE LIMITS OF THE PROJECT.
- TRAFFIC CONTROL & PROTECTION, STANDARD 701321 (SPECIAL) INCLUDES BOTH STAGE I & II AND ANY ADDITIONAL SIGNING OR TRAFFIC CONTROL DEVICES SHOWN ON THE STAGE CONSTRUCTION PLANS.
- ALL ADDITIONAL TRAFFIC SIGNAL HEADS, LOOP DETECTORS AND ASSOCIATED EQUIPMENT REQUIRED TO MAINTAIN ACCESS AT THE FIELD AND DRIVEWAY ENTRANCES SHALL BE INCLUDED IN THE COST OF "TEMPORARY BRIDGE TRAFFIC SIGNALS"
- THE COST OF "BARRICADES, TYPE III" SHALL BE INCLUDED IN THE COST OF "TRAFFIC CONTROL AND PROTECTION, STANDARD 701321 (SPECIAL)".
- ALL SIDEROADS AND ENTRANCES WITHIN TRAFFIC CONTROL SHALL HAVE "NO RIGHT ON RED" AND "STOP HERE ON RED" SIGNS. THE COST SHALL BE INCLUDED IN THE COST OF "TRAFFIC CONTROL AND PROTECTION, STANDARD 701321 (SPECIAL)".

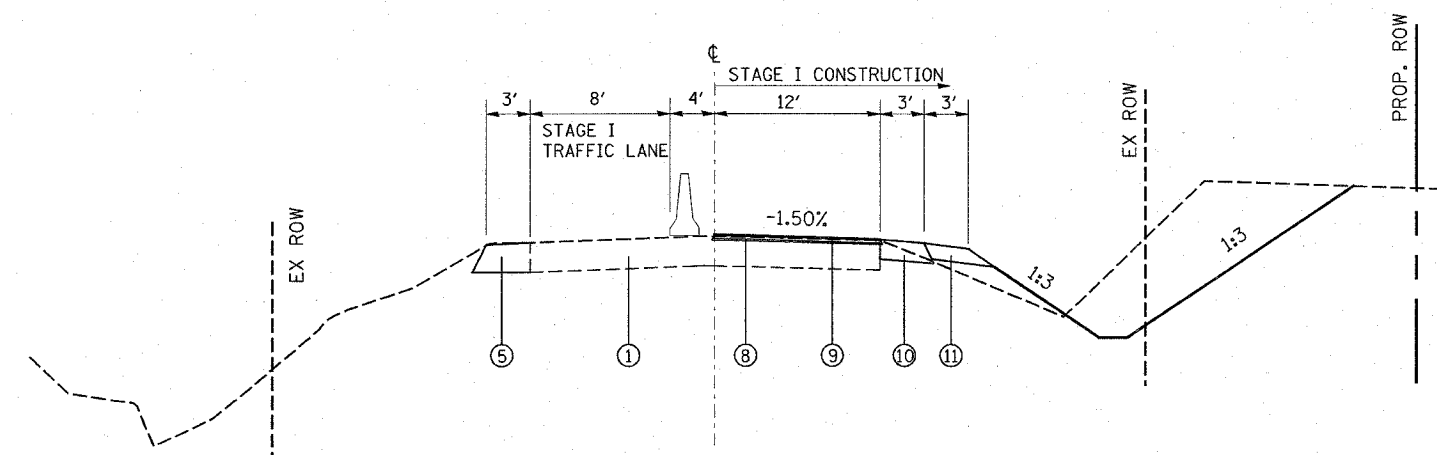
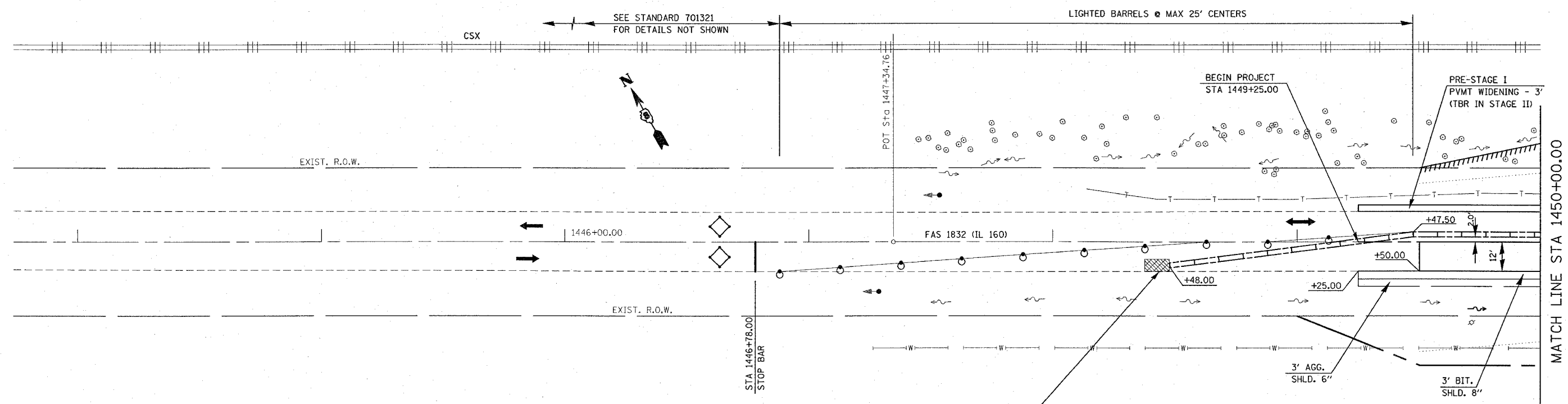

STAGE I TYPICAL SECTION  
STA. 1449+25.0 TO STA. 1450+50.0  
(NTS)

**LEGEND**

- ① EXISTING PAVEMENT
- ⑤ PROPOSED HOT-MIX ASPHALT BASE COURSE WIDENING 9"
- ⑧ PROPOSED HOT-MIX ASPHALT BINDER COURSE (VARIES 0.75" TO 15")
- ⑨ PROPOSED HOT-MIX ASPHALT SURFACE COURSE 1 1/2 "
- ⑩ PROPOSED HOT-MIX ASPHALT SHOULDERS, 8"
- ⑪ PROPOSED AGGREGATE SHOULDER 6"

**LEGEND:**

	STRUCTURE REMOVAL
	PAVEMENT REMOVAL
	TEMPORARY CONCRETE BARRIER
	IMPACT ATTENUATOR
	INDUCTION LOOP DETECTOR
	DRUM WITH STEADY BURNING LIGHT
	SIGNALIZED TWO-WAY TRAFFIC LANE
	TEMPORARY BRIDGE TRAFFIC SIGNAL
	TYPE III BARRICADE

IMPACT ATTENUATORS, TEMPORARY  
(NON-REDIRECTIVE), TEST LEVEL 3 - 1 EACH

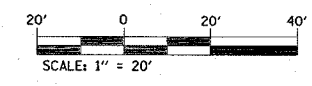

REVISIONS	
NAME	DATE

ILLINOIS DEPARTMENT OF TRANSPORTATION  
**SUGGESTED STAGE I CONSTRUCTION**  
**S.N. 095-0077**  
FAS ROUTE 1832  
SECTION 5BR-2  
WASHINGTON COUNTY

SCALE: VERT. \_\_\_\_\_  
HORIZ. \_\_\_\_\_  
DATE \_\_\_\_\_

DRAWN BY \_\_\_\_\_  
CHECKED BY \_\_\_\_\_

SN 095-0077

PLOT DATE = 12/7/2007  
FILE NAME = c:\projects\ad81106\plan\stage1\1832a.dgn  
PLOT SCALE = 20.00000 / 1 IN.  
USER NAME = gellin