

F.A.S. RTE.	SECTION	COUNTY	TOTAL SHEETS	SHEET NO.
1832	5BR-2	WASHINGTON	97	44
STA. _____ TO STA. _____				
FED. ROAD DIST. NO. _____ ILLINOIS FED. AID PROJECT				

BM: Chiseled 'D' on top of Northwest abutment wingwall  
 16'-4" - 36" - 1452+96 - Elev. 364.60  
 Existing Structure: Span P.C. thru Gully @ 231'0" B.C. to B.C.  
 Built in 1921 as SBI #115, Sec. 5-B @ Sta. 1452+15.  
 Existing deck to be removed by bridge contractor.

STATE OF ILLINOIS  
 DEPARTMENT OF PUBLIC WORKS & BUILDINGS  
 DIVISION OF HIGHWAYS

PROJECT NO.	SECTION	SHEET NO.	SHEETS
1832	5BR-2	2	7

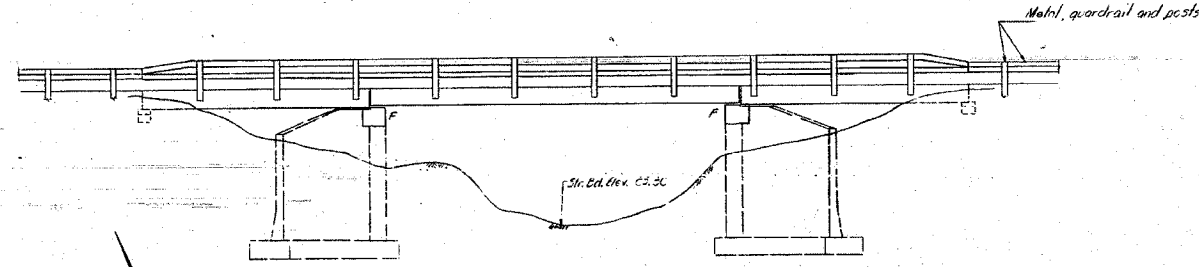

**TOTAL BILL OF MATERIAL**

Item	Unit	Sum	Sub	Total
Portland Cement Concrete (117) Cu Yds	Cu Yds	27		27
Pavement Fabric	Sq Yds	27		27
Concrete Removal	Cu Yds		9	9
Expansion Bolts (2")	Each	40	32	72
Class X Concrete	Cu Yds	1.6	13.2	14.8
Precast Prestressed Conc. Deck Slab (117) Sq Ft	Sq Ft	1003		1003
Precast Concrete Bridge Slab	Sq Ft	259		259
Steel Railing, Type N	Lin Ft	130		130
Reinforcement Bars	Lbs		1750	1750
Post Tensioning Strand (70 k.s.f.)	Sq Yds	2		2
Removal of Existing Superstructure	Each		1	1
Coal Tar Interlayer, Protective Coat	Sq Yds	120		120
Bit. Concrete Surf. Co. @ Class I	Ton	37		37

**GENERAL NOTES**

All reinforcement bars shall be lapped 24 diameter unless otherwise shown.

It shall be the responsibility of the contractor to verify all dimensions and conditions existing in the field prior to construction and ordering materials.

An alternate strand pattern using Extra High Strength Prestressing Strand (70 k.s.f.) is permitted. Expansion bolts shall consist of self-drilling expansion anchors and 3/8" hooked bolts. Hooked bolts shall set a minimum of 12" into new concrete unless otherwise shown.

Shoulder transition to wingwall shall be shaped with broken concrete. Cost incidental.

Limits of Coal Tar Interlayer Protective Coat shall be back to back of abutments.

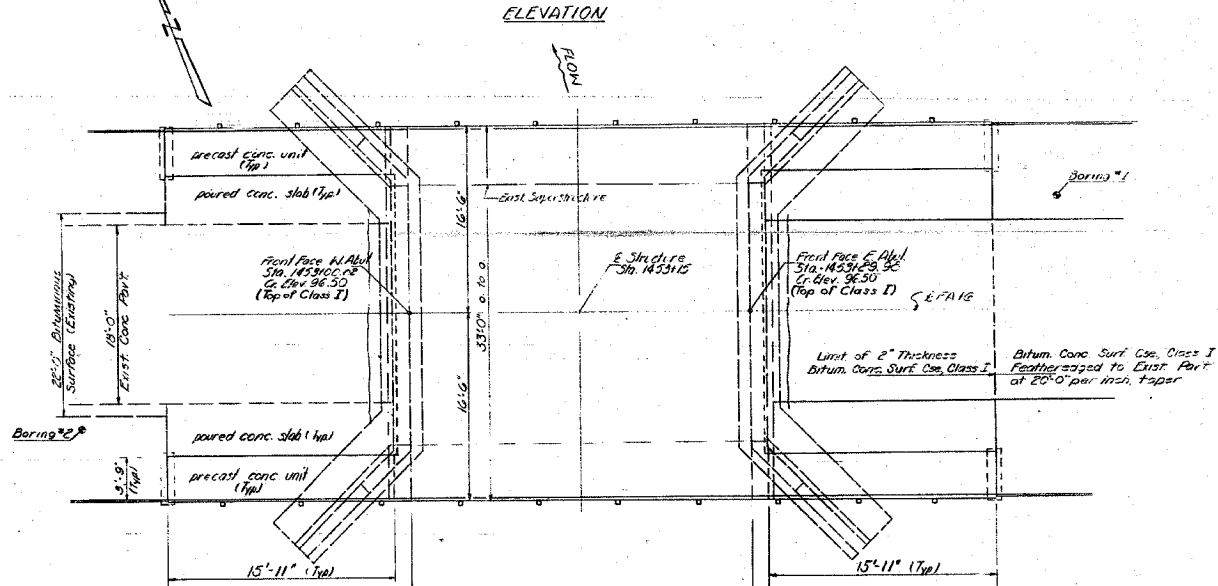

DESIGNED	H.Y. Lee	EXAMINED	JANUARY 26 1971
CHECKED	GM	PASSED	NO. 100000000
DRAWN	GM	APPROVED	Richard H. Hesterman
CHECKED	GM		

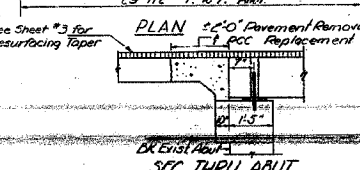

PRECAST PRESTRESSED UNITS

$f_c = 5,000$  psi  
 $f_{ci} = 4,000$  psi  
 $f_s = 248,000$  psi (25 strands)  
 $f_{st} = 173,800$  psi (25 strands)

PRECAST UNITS

$R = 4,500$  psi  
 $R_c = 1,800$  psi  
 $R_s = 1,800$  psi  
 $n = 6$

FIELD UNITS

$R = 1,000$  No. 11 Wgs  
 $k = 75$  Feching  
 $I_s = 80,000$  psi Bent  
 $n = 10$

Allow 25% for future W.S.  
 Loading 4.3 20-44

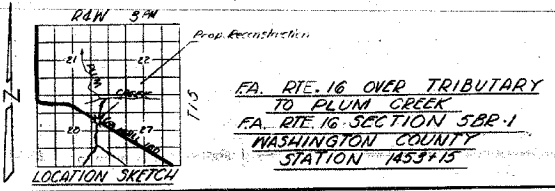

FOR INFORMATION ONLY

S.N. 095-0077

REVISIONS	NAME	DATE

ILLINOIS DEPARTMENT OF TRANSPORTATION  
 EXISTING STRUCTURE PLANS

FAS ROUTE 1832  
 SECTION 5BR-2  
 WASHINGTON COUNTY

SCALE: VERT. \_\_\_\_\_  
 HORIZ. \_\_\_\_\_

DATE \_\_\_\_\_ DRAWN BY \_\_\_\_\_  
 CHECKED BY \_\_\_\_\_

PLOT DATE = 11/29/2007  
 FILE NAME = c:\p\projects\1832\1832\plan\p1832.dgn  
 PLOT SCALE = 58.8088 / IN.  
 REFERENCE = SHEET