

F.A.S. RTE.	SECTION	COUNTY	TOTAL SHEETS	SHEET NO.
1832	5BR-2	WASHINGTON	97	61
STA. _____ TO STA. _____		FED. ROAD DIST. NO. _____ ILLINOIS FED. AID PROJECT		

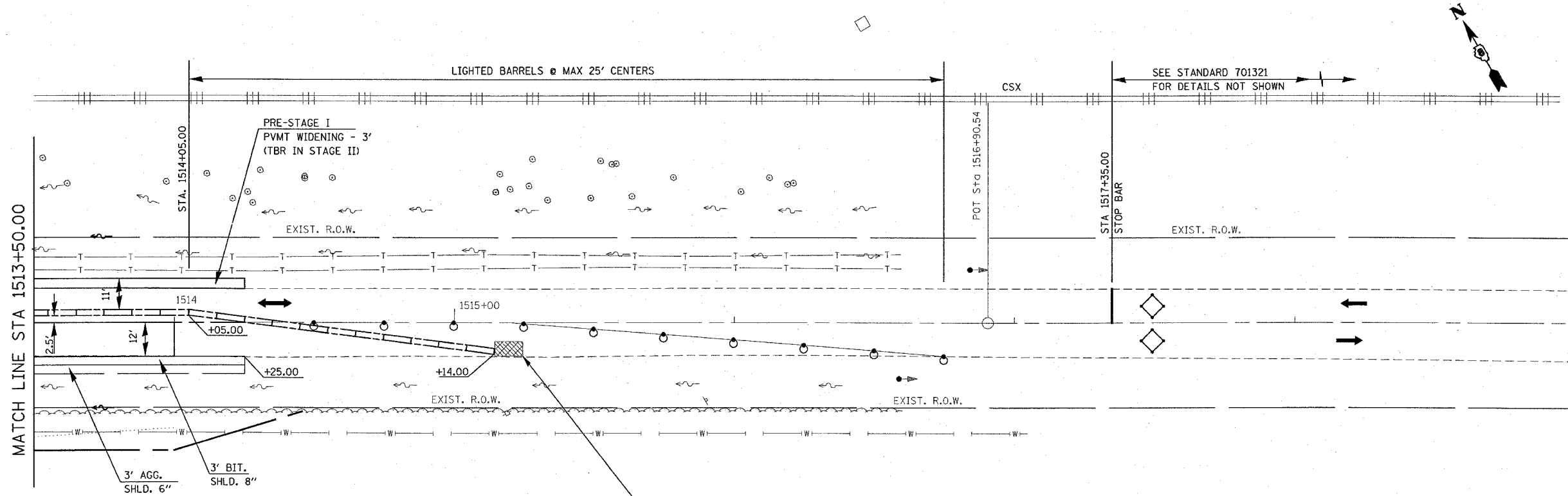

MATCH LINE STA 1513+50.00

**LEGEND:**

	STRUCTURE REMOVAL
	PAVEMENT REMOVAL
	TEMPORARY CONCRETE BARRIER
	IMPACT ATTENUATOR
	INDUCTION LOOP DETECTOR
	DRUM WITH STEADY BURNING LIGHT
	SIGNALIZED TWO-WAY TRAFFIC LANE
	TEMPORARY BRIDGE TRAFFIC SIGNAL
	TYPE III BARRICADE

- LEGEND**
- ① EXISTING PAVEMENT
  - ⑤ PROPOSED HOT-MIX ASPHALT BASE COURSE WIDENING 9"
  - ⑧ PROPOSED HOT-MIX ASPHALT BINDER COURSE (VARIES 0.75" TO 15")
  - ⑨ PROPOSED HOT-MIX ASPHALT SURFACE COURSE 1 1/2 "
  - ⑩ PROPOSED HOT-MIX ASPHALT SHOULDERS, 8"
  - ⑪ PROPOSED AGGREGATE SHOULDER 6"

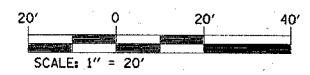
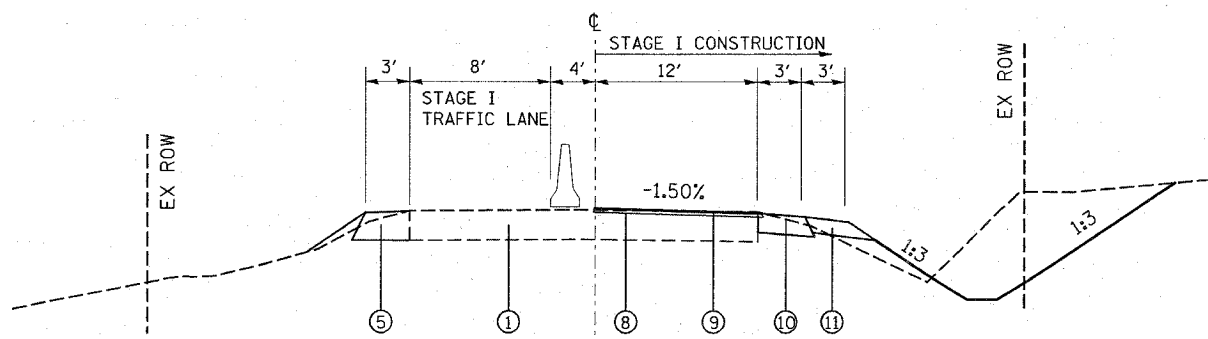

REVISIONS	
NAME	DATE

SN 095-0078

ILLINOIS DEPARTMENT OF TRANSPORTATION

**SUGGESTED STAGE I CONSTRUCTION**

FAS ROUTE 1832  
 SECTION 5BR-2  
 WASHINGTON COUNTY

SCALE: VERT. \_\_\_\_\_  
 HORIZ. \_\_\_\_\_

DATE \_\_\_\_\_ DRAWN BY \_\_\_\_\_  
 CHECKED BY \_\_\_\_\_

PLOT DATE = 12/7/2007  
 FILE NAME = c:\pcc\1832\5br\stage01\stage01b5.dgn  
 PLOT SCALE = 20,00000 / IN.  
 USER NAME = gelnh