

HORSESHOE LAKE ROAD
STAGE IV - SHOULDER WORK

1. MAINTAIN TRAFFIC ON NEWLY RESURFACED ROADWAY.
2. CONSTRUCT HMA SHOULDERS TO MATCH ELEVATION OF SURFACE COURSE.
3. SHAPE AGGREGATE SHOULDERS TO MATCH FINAL ELEVATION OF HMA SHOULDERS.

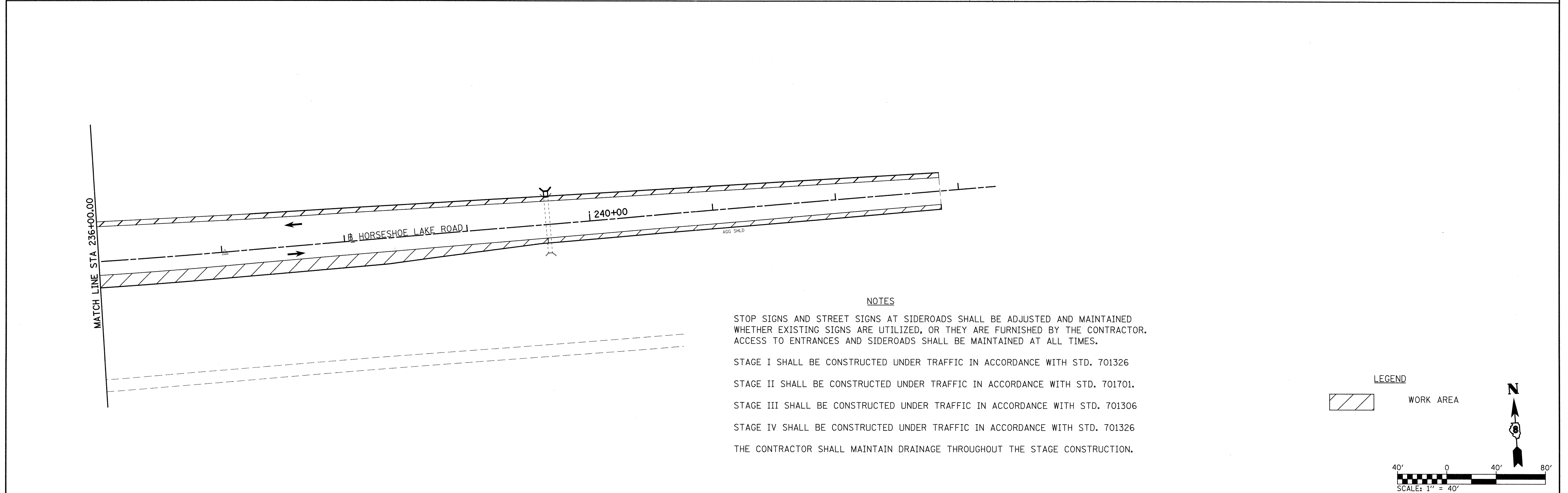
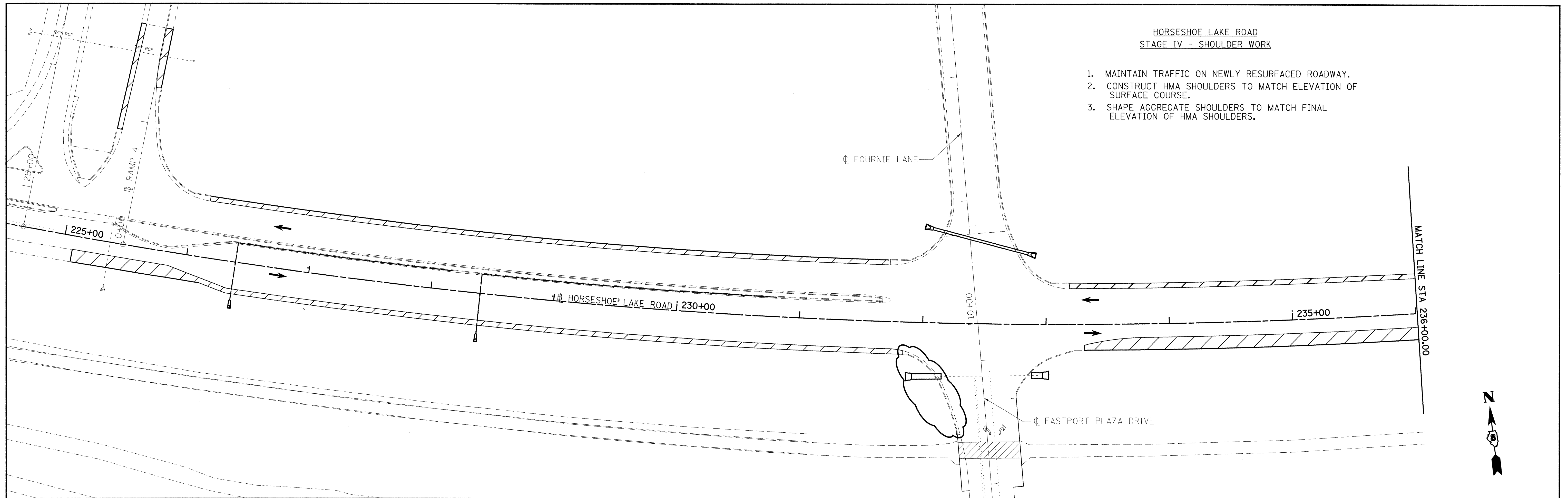

NOTES

STOP SIGNS AND STREET SIGNS AT SIDEROADS SHALL BE ADJUSTED AND MAINTAINED WHETHER EXISTING SIGNS ARE UTILIZED, OR THEY ARE FURNISHED BY THE CONTRACTOR. ACCESS TO ENTRANCES AND SIDEROADS SHALL BE MAINTAINED AT ALL TIMES.

STAGE I SHALL BE CONSTRUCTED UNDER TRAFFIC IN ACCORDANCE WITH STD. 701326

STAGE II SHALL BE CONSTRUCTED UNDER TRAFFIC IN ACCORDANCE WITH STD. 701701.

STAGE III SHALL BE CONSTRUCTED UNDER TRAFFIC IN ACCORDANCE WITH STD. 701306

STAGE IV SHALL BE CONSTRUCTED UNDER TRAFFIC IN ACCORDANCE WITH STD. 701326

THE CONTRACTOR SHALL MAINTAIN DRAINAGE THROUGHOUT THE STAGE CONSTRUCTION.

LEGEND



WORK AREA

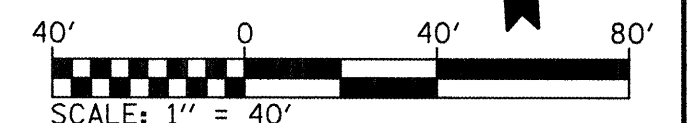

FILE NAME = D:\stg004.dgn	USER NAME = conoverpj	DESIGNED -	REVISED - 7/14/08	STATE OF ILLINOIS DEPARTMENT OF TRANSPORTATION	SUGGESTED STAGING STAGE IV HIGHWAY CONSTRUCTION			F.A.U. RTE. 9111	SECTION 73-15TS	COUNTY MADISON	TOTAL SHEETS 64	SHEET NO. 20
	PLOT SCALE = 40,0000 ' / IN.	DRAWN -	REVISED -		SCALE: 1" = 40'	SHEET NO. 4	OF 4	SHEETS	STA.	TO STA.	CONTRACT NO. 76B22	
	PLOT DATE = 7/16/2008	CHECKED -	REVISED -								ILLINOIS FED. AID PROJECT	
		DATE -	REVISED -								Rev. Sheet 7-17-08	