

HORSESHOE LAKE ROAD  
STAGE II - MEDIAN & PAVEMENT REMOVAL

1. MAINTAIN TRAFFIC ON EXISTING PAVEMENT, RELOCATING TRAFFIC ONTO PAVEMENT WIDENING AS NECESSARY FOR PAVING OPERATIONS.
2. SAW CUT & REMOVE MEDIAN & PAVEMENT AS REQUIRED.
3. CONSTRUCT INLETS AND REMAINING STORM SEWER. REMOVE THE EXISTING PAVEMENT, AS REQUIRED TO CONSTRUCTED THE STORM SEWER, AND PERFORMED THE PAVEMENT PATCHING.
4. CONSTRUCT NEW MEDIAN & PAVEMENT WIDENING AS REQUIRED.
5. SET UP TRAFFIC CONTROL FOR STAGE III.

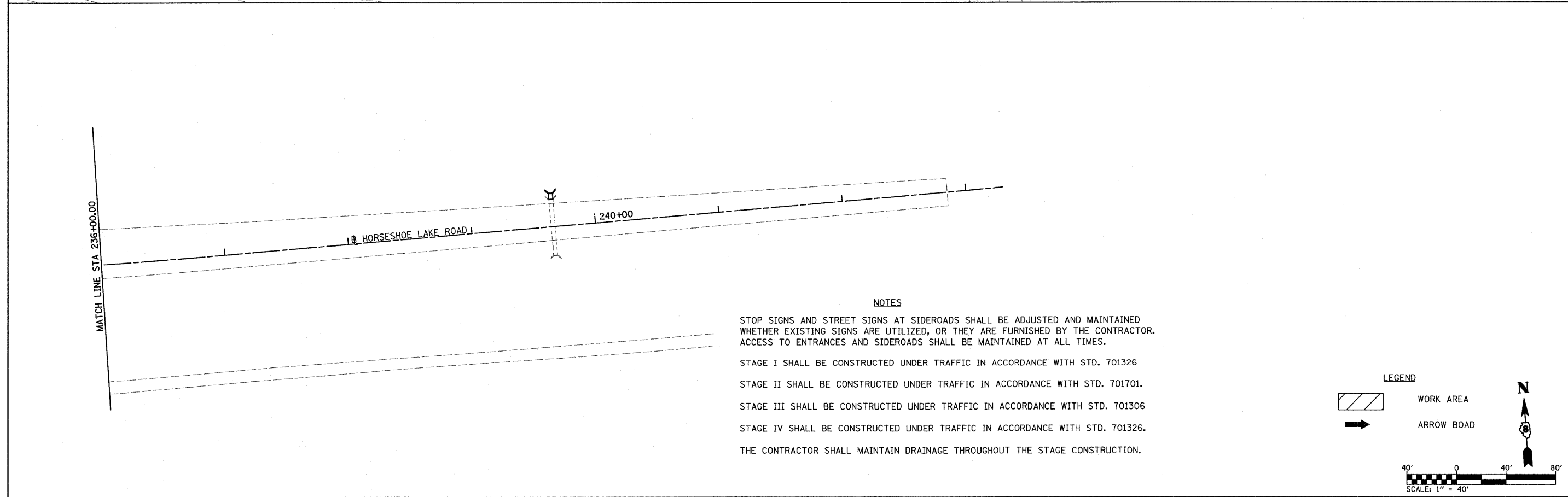

NOTES

STOP SIGNS AND STREET SIGNS AT SIDEROADS SHALL BE ADJUSTED AND MAINTAINED WHETHER EXISTING SIGNS ARE UTILIZED, OR THEY ARE FURNISHED BY THE CONTRACTOR. ACCESS TO ENTRANCES AND SIDEROADS SHALL BE MAINTAINED AT ALL TIMES.

STAGE I SHALL BE CONSTRUCTED UNDER TRAFFIC IN ACCORDANCE WITH STD. 701326

STAGE II SHALL BE CONSTRUCTED UNDER TRAFFIC IN ACCORDANCE WITH STD. 701701.

STAGE III SHALL BE CONSTRUCTED UNDER TRAFFIC IN ACCORDANCE WITH STD. 701306

STAGE IV SHALL BE CONSTRUCTED UNDER TRAFFIC IN ACCORDANCE WITH STD. 701326.

THE CONTRACTOR SHALL MAINTAIN DRAINAGE THROUGHOUT THE STAGE CONSTRUCTION.

LEGEND

- WORK AREA
- ARROW BOAD

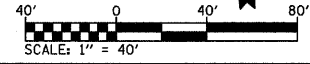

FILE NAME = H:\P\25004\Technical Production\Civil\W0	USER NAME = #USER# 7\Microstation\stg002.dgn	DESIGNED -	REVISED -	<b>STATE OF ILLINOIS DEPARTMENT OF TRANSPORTATION</b>	<b>SUGGESTED STAGING STAGE II HIGHWAY CONSTRUCTION</b>	F.A.U. RTE. 9111	SECTION 73-15TS	COUNTY MADISON	TOTAL SHEETS 64	SHEET NO. 18		
PLOT SCALE = 40,0000 ' / IN.		DRAWN -	REVISED -			SCALE: 1" = 40'	SHEET NO. 2 OF 4 SHEETS	STA.	TO STA.	FED. ROAD DIST. NO. ILLINOIS FED. AID PROJECT		
PLOT DATE = 3/14/2008		CHECKED -	REVISED -									
		DATE -	REVISED -									