

POINT 0003  
17' LT. STA. 502+37.51  
IRON PIN W/ IDOT CAP  
N. 263,999.6647  
E. 865,725.9525

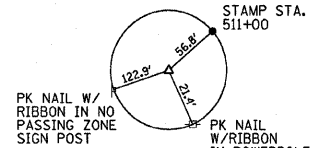

POINT 440604  
18' RT. STA. 510+51.01  
IRON PIN W/ IDOT CAP  
N. 263,513.6058  
E. 866,517.9168

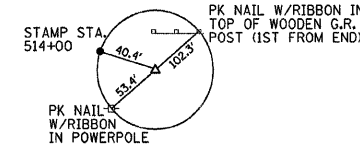

POINT 440605  
23' RT. STA. 514+42.34  
IRON PIN W/ IDOT CAP  
N. 263,719.5654  
E. 866,879.7765

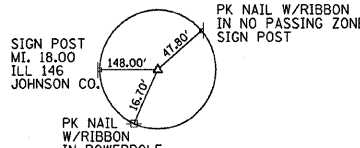

POINT 440606  
20' RT. STA. 521+52.06  
IRON PIN W/ IDOT CAP  
N. 263,560.6153  
E. 867,589.4742

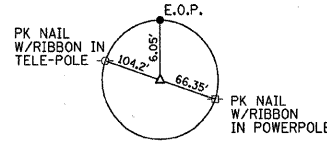

POINT 440607  
18' RT. STA. 529+24.33  
IRON PIN W/ IDOT CAP  
N. 263,385.8769  
E. 868,341.7392

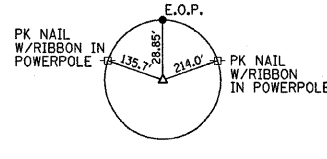

POINT 440608  
40' RT. STA. 535+26.59  
IRON PIN W/ IDOT CAP  
N. 263,295.2467  
E. 868,943.0771

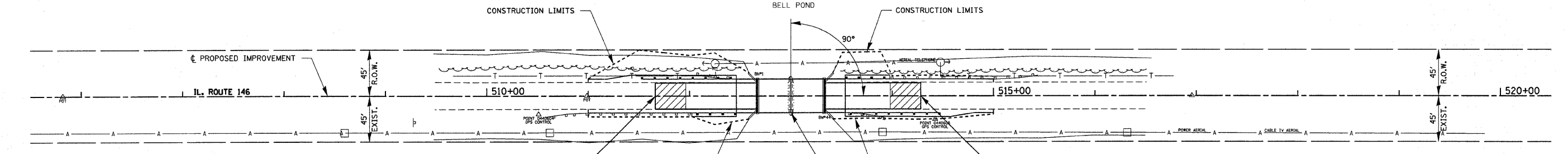
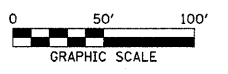

POINT	STATION	NORTHING	EASTING
POT477	C.L. 477+00.00	263,763.9885	863,239.0509
PC	C.L. 479+84.02	263,860.5645	863,506.1459
PI	481+82.77	263,928.1456	863,693.0515
PT	C.L. 483+80.12	263,956.2092	863,869.8087
PC	C.L. 492+48.83	264,078.8718	864,749.8114
PI	496+98.37	264,142.3482	865,194.8525
PT	C.L. 501+37.53	264,039.7345	865,632.5297
SEA501	C.L. 501+37.41	264,039.7345	865,632.5297
PC	C.L. 529+21.34	263,404.2708	868,342.9678
PI	534+00.90	263,294.8067	868,809.8639
PT	C.L. 538+69.74	263,359.5440	869,285.0307
POT548	C.L. 548+00.00	263,485.1232	870,206.7724

IMPROVEMENT BEGINS  
STATION 511+66.23

IMPROVEMENT ENDS  
STATION 514+28.15

STATION 513+00  
PRECAST PRESTRESSED CONCRETE DECK BEAM  
SUPERSTRUCTURE REPLACEMENT.  
TWO SPANS: 32'-9", 32'-9"  
33'-0" RDWY; SKEW = 0°  
STRUCTURE NO. 044-0022

HOT-MIX ASPHALT SURFACE  
REMOVAL BUTT-JOINT

EXISTING STRUCTURE NO. 044-0022  
STATION 513+00 - TWO SPAN PRECAST PRESTRESSED  
CONCRETE DECK BEAM BRIDGE ON CLOSED  
CONCRETE ABUTMENTS AND WINGWALLS.  
66.00' BK.-BK. ABUTS; 33.00' o.-o. DECK

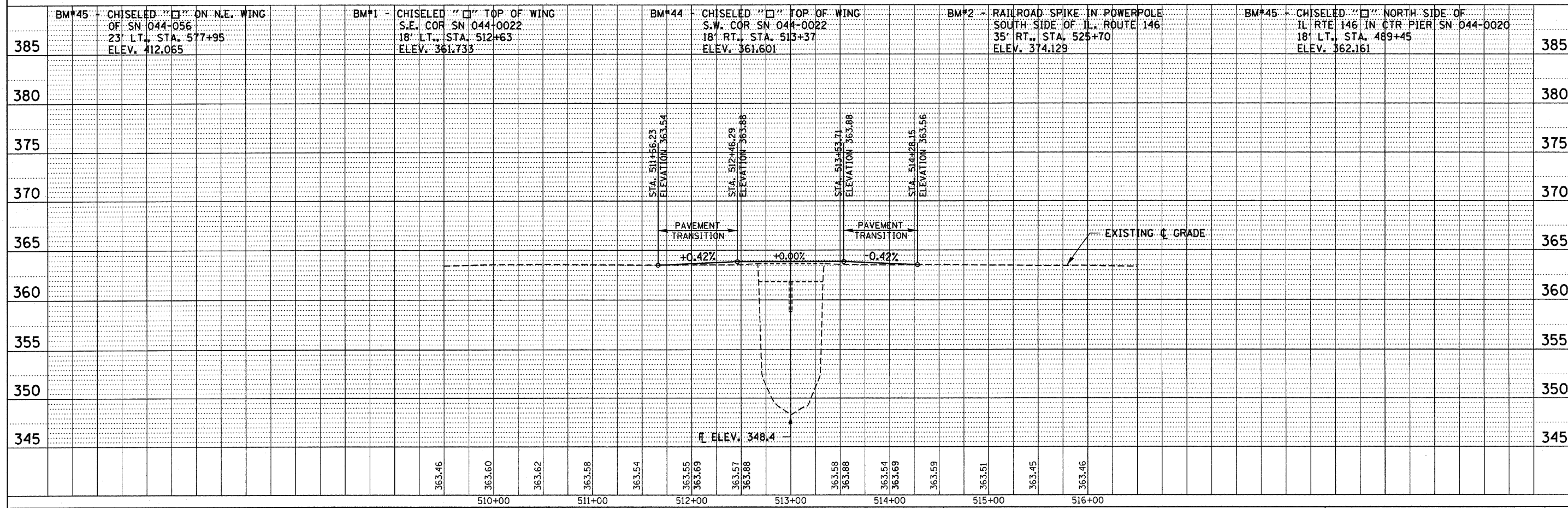

FILE NAME = 0448022-shr-pp1.dgn	USER NAME =	DESIGNED - L.F.S.	REVISED -	<b>STATE OF ILLINOIS</b> <b>DEPARTMENT OF TRANSPORTATION</b>	<b>HAMPTON, LENZINI &amp; RENWICK, INC.</b> CIVIL & STRUCTURAL ENGINEERS LAND SURVEYORS	<b>IL. ROUTE 146</b> <b>PLAN &amp; PROFILE</b>		F.A.P. RTE. = 885	SECTION = 111BR-1	COUNTY = JOHNSON	TOTAL SHEETS = 94	SHEET NO. = 16	
PLOT SCALE =	CHECKED - S.W.M.	DATE - 04/21/08	REVISED -			SCALE: 50:5	SHEET NO. 1 OF 1 SHEETS	STA. 506+00.00 TO STA. 520+00.00	CONTRACT NO. 78030				
PLOT DATE = 4/22/2008						FED. ROAD DIST. NO. ILLINOIS FED. AID PROJECT							

DATE	
BY	
SURVEYED	
PLANNED	
NOTED	
NO.	

DATE	
BY	
SURVEYED	
PLANNED	
NOTED	
NO.	