

**SCHEDULE OF QUANTITIES**

RELOCATE TEMPORARY CONCRETE BARRIER			
STATION TO	STATION	FEET	
279+66.25	283+53.75	387.5	
	TOTAL	387.5	

IMPACT ATTENUATORS, RELOCATE (NON-REDIRECTIVE), TEST LEVEL 3 - 2 EACH

**NOTES**

1. TRAFFIC CONTROL SHALL BE ERECTED AS SHOWN AND ACCORDING TO "TRAFFIC CONTROL AND PROTECTION, STANDARD 701321."
2. SEE SPECIAL PROVISIONS FOR ADDITIONAL TRAFFIC CONTROL REQUIREMENTS.
3. COORDINATE LOCATION OF SIGNALS WITH FINAL WORK AS DIRECTED BY THE ENGINEER.
4. MAINTAIN TEMPORARY RUMBLE STRIPS AT LOCATIONS SHOWN ON STANDARD 701321 AT SOUTH END OF PROJECT ONLY.

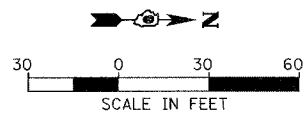
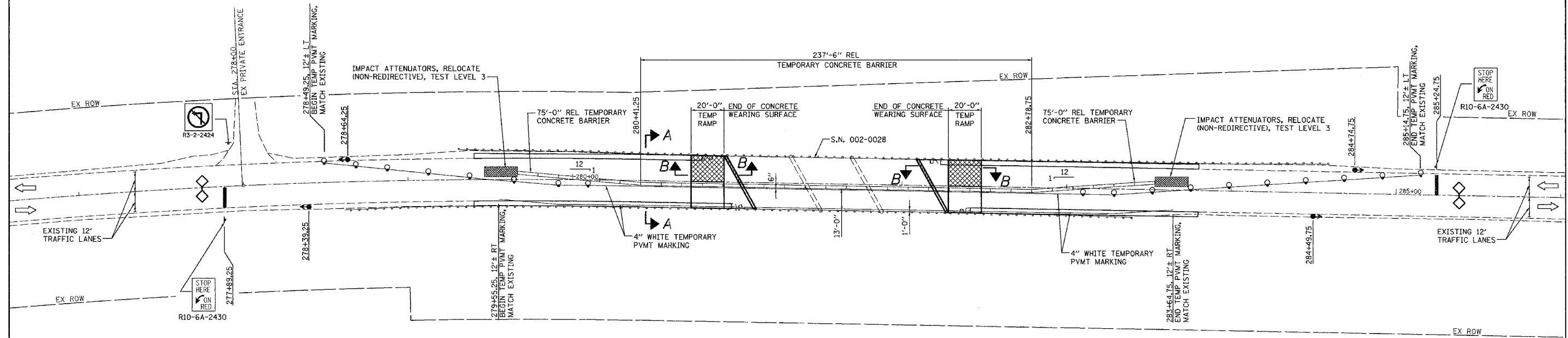

**LEGEND**

- TRAFFIC SIGNAL
- DRUM WITH STEADY BURNING LIGHT
- ▨ TEMPORARY RAMP
- ▩ HMA SURFACE REMOVAL

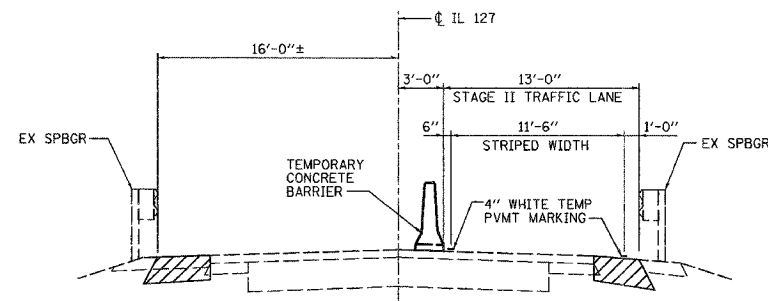

**SECTION A-A**

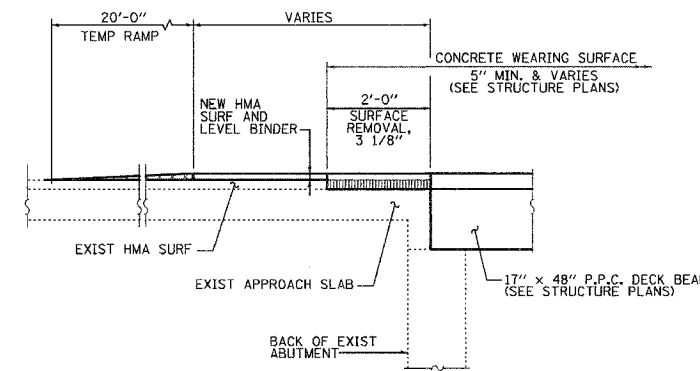

**SECTION B-B**



FILE NAME =	USER NAME = #USER#	DESIGNED - JMH	REVISED -	<b>STATE OF ILLINOIS DEPARTMENT OF TRANSPORTATION</b>	<b>FAS ROUTE 1907 (IL 127) STAGE II CONSTRUCTION</b>	F.A.S. RTE.	SECTION	COUNTY	TOTAL SHEETS	SHEET NO.	
#FILE#		DRAWN - AEC	REVISED -			1907	21BR-1	ALEXANDER	82	8	
		CHECKED - JMH	REVISED -			CONTRACT NO. 78032					
		DATE - 04/08/08	REVISED -			FED. ROAD DIST. NO. 7 (ILLINOIS) FED. AID PROJECT					
				SCALE: 1"=30'		SHEET NO. 2 OF 2 SHEETS		STA. 276+60 TO STA. 286+00			