

SCHEDULE OF QUANTITIES

TEMPORARY CONCRETE BARRIER			
STATION	IQ	STATION	FEET
531+40		535+15	375
		TOTAL	375

TEMPORARY BRIDGE TRAFFIC SIGNALS - 1 EACH

TEMPORARY RUMBLE STRIPS - 3 EACH

IMPACT ATTENUATORS, TEMPORARY (NON-REDIRECTIVE), TEST LEVEL 3 - 2 EACH

NOTES

1. TRAFFIC CONTROL SHALL BE ERECTED AS SHOWN AND ACCORDING TO "TRAFFIC CONTROL AND PROTECTION, STANDARD 701321."
2. SEE SPECIAL PROVISIONS FOR ADDITIONAL TRAFFIC CONTROL REQUIREMENTS.
3. COORDINATE LOCATION OF SIGNALS WITH FINAL WORK AS DIRECTED BY THE ENGINEER.
4. CONSTRUCT TEMPORARY RUMBLE STRIPS AT LOCATIONS SHOWN ON STANDARD 701321 AT SOUTH END OF PROJECT ONLY.

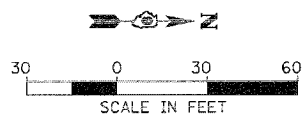
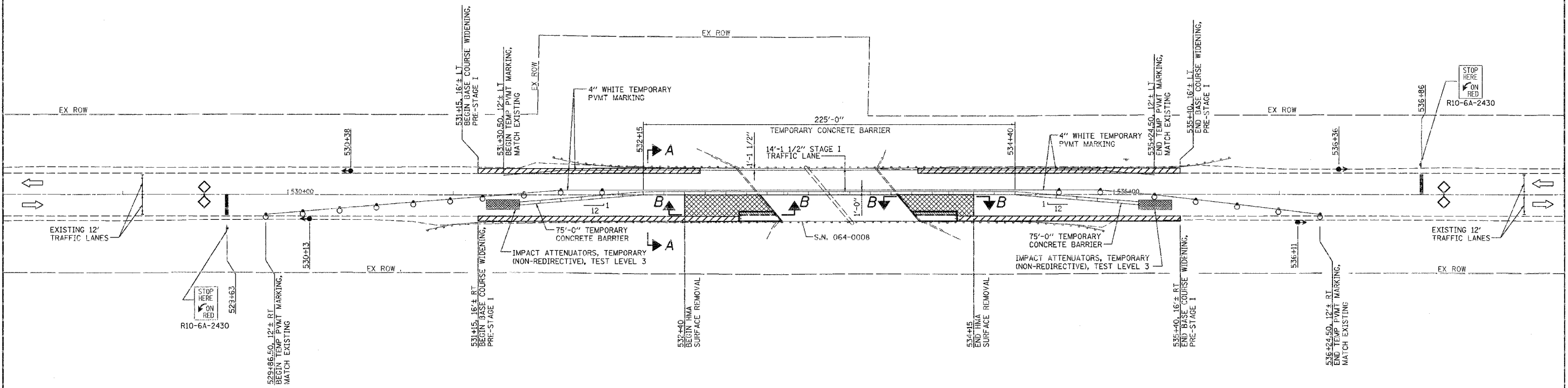

LEGEND

- TRAFFIC SIGNAL
- DRUM WITH STEADY BURNING LIGHT
- ▨ BASE COURSE WIDENING, 10"
- ▩ PAVEMENT REMOVAL
- ▧ HMA SURFACE REMOVAL - BUTT JOINT

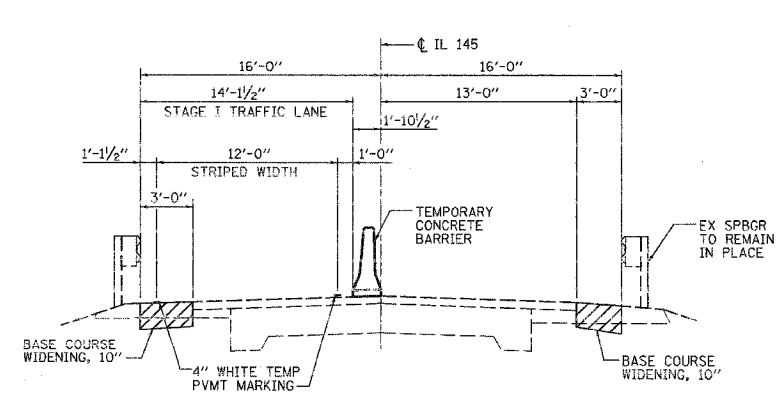

SECTION A-A

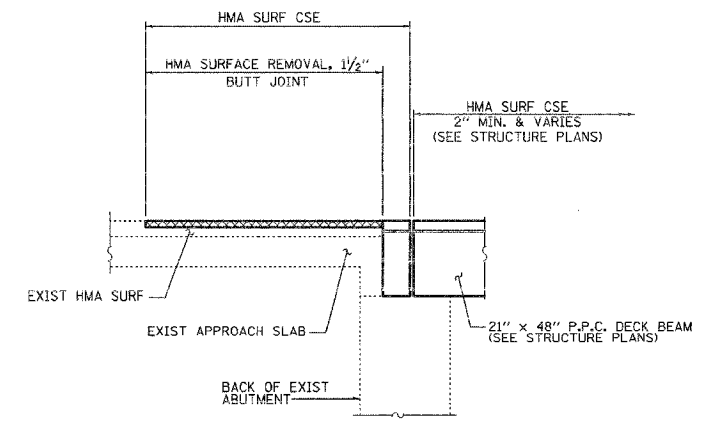

SECTION B-B



FILE NAME =	USER NAME = #USER#	DESIGNED - JMH	REVISED -	STATE OF ILLINOIS DEPARTMENT OF TRANSPORTATION	FAP ROUTE 132 (IL 145) STAGE I CONSTRUCTION	F.A.P. RTE. 132	SECTION 102BR-1	COUNTY MASSAC	TOTAL SHEETS 82	SHEET NO. 49		
#FILE#	PLOT SCALE = #SCALE#	CHECKED - JMH	REVISED -			SCALE: 1"=30'	SHEET NO. 1 OF 2 SHEETS	STA. 528+30	TO STA. 537+70	CONTRACT NO. 78032		
	PLOT DATE = #DATE#	DATE - 03/12/08	REVISED -			FED. ROAD DIST. NO. 7 (ILLINOIS) FED. AID PROJECT						