

SCHEDULE OF QUANTITIES

STATION TO	STATION	FEET
531+40	535+15	375
TOTAL		375

IMPACT ATTENUATORS, RELOCATE (NON-REDIRECTIVE), TEST LEVEL 3 - 2 EACH

NOTES

1. TRAFFIC CONTROL SHALL BE ERECTED AS SHOWN AND ACCORDING TO "TRAFFIC CONTROL AND PROTECTION, STANDARD 701321."
2. SEE SPECIAL PROVISIONS FOR ADDITIONAL TRAFFIC CONTROL REQUIREMENTS.
3. COORDINATE LOCATION OF SIGNALS WITH FINAL WORK AS DIRECTED BY THE ENGINEER.
4. MAINTAIN TEMPORARY RUMBLE STRIPS AT LOCATIONS SHOWN ON STANDARD 701321 AT SOUTH END OF PROJECT ONLY.

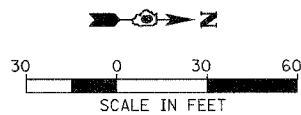
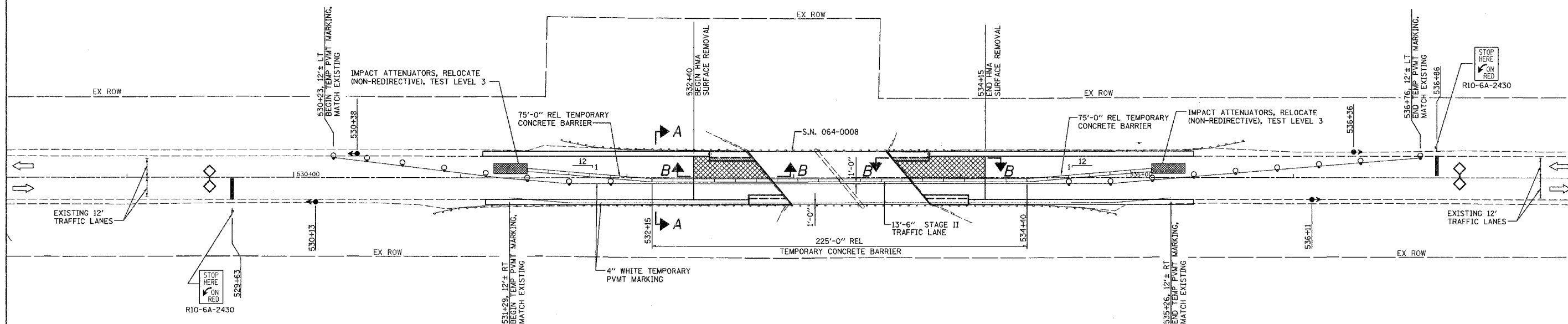

LEGEND

- ◉ TRAFFIC SIGNAL
- ◉ DRUM WITH STEADY BURNING LIGHT
- ▨ PAVEMENT REMOVAL
- ▨ HMA SURFACE REMOVAL - BUTT JOINT

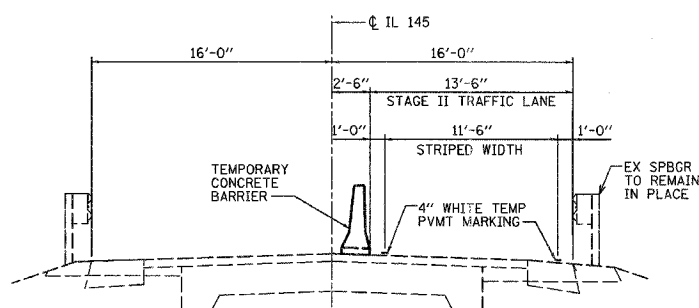

SECTION A-A

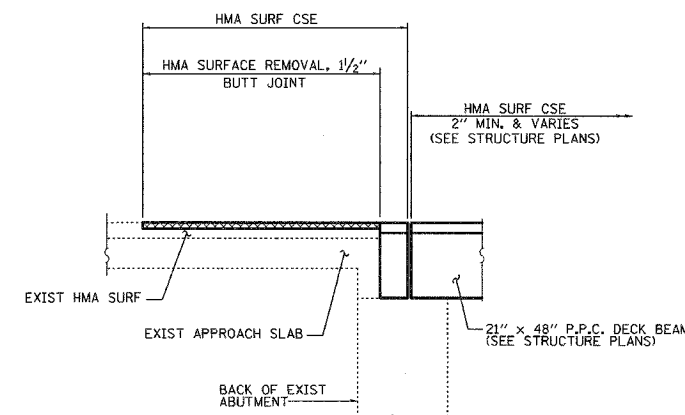

SECTION B-B



FILE NAME =	USER NAME = #USER#	DESIGNED - JHM	REVISED -	STATE OF ILLINOIS DEPARTMENT OF TRANSPORTATION	FAP ROUTE 132 (IL 145) STAGE II CONSTRUCTION	F.A.P. RTE.	SECTION	COUNTY	TOTAL SHEETS	SHEET NO.	
#FILE#		DRAWN - AEC	REVISED -			132	102BR-1	MASSAC	82	50	
	PLOT SCALE = #SCALE#	CHECKED - JMH	REVISED -			CONTRACT NO. 78032					
	PLOT DATE = #DATE#	DATE - 03/12/08	REVISED -			FED. ROAD DIST. NO. 7 ILLINOIS FED. AID PROJECT					

SCALE: 1"=30' SHEET NO. 2 OF 2 SHEETS STA. 528+30 TO STA. 537+70