

Bench Mark 35: Chiseled square in southwest wingwall of SN 076-0008. Elevation 351.404.

Existing Structure: The original single span structure was built in 1928 with a reinforced concrete deck girder superstructure on reinforced concrete closed abutments with a length of 43'-3" back-to-back of abutments. The structure was rehabilitated in 1981. The superstructure was replaced with P.P.C. deck beam with a total width of 33'-0" out-to-out of superstructure and substructure was modified accordingly.

Proposed Improvements: The existing superstructure is to be replaced with P.P.C. deck beams and a HMA surface course and waterproofing. Minor substructure repairs are required. Traffic to be maintained at all times utilizing stage construction.

No Salvage.

STATE OF ILLINOIS
DEPARTMENT OF TRANSPORTATION

ROUTE NO.	SECTION	COUNTY	TOTAL SHEETS	SHEET NO.	SHEET NO. 1
F.A.P. 885	111BR-2	POPE	69	49	11 SHEETS
FED. ROAD DIST. NO. 7	ILLINOIS	FED. AID PROJECT			

Contract #78033

DESIGN SPECIFICATIONS

2007 AASHTO LRFD Bridge Design Specifications, 4th Edition

LOADING HL-93

No allowance for Future Wearing Surface.

DESIGN STRESSES

PRECAST PRESTRESSED UNITS

$f'_c = 6,000$ psi
 $f'_{ci} = 5,000$ psi
 $f_{pu} = 270,000$ psi ($\frac{1}{2}$ " ϕ low lax. strands)
 $f_{pbt} = 201,960$ psi ($\frac{1}{2}$ " ϕ low lax strands)

PRECAST UNITS

$f'_c = 4,500$ psi
 $f_y = 60,000$ psi (reinforcement)

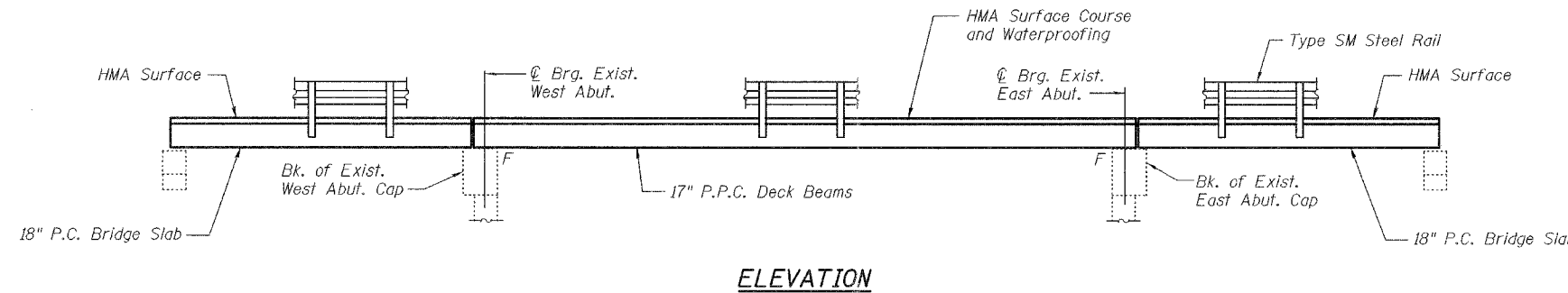

ELEVATION

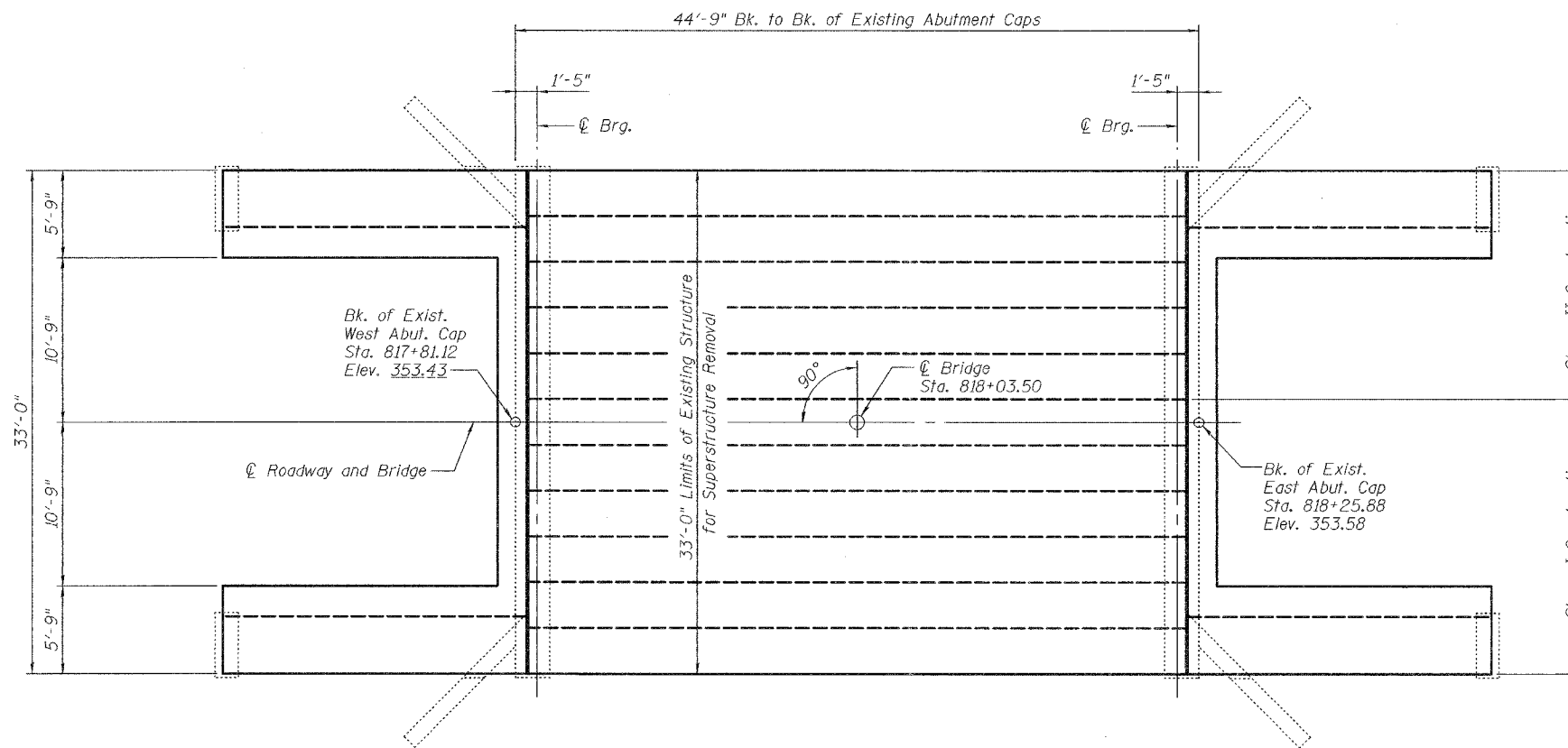

PLAN

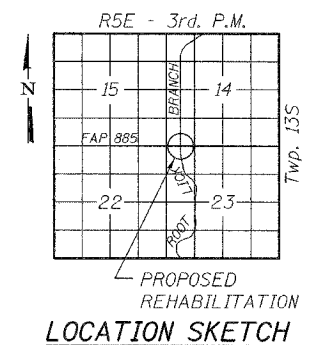

STATION 818+03.50
REBUILT 200_ BY
STATE OF ILLINOIS
F.A.P. RT. 885 SEC. 111BR-2
LOADING HL93
STR. NO. 076-0008

NAME PLATE
See Std. 515001

Notes:
Existing name plate shall be cleaned and relocated adjacent to the new name plate. Cost included with Name Plates.
Locate name plates at outside face of top steel railing tube at southwest corner of bridge.

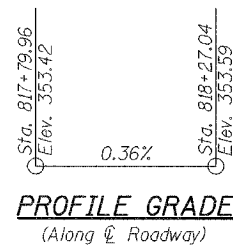

APPROVED
FOR STRUCTURAL ADEQUACY ONLY

Ralph E. Anderson (TSD)
ENGINEER OF BRIDGES AND STRUCTURES



David W. Petermeier 4/23/08
DAVID W. PETERMEIER
EDWARDSVILLE, ILLINOIS
ILLINOIS LICENSED STRUCTURAL
ENGINEER NO. 081-005642
EXPIRES NOV. 30, 2008

GENERAL PLAN AND ELEVATION
ILL. ROUTE 146 OVER ROOT LICK BRANCH
F.A.P. ROUTE 885 - SECTION 111BR-2
POPE COUNTY
STATION 818+03.50
STRUCTURE NO. 076-0008



DESIGNED	YSS
CHECKED	RLM
DRAWN	PRC
CHECKED	RLM

03/17/08