

GENERAL NOTES:

THIS SECTION SHALL BE CONSTRUCTED IN ACCORDANCE WITH THE PLANS, SPECIAL PROVISIONS AND "STANDARD SPECIFICATIONS FOR ROAD AND BRIDGE CONSTRUCTION", ADOPTED JANUARY 1, 2007.

THE WORK INVOLVED ON THIS SECTION CONSISTS OF THE REMOVAL OF THE EXISTING STRUCTURE, THE CONSTRUCTION OF A 40 FOOT LONG SINGLE SPAN PRECAST, PRESTRESSED CONCRETE DECK BEAM BRIDGE, EARTH APPROACHES, AGGREGATE SURFACE COURSE AND OTHER MISCELLANEOUS ITEMS NECESSARY TO COMPLETE THIS SECTION.

ALL ELEVATIONS ARE BASED ON U.S.C.S. MEAN SEA LEVEL DATUM.

IT SHALL BE THE CONTRACTOR'S RESPONSIBILITY TO CONTACT ALL THE UTILITIES, AFFECTING THE PROJECT, PRIOR TO CONSTRUCTION.

TYPICAL CROSS SECTION PROPOSED

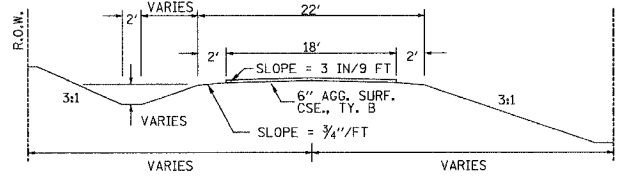

TYPICAL CROSS SECTION EXISTING

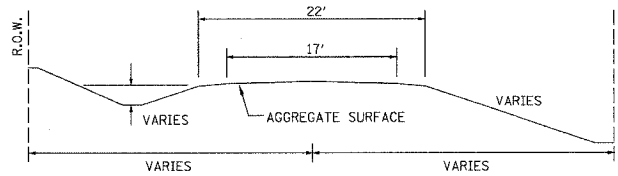

UTILITIES:
J.U.L.I.E. 1-800-892-0123

NOTE: CONSTRUCT SPECIAL DITCH

STA 2+50 TO STA 4+10 LT
STA 5+12 TO STA 7+50 RT

NOTE: CONSTRUCT STONE RIPRAP DITCH

STA 3+76 RT OFFSET 18' TO 20' (0.62 TON/LIN FT)
STA 3+80 LT OFFSET 21.4' TO 31.4' (0.62 TON/LIN FT)
8 TON STONE RIPRAP DITCH ALLOWED IN PROPOSAL.

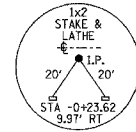

NOTE: CONSTRUCTION TRANSITIONS
STA. 2+50 TO STA. 3+00
STA. 7+00 TO STA. 7+50
ALL QUANTITIES ARE INCLUDED IN THE PROPOSAL

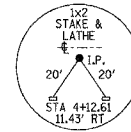

P.I. STA= 5+62.85
Δ= 00°50'57" RT

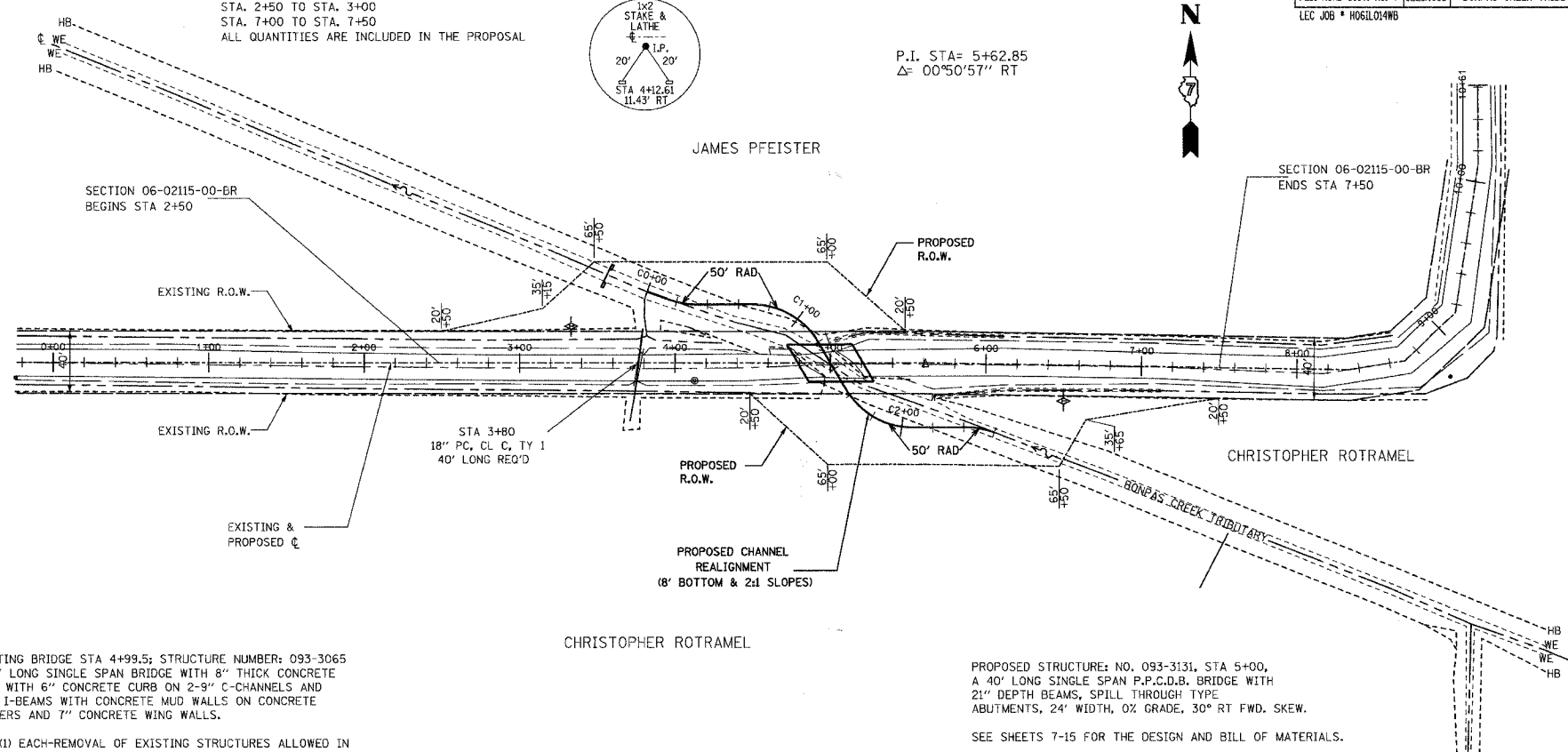

EXISTING BRIDGE STA 4+99.5; STRUCTURE NUMBER: 093-3065
A 27' LONG SINGLE SPAN BRIDGE WITH 8" THICK CONCRETE DECK WITH 6" CONCRETE CURB ON 2-9" C-CHANNELS AND 8-8" I-BEAMS WITH CONCRETE MUD WALLS ON CONCRETE FOOTERS AND 7" CONCRETE WING WALLS.

ONE (1) EACH REMOVAL OF EXISTING STRUCTURES ALLOWED IN THIS PROPOSAL.

CHRISTOPHER ROTRAMEL

PROPOSED STRUCTURE: NO. 093-3131, STA 5+00,
A 40' LONG SINGLE SPAN P.P.C.D.B. BRIDGE WITH
21" DEPTH BEAMS, SPILL THROUGH TYPE
ABUTMENTS, 24" WIDTH, 0% GRADE, 30° RT FWD. SKEW.

SEE SHEETS 7-15 FOR THE DESIGN AND BILL OF MATERIALS.

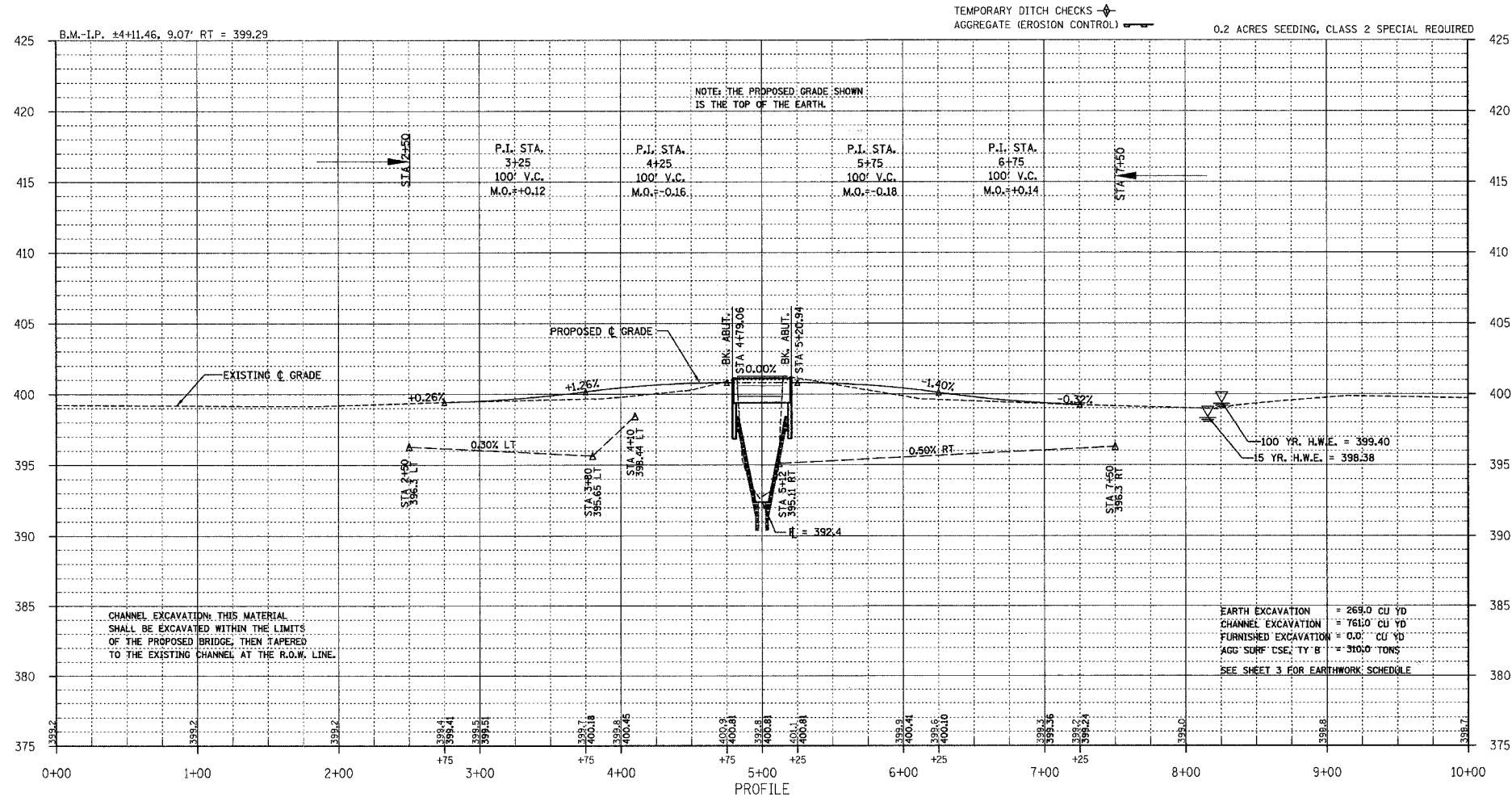

NOTE: THE PROPOSED GRADE SHOWN IS THE TOP OF THE EARTH.

CHANNEL EXCAVATION: THIS MATERIAL SHALL BE EXCAVATED WITHIN THE LIMITS OF THE PROPOSED BRIDGE, THEN TAPERED TO THE EXISTING CHANNEL AT THE R.O.W. LINE.

EARTH EXCAVATION = 268.0 CU YD
CHANNEL EXCAVATION = 761.0 CU YD
FURNISHED EXCAVATION = 0.0 CU YD
AGG SURF CSE TY B = 310.0 TONS
SEE SHEET 3 FOR EARTHWORK SCHEDULE

T.R.	SECTION	COUNTY	TOTAL SHEETS	SHEET NO.
151	06-05120-00-BR	WABASH	15	2

323 W 3RD ST.
P.O. BOX 100
MT. CARMEL, IL
62863

PHONE: (618)-262-8651
FAX: (618)-263-3327

405 W. STATE ST.
SUITE 1
PRINCETON, IN
47670

PHONE: (612)-386-7611
FAX: (612)-385-2812



AARON M. MEFFORD
NAME
SIGNATURE
3-21-08
DATE
11-30-09
EXPIRES

BONPAS CREEK TRIBUTARY
TOWNSHIP ROUTE 151
WABASH COUNTY, ILLINOIS

SHEET TITLE:
PLAN & PROFILE

SCALE: VPIES
BY: AMM
DATE: 3/08
REV:

2 OF 15
SHEETS
SHEET NO.
2