

- ① 10' PIPE CULVERTS, CLASS A, TYPE 1, 24" W/CONC COLLAR & PRC END SECTION
- ② 4' PIPE CULVERTS, CLASS A, TYPE 1, 24" W/CONC COLLAR & PRC END SECTION
- ③ 90' PIPE CULVERTS, CLASS A, TYPE 2, 24" W/2 PRC END SECTIONS
- ④ 89' PIPE UNDERDRAINS FOR STRUCTURES, 4" W/2 CONC HDW FOR PIPE DRAINS
- ⑤ 11' STORM SEWERS, CLASS A, TYPE 2, 36" W/CONC COLLAR, 28" REINF CONC PIPE ELBOW & PRC END SECTION
- ⑥ 11' PIPE DRAINS, 12" W/END SECTION
- ⑦ 21' PIPE DRAINS, 12"
- ⑧ 49' STORM SEWERS, CLASS A, TYPE 2, 36" W/PRC END SECTION
- ⑨ 9' PIPE DRAINS, 12"
- ⑩ 11' STORM SEWERS, CLASS A, TYPE 2, 36" W/CONC COLLAR 34" REINF CONC PIPE ELBOW
- ⑪ 10' STORM SEWERS, CLASS A, TYPE 2, 18" W/ CONC COLLAR
- ⑫ 103' PIPE UNDERDRAINS FOR STRUCTURES, 4" W/CONC HDW FOR PIPE DRAINS
- ⑬ 5' PIPE CULVERT REMOVAL
- ⑭ REMOVE EX PRC END SECTION, PAID FOR AS 8' PIPE CULVERT REMOVAL

**MATCHLINE STATION 44+00**  
SEE SHT. 21 FOR CONT.

CONTRACT NO. 98999	
FAP RTE 869	SECTION 105A/B-1
COUNTY SALINE	TOTAL SHEETS 71
NO. 20	
STA. 1641+00	TO STA. 1651+00
FED. ROAD DIST. NO.	ILLINOIS FED. AID PROJECT

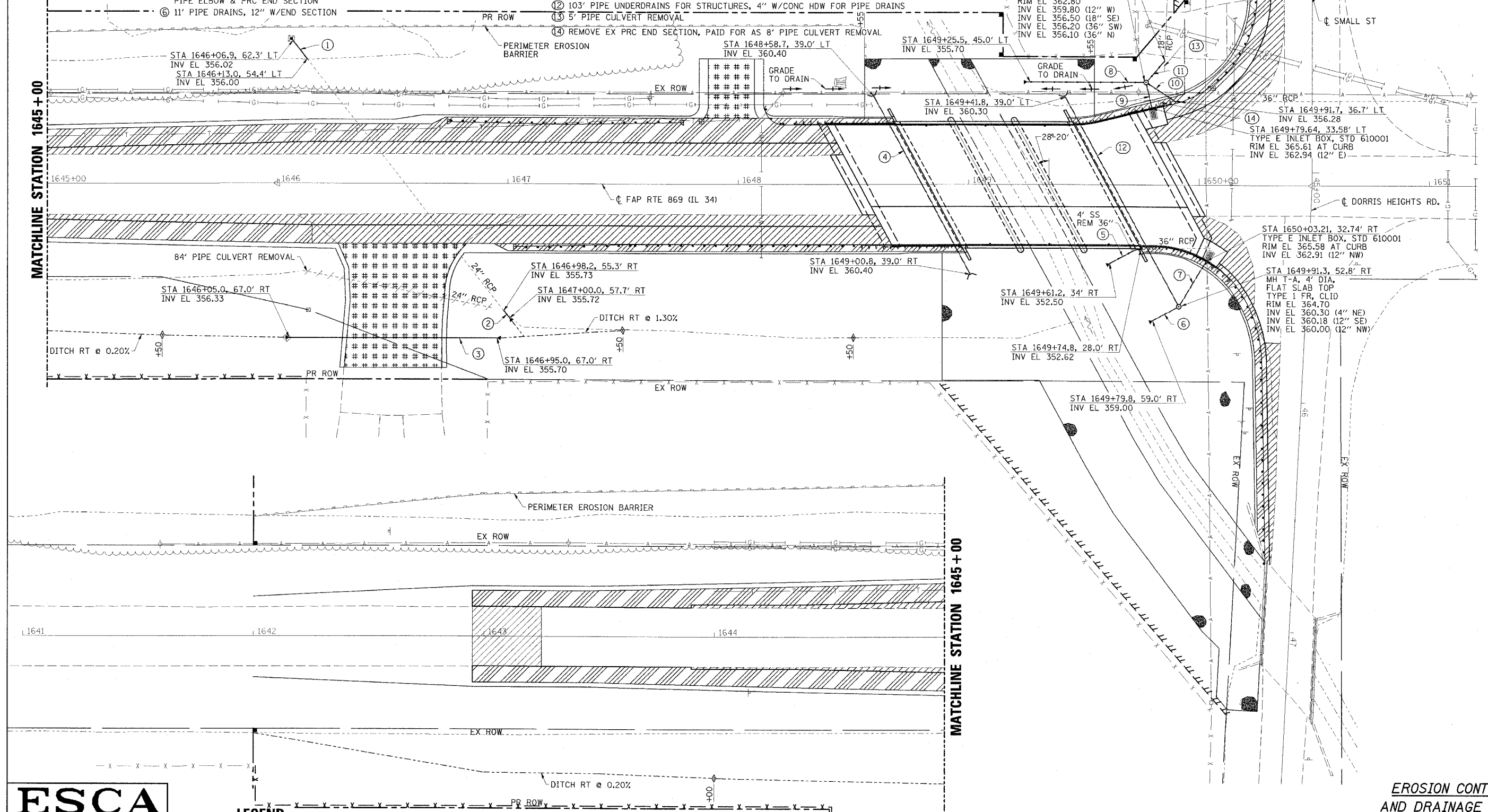

**ESCA**  
CONSULTANTS, INC.

DESIGNED BY:	MTD	07/07
DRAWN BY:	DWH	07/07
CHECKED BY:	MTD	10/07
APPROVED BY:	RDP	03/08

- LEGEND**
- PERIMETER EROSION BARRIER
  - ▨ EROSION CONTROL BLANKET
  - ⊕ TEMPORARY DITCH CHECK
  - ⊕ INLET AND PIPE PROTECTION
  - SWALE FLOW DIRECTION

**EROSION CONTROL AND DRAINAGE PLAN**  
FAP RTE 869 (IL 34)  
SECTION 105A/B-1  
SALINE COUNTY