

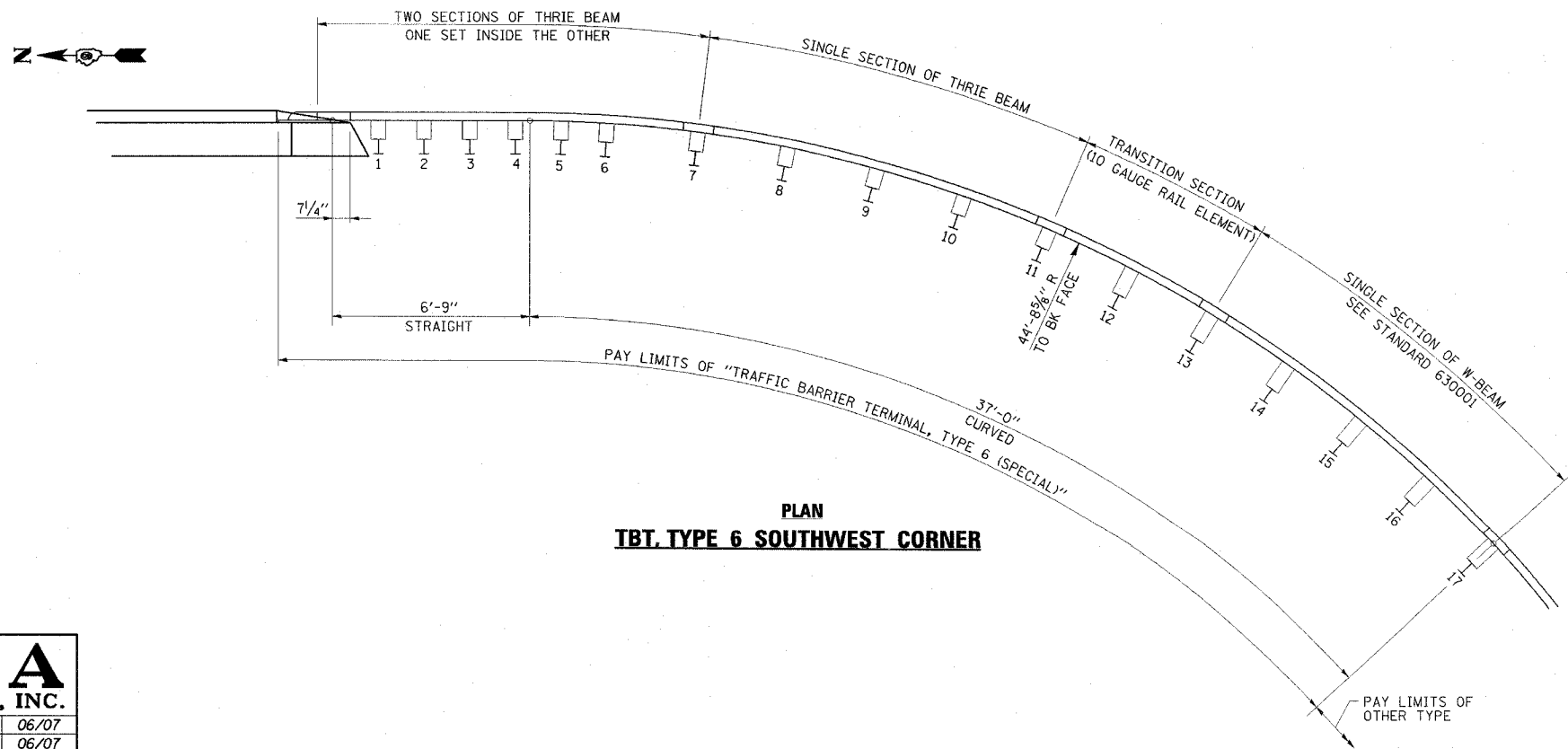

CONTRACT NO. 98999				
FAP RTE	SECTION	COUNTY	TOTAL SHEETS	SHEET NO.
869	(105A)B-1	SALINE	71	26
STA.		TO STA.		
FED. ROAD DIST. NO.	ILLINOIS	FED. AID PROJECT		

NOTES

1. SEE STANDARD 631031 FOR POST SPACING AND ADDITIONAL DETAILS.
2. RAIL ELEMENTS SHALL BE SHOP CURVED TO THE RADII SHOWN AND THE COST INCLUDED IN "TRAFFIC BARRIER TERMINAL, TYPE 6 (SPECIAL)".

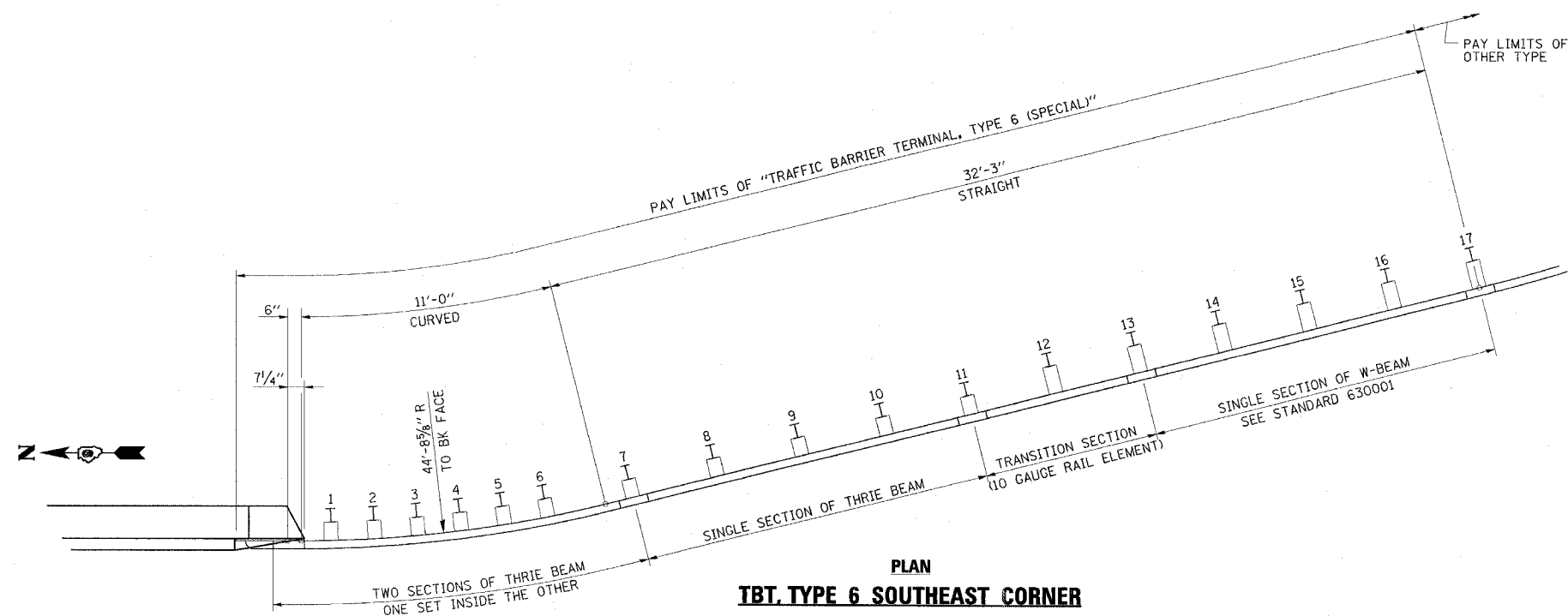

TBT TYPE 6 (SPECIAL)
FAP RTE 869 (IL 34)
SECTION (105A)B-1
SALINE COUNTY

ESCA CONSULTANTS, INC.		
DESIGNED BY:	MTD	06/07
DRAWN BY:	DWH	06/07
CHECKED BY:	MTD	10/07
APPROVED BY:	RDP	03/08

PLOT DATE * DATE *
FILE NAME * FILE *
REFERENCE * REF *
PLOT SCALE * SCALE *
PLOT SIZE * SIZE *