

**SCOPE OF WORK**

THE PROJECT SCOPE CONSISTS OF A BITUMINOUS CONCRETE OVERLAY OF THE AIRPORT ENTRANCE ROAD AND PARKING LOT.

**PROPOSED SAFETY PLAN**

GENERAL- THE BENTON MUNICIPAL AIRPORT CURRENTLY HAS A PAVED NORTH-SOUTH RUNWAY (4000-FT BY 75-FT).

**CONTRACTOR'S RESPONSIBILITIES**

IDENTIFICATION- THE CONTRACTOR'S VEHICLES AND EQUIPMENT SHALL BE PROPERLY MARKED WITH 3-FOOT SQUARE INTERNATIONAL ORANGE AND WHITE CHECKERED FLAGS ANYTIME THEY ARE ON AIRPORT PROPERTY.

THE CONTRACTOR AND HIS EMPLOYEES SHALL BE RESTRICTED TO THE WORK AREA. IT IS ANTICIPATED THAT NO CONSTRUCTION ACTIVITIES ASSOCIATED WITH THIS PROJECT WILL IMPACT ANY AIRCRAFT OPERATIONS ON THE AIRPORT RUNWAYS.

EQUIPMENT PARKING AND STORAGE- THE CONTRACTOR'S EQUIPMENT PARKING, STORAGE, AND EMPLOYEE PARKING WILL BE AT THE LOCATION SHOWN ON THIS SHEET. ONLY CONTRACTOR VEHICLES AND EQUIPMENT REQUIRED FOR CONSTRUCTION WILL BE ALLOWED OUTSIDE THIS AREA.

BARRICADES AND TRAFFIC CONES- IT WILL BE THE CONTRACTOR'S RESPONSIBILITY TO PLACE AND MAINTAIN BARRICADES AND TRAFFIC CONES AS REQUIRED AND AS DIRECTED BY THE RESIDENT ENGINEER. BARRICADES, THEIR MAINTENANCE, PLACEMENT, AND REMOVAL WILL BE CONSIDERED AS AN INCIDENTAL ITEM TO THE CONTRACT AND NO ADDITIONAL COMPENSATION WILL BE ALLOWED.

THE CONTRACTOR WILL NOT BE ALLOWED ON ANY AIRPORT PAVEMENT. THE CONTRACTOR WILL BE RESPONSIBLE FOR REPAIRING ANY DAMAGE TO EXISTING PAVEMENTS CAUSED BY HIS PERSONNEL OR EQUIPMENT.

**HAUL ROUTE AND EQUIPMENT PARKING**

THE CONTRACTOR WILL USE THE DESIGNATED HAUL ROUTE AND EQUIPMENT PARKING AREA SHOWN ON THIS SAFETY PLAN. THE PROPOSED EQUIPMENT PARKING AREA WILL BE APPROXIMATELY 100-FT BY 200-FT. THE CONTRACTOR WILL BE REQUIRED TO MAINTAIN THE PROPOSED HAUL ROUTE AND PARKING AREA THROUGHOUT THE COURSE OF THE PROJECT. AT THE CONCLUSION OF THE PROJECT, ALL AREAS DISTURBED WILL BE RESTORED AS NEEDED TO ITS ORIGINAL STATE. RESTORATION OF THE HAUL ROUTE AND EQUIPMENT PARKING AREA WILL BE CONSIDERED INCIDENTAL TO THE PROJECT AND NO ADDITIONAL COMPENSATION WILL BE ALLOWED.

**UTILITY NOTE**

THE CONTRACTOR IS RESPONSIBLE FOR CONTACTING ALL UTILITY COMPANIES AND ORGANIZATIONS THAT HAVE LINES OR CONDUITS IN THE PROPOSED WORK AREA. ALL LINES AND CONDUITS SHALL BE LOCATED AND IDENTIFIED FOR DEPTH BEFORE ANY EXCAVATION BEGINS. THE CONTRACTOR SHALL CALL JULIE (1-800-892-0123) TO ACCOMPLISH THESE REQUIREMENTS. THE CONTRACTOR IS RESPONSIBLE FOR IDENTIFYING ALL NON-JULIE UTILITIES LOCATED WITHIN THE PROPOSED CONSTRUCTION LIMITS. THESE UTILITIES ARE TO BE LOCATED PRIOR TO THE START OF CONSTRUCTION.

**J.U.L.I.E. INFORMATION**

COUNTY.....FRANKLIN  
CITY.....BENTON  
TOWNSHIP.....BROWNING  
SECTION NO.....12 & 13  
NEAREST MAJOR ROAD INTERSECTION...RT 37 PETROFF RD.  
AIRPORT ADDRESS...BENTON MUNICIPAL AIRPORT  
P.O. BOX 158  
BENTON, IL. 62812

**AIRPORT SECURITY**

AIRPORT SECURITY WILL BE MAINTAINED AT ALL TIMES. THE PROPOSED HAUL ROUTE SHOWN ON THIS SAFETY PLAN IS THE ONLY ACCESS CONTRACTOR EQUIPMENT AND PERSONNEL WILL BE ALLOWED TO USE. THE CONTRACTOR SHALL PROVIDE BARRICADES AT THIS ACCESS AND ENSURE THE BARRICADES ARE IN PLACE AT THE END OF EACH WORKING DAY.

**AIRCRAFT OPERATIONAL AREA**

THE CONTRACTOR, HIS EMPLOYEES, OR ANY EQUIPMENT WILL NOT BE ALLOWED WITHIN THE AIRCRAFT OPERATIONAL AREA.

**HEIGHT OF CONSTRUCTION EQUIPMENT**

THE MAXIMUM ANTICIPATED HEIGHT OF THE CONSTRUCTION EQUIPMENT IS 20 FEET. THE TALLEST EQUIPMENT IS EXPECTED TO BE A SEMI-TRUCK IN THE UP POSITION.

BENTON MUNICIPAL AIRPORT
IL PROJECT NO. H96-3753
AIP NO. 3-17-0050-B10
<b>RUNWAY SAFETY PLAN</b>
SHEET 3 OF 11

BN013

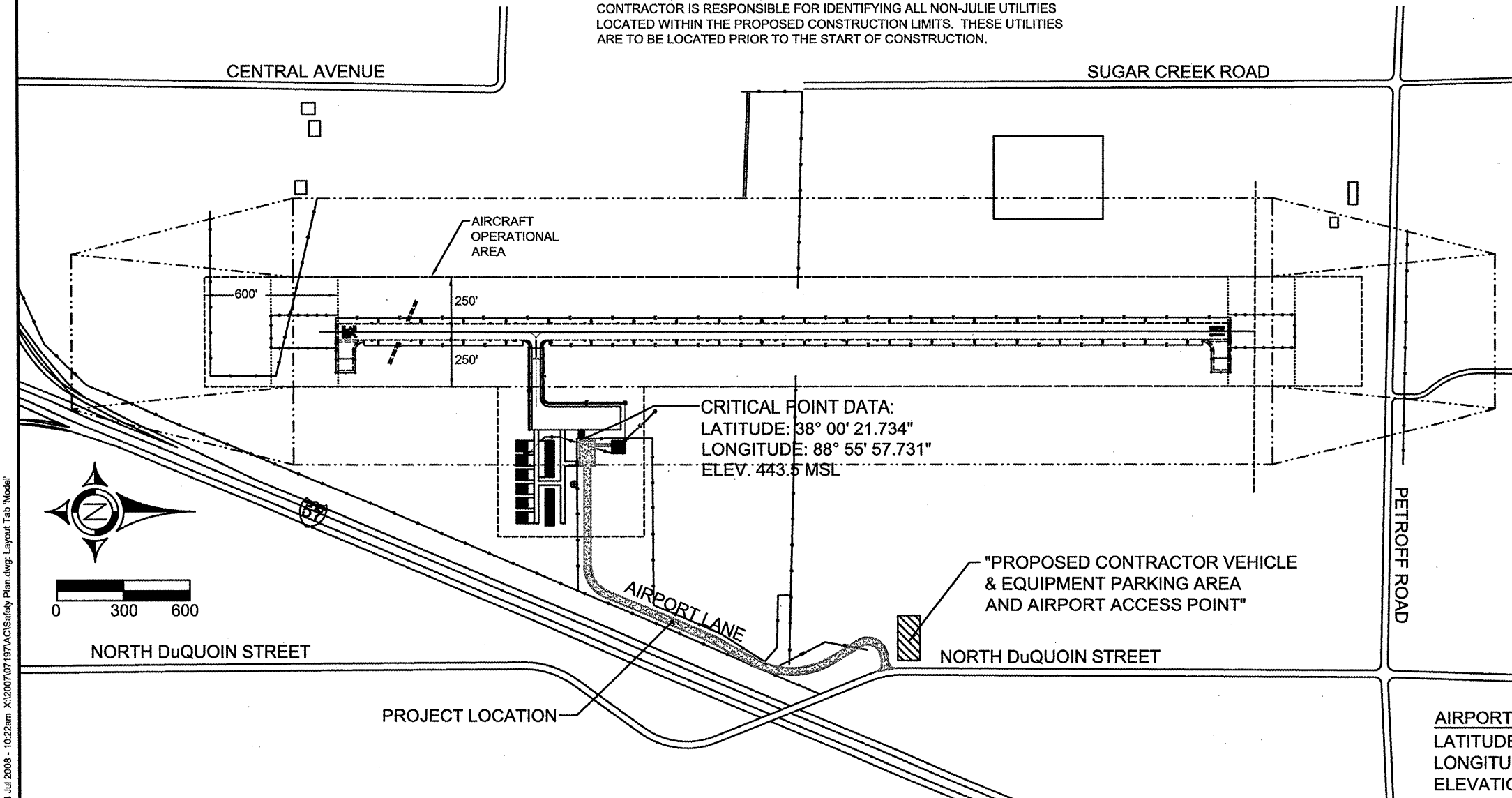

14 Jul 2008 - 10:22am X:\2007\07197\ACISafety Plan.dwg: Layout Tab Model