

LEGEND			NOTES:	
1	LINE 4" (YELLOW SOLID LINE)	5	LINE 4" (WHITE SOLID LINE)	1. ALL PAVEMENT MARKINGS SHALL BE THERMOPLASTIC UNLESS OTHERWISE SPECIFIED.
2	LINE 4" (DOUBLE YELLOW SOLID LINES)	6	LINE 6" (WHITE SOLID LINE)	
3	LINE 4" (YELLOW - 10' DASH, 30' SKIP)	7	LINE 6" (WHITE LANE LINE - 2' DASH, 6' SKIP)	2. RAISED REFLECTIVE PAVEMENT MARKERS SHALL BE USED THROUGHOUT THE PROJECT LIMITS. SEE DISTRICT DETAIL TC-11.
4	LINE 4" (WHITE LANE LINE - 10' DASH, 30' SKIP)	8	LINE 8" (WHITE SOLID LINE)	
		9	LINE 12" (WHITE SOLID LINE)	
		10	LINE 12" (WHITE DIAGONAL LINE)	
		11	LINE 12" (YELLOW DIAGONAL LINE)	
		12	LINE 24" (WHITE SOLID LINE)	
		13	LETTERS AND SYMBOLS (TYP.)	
		TOPSOIL, FURNISH AND PLACE 4" & SEEDING, CLASS 2A		

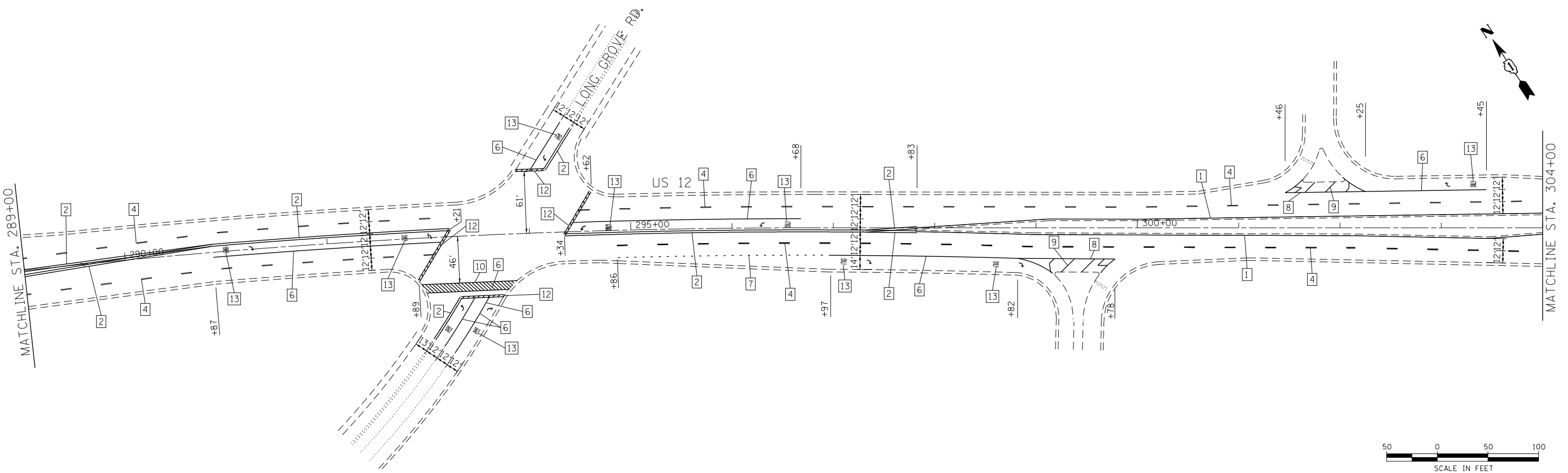

COMPANY NAME: HRGreen
 PROJECT CONTACT: HRGreen.com
 DATE PLOTTED: 5/23/2014 11:50:40 AM
 FILE NAME: 86100196.10-pm-06.dgn
 PLOT DRIVER: pdfcut
 PEN TABLE: standard-trans.tbl



USER NAME = dstencz	DESIGNED - J. ATTANASEO	REVISED -
FILE NAME = 86100196.10-pm-06.dgn	DRAWN - J. ATTANASEO	REVISED -
PLOT SCALE = 1" = 50'	CHECKED - T. HAMILTON	REVISED -
PLOT DATE = 5/23/2014	DATE - 5/23/14	REVISED -

STATE OF ILLINOIS
DEPARTMENT OF TRANSPORTATION

PAVEMENT MARKING AND RESTORATION PLAN
US ROUTE 12 (ELA RD. TO LAKE COOK RD.)
 SCALE: 1" = 50' SHEET NO. 6 OF 8 SHEETS STA. 274+00 TO STA. 304+00

F.A.P. RTE. 334	SECTION SY-3-RS-4	COUNTY LAKE	TOTAL SHEETS 104	SHEET NO. 24
FED. ROAD DIST. NO. ILLINOIS FED. AID PROJECT			CONTRACT NO. 60N26	

