

LEGEND					
1	LINE 4" (YELLOW SOLID LINE)	5	LINE 4" (WHITE SOLID LINE)	10	LINE 12" (WHITE DIAGONAL LINE)
2	LINE 4" (DOUBLE YELLOW SOLID LINES)	6	LINE 6" (WHITE SOLID LINE)	11	LINE 12" (YELLOW DIAGONAL LINE)
3	LINE 4" (YELLOW - 10' DASH, 30' SKIP)	7	LINE 6" (WHITE LANE LINE - 2' DASH, 6' SKIP)	12	LINE 24" (WHITE SOLID LINE)
4	LINE 4" (WHITE LANE LINE - 10' DASH, 30' SKIP)	8	LINE 8" (WHITE SOLID LINE)	13	LETTERS AND SYMBOLS (TYP.)
		9	LINE 12" (WHITE SOLID LINE)		
				TOPSOIL, FURNISH AND PLACE 4" & SEEDING, CLASS 2A

NOTES:

- ALL PAVEMENT MARKINGS SHALL BE THERMOPLASTIC UNLESS OTHERWISE SPECIFIED.
- RAISED REFLECTIVE PAVEMENT MARKERS SHALL BE USED THROUGHOUT THE PROJECT LIMITS. SEE DISTRICT DETAIL TC-11.

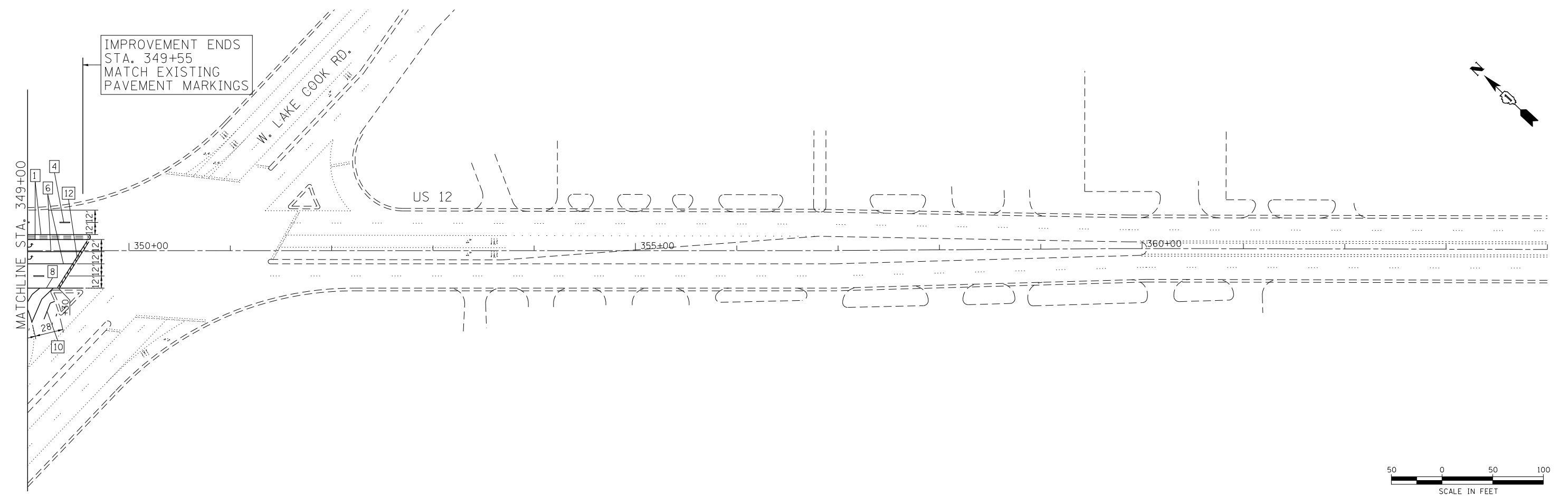

COMPANY NAME: HRGreen.com
 PROJECT CONTACT: J. ATTANASEO
 DATE PLOTTED: 5/23/2014 11:29:01 AM
 FILE NAME: 86100196.10-pm-08.dgn
 PLOT DRIVER: pafch
 PEN TABLE: standard-trans.tbl



USER NAME = dstencz	DESIGNED - J. ATTANASEO	REVISED -
FILE NAME = 86100196.10-pm-08.dgn	DRAWN - J. ATTANASEO	REVISED -
PLOT SCALE = 1" = 50'	CHECKED - T. HAMILTON	REVISED -
PLOT DATE = 5/23/2014	DATE - 5/23/14	REVISED -

**STATE OF ILLINOIS
 DEPARTMENT OF TRANSPORTATION**

**PAVEMENT MARKING AND RESTORATION PLAN
 US ROUTE 12 (ELA RD. TO LAKE COOK RD.)**

SCALE: 1" = 50' SHEET NO. 8 OF 8 SHEETS STA. 334+00 TO STA. END

F.A.P. RTE.	SECTION	COUNTY	TOTAL SHEETS	SHEET NO.
334	SY-3-RS-4	LAKE	104	26
FED. ROAD DIST. NO. ILLINOIS FED. AID PROJECT			CONTRACT NO. 60N26	