

WORK SHALL MEET THE REQUIREMENTS OF THE SPECIAL PROVISION, "TRAFFIC SIGNAL SPECIFICATIONS FOR DETECTOR LOOP REPLACEMENT AND/OR INSTALLATION ON ROADWAY GRINDING, RESURFACING AND PATCHING OPERATIONS". SPECIAL ATTENTION MUST BE MADE TO THE SECTIONS "INSPECTION OF CONSTRUCTION" AND "DETECTOR LOOP REPLACEMENT" FOR INSTALLATION AND INSPECTION REQUIREMENTS. LOOP REPLACEMENT WORK THAT DOES NOT MEET THE CONTRACT REQUIREMENTS SHALL NOT BE PAID. WORK NECESSARY TO COMPLETE THE LOOP REPLACEMENT WORK MAY BE ASSIGNED BY THE ENGINEER TO IDOT'S ELECTRICAL MAINTENANCE CONTRACTOR (EMC); ALL RELATED COSTS WILL BE THE RESPONSIBILITY OF THE CONTRACTOR.

**TRAFFIC SIGNAL LEGEND**

|  | PROPOSED | EXISTING |
|--|----------|----------|
| SIGNAL HEAD WITH BACKPLATE                       | →        | →        |
| SIGNAL HEAD                                      | →        | →        |
| GALVANIZED STEEL CONDUIT IN TRENCH OR PUSHED     | —        | —        |
| DETECTOR LOOP                                    | □        | □        |
| VEHICLE DETECTOR, NON COMPENSATED MAGNETIC TYPE  | —        | —        |
| RACEWAY FOR MAGNETIC DETECTOR, TYPE I OR TYPE II | —        | —        |

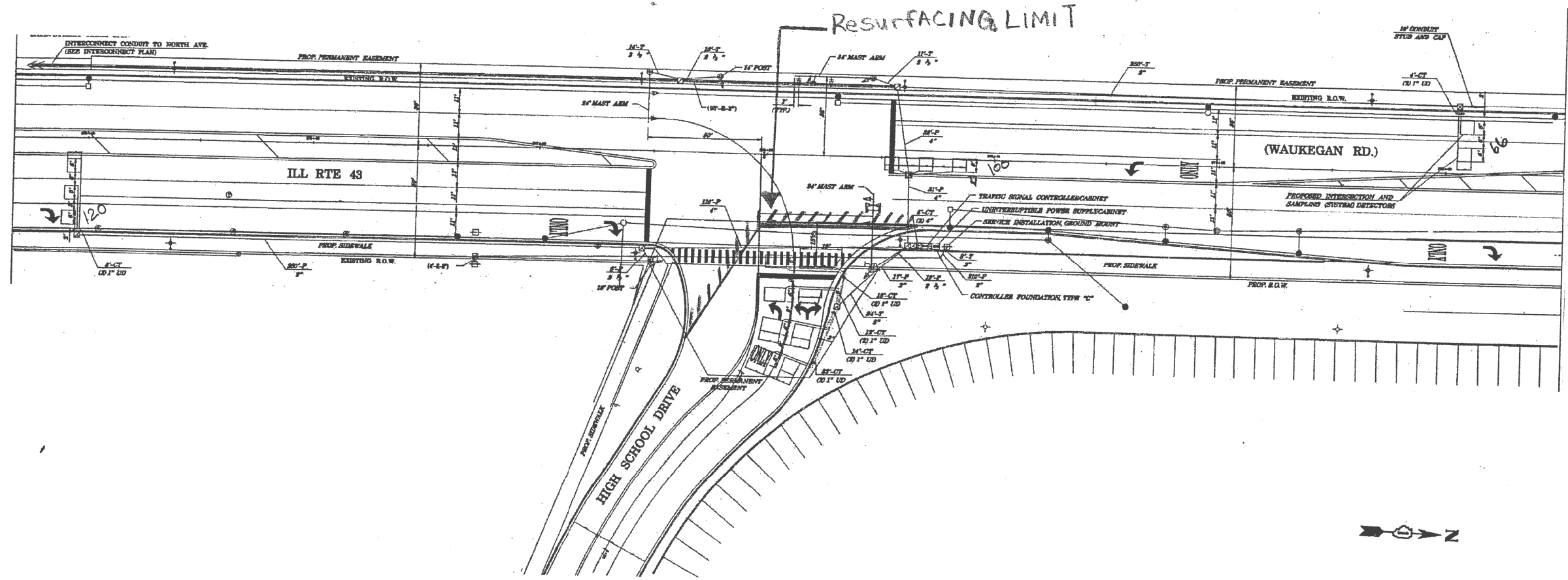

THIS PLAN IS FOR THE SOLE PURPOSE OF DETECTOR LOOP REPLACEMENTS ONLY

REPLACE ALL DETECTOR LOOPS AS SHOWN (WITHIN THE RESURFACING LIMITS)

| CODE     | QUANTITY | UNIT | ITEM                       |
|----------|----------|------|----------------------------|
| 88600600 | 286      | FOOT | DETECTOR LOOP, REPLACEMENT |

|   |                             |            |           |   |   |                           |           |        |              |           |
|---|-----------------------------|------------|-----------|---|---|---------------------------|-----------|--------|--------------|-----------|
| FILE NAME :                             | USER NAME : pyrzanowskirb   | DESIGNED - | REVISED - | <b>STATE OF ILLINOIS<br/>DEPARTMENT OF TRANSPORTATION</b> | <b>DETECTOR LOOP REPLACEMENT PLANS<br/>SHEET 5 OF 6</b> | F.A.J. RTE.               | SECTION   | COUNTY | TOTAL SHEETS | SHEET NO. |
| ct:\pwr\work\pwr\pyrzanowskirb\d0311620 | D151112-sht-plan.dgn        | DRAWN -    | REVISED - |   |   | 2706                      | 1A&BYRS-2 | LAKE   | 28           | 17        |
| Default                                 | PLOT SCALE = 100.000' / in. | CHECKED -  | REVISED - |   |   | <b>CONTRACT NO. 60V04</b> |           |        |              |           |
|   | PLOT DATE = 5/14/2014       | DATE -     | REVISED - |   |   | ILLINOIS FED. AID PROJECT |           |        |              |           |