

| GUARDRAIL TABLE (SOUTHBOUND) |           |        |                              |
|------------------------------|-----------|--------|------------------------------|
| STATION                      | STATION   | OFFSET | DESCRIPTION                  |
| 98+31.50                     | 98+81.50  | LT     | TR BAR TRM TI SPL TAN        |
| 98+81.50                     | 99+81.50  | LT     | SPBR, TY A, 9' POST          |
| 99+81.50                     | 100+12.75 | LT     | SPBGR ATTACHED TO STRUCTURES |
| 100+12.75                    | 101+62.75 | LT     | SPBR, TY A, 9' POST          |
| 101+62.75                    | 102+12.75 | LT     | TR BAR TRM TI SPL TAN        |

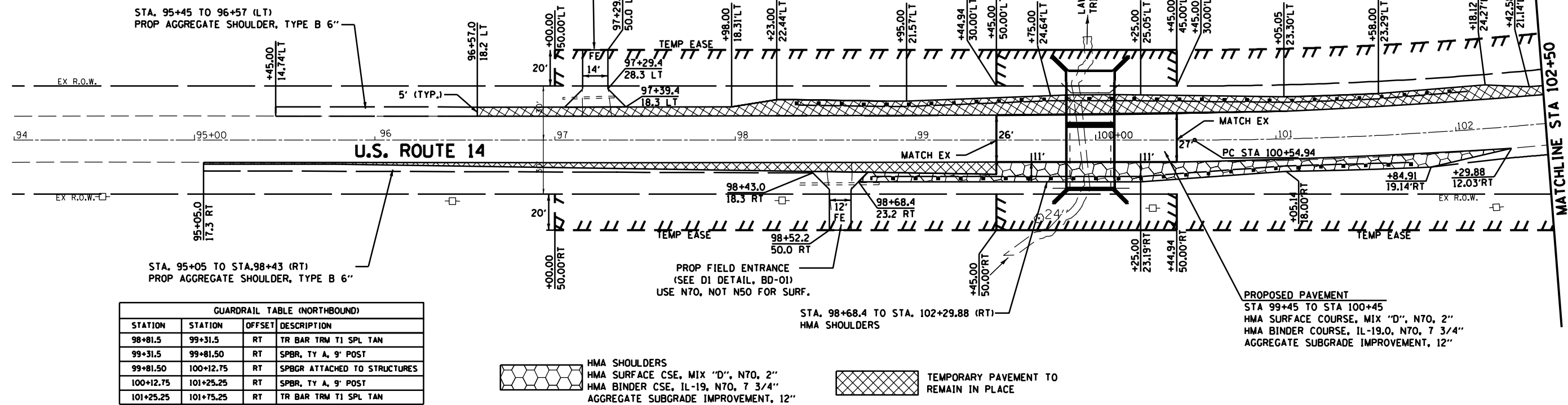

| GUARDRAIL TABLE (NORTHBOUND) |           |        |                              |
|------------------------------|-----------|--------|------------------------------|
| STATION                      | STATION   | OFFSET | DESCRIPTION                  |
| 98+81.5                      | 99+31.5   | RT     | TR BAR TRM TI SPL TAN        |
| 99+31.5                      | 99+81.50  | RT     | SPBR, TY A, 9' POST          |
| 99+81.50                     | 100+12.75 | RT     | SPBGR ATTACHED TO STRUCTURES |
| 100+12.75                    | 101+25.25 | RT     | SPBR, TY A, 9' POST          |
| 101+25.25                    | 101+75.25 | RT     | TR BAR TRM TI SPL TAN        |

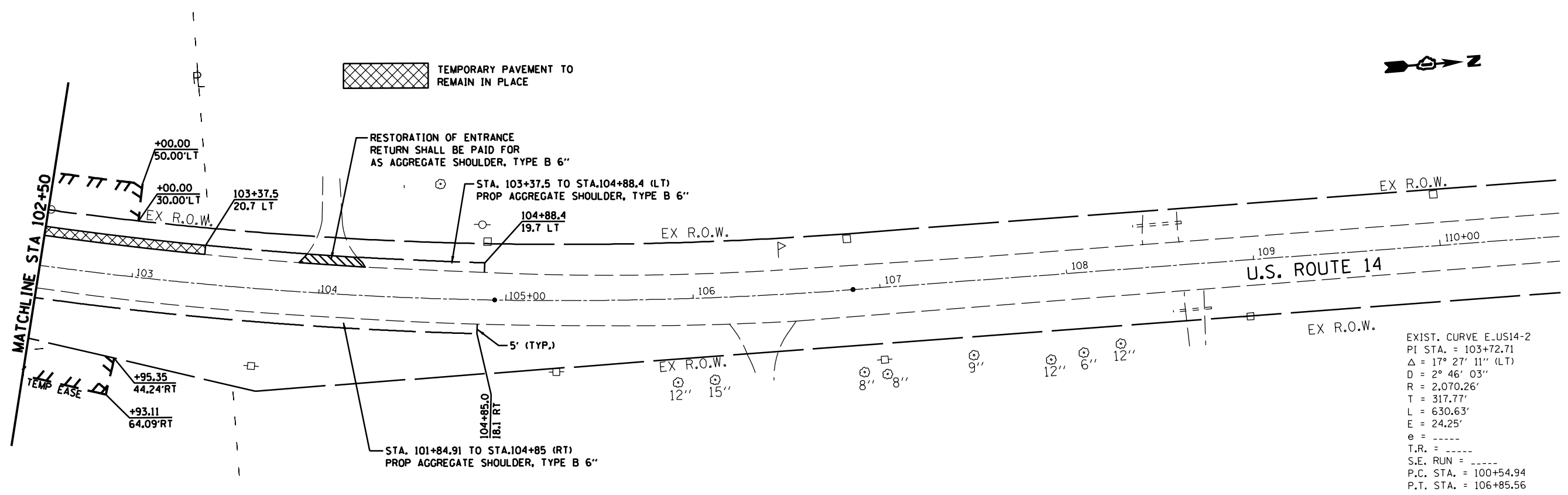

FILE NAME = \$FILE\$  
 PLOT SCALE = \$SCALE\$  
 USER NAME = \$USER\$

**MILLENNIA PROFESSIONAL SERVICES**  
 2600 Warrenville Road, Suite 203, Downers Grove, IL 60515  
 630.785.0110 voice, 630.839.2566 fax  
 www.mps-ill.com

|                   |           |
|-------------------|-----------|
| DESIGNED - TVN/MG | REVISED - |
| DRAWN - MG/JP     | REVISED - |
| CHECKED - TVN     | REVISED - |
| DATE - *DATE*     | REVISED - |

**STATE OF ILLINOIS  
 DEPARTMENT OF TRANSPORTATION**

**US ROUTE 14 OVER LAWRENCE CREEK TRIBUTARY  
 PROPOSED ROADWAY PLAN**

SCALE: 1"=30'    SHEET NO. 1 OF 1 SHEETS    STA. 94+00 TO STA. 110+00

|                    |               |                |   |             |
|--------------------|---------------|----------------|---|-------------|
| F.A.P. RTE. 066    | SECTION 21B-R | COUNTY MCHENRY | TOTAL SHEETS 40                                   | SHEET NO. 8 |
| CONTRACT NO. 60V25 |               |                | FED. ROAD DIST. NO. 1   ILLINOIS FED. AID PROJECT |             |