

I-80 (MOLINE EXPY)

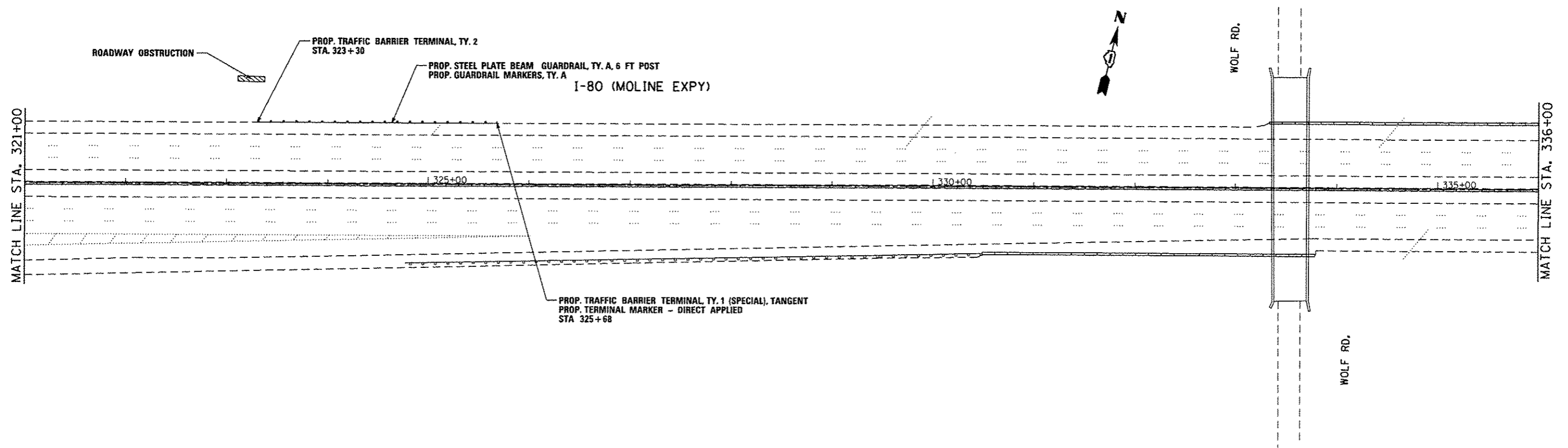
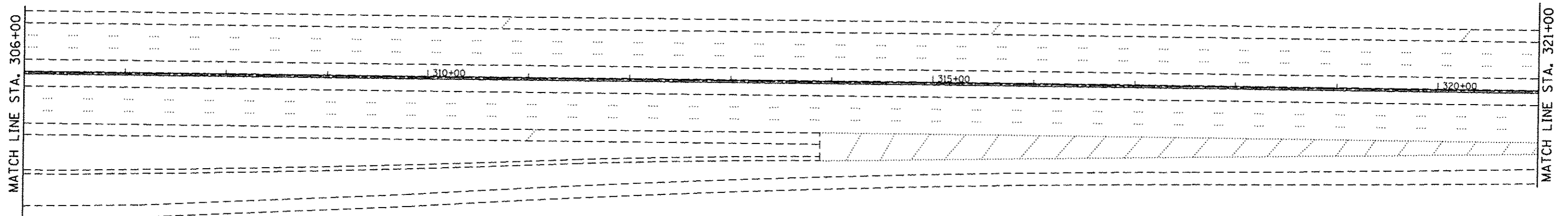

FILE NAME : c:\pwwork\p\eridot\pancap\1\0368459\011144-shs-plan.dgn	USER NAME : PancaPL	DESIGNED -	REVISED -	STATE OF ILLINOIS DEPARTMENT OF TRANSPORTATION	ROADWAY PLAN			F.A.I. RTE.	SECTION	COUNTY	TOTAL SHEETS	SHEET NO.
	PLOT SCALE = 100,0000 1 / in.	CHECKED -	REVISED -		INTERSTATE 80 (FROM US RTE 30 TO I-294)			80	2013-0721	COOK/WILL	43	14
PLOT DATE = 1/31/2014	DATE -	REVISED -	SCALE:		SHEET	OF	SHEETS	STA.	TO STA.	CONTRACT NO. 60X49		
DeFault							ILLINOIS FED. AID PROJECT					