

- ① SS. CLASS A, TYPE 2, 12", 50'
(TB = 6.6 CU YD)
- ② SS. CLASS A, TYPE 2, 12", 100'
(TB = 13.2 CU YD)
- ③ SS. CLASS A, TYPE 2, 12", 95'
(TB = 12.5 CU YD)
- ④ SS. CLASS A, TYPE 2, 12", 55'
(TB = 3.3 CU YD)
- ⑤ SS. CLASS A, TYPE 2, 15", 25'
- ⑥ SS. CLASS A, TYPE 3, 48", 110'
- ⑦ SS. CLASS A, TYPE 3, 15", 100'
(TB = 16.0 CU YD)
- ⑧ SS. CLASS A, TYPE 3, 15", 100'
(TB = 139.6 CU YD)

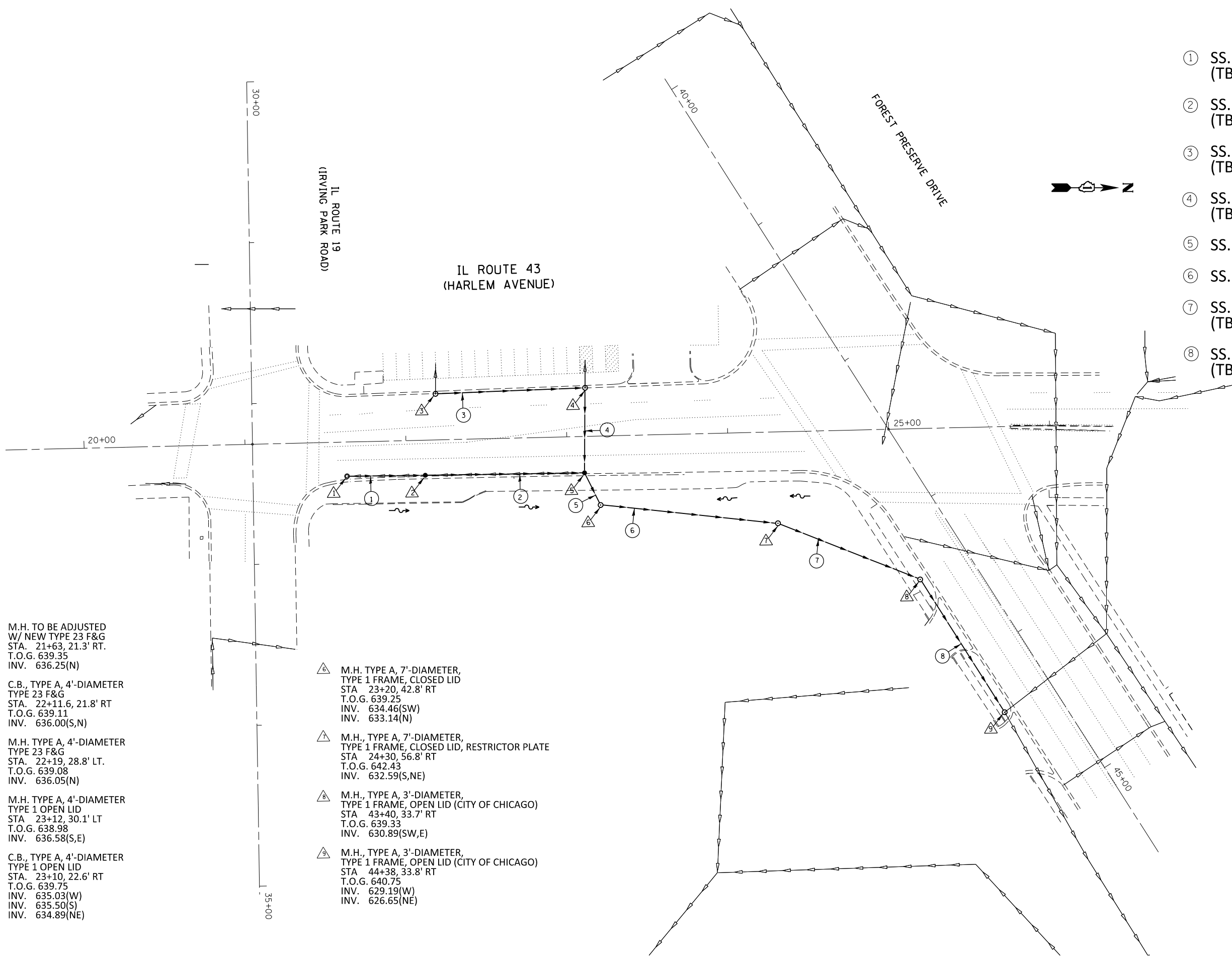

- ① M.H. TO BE ADJUSTED
W/ NEW TYPE 23 F&G
STA. 21+63, 21.3' RT.
T.O.G. 639.35
INV. 636.25(N)
- ② C.B., TYPE A, 4'-DIAMETER
TYPE 23 F&G
STA. 22+11.6, 21.8' RT
T.O.G. 639.11
INV. 636.00(S,N)
- ③ M.H. TYPE A, 4'-DIAMETER
TYPE 23 F&G
STA. 22+19, 28.8' LT.
T.O.G. 639.08
INV. 636.05(N)
- ④ M.H. TYPE A, 4'-DIAMETER
TYPE 1 OPEN LID
STA. 23+12, 30.1' LT
T.O.G. 638.98
INV. 636.58(S,E)
- ⑤ C.B., TYPE A, 4'-DIAMETER
TYPE 1 OPEN LID
STA. 23+10, 22.6' RT
T.O.G. 639.75
INV. 635.03(W)
INV. 635.50(S)
INV. 634.89(N)
- ⑥ M.H. TYPE A, 7'-DIAMETER,
TYPE 1 FRAME, CLOSED LID
STA. 23+20, 42.8' RT
T.O.G. 639.25
INV. 634.46(SW)
INV. 633.14(N)
- ⑦ M.H., TYPE A, 7'-DIAMETER,
TYPE 1 FRAME, CLOSED LID, RESTRICTOR PLATE
STA. 24+30, 56.8' RT
T.O.G. 642.43
INV. 632.59(S,NE)
- ⑧ M.H., TYPE A, 3'-DIAMETER,
TYPE 1 FRAME, OPEN LID (CITY OF CHICAGO)
STA. 43+40, 33.7' RT
T.O.G. 639.33
INV. 630.89(SW,E)
- ⑨ M.H., TYPE A, 3'-DIAMETER,
TYPE 1 FRAME, OPEN LID (CITY OF CHICAGO)
STA. 44+38, 33.8' RT
T.O.G. 640.75
INV. 629.19(W)
INV. 626.65(N)

FILE NAME =	USER NAME = guillaumejp	DESIGNED -	REVISED -	STATE OF ILLINOIS DEPARTMENT OF TRANSPORTATION	PROPOSED DRAINAGE PLAN				F.A.P. RTE.	SECTION	COUNTY	TOTAL SHEETS	SHEET NO.
Default	36814-sht-plan.dgn	DRAWN -	REVISED -		IL. ROUTE 43 (HARLEM AVE.) FOREST PRESERVE DR. - IL. ROUTE 19				348	3134-T(14)	COOK	16	7
	PLOT SCALE = 60.0000' / in.	CHECKED -	REVISED -		SCALE: 1"=30'	SHEET	OF	SHEETS	STA.	TO	STA.	CONTRACT NO. 60Y36	
	PLOT DATE = 6/4/2014	DATE -	REVISED -		ILLINOIS FED. AID PROJECT								