

MOT STAGE 1.2 TYPICAL SECTION Y-Y

U.S. ROUTE 14
STA. 327+00

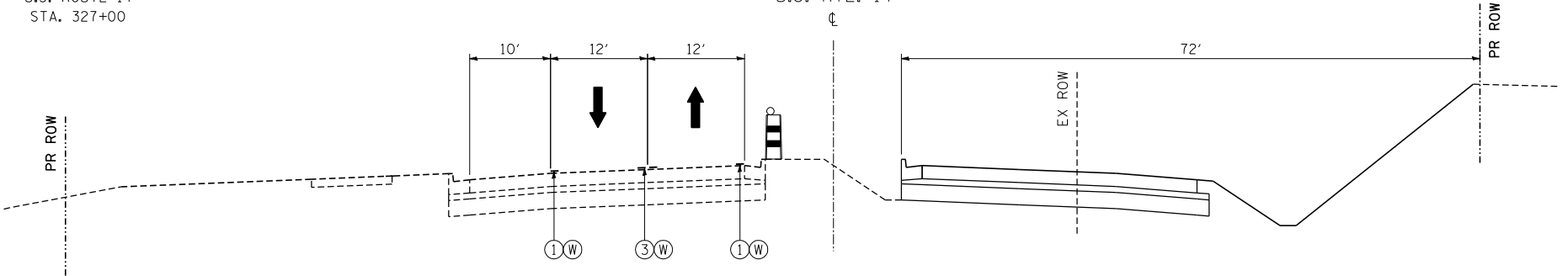

MOT STAGE 1.2 TYPICAL SECTION Z-Z

U.S. ROUTE 14
STA. 375+00

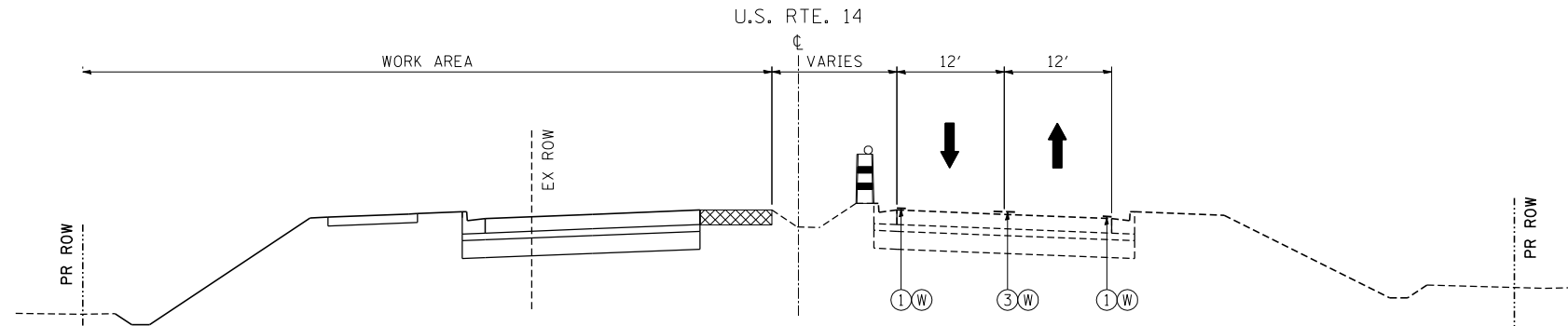

MOT STAGE 1.2 TYPICAL SECTION AA-AA

U.S. ROUTE 14
STA. 482+00

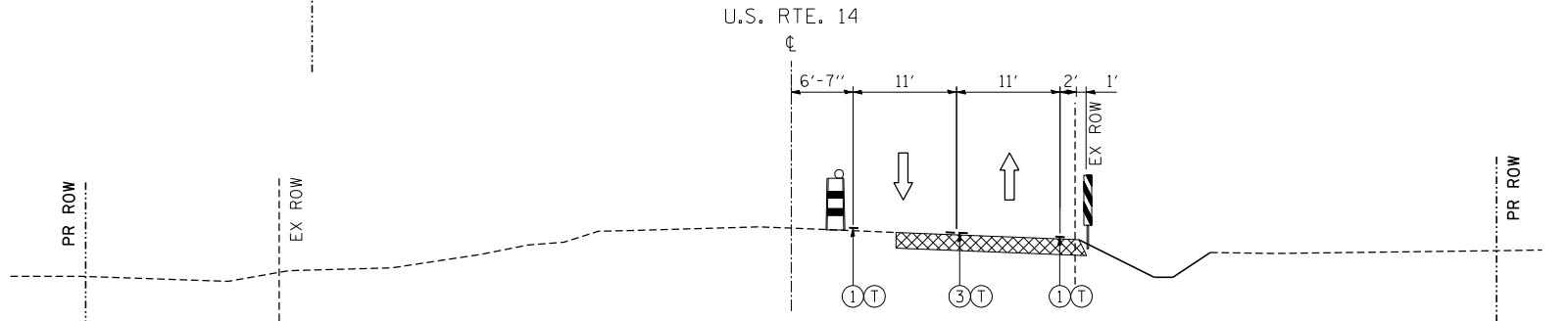

MOT TYPICAL SECTION BB-BB

U.S. ROUTE 14
STA. 492+50

MAINTENANCE OF TRAFFIC LEGEND

- TEMPORARY PAVEMENT (SEE SHT 83 FOR SECTION)
- TEMPORARY CONCRETE BARRIER
- TYPE II BARRICADE OR DRUM W/ TYPE C STEADY BURN BI-DIRECTIONAL LIGHT
- DOUBLE VERTICAL PANEL WITH TYPE C STEADY BURN BI-DIRECTIONAL LIGHT
- EXISTING TRAFFIC DIRECTION
- PROPOSED TRAFFIC DIRECTION
- PVT MK - LINE 4" WHITE
- PVT MK - LINE 4" YELLOW
- PVT MK - DBL 4" YELLOW
- PVT MK - LINE 6" WHITE
- PVT MK - LINE 8" WHITE
- EXISTING PAVEMENT MARKING
- TEMP PVT MK
- WET REF TEM TAPE T3

T:\DOCUMENTS\1934\9901\CIVIL\DCG\TSC00.FIN.DGN
 11-07-2013 16:25:40
 HECHTBR

FILE NAME =	USER NAME = HECHTBR	DESIGNED -	REVISED -
FILEL		DRAWN - JP	REVISED -
exp U.S. Services Inc. Chicago, IL		CHECKED - BRH	REVISED -
BUILDING-EARTH & ENVIRONMENT-ENERGY INDUSTRIAL-INFRASTRUCTURE-SUSTAINABILITY		DATE - 11/01/13	REVISED -
	PLOT SCALE = *SCALE*		
	PLOT DATE = *DATE*		

STATE OF ILLINOIS
DEPARTMENT OF TRANSPORTATION
 U.S. ROUTE 14

MOT TYPICAL SECTIONS			
U.S. ROUTE 14			
STAGE 1.2			
SCALE: N.T.S.	SHEET NO.	OF SHEETS	STA. TO STA.

F.A.P. RTE.	SECTION	COUNTY	TOTAL SHEETS	SHEET NO.
305	27R-2	MCHENRY	673	89
FED. ROAD DIST. NO. 1 ILLINOIS FED. AID PROJECT			CONTRACT NO. 62268	