

PLAN	SURVEYED	DATE
	PLOTTED	BY
	GRADES CHECKED	
	STRUCTURE NOTATIONS CHKD	
	NOTE BOOK NO.	
	CHECKED AT	
	FILE NAME	

PROFILE	SURVEYED	DATE
	PLOTTED	BY
	GRADES CHECKED	
	STRUCTURE NOTATIONS CHKD	
	NOTE BOOK NO.	
	CHECKED AT	
	FILE NAME	

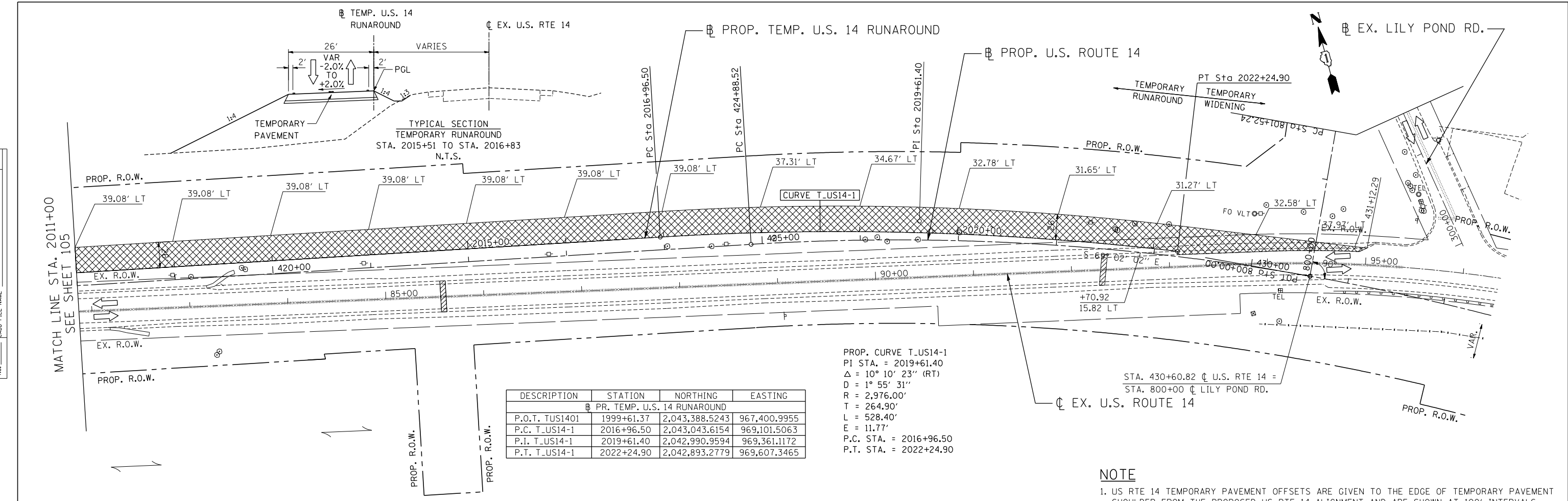

DESCRIPTION	STATION	NORTHING	EASTING
PR. TEMP. U.S. 14 RUNAROUND			
P.O.T. T_US1401	1999+61.37	2,043,388.5243	967,400.9955
P.C. T_US14-1	2016+96.50	2,043,043.6154	969,101.5063
P.I. T_US14-1	2019+61.40	2,042,990.9594	969,361.1172
P.T. T_US14-1	2022+24.90	2,042,893.2779	969,607.3465

S.E. TRANSITION -2% TO +2%
FROM STA. 2015+51 TO STA. 2016+83

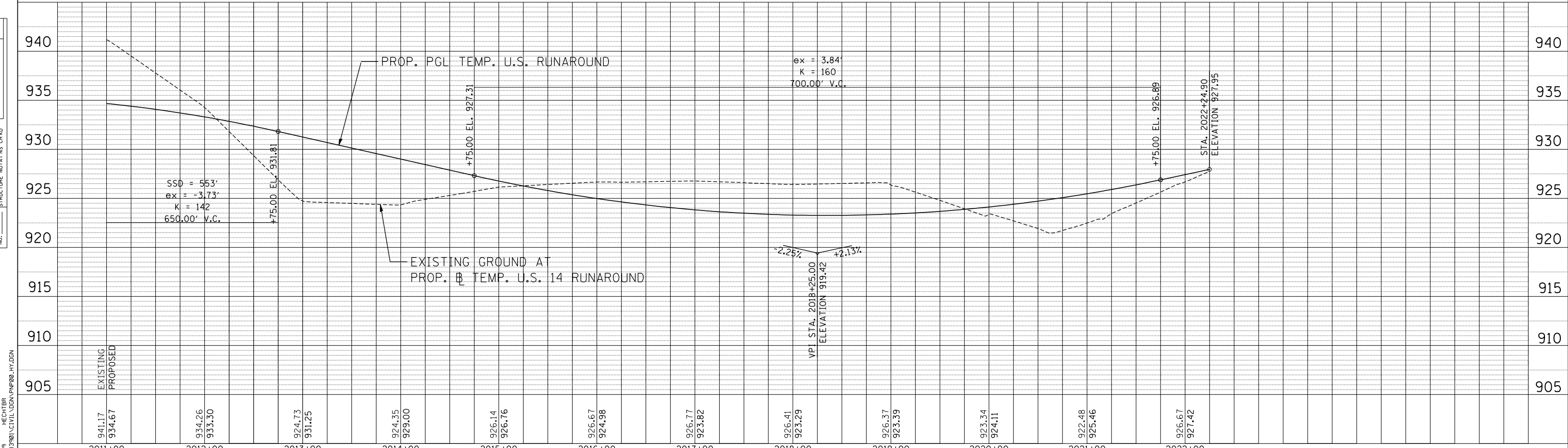

FILE NAME =	USER NAME = HECHTBR	DESIGNED -	REVISED -	STATE OF ILLINOIS DEPARTMENT OF TRANSPORTATION U.S. ROUTE 14	MAINTENANCE OF TRAFFIC PRESTAGE PLAN & PROFILE STA. 418+00 TO STA. 432+50	F.A.P. RTE.	SECTION	COUNTY	TOTAL SHEETS	SHEET NO.	
#FILEL#		DRAWN - RJS	REVISED -			305	27R-2	MCHENRY	673	106	
PLOT SCALE = *SCALE*		CHECKED - BRH	REVISED -			CONTRACT NO. 62268					
PLOT DATE = *DATE*		DATE - 11/01/13	REVISED -			FED. ROAD DIST. NO. 1 ILLINOIS FED. AID PROJECT					

11-06-2013 15:56:45 HECHTBR
T:\DOCUMENT\1934398\CIVIL\UDN\PR08.HV.DGN