

MAINTENANCE OF TRAFFIC LEGEND

- | | | | | | | | | | |
|--|--------------------------------------|--|--|--|---|--|-------------------------|--|-------------------------|
| | WORK AREA | | EXISTING TRAFFIC DIRECTION | | ARROW BOARD | | PVT MK - LINE 4" WHITE | | PVT MK - LINE 24" WHITE |
| | TEMPORARY PAVEMENT (CURRENT STAGE) | | BARRICADE, TYPE III, W/ TYPE A FLASHING LIGHTS | | DOUBLE VERTICAL PANEL WITH TYPE C STEADY BURN LIGHT | | PVT MK - LINE 4" YELLOW | | PVT MK - LINE 8" WHITE |
| | TEMPORARY PAVEMENT (PREVIOUS STAGES) | | TYPE II BARRICADE OR DRUM W/ TYPE C STEADY BURN BI-DIRECTIONAL LIGHT | | PROPOSED SIGN | | PVT MK - DBL 4" YELLOW | | TEMP PVT MK |
| | CONSTRUCTED PAVEMENT | | TYPE B MONO-DIRECTIONAL FLASHING LIGHT | | TYPE II BARRICADE OR DRUM W/ TYPE A FLASHING LIGHT | | PVT MK - LINE 6" WHITE | | WET REF TEM TAPE T3 |
| | | | PVT MK - LINE 12" | | PVT MK - LTRS & SYMB | | | | |

NOTES

- TYPE II BARRICADES OR DRUMS WITH TYPE C STEADY BURN LIGHT SHALL BE SPACED AT 25' C-C ALONG INTERSECTION RADIUS RETURNS.
- TEMPORARY PAVEMENT SHALL BE CONSTRUCTED AFTER PROPOSED PAVEMENT HAS BEEN CONSTRUCTED AND CONSTRUCTED 2' WIDER THAN EDGE OF TRAVELED LANE SHOWN ON SHT 118.

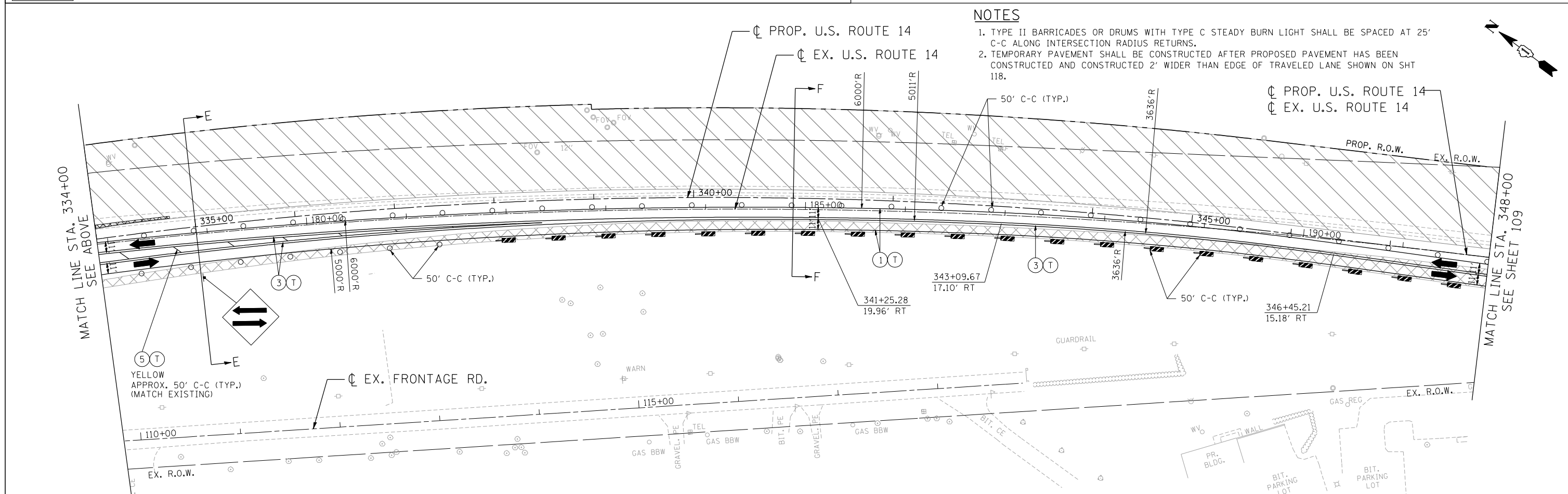

FILE NAME = #FILEL#
 USER NAME = HECHTBR
 DESIGNED -
 DRAWN - JP
 CHECKED - KA
 DATE - 11/01/13
 PLOT SCALE = #SCALE#
 PLOT DATE = #DATE#

**STATE OF ILLINOIS
DEPARTMENT OF TRANSPORTATION
U.S. ROUTE 14**

**MAINTENANCE OF TRAFFIC
STAGE 1.1
STA. 164+00 (EX) TO STA. 348+00**

SCALE: 1"=50'

SHEET NO. OF SHEETS STA. TO STA.

F.A.P. RTE.	SECTION	COUNTY	TOTAL SHEETS	SHEET NO.
305	27R-2	MCHENRY	673	108
CONTRACT NO. 62268				

FED. ROAD DIST. NO. 1 ILLINOIS FED. AID PROJECT