

MAINTENANCE OF TRAFFIC LEGEND

	WORK AREA		EXISTING TRAFFIC DIRECTION		ARROW BOARD		PVT MK - LINE 4" WHITE		PVT MK - LINE 24" WHITE
	TEMPORARY PAVEMENT (CURRENT STAGE)		PROPOSED TRAFFIC DIRECTION		DOUBLE VERTICAL PANEL WITH TYPE C STEADY BURN LIGHT		PVT MK - LINE 4" YELLOW		PVT MK - LINE 8" WHITE
	TEMPORARY PAVEMENT (PREVIOUS STAGES)				PROPOSED SIGN		PVT MK - DBL 4" YELLOW		TEMP PVT MK
	CONSTRUCTED PAVEMENT				TYPE II BARRICADE OR DRUM W/ TYPE C STEADY BURN BI-DIRECTIONAL LIGHT		PVT MK - LINE 6" WHITE		WET REF TEM TAPE T3
					TYPE II BARRICADE OR DRUM W/ TYPE A FLASHING LIGHT		PVT MK - LINE 12"		
							PVT MK - LTRS & SYMB		

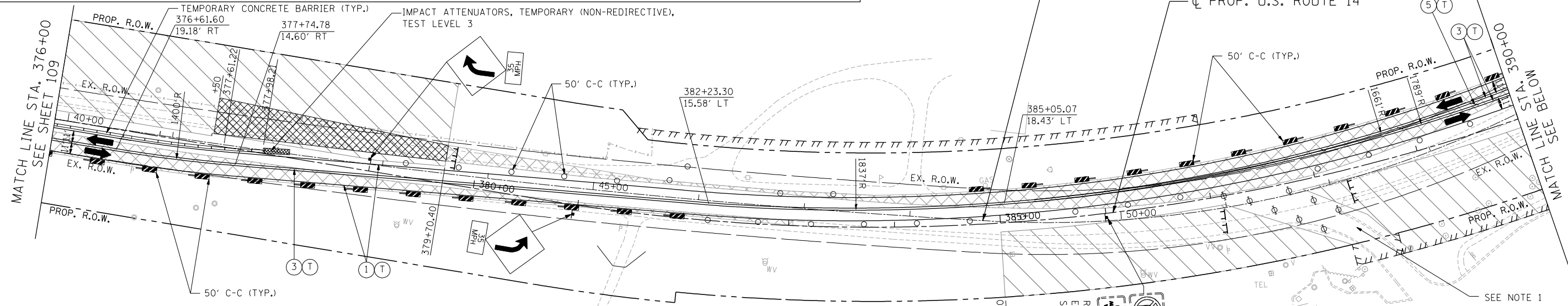

NOTES

1. THE EMERGENCY VEHICLE ENTRANCE SHALL BE CONSTRUCTED ONE HALF AT A TIME IN ORDER TO MAINTAIN ACCESS AT ALL TIMES.
2. TYPE II BARRICADES OR DRUMS WITH TYPE C STEADY BURN LIGHT SHALL BE SPACED AT 25' C-C ALONG INTERSECTION RADIUS RETURNS.

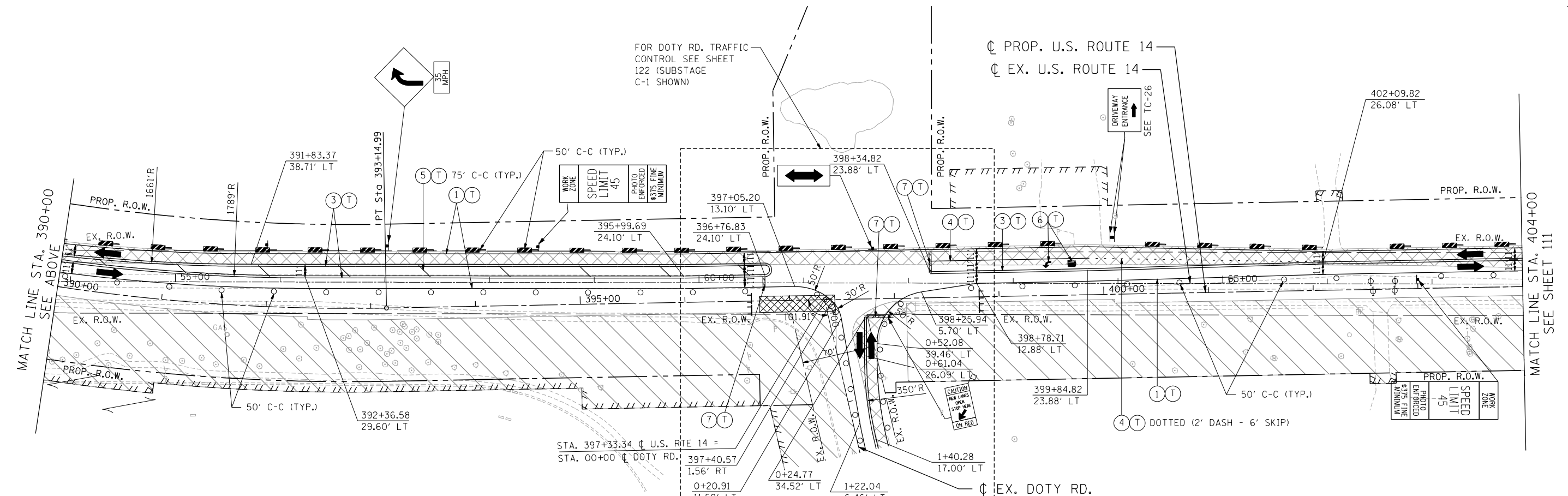

FILE NAME = ... USER NAME = HECHTBR ... DESIGNED - ... REVISED - ... DRAWN - JP ... CHECKED - KA ... DATE - 11/01/13 ... PLOT SCALE = ... PLOT DATE = ...

STATE OF ILLINOIS
DEPARTMENT OF TRANSPORTATION
 U.S. ROUTE 14

MAINTENANCE OF TRAFFIC
STAGE 1.1
STA. 376+00 TO STA. 404+00

F.A.P. RTE.	SECTION	COUNTY	TOTAL SHEETS	SHEET NO.
305	27R-2	MCHENRY	673	110
FED. ROAD DIST. NO. 1 ILLINOIS FED. AID PROJECT			CONTRACT NO. 62268	

SCALE: 1"=50' SHEET NO. OF SHEETS STA. TO STA.