

EX. RIDGEFIELD RD. NORTH

MATCH LINE STA. 851+50
SEE SHEET 115

PROP. RIDGEFIELD RD. NORTH

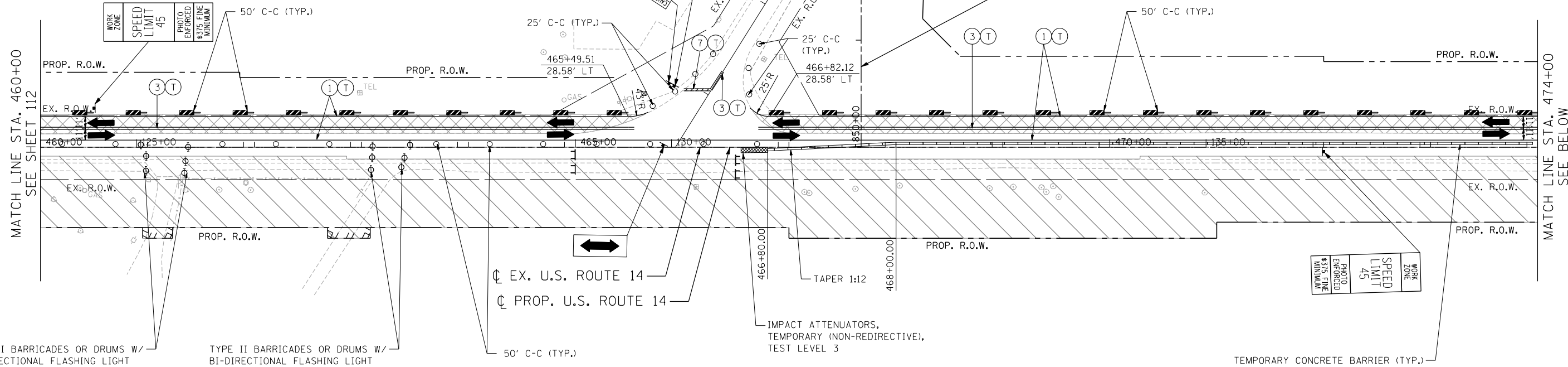

MATCH LINE STA. 460+00
SEE SHEET 112

MATCH LINE STA. 474+00
SEE BELOW

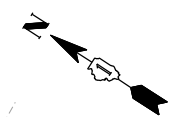

PROP. U.S. ROUTE 14
EX. U.S. ROUTE 14

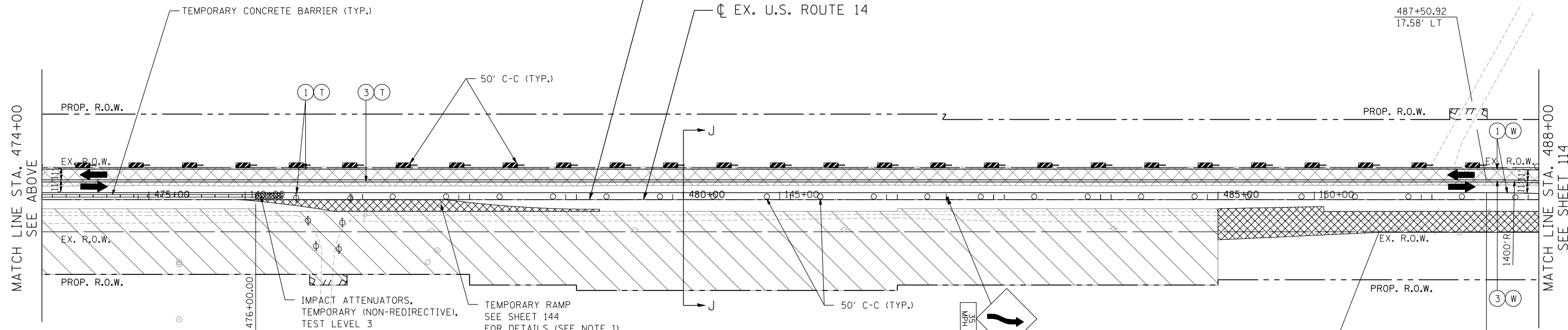

MATCH LINE STA. 474+00
SEE ABOVE

MATCH LINE STA. 488+00
SEE SHEET 114

MAINTENANCE OF TRAFFIC LEGEND

	WORK AREA		EXISTING TRAFFIC DIRECTION		ARROW BOARD		PVT MK - LINE 4" WHITE		PVT MK - LINE 24" WHITE
	TEMPORARY PAVEMENT (CURRENT STAGE)		PROPOSED TRAFFIC DIRECTION		DOUBLE VERTICAL PANEL WITH TYPE C STEADY BURN LIGHT		PVT MK - LINE 4" YELLOW		PVT MK - LINE 8" WHITE
	TEMPORARY PAVEMENT (PREVIOUS STAGES)		BARRICADE, TYPE III, W/ TYPE A FLASHING LIGHTS		PROPOSED SIGN		PVT MK - DBL 4" YELLOW		TEMP PVT MK
	CONSTRUCTED PAVEMENT		TYPE II BARRICADE OR DRUM W/ TYPE C STEADY BURN BI-DIRECTIONAL LIGHT		TYPE II BARRICADE OR DRUM W/ TYPE A FLASHING LIGHT		PVT MK - LINE 6" WHITE		WET REF TEM TAPE T3
			TYPE B MONO-DIRECTIONAL FLASHING LIGHT		TYPE A FLASHING LIGHT		PVT MK - LINE 12"		
			TYPE A FLASHING LIGHT		TYPE A FLASHING LIGHT		PVT MK - LTRS & SYMB		

NOTES

1. TEMPORARY PAVEMENT SHALL BE CONSTRUCTED AFTER PROPOSED PAVEMENT HAS BEEN CONSTRUCTED AND CONSTRUCTED 2' WIDER THAN EDGE OF TRAVELED LANE SHOWN ON SHT 127.

FILE NAME = ... USER NAME = HECHTBR ... DESIGNED - ... REVISED - ... DRAWN - JP ... CHECKED - KA ... DATE - 11/01/13 ... PLOT SCALE = *SCALE* ... PLOT DATE = *DATE*



STATE OF ILLINOIS
DEPARTMENT OF TRANSPORTATION
U.S. ROUTE 14

MAINTENANCE OF TRAFFIC
STAGE 1.1
STA. 460+00 TO STA. 488+00

SCALE: 1"=50'

SHEET NO. OF SHEETS STA. TO STA.

F.A.P. RTE.	SECTION	COUNTY	TOTAL SHEETS	SHEET NO.
305	27R-2	MCHENRY	673	113
CONTRACT NO. 62268				
FED. ROAD DIST. NO. 1 ILLINOIS FED. AID PROJECT				