

DATE	
BY	
SURVEYED	
PLOTTED	
TEMPLATE	
AREAS	
CHECKED	
FINAL SURVEY	
NOTE BOOK	
NO.	

DATE	
BY	
SURVEYED	
PLOTTED	
TEMPLATE	
AREAS	
CHECKED	
ORIGINAL SURVEY	
NOTE BOOK	
NO.	

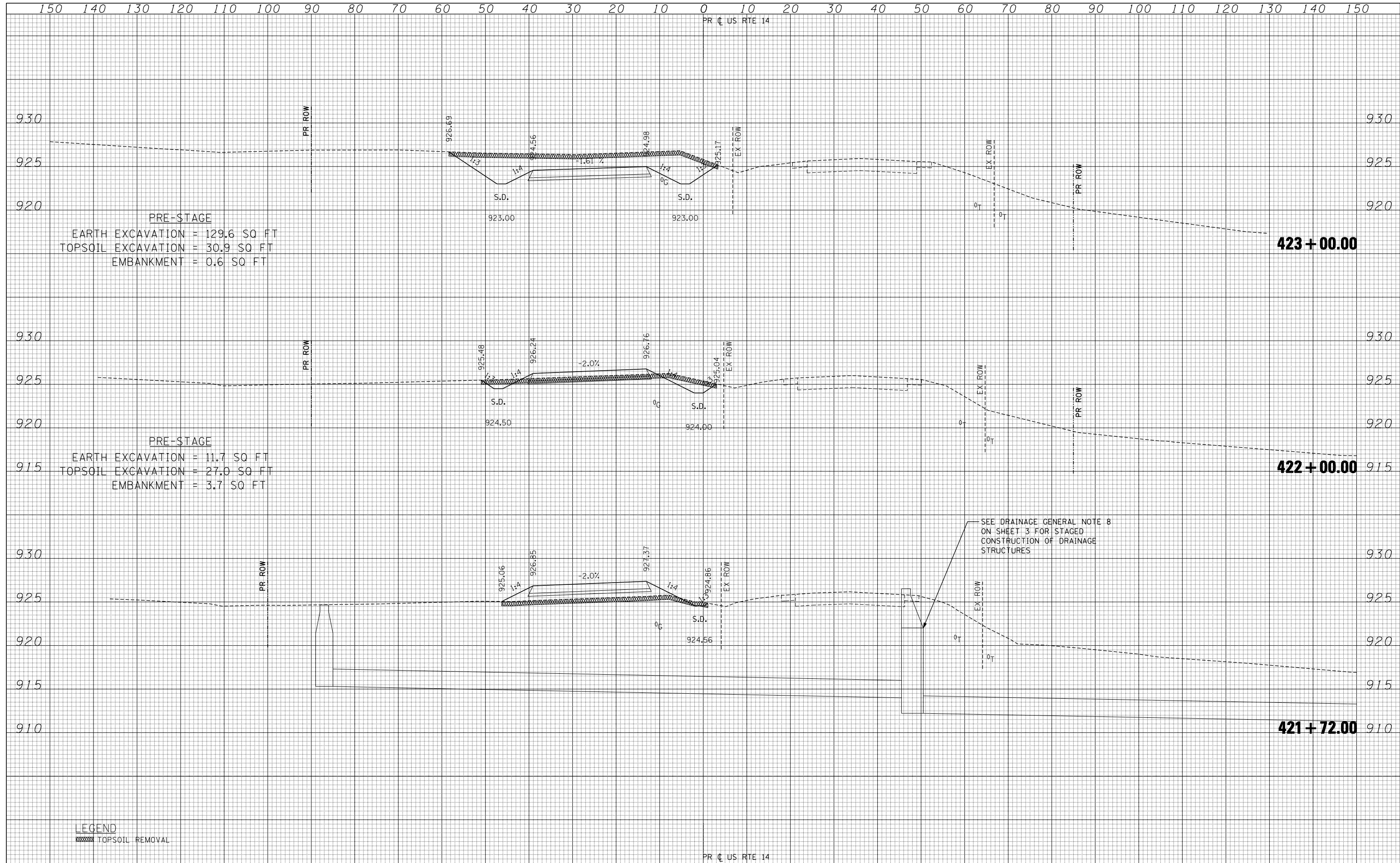

FILE NAME	USER NAME	DESIGNED	REVISED	STATE OF ILLINOIS DEPARTMENT OF TRANSPORTATION	U.S. ROUTE 14 PRE-STAGE CROSS SECTIONS	F.A.P. RTE.	SECTION	COUNTY	TOTAL SHEETS	SHEET NO.	
FILEL	*USER*	DRAWN - AG	REVISED -			305	27R-2	MCHENRY	673	176	
		CHECKED - BRH	REVISED -			CONTRACT NO. 62268					
		DATE - 11/01/13	REVISED -			ILLINOIS FED. AID PROJECT					

SCALE: HORIZ. 1" = 10' VERT. 1" = 5' STA. 421+72.00 TO STA. 423+00.00