

DATE	
BY	
FINAL SURVEY	SURVEYED
NOTE BOOK	PLOTTED
NO.	TEMPLATE
	AREAS CHECKED

DATE	
BY	
ORIGINAL SURVEY	SURVEYED
NOTE BOOK	PLOTTED
NO.	TEMPLATE
	AREAS CHECKED

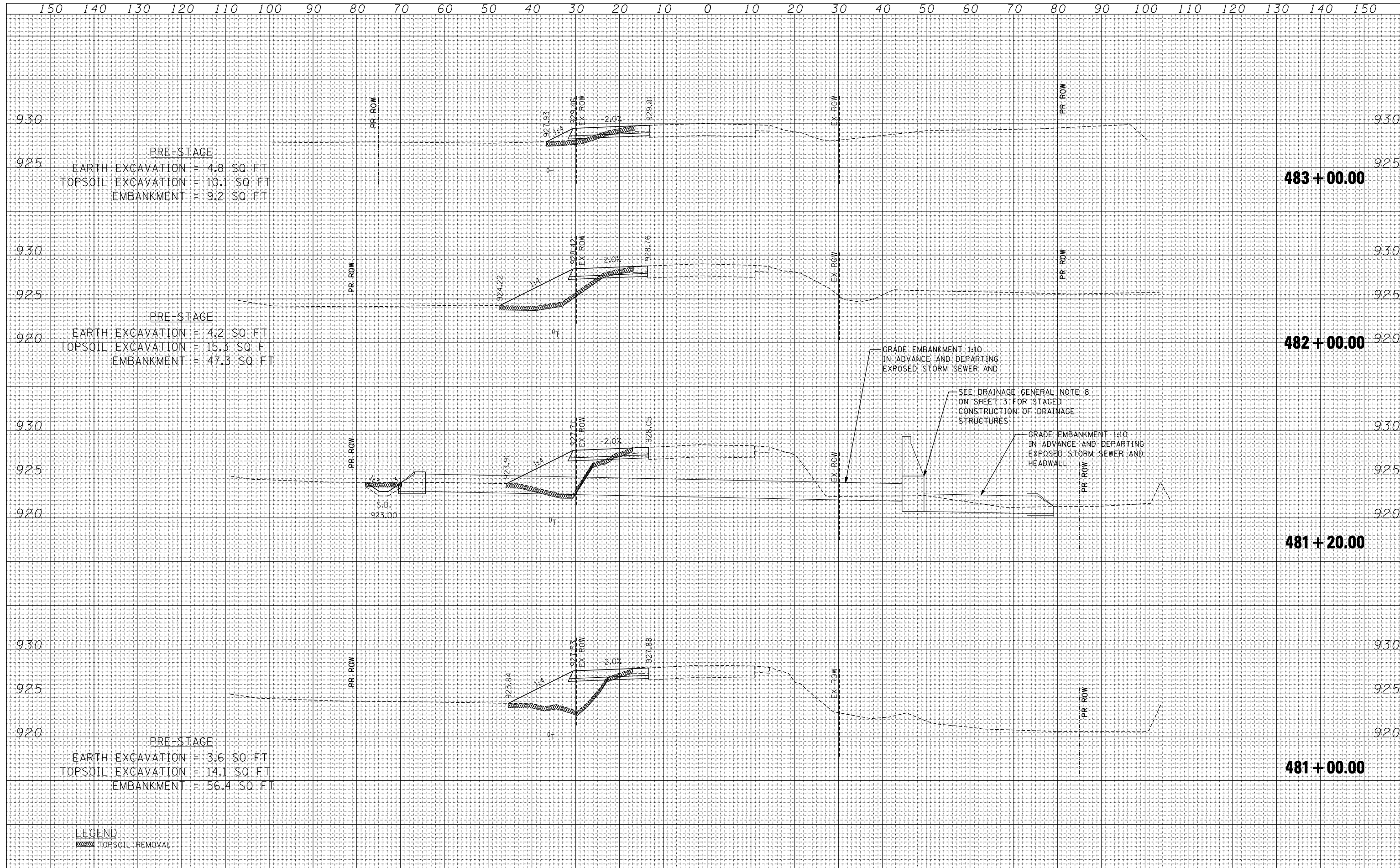

FILE NAME	USER NAME	DESIGNED	REVISED	F.A.P. RTE.	SECTION	COUNTY	TOTAL SHEETS	SHEET NO.
FILEL	*USER*	DRAWN - AG	REVISED -	305	27R-2	MCHENRY	673	194
		CHECKED - BRH	REVISED -					
		DATE - 11/01/13	REVISED -					
exp U.S. Services Inc. CHICAGO, IL BUILDING - EARTH & ENVIRONMENT - ENERGY INDUSTRIAL - INFRASTRUCTURE - SUSTAINABILITY				U.S. ROUTE 14 PRE-STAGE CROSS SECTIONS SCALE: HORIZ. 1" = 10' VERT. 1" = 5' STA. 481+00.00 TO STA. 483+00.00		ILLINOIS FED. AID PROJECT CONTRACT NO. 62268		

**STATE OF ILLINOIS
DEPARTMENT OF TRANSPORTATION**