

NOTE: THE PIPES AND STRUCTURES SHOWN ARE PROPOSED, UNLESS OTHERWISE CALLED AS TEMPORARY. SEE PROPOSED DRAINAGE PLANS FOR PROPOSED PIPE AND STRUCTURE INFORMATION.

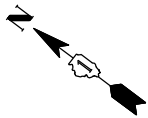

MATCH LINE STA. 348+00  
SEE SHEET 227

MATCH LINE STA. 362+00  
SEE STAGE 1.1 SHEET 219

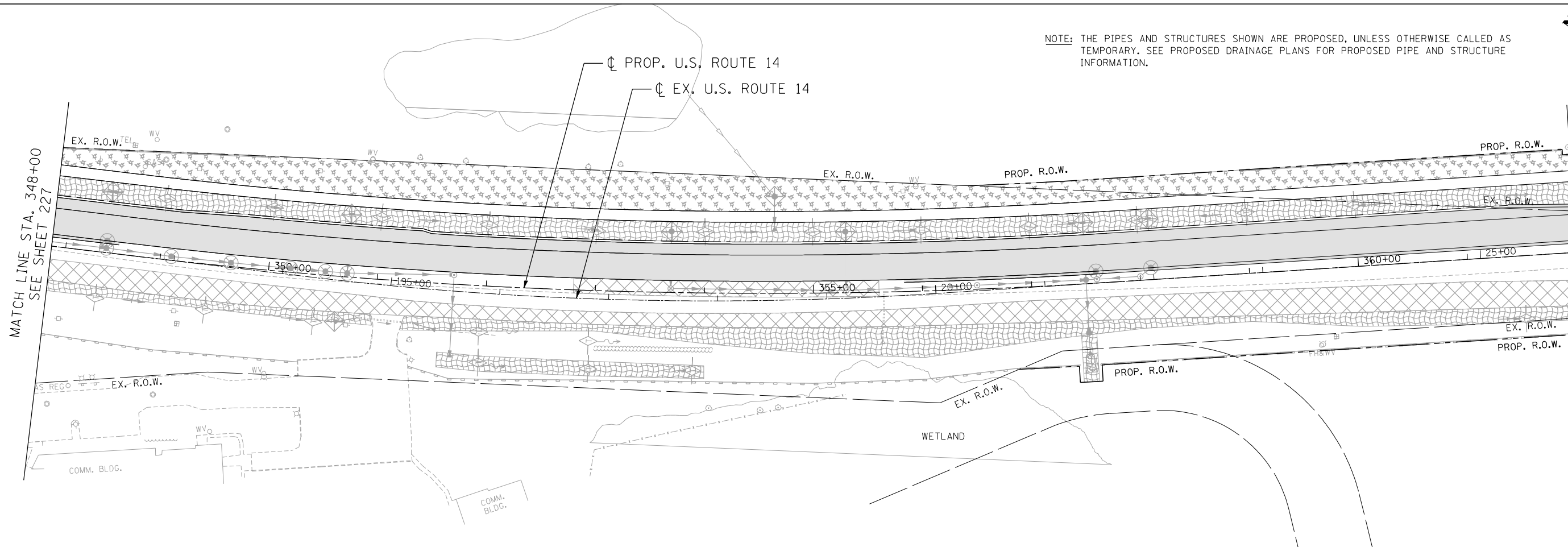

**EROSION CONTROL LEGEND**

	INLET FILTER		TEMPORARY EROSION CONTROL BLANKET (TECB) & TEMPORARY EROSION CONTROL SEEDING (TECS)		PROPOSED PAVEMENT
	TEMPORARY DITCH CHECK		MULCH, METHOD 2 (MM 2) & TEMPORARY EROSION CONTROL SEEDING (TECS)		INLET AND PIPE PROTECTION
	PERIMETER EROSION BARRIER (PEB)		EROSION CONTROL MEASURES (TECB, MM 2 AND TECS) PLACED IN PREVIOUS STAGES		TEMPORARY PAVEMENT PLACED IN PREVIOUS STAGES
	TEMPORARY PAVEMENT				

**STATE OF ILLINOIS**  
**DEPARTMENT OF TRANSPORTATION**  
U.S. ROUTE 14

**EROSION CONTROL**  
**STAGE 1.1 SUBSTAGE A-2**  
**STA. 348+00 TO STA. 362+00**

SCALE: 1"=50' SHEET NO. OF SHEETS STA. TO STA.

F.A.P. RTE.	SECTION	COUNTY	TOTAL SHEETS	SHEET NO.
305	27R-2	MCHENRY	673	228
FED. ROAD DIST. NO. 1 ILLINOIS FED. AID PROJECT			CONTRACT NO. 62268	

FILE NAME = USER NAME = HECHTBR DESIGNED - REVISED - DRAWN - MRK REVISED - CHECKED - TKL REVISED - DATE - 11/01/13 REVISED -  
 exp U.S. Services Inc. Chicago, IL BUILDINGS-EARTH & ENVIRONMENT-ENERGY INDUSTRIAL-INFRASTRUCTURE-SUSTAINABILITY  
 T:\DOCUMENT\1934\9901\CIVIL\DCN\EROC00.L3.DGN