

NOTE: THE PIPES AND STRUCTURES SHOWN ARE PROPOSED, UNLESS OTHERWISE CALLED AS TEMPORARY. SEE PROPOSED DRAINAGE PLANS FOR PROPOSED PIPE AND STRUCTURE INFORMATION.

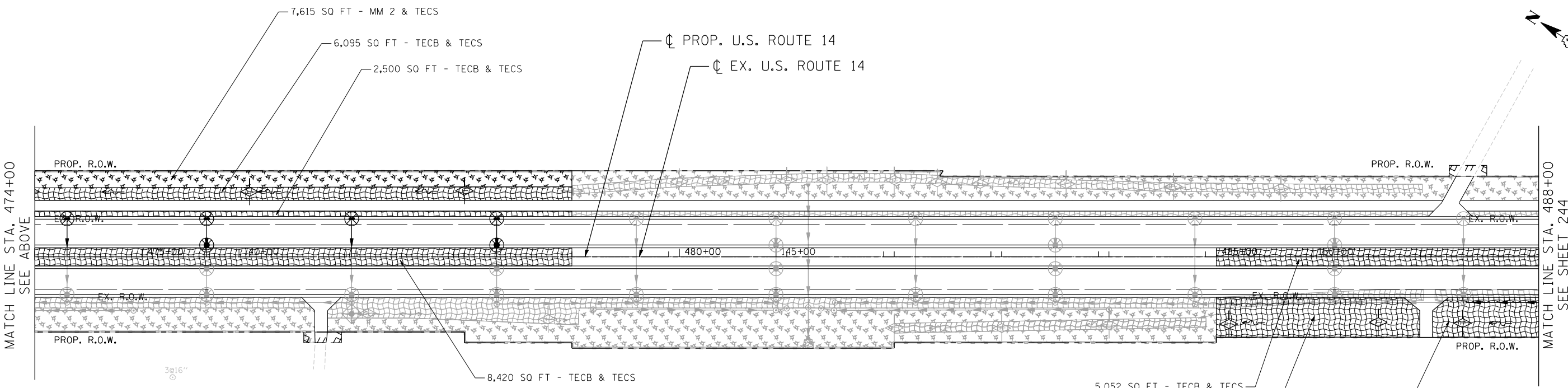

**EROSION CONTROL LEGEND**

- INLET FILTER
- TEMPORARY DITCH CHECK
- PERIMETER EROSION BARRIER (PEB)
- TEMPORARY PAVEMENT
- TEMPORARY EROSION CONTROL BLANKET (TECB) & TEMPORARY EROSION CONTROL SEEDING (TECS)
- MULCH, METHOD 2 (MM 2) & TEMPORARY EROSION CONTROL SEEDING (TECS)
- EROSION CONTROL MEASURES (TECB, MM 2 AND TECS) PLACED IN PREVIOUS STAGES
- PROPOSED PAVEMENT
- INLET AND PIPE PROTECTION
- TEMPORARY PAVEMENT PLACED IN PREVIOUS STAGES

FILE NAME = ...  
 USER NAME = HECHTBR  
 DESIGNED - MRK  
 DRAWN - MRK  
 CHECKED - TKL  
 DATE - 11/01/13  
 REVISED -  
 REVISED -  
 REVISED -  
 REVISED -  
 REVISED -  
 REVISED -  
 STATE OF ILLINOIS  
 DEPARTMENT OF TRANSPORTATION  
 U.S. ROUTE 14  
 EROSION CONTROL  
 STAGE 2.1  
 STA. 460+00 TO STA. 488+00  
 SCALE: 1"=50'  
 SHEET NO. OF SHEETS STA. TO STA.  
 F.A.P. RTE. SECTION COUNTY TOTAL SHEETS SHEET NO.  
 305 27R-2 MCHENRY 673 243  
 FED. ROAD DIST. NO. 1 ILLINOIS FED. AID PROJECT CONTRACT NO. 62268

